

ASDA Multi

• **Plow Subsoiler with
Automatic Shank**

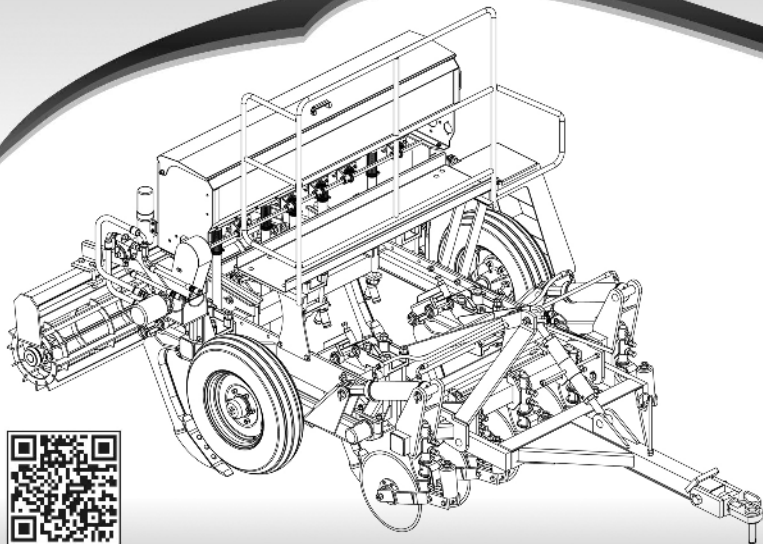

www.baldan.com.br

Instruction Manual

INTRODUCTION

We thank you for the preference and congratulate your excellent choice in acquiring an implement of outstanding quality, manufactured in accordance with the advanced technology of **BALDAN IMPLEMENTOS AGRÍCOLAS S/A.**

This manual will assist you, in proceeds necessities, since when you bought until the operational proceeds application, security and maintenance.

The **BALDAN** guarantees that deliver this implement to the dealer, working properly, and in perfect conditions.

The dealers it's under the responsibility to keep the protection and conservation while keep the implement in your stock, and than, to assembly, tighten, lubrication and overhaul.

On time of the technical deliver, the dealer must to have conducted the user customer about the manutentation, safety, and your obligations in a possible technical assistance, the obligation to see the warranty terms and read the instruction manual. Any solicitation of warranty, please contact our Baldan technical service, by your Baldan dealer that you bought our implement. Reaffirm the necessity to read carefully of warranty certificate and note all of items from this manual, therefore you will increase the working life of your equipment.



Instruction Manual



INDEX

Warranty	6
<i>Product warranty.....</i>	<i>6 - 7</i>
General Information.....	8
<i>Owner.....</i>	<i>8</i>
Safety rules	9 - 11
Warnings	12 - 13
Components.....	14
Dimensions	15
<i>ASDA Multi 5 / 7 / 9 rods.....</i>	<i>15</i>
Technical specifications.....	16
Assembly	16
<i>Coupling header assembly.....</i>	<i>17</i>
<i>Wheel shaft assembly</i>	<i>18</i>
<i>Tires installation.....</i>	<i>19</i>
<i>Rods assembly.....</i>	<i>19</i>
<i>Rods assembly.....</i>	<i>20</i>
<i>Platforms assembly.....</i>	<i>21</i>
<i>Roller harrow assembly</i>	<i>22</i>
<i>Tank assembly</i>	<i>23</i>
<i>Cutting discs assembly.....</i>	<i>24</i>
<i>Hydraulic cylinders installation.....</i>	<i>25</i>
<i>Hydraulic system installation</i>	<i>26</i>
<i>Assembly of the hydraulic transmission system seed sytem</i>	<i>27</i>
<i>Assembly of the hydraulic transmission system fertilizing sytem.....</i>	<i>27</i>
Coupling	28
<i>Coupling of the subsoiler to the tractor drawbar</i>	<i>28</i>

INDEX

<i>Subsoiler leveling</i>	29
Ladder	30
<i>Use of ladder</i>	30
Adjustments	31
<i>Adjustment for transport</i>	31
<i>Depth adjustment</i>	32
<i>Rod automatic disarm load adjustment</i>	33
<i>Cutting disc depth adjustment</i>	34
<i>Cutting disc pressure adjustment</i>	34
Seed distribution	35
<i>Seed distribution adjustment</i>	35
<i>Seed distribution box adjustment</i>	36
<i>Seed adjustment with hydraulic motor</i>	37
<i>Practical calculation for seed distribution</i>	38
<i>Seed distribution table</i>	39
Fertilizer distribution	40
<i>Fertilizer guide - Fertilization system</i>	40
<i>Fertilizer conductor</i>	41
<i>Fertilizer adjustment with hydraulic motor</i>	42
<i>Practical calculation for fertilizer distribution</i>	43
<i>Fertilizer distribution table</i>	44
<i>Practical test to assess the quantity fertilizer and seed distribution</i>	45
Operations	46
<i>Rod operations</i>	47 - 48

INDEX

Maintenance.....	48
<i>Tires pressure.....</i>	<i>49</i>
<i>Lubrication.....</i>	<i>50</i>
<i>Table of greases and equivalents.....</i>	<i>50</i>
<i>Lubricate every 10 working hours</i>	<i>51 - 54</i>
<i>Lubricate every 24 working hours</i>	<i>54</i>
<i>Lubricate every 30 working hours</i>	<i>55</i>
<i>Lubricate every 60 working hours</i>	<i>55</i>
<i>Bearings adjustments</i>	<i>56</i>
<i>Bearings lubrication.....</i>	<i>56</i>
<i>Maintenance Operational.....</i>	<i>57</i>
<i>Precautions</i>	<i>58</i>
<i>General cleaning</i>	<i>59</i>
<i>Fertilizer system cleaning - optional fertilization system.....</i>	<i>60</i>
Optional.....	61
<i>Tire 11x15</i>	<i>61</i>
<i>Fertilization system</i>	<i>61</i>
Identification.....	62 - 63
Notes	64 - 65
Certificate.....	66
<i>Certificate of Warranty.....</i>	<i>66 - 74</i>

WARRANTY

PRODUCT WARRANTY

A **BALDAN IMPLEMENTOS AGRÍCOLAS S/A**, ensures the dealer normal performance of the implement for a period of six (6) months as of the delivery date on the retail invoice to the first final consumer.

During this period, **BALDAN** undertakes to repair defects in material and/or of manufacture of its liability, including labor, freight and other expenses of the dealer's liability.

In the warranty period, request and replacement of eventual defective parts shall be made to the dealer of the area, who will submit the faulty piece for **BALDAN**.

When this procedure is not possible and the resolving capacity of the dealer is exhausted, the dealer will request the support of **BALDAN** Technical Assistance through a specific form distributed to dealers.

After analyzing the replaced items by **BALDAN** Technical Assistance, and concluding that it is not a warranty, then the dealer will be responsible for the costs related to the replacement; as well as material expenses, travel including accommodation and meals, accessories, lubricant used and other expenses arising from the call out to Technical Assistance, and **BALDAN** company is authorized to carry the respective invoice in the name of the resale.

Any repair carried out in the product within the dealer warranty deadline will only be authorized by **BALDAN** upon previous budget presentation describing parts and workforce to be executed.

The product is excluded from this term if it is repaired or modified by representatives not belonging to the BALDAN dealer network, as well as the application of non-genuine parts or components to the user's product.

This warranty is void where it is found that the defect or damage is caused by improper use of the product, failure to follow instructions or inexperience of the operator.

It is agreed that this warranty does not cover tires, polyethylene tanks, cardan shafts, hydraulic components, etc., which are equipment guaranteed by their manufacturers.

Manufacturing and/or material defects, object of this warranty term, will not constitute, under any circumstances, grounds for termination of a purchase agreement, or for indemnification of any nature.

BALDAN reserves the right to change and/or perfect the technical characteristics of its products, without previous notice, and without obligation to proceed in the same way with the products previously manufactured.

GENERAL INFORMATION

TO THE OWNER

BALDAN IMPLEMENTOS AGRÍCOLAS S/A, is not responsible for any damaged caused by accident due to usage, transportation, or in the improper or incorrect transportation of its implement, whether by negligence and/or inexperience of any person.

Only people with complete knowledge of the tractor and the implement should carry their transportation and operation.

BALDAN is not responsible for any damaged caused in unpredictable or unrelated situations to the normal use of the implement.

The incorrect handling of this equipment may result in severe or fatal accidents. Before starting the equipment, carefully read the instructions contained in this manual. Make sure that the person responsible for the operation is instructed as the correct and safe handling. Also make sure that the operator has read and understood the instructions manual of the product.



NR-31 - SAFETY AND HEALTH AT WORK IN AGRICULTURE, LIVESTOCK FORESTRY, FOREST EXPLORATION AND AQUACULTURE.

The purpose of this Regulatory Standard is to establish the precepts to be observed in the organization and in the work environment, in a manner compatible with the planning and development of agriculture, livestock, forestry and aquaculture activities with the safety and health and environment work environment.

MR. OWNER OR OPERATOR OF THE EQUIPMENT.

Read and carefully comply with provisions of NR-31.

For more information, refer to the site and read in full NR-31.

<http://portal.mte.gov.br/legislacao/normas-regulamentadoras-1.htm>



SAFETY RULES



THIS SYMBOL INDICATES AN IMPORTANT SAFETY WARNING. WHENEVER YOU FIND IT IN THIS MANUAL CAREFULLY READ THE MESSAGE THAT FOLLOWS AND BE ALERT TO THE POSSIBILITY OF PERSONAL INJURIES.



ATTENTION

- *Read the instructions manual carefully to learn about the recommended security practices.*



ATTENTION

- *Only begin operating the tractor, when you are properly installed and with the seatbelt buckled.*



ATTENTION

- *Do not carry passengers on the tractor and not inside or on the equipment.*



ATTENTION

- *There are risks of serious injuries in case of overturning when working on slopes.*
- *Do not use excessive speed.*



SAFETY RULES



ATTENTION

- Do not operate the tractor if the front has no enough ballast to balance the rear equipment.
- With a tendency to lift, add weights or ballast in the front of the tractor or on the front wheels.



ATTENTION

- Before performing any maintenance on your equipment, make sure it is properly stopped.
- Avoid getting hit.



ATTENTION

- Keep yourself away from the active elements of the machine (Discs), they are sharp and can cause accidents.
- When carrying any service on the discs, use safety gloves on your hands.



ATTENTION

- When looking for a possible leak on the hoses, use a piece of cardboard or wood, never use your hands.
- Avoid fluid incision on the skin.

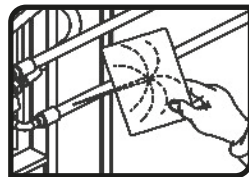

SAFETY RULES



ATTENTION

- Do not operate the ASDA Multi, if the transmission protection is not properly installed.
- Only remove the protection to change gears, replace it immediately.
- Do not make adjustments when the ASDA Multi is in motion.

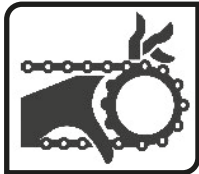

ATTENTION

- When operating the ASDA Multi, do not allow people to remain on the machine.
- Do not stand on the platform when the ASDA Multi is in motion.



ATTENTION

- The hydraulic oil works under pressure and can cause serious injuries, if there are any leaks. Periodically check the hoses conditions. If there is evidence of leaks replace immediately.
- Before connecting or disconnecting the hydraulic hoses relieve the system pressure, triggering the command with the tractor turned off.











ATTENTION

- When transporting this equipment do not exceed the speed of 16km/h or 10 MPH, avoiding risk of damage and accidents.









WARNINGS

- 01-  When operating the implement, do not allow people to stay close to it or on it.
- 02-  When performing any discs assembly and disassembly service, use gloves to protect your hands.
- 03-  Before connecting or disconnecting hydraulic hoses, relieve the system pressure triggering the command with the tractor turned off.
- 04-  Periodically check the hydraulic hoses conditions. If there is evidence of oil leaks, immediately replace the hose because the oil works under high pressure and can cause serious accidents.
- 05-  Do not wear loose clothing as they can curl up on the implement.
- 06-  When you turn the tractor engine on, be properly seated on the operator's seat and be sure that you have full aware about the proper and safe handling for both the tractor and the implement. Always place the gearshift lever on the neutral position, turn off the command gear of the energy plug and put the hydraulic commands on the neutral position.
- 07-  Do not turn on the tractor engine indoors without a proper ventilation, because the exhaust gases are harmful to health.
- 08-  When maneuvering the tractor for the implement coupling, make sure that you have the necessary space and that no one is close to it, always maneuvering at slow speed and be prepared to brake at any emergency.
- 09-  Do not make adjustments with the implement in operation.



WARNINGS

- 10-  When working on slopes, be careful always looking to maintain the necessary stability. In case of early unbalance reduce the acceleration, turn the wheels toward the slope side of the land and never lift the implement.
- 11-  Always drive the tractor at speeds compatible with safety, especially when working on uneven lands or slopes, keep the tractor always engaged.
- 12-  When driving the tractor on roads, keep the brake pedals interconnected.
- 13-  Do not operate the tractor with a lightweight front. If the front has a tendency to lift, add more weight on the front or on the front wheels.
- 14-  When leaving the tractor place the gearshift lever in neutral position and apply the parking brake. Never leave the implements coupled to the tractor in the hydraulic system raised position.
- 15-  Alcoholic beverages and some medications can cause a loss of reflexes and change the operator physical conditions. Therefore, never operate this equipment when using these substances.
- 16-  Read or explain all the above procedures to the user who cannot read.

*If case of doubt, ask the After-sales.
Telephone: 0800-152577 / E-mail: posvenda@baldan.com.br*



COMPONENTS

ASDA MULTI - SUBSOILER PLOW WITH AUTOMATIC SHANK

- 01 - Coupling shackle
- 02 - Coupling header
- 03 - Header regulator
- 04 - Complete cutting disc
- 05 - Hydraulic cylinder
- 06 - Roller harrow fixing bracket
- 07 - Roller harrow oscillation bar
- 08 - Roller harrow
- 09 - Tank protective cover
- 10 - Hydraulic engine
- 11 - Complete wheel
- 12 - Wheel articulation support
- 13 - Rod with complete automatic disarming
- 14 - Frame
- 15 - Hydraulic hoses support

- 16 - Tank
- 17 - Platform
- 18 - Ladder
- 19 - Platform Handrail
- 20 - Manual Container
- 21 - Hydraulic hoses

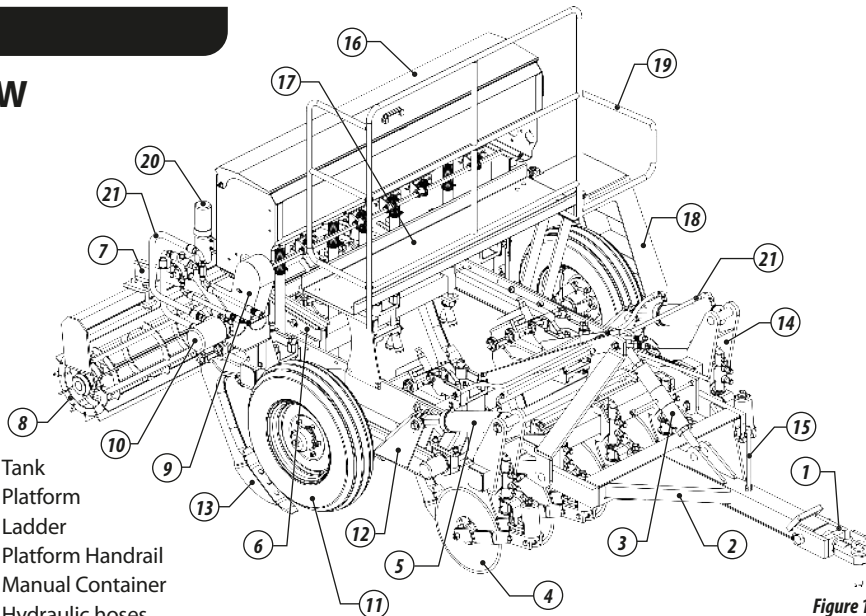
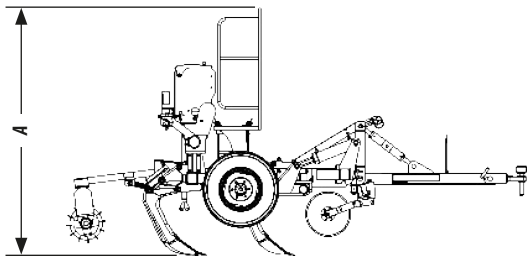

Figure 1



DIMENSIONS

ASDA MULTI 5 / 7 / 9 RODS



Figures 02

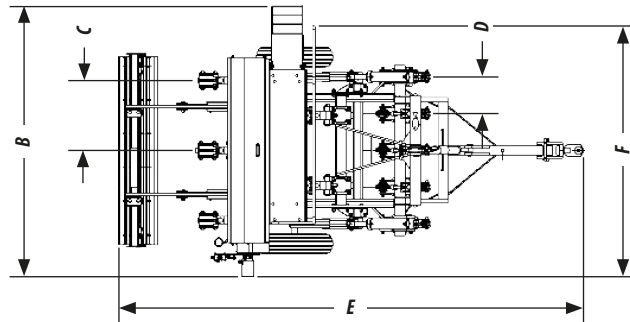

Model	Nr of Rods	Measurement					
		A (mm)	B (mm)	C (mm)	D (mm)	E (mm)	F (mm)
ASDA Multi	5	2560	2730	750	375	4695	2533
	7	2560	3462	750	375	4695	3265
	9	2560	4196	750	375	4695	3999



TECHNICAL SPECIFICATIONS





Model	Nr of Rods	Nr of Discs	Disc Diameter (ø)	Tank Capacity	Working Width (mm)	Approximate Weight (kg)	Working Depth (mm)	Spacing between Rods (mm)	Tractor Power (HP)
				Seed / Fertilizer (lts)					
ASDA Multi	5	5	18"	365	1875	1944	450	375	120
	7	7	18"	365	2625	2542	450	375	140
	9	9	18"	470	3375	3005	450	375	180

BALDAN reserves the right to change and or improve the technical characteristics of its products without notice and without the obligation to do so with the products previously manufactured. The technical specifications are approximate and informed in normal working conditions.

Table 01

ASSEMBLY

- The ASDA Multi subsoiler leaves the factory disassembled. To assemble it, follow the instructions below:

- 1 -  Before beginning the assembly of the ASDA Multi, look for a good place that facilitates the identification of the parts and their assembly.
- 2 -  When carrying out any assembly and disassembly service on the discs, use gloves in your hands.
- 3 -  Do not wear loose clothing, as they may get caught in the equipment.
- 4 -  To assemble ASDA Multi, place the chassis on 2 (two) trestles at least 850 mm high.



ASSEMBLY

COUPLING HEADER ASSEMBLY

- To assemble the coupling header (1), proceed as follows:
01 - Couple the coupling header (1) on the frame (2) using the pins (3), flat washers (4) and cotter pin (5).
02 - Then, introduce the regulator (6) inside the frame (2) fixing it with the pins (7), flat washers (8) and lock-ring (9).
03 - Then, introduce the regulator (6) inside the header (1) fixing it with the pins (10), flat washers (11) and lock-ring (12).

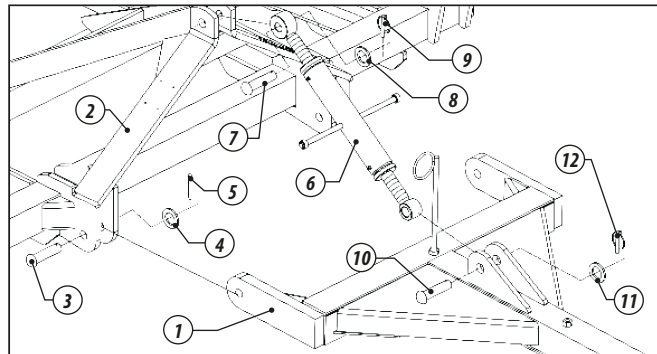

Figure 03



ASSEMBLY

WHEEL SHAFT ASSEMBLY

- To assemble the wheel shaft (1), proceed as follows:
 - 01 - Put the bracket (2) on the chassis (3) and fix it using the screws (4), washers (5) and nuts (6).
 - 02 - Then, install the bearing (7) on the wheel shaft (1) and fix it on the chassis (3) using the screws (8), spring washers (9) and nuts (10).

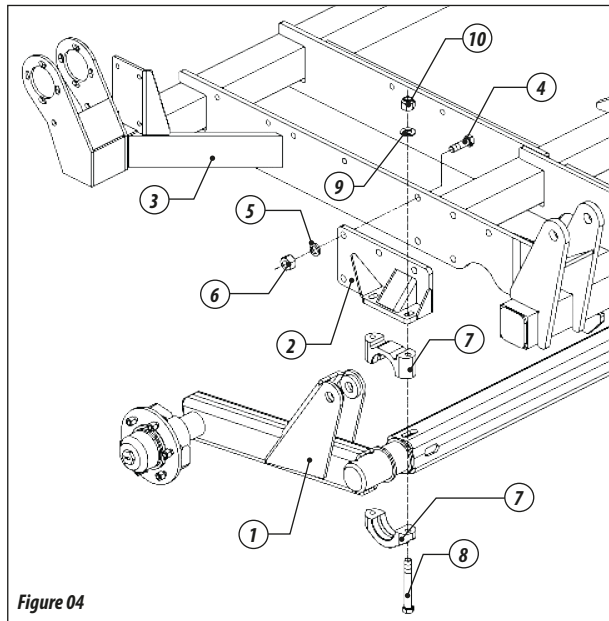

Figure 04



ASSEMBLY

TIRES INSTALLATION

- To install the tires (1), proceed as follows:
- 01 - Install the tire (1) on the wheel shaft (2) using the screws (3) and nuts (4).

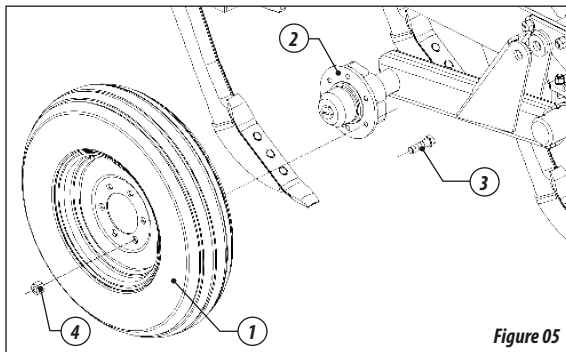

RODS ASSEMBLY

- To assemble the rods (1), proceed as follows:
- 01 - Place the rods (1) on the frame (2) fixing them with the screws (3), spring washers (4) and nuts (5).

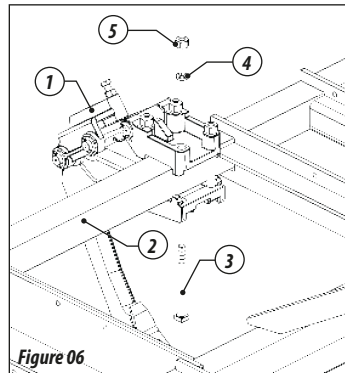

ASSEMBLY

RODS ASSEMBLY

02 - The following figures show the correct assembly for each subsoiler model.

03 - The rods are mounted in odd numbers, therefore, start assembling the central rod, and then assemble the others at the desired spacing.

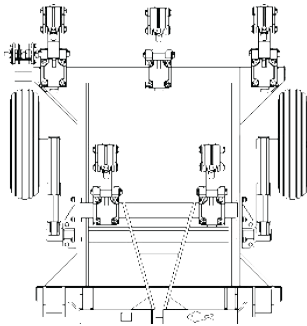

ASDA Multi 5 Rods

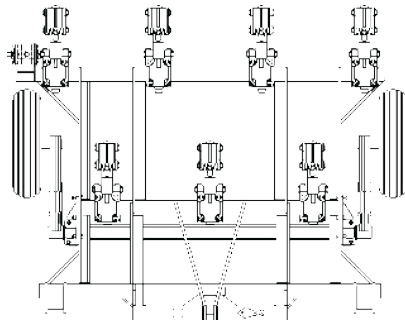

ASDA Multi 7 Rods

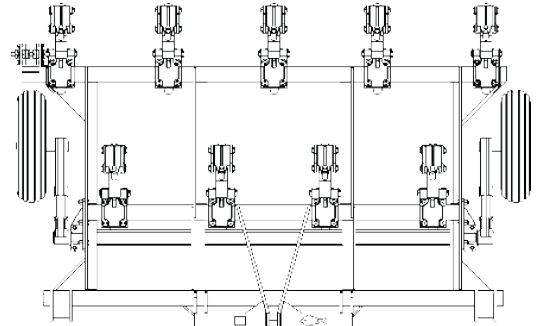

ASDA Multi 9 Rods

Figures 07



ASSEMBLY

PLATFORMS ASSEMBLY

- To assemble the platform (1), proceed as follows:

01 - Place the platform (1) on the chassis (2), fixing it with the screws (3), spring washers (4) and nuts (5).

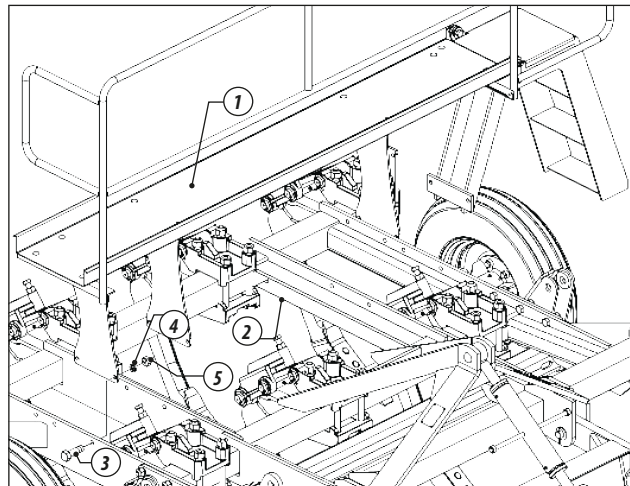

Figure 08



ASSEMBLY

ROLLER HARROW ASSEMBLY

- To assemble the roller harrow (1), proceed as follows:

- 01- Place the support (2) on the chassis (3) fixing through the plate (4), lock washers (5) and nuts (6).
- 02- Then, insert the swing bar (7) between the support (2) and lock with the pin (8), flat washer (9) and cotter pin (10).
- 03- Then, fix the removal roller (1) on the swing bar (7) using the screws (11), plate (12), lock washers (13) and nuts (14).
- 04- Finally, place the spring (15) between the swing bar (7) and the support (2) fixing through the pins (16), flat washers (17) and cotter pins (18).

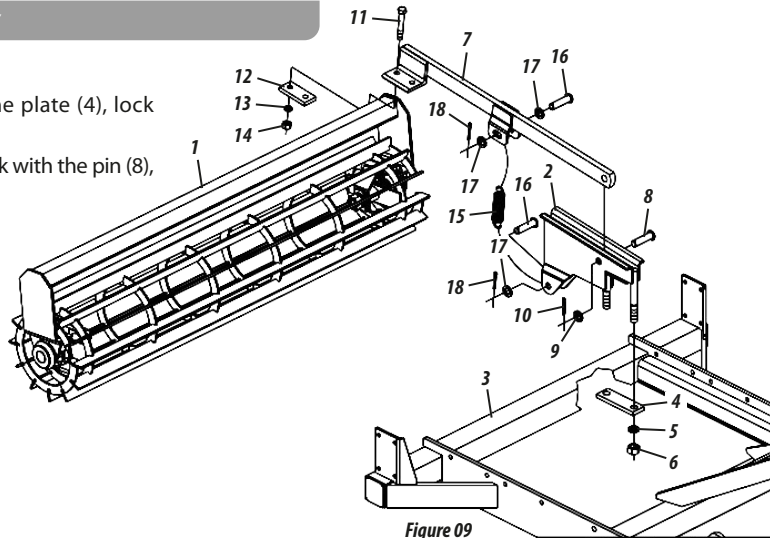

Figure 09



ASSEMBLY

TANK ASSEMBLY

- To assemble the tank (1), proceed as follows:

- 01- Fix the brackets (2 and 3) on the chassis (4), using the screws (5), lock washers (6) and nuts (7).
- 02- Then, place the tank (1) on the supports (2 and 3), fixing it using the screws (8), flat washers (9), lock washers (10) and nuts (11).
- 03- Then, place the chain (12) on the gears in the support (2) and in the tank (1).
- 04- Then, place the protective cover (13), fixing it on the support (2) using the screws (14), flat washers (15), lock washers (16) and nuts (17).
- 05- Finish by attaching the hydraulic hoses (18 and 19) to the oil flow regulating valve (20).

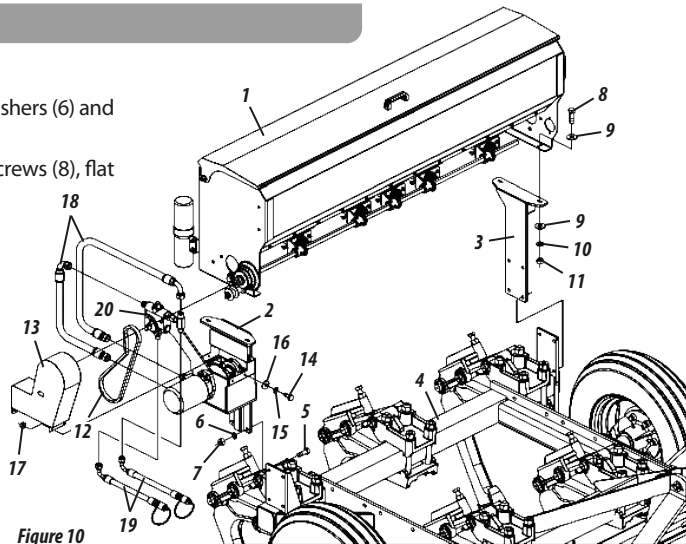

Figure 10

ASSEMBLY

CUTTING DISCS ASSEMBLY

- To assemble the cutting discs (1), proceed as follows:

01 - Install the cutting discs (1) on the chassis (2) using the clamps (3), screws (4), spring washers (5) and nuts (6).

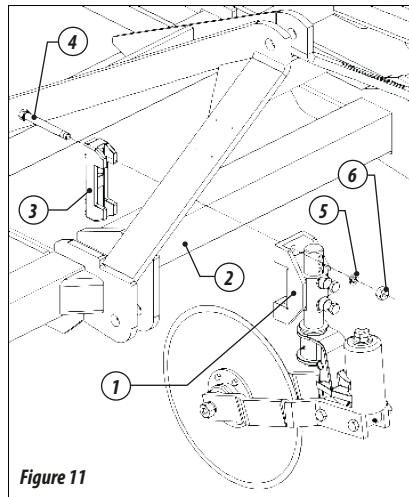

Figure 11



ATTENTION

The cutting discs (1) must be assembled in alignment with the rods.

HYDRAULIC CYLINDERS INSTALLATION

- 01 - To install the hydraulic cylinders (1), proceed as follows:
- 02 - Fix the hydraulic cylinders bases (1) on the chassis (2) with the pins (3), flat washers (4) and cotter pins (5).
- 03 - Then, fix the hydraulic cylinders rods (1) on the wheel support (6) with the pins (7), flat washers (8) and cotter pins (9).

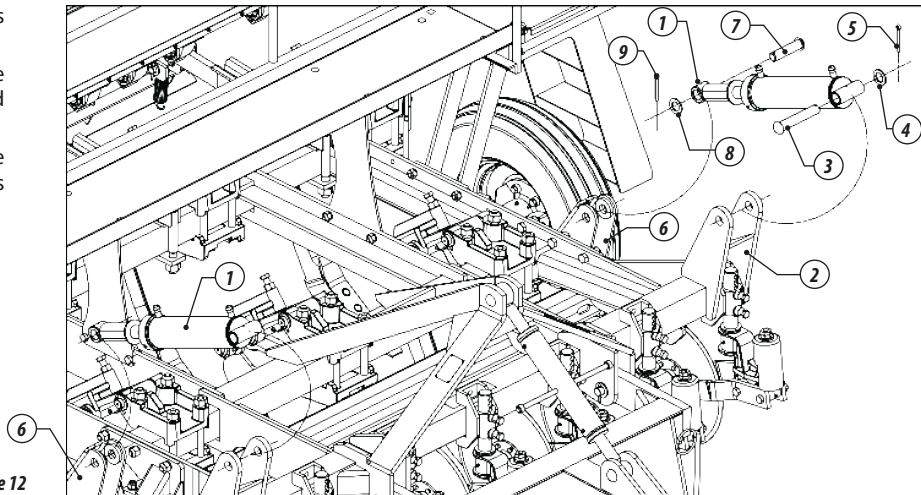

Figure 12

ASSEMBLY

HYDRAULIC SYSTEM INSTALLATION

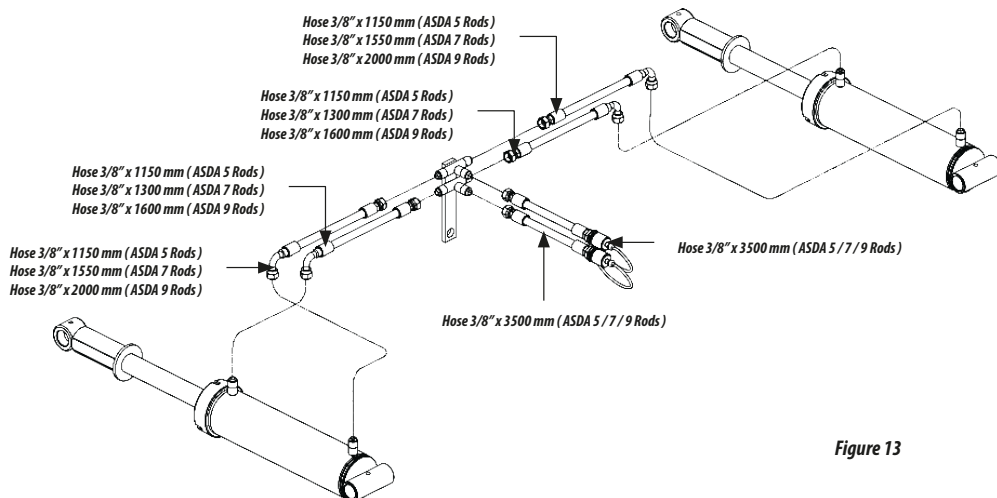
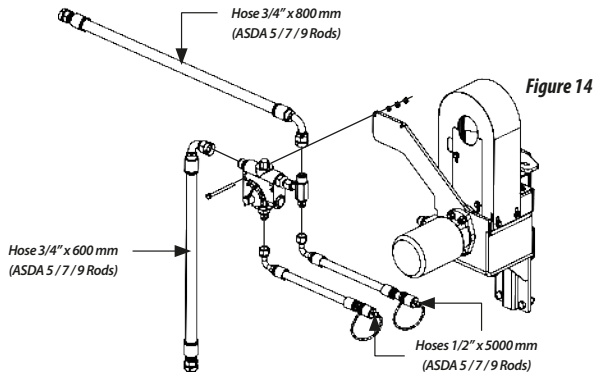

Figure 13

ASSEMBLY

ASSEMBLY OF THE HYDRAULIC TRANSMISSION SYSTEM SEED SYSTEM



ASSEMBLY OF THE HYDRAULIC TRANSMISSION SYSTEM FERTILIZING SYSTEM

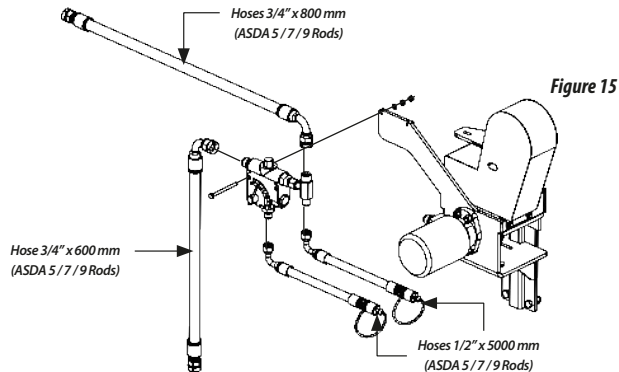

ATTENTION

When you finish assembling the hydraulic system, make a general overhaul on the ASDA Multi, checking that there are no objects (nuts, bolts or others) inside the tank. Retighten all bolts and nuts, check all pins, cotter pins and locks, check all hoses.



COUPLING

COUPLING OF THE SUBSOILER TO THE TRACTOR DRAWBAR

- To couple the ASDA Multi to the tractor drawbar, follow the instructions below:
 - 01 - Before coupling the ASDA Multi, find a safe place and easy to access.
 - 02 - Always use low gear with low acceleration.
 - 03 - Before connecting and disconnecting the hydraulic hoses, stop the engine and relieve the circuit pressure, fully triggering the control levers.
 - 04 - Make sure that, when you relieve the system pressure, nobody can be harmed by the equipment motion.
- According to the following instructions, proceed as follows:
 - 05 - Level the ASDA multi coupling header (1) in relation to the tractor coupler using the regulator (2). Then, slowly move in reverse the tractor to the ASDA Multi, paying attention to the brakes application.
 - 06 - Couple the ASDA Multi to the tractor fixing it with the coupling pin (3) and lock-ring (4).
 - 07 - Finally, couple the hoses (5) on the tractor quick coupling.

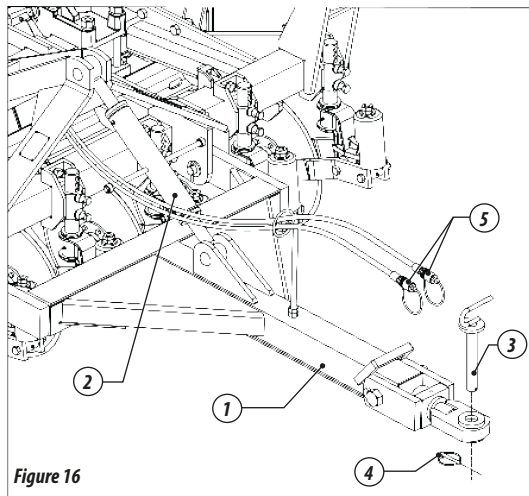

Figure 16



COUPLING

SUBSOILER LEVELING

- To level the ASDA Multi, proceed as follows:
01 - First, the tractor must be on leveled ground.
02 - Then, level the ASDA Multi using the regulator (1).

Figure 17

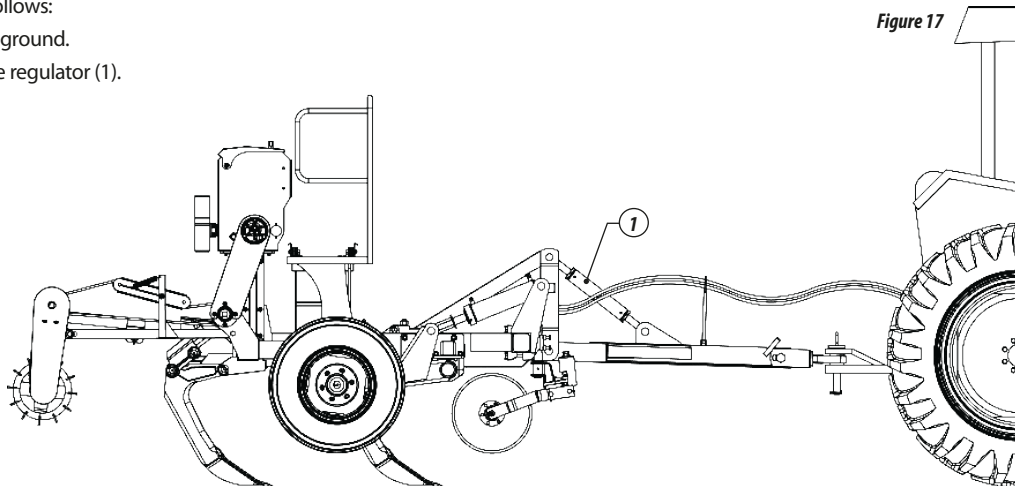

ATTENTION

Los flejes deben estar paralelos al suelo, es decir, todos deben tocar el mismo plano.

LADDER

USE OF LADDER

- The articulated ladder (1) should only be used when filling or maintaining the ASDA MULTI tank. Before using the articulated ladder (1), make sure that the subsoiler is stopped and the tractor is switched off.



ATTENTION

*Do not stay on the ladder when the subsoiler is working or being transported.
Do not work or transport the subsoiler with the ladder open.
Do not transport people on the platform, ladder or any other part of the subsoiler. Ignoring these warnings could result in serious accidents or even death.*



IMPORTANT

The articulated ladder (1) should only be used when filling or maintaining the tanks. The articulated ladder (1) complies with NBR standards.

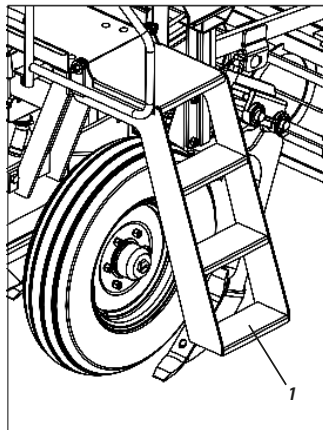

OPEN POSITION: FOR MAINTENANCE OR FILLING THE TANK.

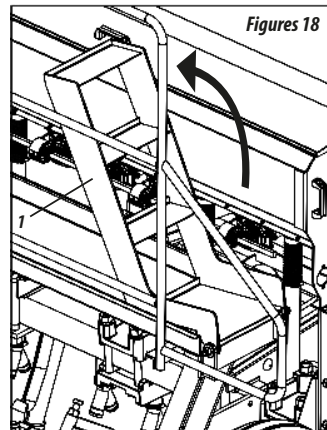

CLOSED POSITION: FOR WORK OR TRANSPORT.



ADJUSTMENTS

ADJUSTMENT FOR TRANSPORT

- Before transporting the ASDA Multi, proceed as follows:
01 - Perform the total stroke of the hydraulic cylinder (1), put the latch (2) and fix it with the pin (3) and lock (4).

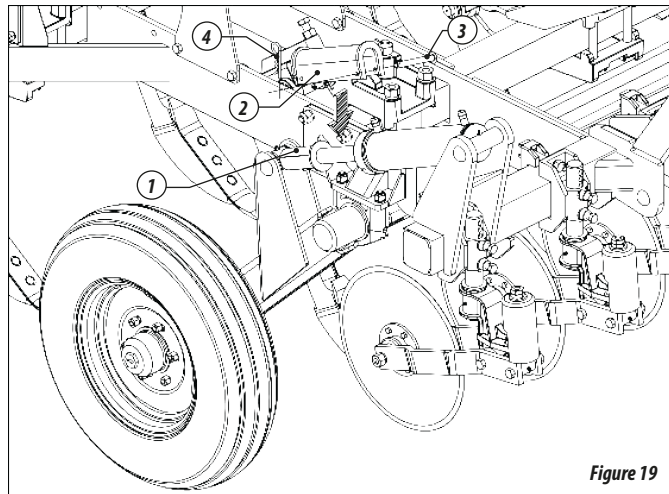

Figure 19



ATTENTION

After finishing the ASDA Multi transport, remove the lock (2) from the hydraulic cylinder (1).

ADJUSTMENTS

DEPTH ADJUSTMENT

- The rods working depth (1) is limited by the wheels (2) which are driven by hydraulic cylinders (3). To limit the rods working depth (1), proceed as follows:

- 01 - First, determine the rods working depth (1).
- 02 - Then, raise the wheels (2) with the hydraulic cylinder (3) up to the determined distance; place the limiter rings (4) on the hydraulic cylinders rods (3).



ATTENTION

The limiter rings (3) supplied with the ASDA Multi, have different sizes, and if combined they allow several depth adjustments.



NOTE

After adjustment, the depth will be constant, because the limiter rings (3) are limiting the hydraulic cylinder stroke, preventing the wheels oscillation, always maintaining the same depth.

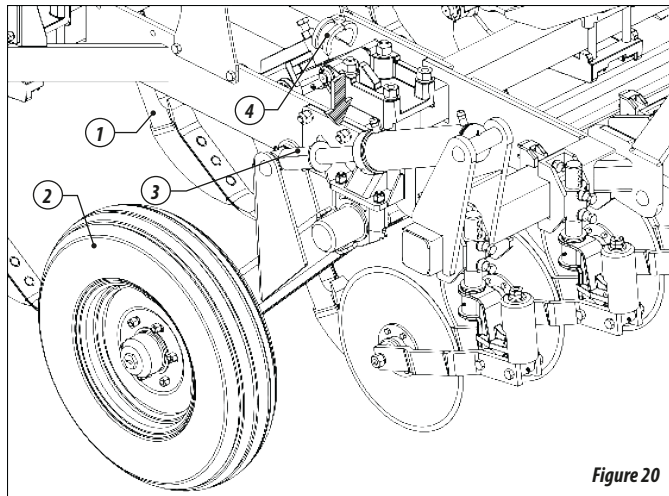

Figure 20



ADJUSTMENTS

ROD AUTOMATIC DISARM LOAD ADJUSTMENT

- The rods automatic disarming (1), leaves the factory with the determined preload adjustment. To decrease or increase the load, proceed as follows:

Turning the screw (2), 90° (1/4 turn) to the right (clockwise).

Decrease 5kg of the disarming load.

Turning the screw (2), 90° (1/4 turn) to the left (counterclockwise).

Increase 5kg to the disarming load.



NOTE

Always perform a load adjustment of 1/4 turn, i.e., every 5 kg up to stop the disarming.



ATTENTION

Reduce or increase the load only if the rod is disarming all the time.

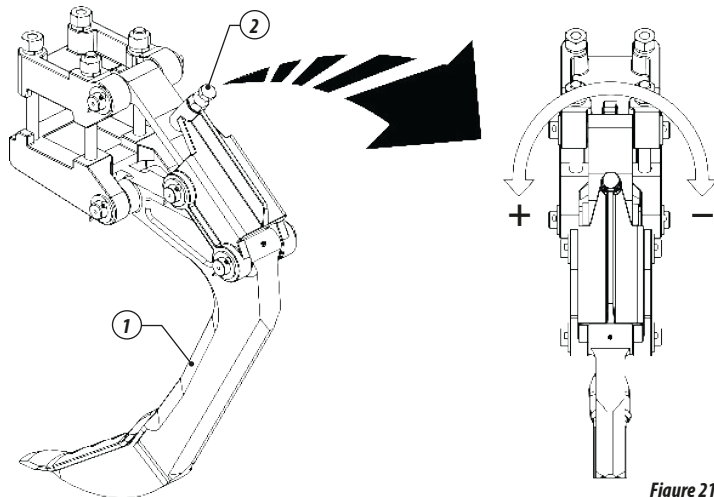

Figure 21

ADJUSTMENTS

CUTTING DISC DEPTH ADJUSTMENT

- To adjust the cutting disc depth (1), proceed as follows:

01 - Loosen the screws (2) and slide the shaft (3) to the desired adjustment.

02 - Then, retighten the screws (2).

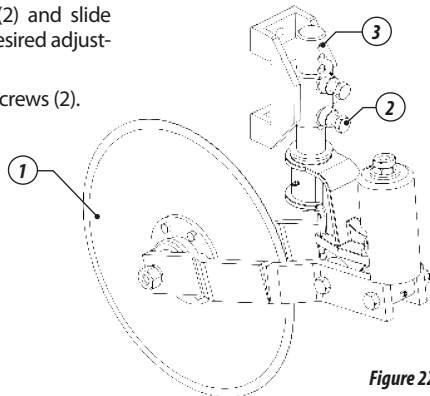

Figure 22



ATTENTION

The cutting disc depth and pressure adjustment (1) will be done in the field before starting the works, paying attention to the type of soil to be worked, to get a better performance of the ASDA Multi.

CUTTING DISC PRESSURE ADJUSTMENT

- To adjust the cutting disc pressure (1), proceed as follows:

Turn the nut (2) clockwise.

For higher pressure of the spring (3).

Turn the nut (2) counterclockwise.

For lower-pressure of the spring (3).



ATTENTION

When you adjust the cutting disc pressure, pay attention not to cancel its joint action.

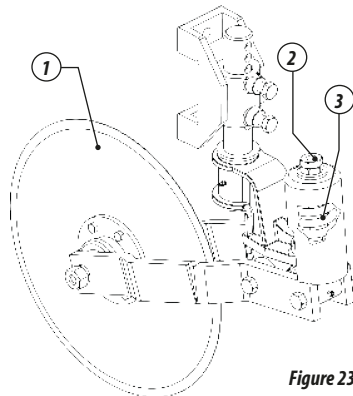

Figure 23

SEED DISTRIBUTION

SEED DISTRIBUTION REGULATION

- To adjust the seed distribution, proceed as follows:

- 01 - First, unlock the steering wheel (1) through the lock (2).
- 02 - Then, turn the handwheel (1) in the "A" or "B" direction, adjusting the seed distribution using the graduated scale (3) fixed on the shaft (4), according to your need and working condition.
- 03 - At the end of the adjustment, lock the handwheel (1) again through the lock (2).

Figuras 24

Turning the steering wheel in the "A" direction.

Scale closes

Turning the steering wheel in the "B" direction.

The scale opens



ATTENTION

*Do not work with the steering wheel (1) unlocked.
Ignoring this warning can cause variation in the distribution
of fertilizer or seed.*

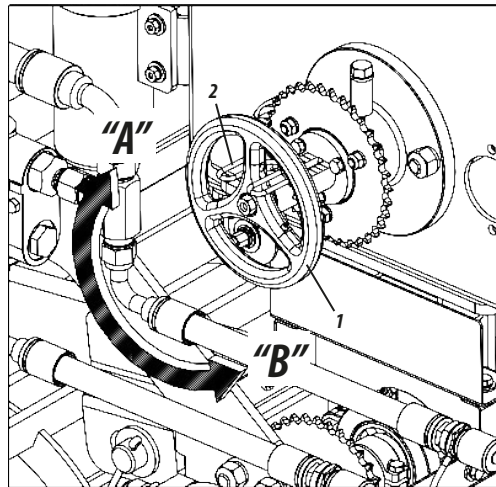
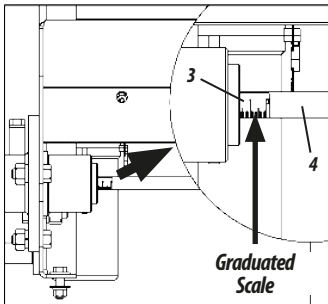

SEED DISTRIBUTION

SEED DISTRIBUTION BOX ADJUSTMENT

- To avoid breakage of the seeds or an irregular sowing, adjust the seed distribution box (1), for this, proceed as follows:

01 - Release the latch (2) and set it to the holes (1, 2 and 3) according to the size of each type of seed to be used.

ATTENTION

Before you start planting, always check the seed distribution box adjustment (1).

NOTE

Do not press the seed because it may break. The seed must fall freely.

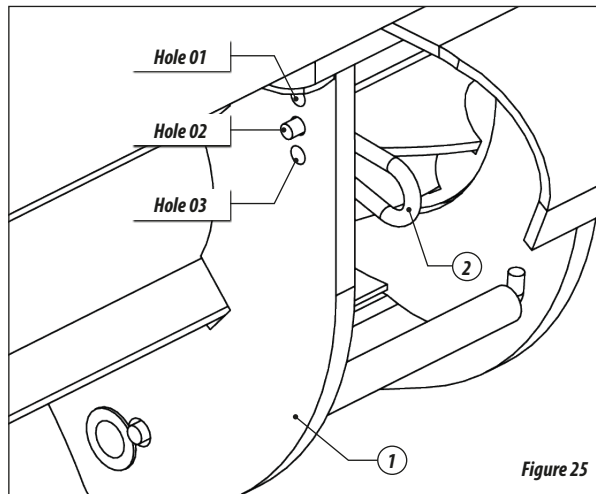
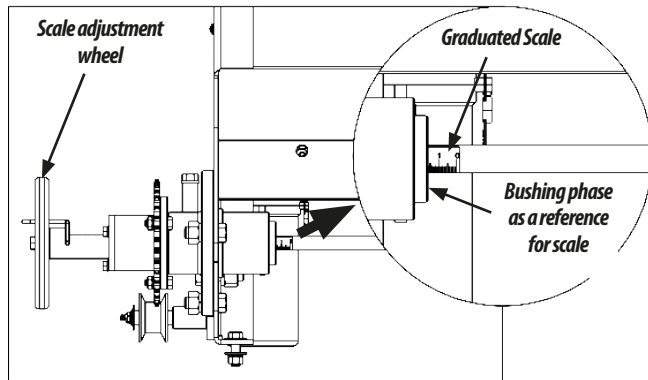

Figure 25

SEED DISTRIBUTION

SEED ADJUSTMENT WITH HYDRAULIC MOTOR



Rotor opening positions: The rotor opens every 1 mm according to the graduated scale fixed on the axis indicated by the arrow. Use the face of the bushing with reference for orientation of the scale. At mark 0, the rotor is completely closed.

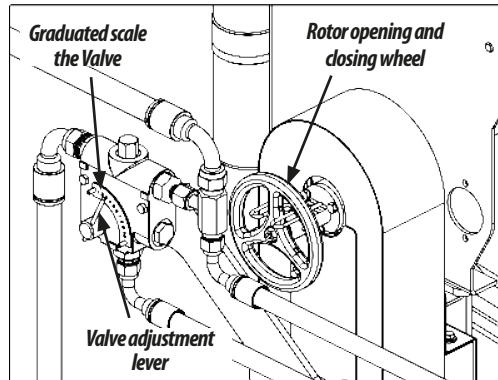

Figures 26

Details of the valve adjustment lever and scale.



SEED DISTRIBUTION

PRACTICAL CALCULATION FOR SEED DISTRIBUTION

- 01- Determine the spacing between stems and the amount of seed to be distributed per bushel (Aa) or hectare (Ha).
- 02- **Example:** ASDA Multi with a spacing of 375 mm, to play 5 kg of Colonion per Ha, use the formula below:

Formula Data:

E = Spacing between rods (mm)

Q = Amount of seed to be distributed [kg]

A = Area to be planted [m²]

D = 50 meters distance (test)

X = Seed grams at 50 meters

Formula:
$$X = \frac{E \times Q \times D}{A}$$

Solve:
$$X = \frac{375 \times 5 \times 50}{10.0000}$$

$$X = 0.18 \times 50 = 9,3$$

$$X = 9,3 \text{ grams at 50 meters per rod}$$

Conclusion: The valve has high sensitivity in flow regulation, so, as an example, using the same calculation above to distribute Colonião, the seed distribution table on the following page does not indicate 9.3 grams, however observing the Colonion line, note- this value of 9.3 grams is between 14 and 15 mm from the graduated scale of the axis. For these cases, it is advisable to keep the valve lever in position 2 and slowly turn the handwheel so that the graduated scale is located in the measured position, between 14 and 15 mm, that is, approximately 14.5 mm. Then, perform the test collection in the 50m to confirm that the 9.3 grams calculated using the formula on the previous page fell.



SEED DISTRIBUTION

SEED DISTRIBUTION TABLE

	ESTIMATE AMOUNT OF GRAMS PER ROD AT 50 METERS (SPEED 6Km/h)																			
	Crop Types	Combinations	Scale in 1mm	Scale in 2mm	Scale in 3mm	Scale in 4mm	Scale in 5mm	Scale in 6mm	Scale in 7mm	Scale in 8mm	Scale in 9mm	Scale in 10mm	Scale in 11mm	Scale in 12mm	Scale in 13mm	Scale in 14mm	Scale in 15mm	Scale in 16mm	Scale in 17mm	Scale in 18mm
Gramineae	Green panic grass	Valve Position 2	0,58	1,16	1,74	2,31	2,89	3,89	4,38	4,95	5,71	6,48	7,13	7,77	8,42	9,1	9,72	10,36	11,01	11,66
	Common Brachiara	Valve Position 2	2,90	5,78	8,68	11,57	14,47	19,45	21,88	24,75	28,53	32,38	35,62	38,86	42,10	45,33	48,57	51,81	55,05	58,29
	Brachiara Brizantha	Valve Position 2	1,74	3,47	5,21	6,94	8,68	11,67	13,13	14,85	17,12	19,43	21,37	23,32	25,26	27,20	29,15	31,09	33,03	34,97
	Millet	Valve Position 2	4,64	9,25	13,89	18,51	23,15	31,12	35,01	39,60	45,65	51,81	56,99	62,17	67,36	72,54	77,72	82,90	88,08	93,26
Leguminosae	Perennial Soybean	Valve Position 2	1,43	2,85	4,29	5,71	7,14	9,60	10,80	12,22	14,08	15,98	17,58	19,18	20,78	22,38	23,97	25,57	27,17	28,77
	Alfafa	Valve Position 2	1,64	3,26	4,90	6,52	8,16	10,97	12,34	13,96	16,09	18,27	20,09	21,92	23,75	25,57	27,40	29,23	31,05	32,88
	Bird's-foot Trefoil	Valve Position 2	1,84	3,67	5,51	7,34	9,18	12,34	13,89	15,71	18,11	20,55	22,61	24,66	26,72	28,77	30,83	32,88	34,94	36,99
	Desmodium	Valve Position 2	1,55	3,10	4,65	6,20	7,75	10,42	11,73	13,26	15,29	17,35	19,09	20,82	22,56	24,29	26,03	27,77	29,50	31,24
	Clover	Valve Position 2	1,47	2,94	4,41	5,87	7,34	9,87	11,11	12,57	14,49	16,44	18,08	19,73	21,37	23,02	24,66	26,31	27,95	29,59

Table 02



FERTILIZER DISTRIBUTION

FERTILIZER GUIDE - FERTILIZATION SYSTEM

- 01 - To guide the fertilizer from the distribution box to the soil, connect the hoses (1) on the fertilizer distribution connectors (2) using the clamps (3).
- 02 - Then, connect the hose (4) on the hose (1) using the clamps (5).
- 03 - Finally, connect the Y connector (6) on the hose (4) using the clamps (7).

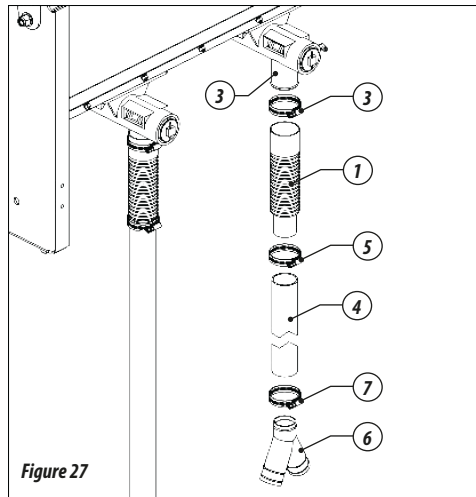

FERTILIZER DISTRIBUTION

FERTILIZER CONDUCTOR - FERTILIZATION SYSTEM

- 01 - The independent distribution system has safety outputs that ensure the proper operation of the system without damaging it. In case of hose and dispenser clogging, clean the dispenser up to the end of the hose near the rod, as the system clogging may occur due to roots, plastic pieces and other objects.



ATTENTION

*Daily check the distributors and the hoses, and clean their outputs.
When the fertilizer contains impurities or is moist, clean more often.*

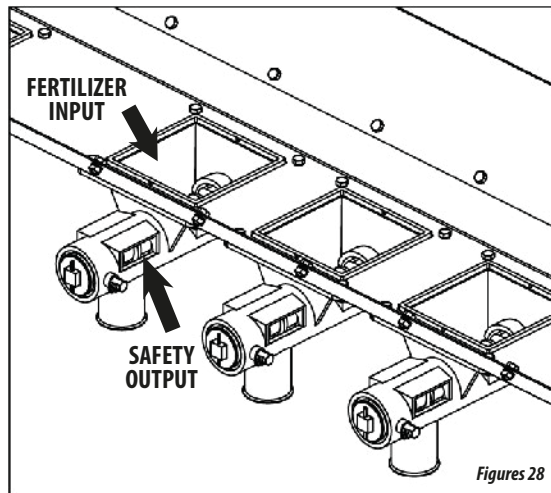

FERTILIZER DISTRIBUTION

FERTILIZER ADJUSTMENT WITH HYDRAULIC MOTOR

- The adjustment of the fertilizer must be done through the oil flow regulation valve (1), with the tractor stopped, but at the same working speed. Collect the fertilizer during the timed time to cover 50 or 100 meters and calculate according to the example on the following page.



IMPORTANT

*Wait a few seconds before starting to compost the fertilizer so that it completely involves the shaft.
Before starting the test, heat the tractor oil to normal working temperature.*



NOTE

*The variation in the amount of fertilizer is obtained by opening or closing the flow control valve (1).
By opening the flow control valve (1), the hydraulic motor (2) rotates faster, increasing the amount of fertilizer.*

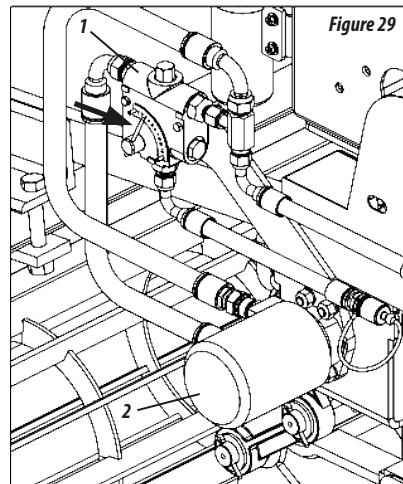

FERTILIZER DISTRIBUTION

PRACTICAL CALCULATION FOR FERTILIZER DISTRIBUTION

01 - Determine the spacing between rods and the amount of fertilizer to be distributed per bushel (Aa) or hectare (Ha).

- *Example: ASDA Multi ASDA Multi with 375 mm spacing, to distribute 550 kg of fertilizer per Ha, use the formula below:*

Formula Data:

E = Spacing between rods (mm)

Q = Quantity of fertilizer to be distributed [kg]

A = Area to be fertilized [m^2]

D = Distance of 50 meters (test)

X = Grams of fertilizer on 50 meters

$$\text{Formula: } X = \frac{E \times Q \times D}{A}$$

$$\text{Solve: } X = \frac{375 \times 550 \times 50}{10.0000}$$

$$X = 20.62 \times 50 = 1031$$

$$X = 1031 \text{ grams on 50 meters per rods}$$

Conclusion: The valve has high sensitivity in the flow regulation, so, in the example above, to distribute 550 Kg of fertilizer per Ha the result of the calculation is 1031 grams. However, the fertilizer distribution table on the following page does not indicate 1031 grams, however, it is noted that this value of 1031 grams is between the position of valve 4 and 4.5. For these cases, it is advisable to move the valve lever slowly in the median position between 4 and 4.5. After that, do the test collection in the 50 m to confirm that the 1031 grams calculated in the formula above fell.



FERTILIZER DISTRIBUTION

FERTILIZER DISTRIBUTION TABLE

<i>Estimate amount of grams per rod at 50 meters (Speed 6 km/h)</i>		
FERTILIZER	Combinations	Approximate Quantity
	Valve Position 2	136
	Valve Position 2,5	248
	Valve Position 3	450
	Valve Position 3,5	655
	Valve Position 4	1004
	Valve Position 4,5	1375
	Valve Position 5	1615

Table 03

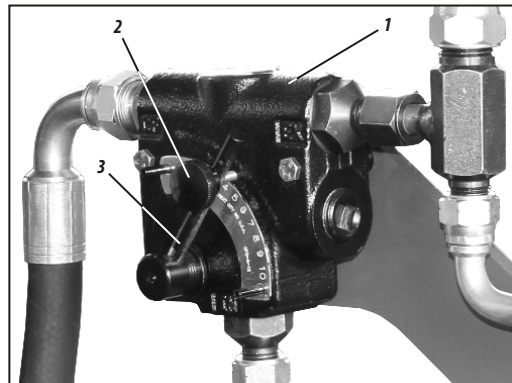

Figure 30



NOTE

To adjust the valve (1), release the handle (2), adjust the lever (3) to the desired position and tighten the handle (2) to lock it.



FERTILIZER DISTRIBUTION

PRACTICAL TEST TO ASSESS THE QUANTITY FERTILIZER AND SEED DISTRIBUTION

- 01 - For greater accuracy of the fertilizer or seed distribution, make the test of the quantity to be distributed on-the planting site, because for each soil there is a special condition.
- 02 - Check and always maintain the ASDA Multi tires calibration.
- 03 - Note the test distance on the table, we opted for 50 linear meters.
- 04 - Fill the ASDA Multi tank, at least, halfway. Drive an average of 10 meters outside the test area for the fertilizer or the seeds ll the dispensers.
- 05 - Seal the outlet of the seed nozzles and place a recipient to collect fertilizer at the outputs. Move the tractor inside the demarcated area, always at the same speed that used for sowing from 5 to 7 Km/h.
- 06 - After covering the demarcated area, remove the seal from the seeds nozzle and collect them for counting and also collect the fertilizer to weight the collected amount. If necessary, increase or reduce the seeds and fertilizer quantities to be distributed, check the table.



IMPORTANT

We suggest performing a practical test of the seeds and fertilizer distribution, over 50 meters, to later compare the results of the fertilizer and the seeds.



OPERATIONS

- The preparation of the tractor will allow you to save time in addition to a better result in field work. The following suggestions may be useful to you.

- 01 - *After the first day of work with ASDA Multi, retighten all screws and nuts, check the condition of the pins, and locks. Then, perform a general tightening of all bolts and nuts every 10 hours of work.*
- 02 - *Adjust the tractor according to the contents of the instruction manual, always using the front and rear weights to stabilize the equipment.*
- 03 - *When using ASDA Multi it is important to check the coupling and cross leveling system to make sure that the rods will have the same depth of penetration into the ground.*
- 04 - *After coupling and leveling, the next adjustments will be made directly in the field of work, analyzing the terrain in its texture, humidity and the types of operations to be done with ASDA Multi.*
- 05 - *Do not transport or work with an overload on the ASDA Multi.*
- 06 - *Only fill the ASDA Multi at the workplace.*
- 07 - *In case of doubt, never operate or handle the ASDA Multi, consult Post Sales.*
- 08 - *Telephone: 0800-152577 or e-mail: posvenda@baldan.com.br*



OPERATIONS

ROD OPERATIONS

- 01 - The subsoiling must be done in relatively dry soils to break the soil compacted layer.
- 02 - This layer is found immediately below the topsoil, i.e., approximately at 10 to 15 cm deep, and this layer thickness ranges from 5 to 15 cm.
- 03 - Check the depth of the soil compacted layer with a penetrometer or a trench and perform the rods working depth adjustment.
- 04 - The rods are equipped with an exclusive automatic disarming system which, in case of obstacles, disarm, returning to the normal working position merely lifting the subsoiler.
- 05 - When operating with the subsoiler, choose a gear that allows the tractor to keep a certain reserve of power that can be used in case of unforeseen eorts.
- 06 - The working speed varies according to the soil conditions.



Figures 31

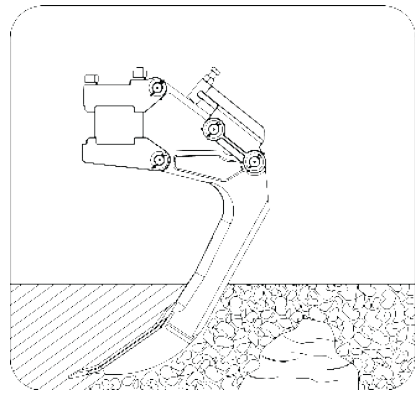
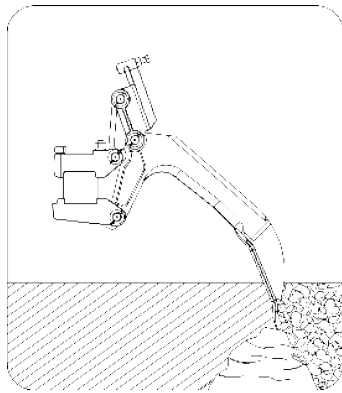
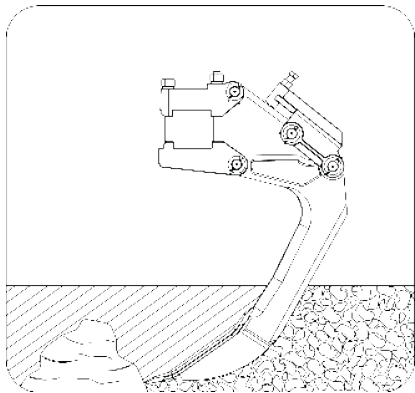

MAINTENANCE

01 - The ASDA Multi was developed to give you the maximum performance whatever are the soils conditions. The experience shows that the periodic maintenance of some parts of the subsoiler is the best way to avoid problems, so we suggest checking.



ATTENTION

*Constantly check the nuts and bolts, if necessary, tighten them.
The general tightening maintenance of the equipment must be done every 8 hours.*



MAINTENANCE

TIRES PRESSURE

- 01 - The tires must always be properly calibrated avoiding premature wear due to excess or lack of pressure.
- 02 - Before calibrating the tires, check the model used on your ASDA Multi and check below the correct calibration.

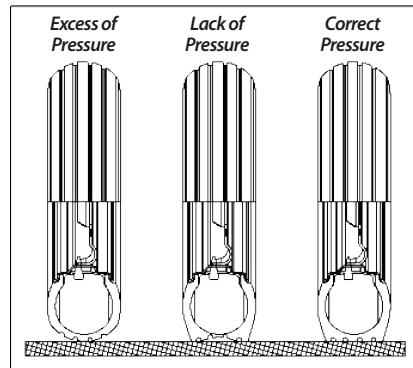

Figures 32

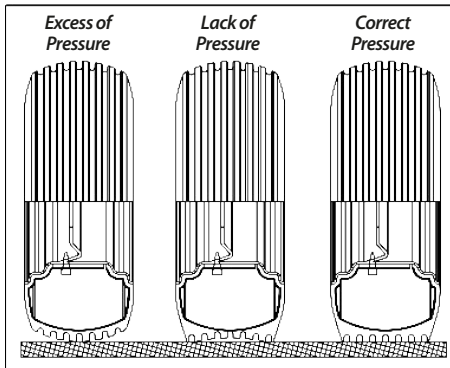

ATTENTION

When you calibrate the tires do not exceed the recommended calibration.



IMPORTANT

When you purchase the subsoiler without tires, we recommend asking the manufacturer about the ideal calibration for the tire model to be used on the subsoiler. The tractor tire pressure calibration must be made according to the one recommended by the manufacturer.

TIRES 750 x 16 (Standard) : **USE 60 lbs/pol².**

TIRES 11x15 (Optional) : **USE 44 lbs / pol².**



MAINTENANCE

LUBRICATION

Table 04

- 01 - Lubrication is essential for a good performance and a longer durability of the subsoiler moving parts, contributing to the maintenance costs reduction.
- 02 - Before starting the operation, carefully lubricate all the grease fittings always respecting the lubrication intervals of the following pages. Pay attention to the lubricant quality, relative to its efficiency and purity, avoiding using products contaminated by water, earth and other agents.

TABLE OF GREASES AND EQUIVALENTS

<i>Manufacturer</i>	<i>Types of recommended grease</i>
<i>Petrobrás</i>	<i>Lubrax GMA 2</i>
<i>Atlantic</i>	<i>Litholine MP 2</i>
<i>Ipiranga</i>	<i>Super Graxa Ipiranga Ipiranga Super Graxa 2 Ipfiflex 2</i>
<i>Castrol</i>	<i>LM 2</i>
<i>Mobil</i>	<i>Mobilgrease MP 77</i>
<i>Texaco</i>	<i>Marfak 2 Agrotex 2</i>
<i>Shell</i>	<i>Retinax A Alvania EP 2</i>
<i>Esso</i>	<i>Multipurpose grease H</i>
<i>Bardahl</i>	<i>Maxlub APG 2 EP</i>



IMPORTANT

If there are equivalent manufacturers and brands which are not listed in the table, consult the manufacturer's technical manual.



MAINTENANCE

LUBRICATE EVERY 10 WORKING HOURS

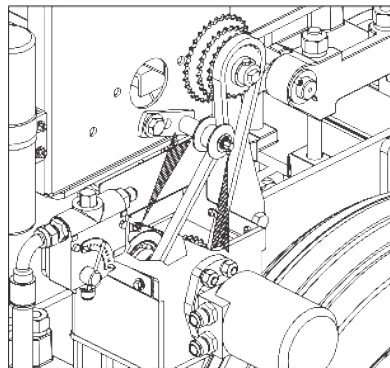
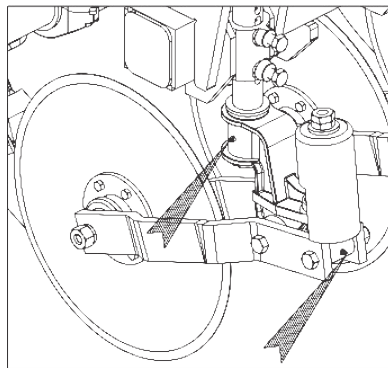
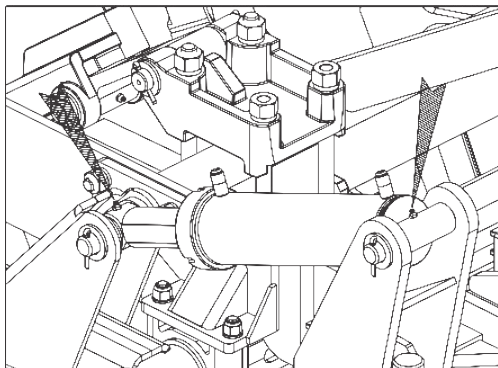

Figures 33



ATTENTION

When lubricating the ASDA Multi, do not exceed the new grease quantity. Use the sufficient quantity.



MAINTENANCE

LUBRICATE EVERY 10 WORKING HOURS

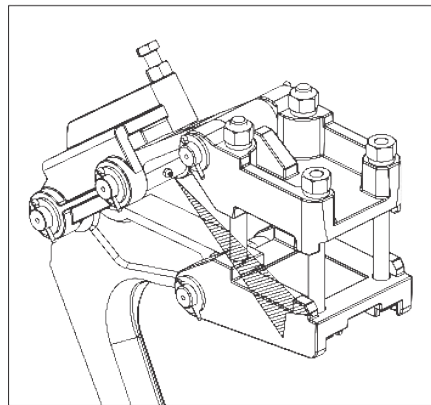
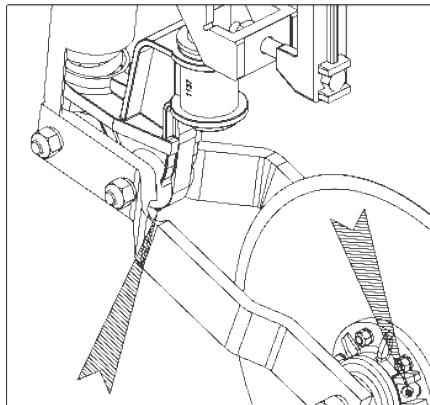
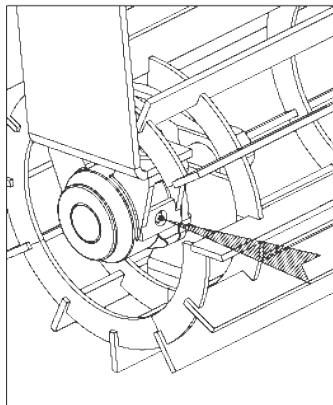

Figures 33



ATTENTION

When lubricating the ASDA Multi, do not exceed the new grease quantity. Use the sufficient quantity.



MAINTENANCE

LUBRICATE EVERY 10 WORKING HOURS

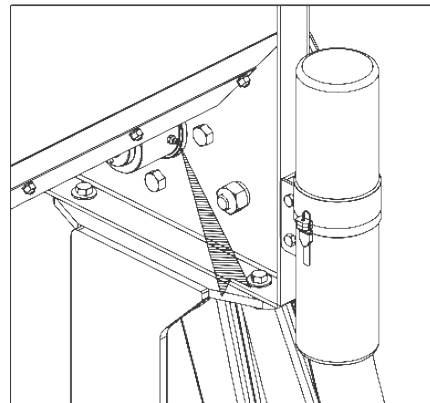
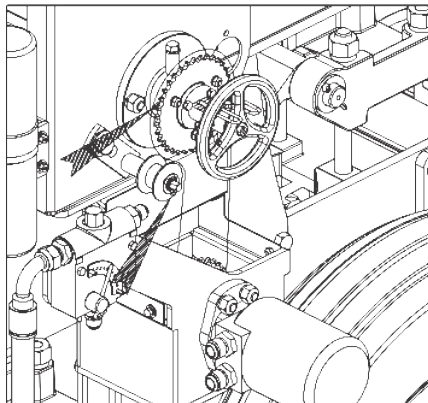
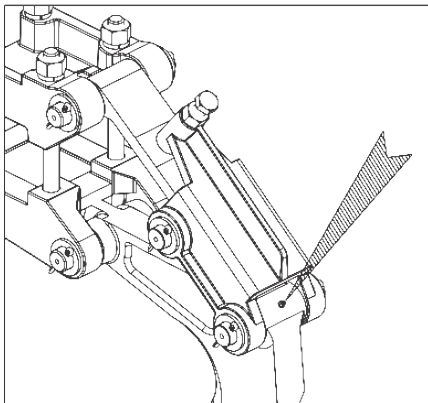

Figures 33



ATTENTION

When lubricating the ASDA Multi, do not exceed the new grease quantity. Use the sucient quantity.



MAINTENANCE

LUBRICATE EVERY 10 WORKING HOURS

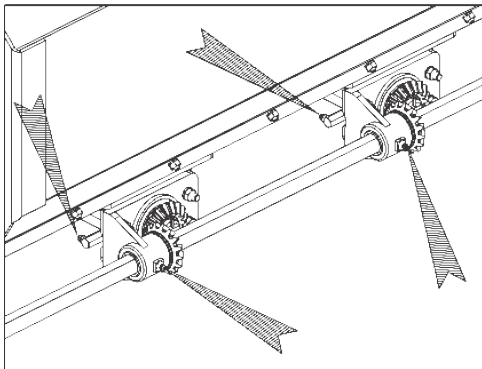

Figures 33

LUBRICATE EVERY 24 WORKING HOURS

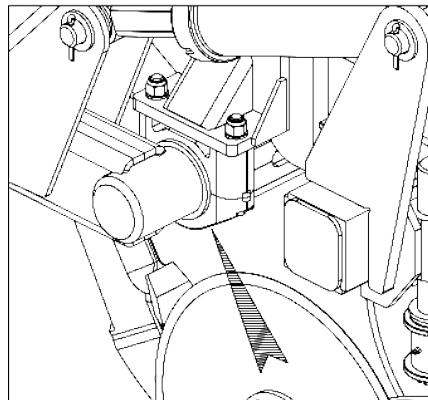

Figure 34



ATTENTION

When lubricating the ASDA Multi, do not exceed the new grease quantity. Use the sucient quantity.



MAINTENANCE

LUBRICATE EVERY 30 WORKING HOURS

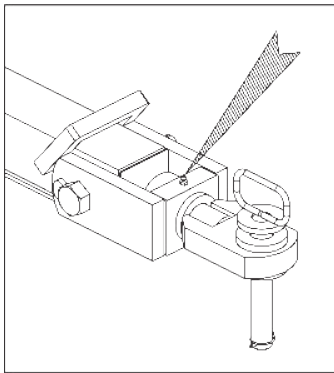
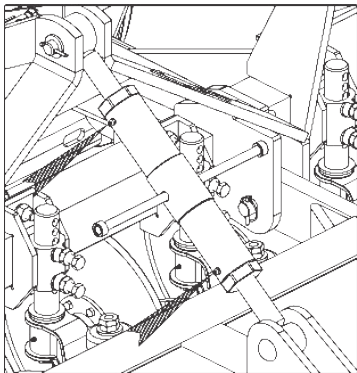

Figures 35

LUBRICATE EVERY 60 WORKING HOURS

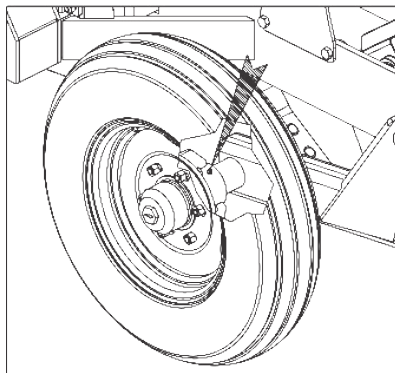

Figure 36



ATTENTION

When lubricating the ASDA Multi, do not exceed the new grease quantity. Use the sufficient quantity.



MAINTENANCE

BEARINGS ADJUSTMENTS

- 01 - When clearances appear on the bearings, proceed as follows to adjust them:
- 02 - Loosen the screws (1) and remove the cover (2) from the bearing (3).
- 03 - Then, remove one or two joints (4) of the bearing cover (3). Reinstall the bearing cover (3) and tighten it.
- 04 - If the clearance persists, you can machine the bearing cover (3) to increase the adjustment, then assemble it on the bearing with the necessary joints quantity.
- 05 - The bearing must turn freely, i.e., with no clearance.



ATTENTION

Do not assemble the bearing without joints (4).

BEARINGS LUBRICATION

- 06 - In the early working days with the ASDA Multi, daily check the bearing oil level, then, check it every 120 hours.
- 07 - The oil change must be done every 1200 working hours. Use oil for transmission 90 API GL4, MIL-L-2105; SAEJ306, may/81; SAE 80W,90 and 140.



IMPORTANT

The optimum oil level is when it reaches the plug hole. To check the bearing oil level, do it on a leveled place.

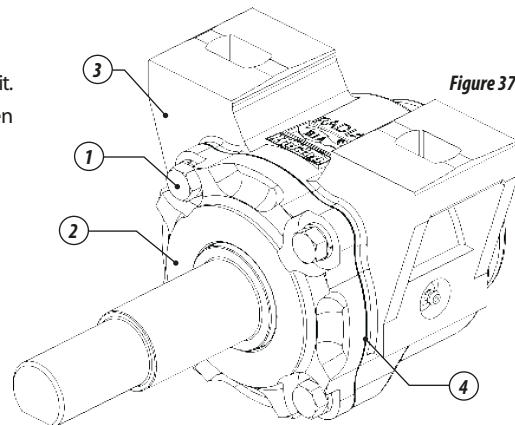

Figure 37

MAINTENANCE

MAINTENANCE OPERATIONAL

PROBLEMS	PROBABLE CAUSES	SOLUTIONS
Leakage in hydraulic hoses.	Lack of sealing material on the thread.	Use thread sealant tape and carefully retighten.
	Insufficient tightening.	Retighten carefully.
Automatic assembly does not disarm.	Improper adjustment on the screw.	Apply correct adjustment to the screw according to page 33.
Quick couplings do not adapt.	Couplings of different types.	Exchange them for males and females of the same type.
Automatic assembly with frequent trip.	Areas with high incidence of obstacles such as: stones, stumps, roots, etc.	Reduce speed and / or avoid these areas.
	Soil with high compaction index.	Reduce speed.
	Tractor power and working speed higher than recommended.	Work within the power and speed limits recommended by the manufacturer.
	Improper adjustment on the screw.	Apply correct adjustment to the screw according to page 33.

Table 05



MAINTENANCE

PRECAUTIONS

- 01 - Before each job, check the condition of all pins, screws, bearings and discs. When necessary, retighten them.
- 02 - The speed of travel must be carefully controlled according to the conditions of the terrain.
- 03 - ASDA Multi models 5/7/9 rods are used in various applications, requiring knowledge and attention during handling.
- 04 - Only local conditions can determine the best way of operating the ASDA Multi.
- 05 - When assembling or disassembling any part of the ASDA Multi, employ suitable methods and tools.
- 06 - Observe the lubrication intervals carefully at the different points of the ASDA Multi.
- 07 - Always check if the parts show wear. If replacement is required, **always require original Baldan parts.**
- 08 - Keep the ASDA Multi tires always inflated.
- 09 - Always keep ASDA Multi discs sharp.



IMPORTANT

Proper and periodic maintenance is necessary to ensure the equipment long life.



MAINTENANCE

GENERAL CLEANING

- 01 - When storing the ASDA Multi, do a general cleaning and wash it thoroughly with water only. Check that the paint has not worn out, if this has happened, apply a general coat, apply protective oil and lubricate the ASDA Multi completely.
- 02 - Fully lubricate the subsoiler. Check all moving parts of the ASDA Multi, if they show wear or looseness, make the necessary adjustment or replacement of the parts, leaving the subsoiler ready for the next job.
- 03 - When connecting or disconnecting hydraulic hoses, do not allow the ends to touch the ground. Before connecting the hydraulic hoses, clean the connections with a clean, lint-free cloth (**do not use tow**).
- 04 - Replace all stickers, especially warning ones that are damaged or missing. Make everyone aware of their importance and the dangers of accidents when instructions are not followed.
- 05 - After all maintenance care, store your ASDA Multi on a flat surface, covered and dry, away from animals and children.
- 06 - We recommend washing the ASDA Multi only with water at the beginning of the work.



ATTENTION

Do not use chemical products to wash the agricultural trailer, as this may damage the painting of the trailer.



MAINTENANCE

FERTILIZER SYSTEM CLEANING - OPTIONAL FERTILIZATION SYSTEM

- 01 - After the works, do not leave fertilizer in the tanks, clean them as follows:
- 02 - Remove the exhible pin (1) from the back of the distributor gun (2). Then, loosen the screw (3), remove the washer (4), bushing (5) ring (6), bushing (7), washer (8) and nally the spring (9) pulling back, as shown in Figure 32.
- 03 - Then, reassemble all the components, paying attention to the correct assembly of the fertilizer distribution system every 120 working hours.



ATTENTION

Do not insert ngers or objects into holes inside of the tank, because the fertilizer helical screw can cause serious injuries.



IMPORTANT

Do not use chemical cleaners to wash the ASDA Multi, this may damage its painting.



NOTE

*Always ll the tank at the workplace.
Avoid any impurity inside the tank.
Daily perform the dosing measurement.*

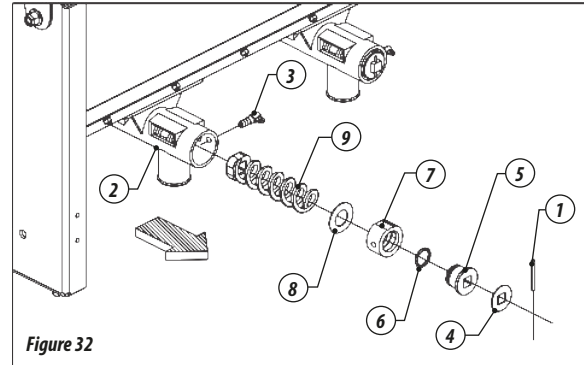

Figure 32

OPTIONAL

- The ASDA multi has optional items that may be purchased according to the work needs.

TIRE 11X15

- 01 - To work on clay soils, the ASDA Multi Versions 07 and 09 rods can be optionally purchased with 11X15 tires.

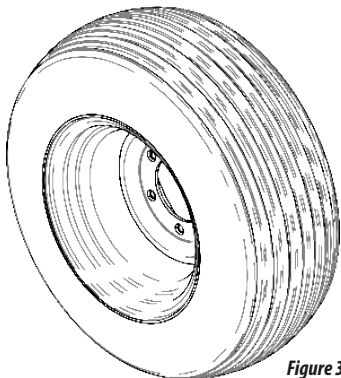
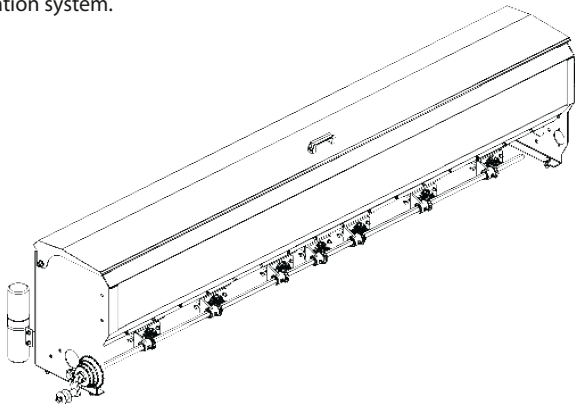

Figure 33

FERTILIZATION SYSTEM

- 01 - The ASDA Multi Versions 05 / 07 and 09 rods can be optionally purchased with a fertilization system.



IDENTIFICATION

PRODUCT IDENTIFICATION

01 - To consult the parts catalog or request technical assistance from Baldan, always indicate the model (1), serial number (2) and manufacturing date (3), found on the product identification plate.

ALWAYS REQUIRE BALDAN ORIGINAL PARTS



The drawings in this instructions manual are for illustrative purposes only. To enable a better overview and detailed instructions, on some drawings in this manual, safety devices (covers, shields, etc..) were removed. Never operate the agricultural wagon without these devices.



PUBLICATIONS

Code: 6055010090-0 | CPT: ASDAMULTI13717



CONTACT

In case of doubt do not operate or handle the equipment, please contact our After-sales Service.

Telephone: 0800-152577

E-mail: posvenda@baldan.com.br

IDENTIFICATION

PRODUCT IDENTIFICATION

- Do the identification below to always have the properly informations about your equipment life time.

Owner: _____

Dealer: _____

Farm: _____ **City:** _____ **Country:** _____

Model: _____

Warranty: _____ **Serial Number:** _____

Purchase Date: _____ / _____ / _____ **Invoice Number:** _____

NOTES

[illegible]

NOTES

This image shows a single page of white paper with horizontal blue or grey ruling lines. The lines are evenly spaced and run across the width of the page, leaving small margins at the top and bottom. There is no handwriting or other markings on the paper.

CERTIFICATE OF WARRANTY

- 01 - **BALDAN IMPLEMENTOS AGRÍCOLAS S/A**, guarantee the normal operation of the product for a 6 (six) months period dated from the dealers's bill of sale to the first final customer.
- 02 - During this period, **Baldan** compromise itself to repair the material or manufacturing defects, but the labour, the freight and other expenses are the dealer's responsibility.
- 03 - At the guarantee period, all the request and replacement of any defective part must be made to the dealer of the region, which will send the defective part for analysis at **Baldan**.
- 04 - When this procedure won't be possible and the dealer couldn't have the ability to solve the problem, the dealer can ask for **Baldan's Technical Assistance** using the specific form delivered to them.
- 05 - After the analysis of the items replaced by **Baldan Technical Assistance** and if we conclude that it wasn't a guarantee problem, then the dealer will be the responsible for all costs related to the replacement; as well as material expenses, travel including accommodation and meals, also the accessories, lubricant used or any other expenses after having called the Technical Assistance. And, withal, the company Baldan is authorized to issue the billing in name of the respective reseller.
- 06 - Any repair made to the product which is in warranty period by the dealer, will only be authorized by Baldan after budget previous presentation describing pieces and labour to be accomplished.
- 07 - It is out of this term the product which has repairs or modifications not made by dealers from Baldan's network, as well as pieces applications or not authentic components to the product by the user.
- 08 - This certificate of guarantee will become invalid when notice that the damage or defect is the result of incorrect use of the product, of instructions non-observance or operator's inexperience.

- 09 - It's stipulated that this guarantee don't cover tires, polyethylene deposits, universal joints, hydraulic components, etc, wich equipments are guarantee by their manufacturers.
- 10 - The material or manufacture defects, object of this certificate of guarantee, will not be, by any hypotesis, reason for cancellation of the contract of sale, or indemnity of any kind.
- 11 - For a warranty solicitation to the distributor, you have to proceed in the following manner:
- 12 - Send the technical informe detailed telling the problem (technical assistance request form to the client), you can find it send us an email to **aftersales@baldan.com.br** or acessing our website.
- 13 - If it's possible send films and photos from the requested spare parts.
- 14 - To point at the form: serial number, manufacture year, etc, that is, all information asked at the form. The damage spare parts should be available for analysis of the the after sales department in a future visit (in case of requested).
- 15 - **Baldan** keeps the right of changing and or improve the technical characteristics of its products, without notice and without the obligation of act like this way with its previously manufactured products.

INSPECTION AND DELIVERY CERTIFICATE

- **SERVICE BEFORE THE DELIVERY:** This equipment was very carefully prepared by the dealer's organization, inspected in all its parts in agreement with the manufacture's prescription.
- **DELIVERY SERVICE:** The user was informed about the current guarantee terms and instructed about maintenance care and utilization.
- I confirm that I was informed about the current guarantee terms and instructed about the correct utilization and maintenance of this product.

Product: _____ *Serial number:* _____

Date: _____ *Bill of sale:* _____ *Store:* _____

City: _____ *State:* _____ *Zip code:* _____

Owner: _____ *Phone:* _____

Adress: _____ *Number:* _____

City: _____ *State:* _____

E-mail: _____ *Date of sale:* _____

INSPECTION AND DELIVERY CERTIFICATE

- **SERVICE BEFORE THE DELIVERY:** This equipment was very carefully prepared by the dealer's organization, inspected in all its parts in agreement with the manufacture's prescription.
- **DELIVERY SERVICE:** The user was informed about the current guarantee terms and instructed about maintenance care and utilization.
- I confirm that I was informed about the current guarantee terms and instructed about the correct utilization and maintenance of this product.

Product: _____ *Serial number:* _____

Date: _____ *Bill of sale:* _____ *Store:* _____

City: _____ *State:* _____ *Zip code:* _____

Owner: _____ *Phone:* _____

Adress: _____ *Number:* _____

City: _____ *State:* _____

E-mail: _____ *Date of sale:* _____

INSPECTION AND DELIVERY CERTIFICATE

- **SERVICE BEFORE THE DELIVERY:** This equipment was very carefully prepared by the dealer's organization, inspected in all its parts in agreement with the manufacture's prescription.
- **DELIVERY SERVICE:** The user was informed about the current guarantee terms and instructed about maintenance care and utilization.
- I confirm that I was informed about the current guarantee terms and instructed about the correct utilization and maintenance of this product.

Product: _____ *Serial number:* _____

Date: _____ *Bill of sale:* _____ *Store:* _____

City: _____ *State:* _____ *Zip code:* _____

Owner: _____ *Phone:* _____

Adress: _____ *Number:* _____

City: _____ *State:* _____

E-mail: _____ *Date of sale:* _____

3ª Page - Manufacturer

Please send this filled copy to Baldan, until 15 days after the purchase.

Signature / Store's stamp _____

1.74.05.0059-5

AC MATÃO
ECT/DR/SP

RESPONSE CARD

NO STAMPING IS REQUIRED

THE STAMP WILL IS REQUIRED:



BALDAN IMPLEMENTOS AGRÍCOLAS S/A.

Av. Baldan, 1500 | Nova Matão | CEP: 15993-000 | Matão-SP | Brasil

Fone: (0**16) 3221-6500 | Fax: (0**16) 3382-6500

Home Page: www.baldan.com.br | e-mail: sac@baldan.com.br

Exportação: Fone: 55 16 3321-6500 | Fax: 55 16 3382-4212 | 3382-2480

e-mail: export@baldan.com.br



Baldan



BALDAN IMPLEMENTOS AGRÍCOLAS S/A.

Av. Baldan, 1500 | Nova Matão | CEP: 15993-000 | Matão-SP | Brasil

Phone: (0**16) 3221-6500 | Fax: (0**16) 3382-6500

Home Page: www.baldan.com.br | e-mail: sac@baldan.com.br

Export - Phone: 55 16 3221-6500 | Fax: 55 16 3382-4212 | 3382-2480

e-mail: export@baldan.com.br