

# CABC

**CABC - Coffee Wagon With  
Articulated Dumping System**

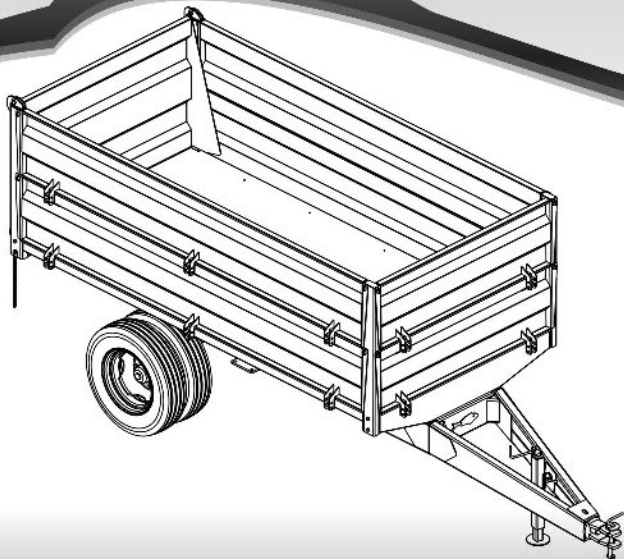

[www.baldan.com.br](http://www.baldan.com.br)

**Instruction Manual**



# INTRODUCTION

**W**e thank you for the preference and congratulate your excellent choice in acquiring an implement of outstanding quality, manufactured in accordance with the advanced technology of BALDAN IMPLEMENTOS AGRÍCOLAS S/A.

This manual will assist you, in proceeds necessities, since when you bought until the operational proceeds application, security and maintenance.

The BALDAN guarantees that deliver this implement to the dealer, working properly, and in perfect conditions.

The dealers it's under the responsibility to keep the protection and conservation while keep the implement in your stock, and than, to assembly, tighten, lubrication and overhaul.

On time of the technical deliver, the dealer must to have conducted the user customer about the manutentation, safety, and your obligations in a possible technical assistance, the obligation to see the warranty terms and read the instruction manual. Any solicitation of warranty, please contact our Baldan technical service, by your Baldan dealer that you bought our implement.

Reaffirm the necessity to read carefully of warranty certificate and note all of items from this manual, therefore you will increase the working life of your equipment.



# ***Instruction Manual***



# INDEX

## Warranty

Product warranty.....	5
-----------------------	---

## General information

Owner.....	7
------------	---

Safety rules .....	8 - 11
--------------------	--------

Warnings .....	12 - 13
----------------	---------

Components.....	14
-----------------	----

Dimensions.....	15
-----------------	----

Cabc 4500.....	15 - 16
----------------	---------

Technical specifications.....	17
-------------------------------	----

Assembly .....	18
----------------	----

Frame assembly.....	18
---------------------	----

Double wheels installation.....	19
---------------------------------	----

Mechanical jack assembly.....	20
-------------------------------	----

Bucket base assembly .....	21
----------------------------	----

Hydraulic cylinder installation .....	22
---------------------------------------	----

Hydraulic hoses assembly.....	23
-------------------------------	----

Locking system assembly.....	24
------------------------------	----

Bucket base assembly .....	25
----------------------------	----

Lower plates assembly.....	26
----------------------------	----

Upper plates assembly.....	27
----------------------------	----

# INDEX

<i>Tailgate assembly</i> .....	28
<b>Coupling</b>	
<i>Coupling of the agricultural wagon to the tractor traction bar</i> .....	29
<i>Leveling of the agricultural wagon</i> .....	30
<b>Adjustments</b>	
<i>Wheel shaft gravity adjustment</i> .....	31
<i>Tailgate disarming and rearming adjustment</i> .....	32
<i>Tailgate opening adjustment</i> .....	33
<b>Operations</b> .....	34
<b>Maintenance</b> .....	35
<i>Tires pressure</i> .....	35
<i>Lubrication</i> .....	36
<i>Table de grasas y equivalentes</i> .....	36
<i>Lubricate every 10 working hours</i> .....	37
<i>Lubricate every 30 working hours</i> .....	38
<i>Lubricate every 60 working hours</i> .....	38
<i>Precautions</i> .....	39
<i>General cleaning</i> .....	40
<b>Identification</b> .....	41 - 42
<b>Notes</b> .....	43 - 44

## WARRANTY

### PRODUCT WARRANTY

**BALDAN IMPLEMENTOS AGRÍCOLAS S/A**, warrants the normal operation of the implement to the dealer for a period of six (6) months from the date of delivery of the resale invoice to the first consumer.

During this period **BALDAN** undertakes to fix any defects in materials or workmanship of its responsibility, the labor, the freight and other expenses being of the dealer's liability.

During the warranty period, the request and the replacement of any defective parts must be made to the dealer of the region, which will send the defective part for analysis by **BALDAN**.

When such a procedure is not possible and the capacity of resolution by the dealer is exhausted, this one will request the **BALDAN** Technical Assistance support through a specific form distributed to the dealers.

After analyzing the items replaced by the **BALDAN** Technical Assistance, and if the conclusion is that it is not a case of warranty, then the costs related to the replacement will be supported by the dealer; as well as the material costs, travel including stays and meals, accessories, lubricant used and other expenses deriving from the request to the Technical Assistance, in this case, **BALDAN** is authorized to make the billing on behalf of the dealer's name.



Any repair done by the dealer on the product within the warranty period, will only be authorized by **BALDAN** upon prior presentation of the budget describing the parts and the works to be performed.

Is excluded from this warranty the product that is repaired or modied in workshops that do not belong to the **BALDAN** dealers network, as well as the application of non-genuine parts or components on the user product.

This warranty will become void if it is determined that the defect or damage is the result of misuse of the product, failure to follow the instructions or the inexperience of the operator.

It is agreed that this warranty does not cover tires, polyethylene tanks, cardans, hydraulic components, etc., which are equipment warranted by their manufacturers.

Defects in workmanship and or material, object of this warranty shall not be, under any circumstances, grounds for the termination of the contract of sale, or for compensation of any nature.

**BALDAN** reserves the right to change and or improve the technical characteristics of its products without notice and without the obligation to do so with the products previously manufactured.



## GENERAL INFORMATION

### OWNER

- 01 - **BALDAN IMPLEMENTOS AGRÍCOLAS S/A**, will not be responsible for any damage caused by an accident due to the use, transport or improper or incorrect storage of your implement, whether in case of negligence and/or inexperience of any person.
- 02 - Only persons who have the full knowledge of the tractor and the implement must perform their transportation and operation.
- 03 - **BALDAN** will not be responsible for any damage caused due to unpredictable situations or beyond the normal use of the implement.

*The mishandling of this equipment can result in serious or fatal accidents. Before switching on the equipment, carefully read the instructions of this manual. Make sure that the person responsible for the operation is instructed on the proper and safe handling of the equipment. Also make sure that the operator has read and understood the product instructions manual.*



**01- NR-31 - SAFETY AND HEALTH AT WORK IN AGRICULTURE, LIVESTOCK, FORESTRY, FOREST EXPLOITATION AND AQUACULTURE.**

**02- This Regulatory Norm aims to establish the principles to be observed in the organization and the work environment, in a way consistent with the planning and development of the agriculture, livestock, forestry, forest exploitation and aquaculture activities regarding the safety and health and the working environment.**

**IF YOU ARE THE OWNER OR THE OPERATOR OF THE EQUIPMENT.  
Read and carefully follow the NR-31 provisions.**

*For more information, visit the website and read the complete NR-31.  
<http://portal.mte.gov.br/legislacao/normas-regulamentadoras-1.htm>*



**CABC**

## SAFETY RULES



*THIS SYMBOL INDICATES AN IMPORTANT SAFETY WARNING. WHENEVER YOU FIND IT IN THIS MANUAL CAREFULLY READ THE MESSAGE THAT FOLLOWS AND BE ALERT TO THE POSSIBILITY OF PERSONAL INJURIES.*



### ATTENTION

- *Read the instructions manual carefully to learn about the recommended security practices.*



### ATTENTION

- *Only begin operating the tractor, when you are properly installed and with the seatbelt buckled.*



### ATTENTION

- *To avoid serious injuries or death, keep a safe distance from the unloading and elevation area during the operation.*

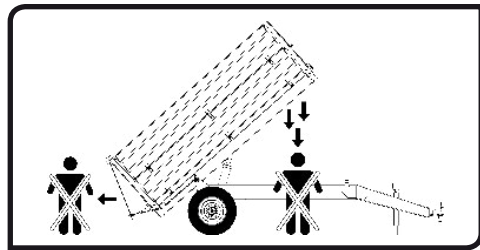

## SAFETY RULES



### ATTENTION

- Do not operate the tractor if the front has no enough ballast to balance the rear equipment.
- With a tendency to lift, add weights or ballast in the front of the tractor or on the front wheels.



### ATTENTION

- Before performing any maintenance on your equipment, make sure it is properly stopped.
- Avoid getting hit.



### ATTENTION

- There are risks of serious injuries in case of overturning when working on slopes.
- Do not use excessive speed.

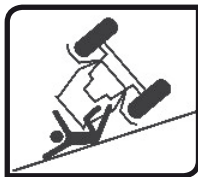

### ATTENTION

- When looking for a possible leak on the hoses, use a piece of cardboard or wood, never use your hands.
- Avoid fluid incision on the skin.

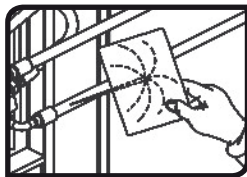

## SAFETY RULES



### ATTENTION

- Do not carry passengers on the tractor and not inside or on the equipment.



### ATTENTION

- When operating the CABC, do not allow people to stay on the wagon.



### ATTENTION

- The hydraulic oil works under pressure and can cause serious injuries, if there are any leaks. Periodically check the hoses conditions. If there is evidence of leaks replace immediately.
- Before connecting or disconnecting the hydraulic hoses relieve the system pressure, triggering the command with the tractor turned off.



### ATTENTION

- When transporting this equipment does not exceed the speed of 16km/h or 10 MPH, avoiding risk of damage and accidents.









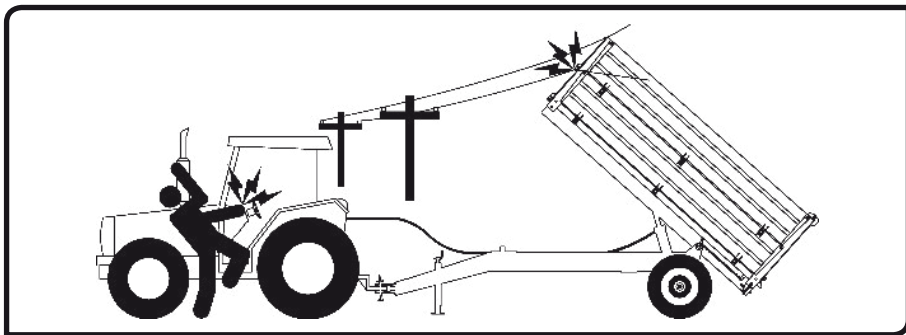

## SAFETY RULES

### **ATTENTION**







- *When operating or transporting the agricultural wagon, keep away from electric transmission lines, low branches of trees and other overhead obstructions, avoiding serious injury or even death.*



## WARNINGS

- 01-  When operating the agricultural wagon, do not allow people to stay close to it or on it.
- 02-  When performing any assembly or disassembly service, use gloves to protect your hands.
- 03-  Before connecting or disconnecting hydraulic hoses, relieve the system pressure triggering the command with the tractor turned off.
- 04-  Periodically check the hydraulic hoses conditions. If there is evidence of oil leaks, immediately replace the hose because the oil works under high pressure and can cause serious accidents.
- 05-  Do not wear loose clothing as they can curl up on the agricultural wagon.
- 06-  When you turn the tractor engine on, be properly seated on the operator's seat and be sure that you have full aware about the proper and safe handling for both the tractor and the implement. Always place the gearshift lever on the neutral position, turn off the command gear of the energy plug and put the hydraulic commands on the neutral position.
- 07-  Do not turn on the tractor engine indoors without a proper ventilation, because the exhaust gases are harmful to health.
- 08-  When maneuvering the tractor for the agricultural wagon coupling, make sure that you have the necessary space and that no one is close to it, always maneuvering at slow speed and be prepared to brake at any emergency.
- 09-  Do not make adjustments with the agricultural wagon in operation.

## WARNINGS

- 10-  When working on slopes, be careful always looking to maintain the necessary stability. In case of early unbalance reduce the acceleration, turn the wheels toward the slope side of the land and never lift the agricultural wagon.
- 11-  Always drive the tractor at speeds compatible with safety, especially when working on uneven lands or slopes, keep the tractor always engaged.
- 12-  When driving the tractor on roads, keep the brake pedals interconnected.
- 13-  Do not operate the tractor with a lightweight front. If the front has a tendency to lift, add more weight on the front or on the front wheels.
- 14-  When leaving the tractor place the gearshift lever in neutral position and apply the parking brake. Never leave implements coupled to the tractor in the raised position of the hydraulic system.
- 15-  Alcoholic beverages and some medications can cause a loss of reflexes and change the operator physical conditions. Therefore, never operate this equipment when using these substances.
- 16-  Read or explain all the above procedures to the user who cannot read.

*If case of doubt, ask the After-sales.  
Phone: 08000-152577 / E-mail: posvenda@baldan.com.br*



## COMPONENTS

# CABC - COFFEE WAGON WITH ARTICULATED DUMPPING SYSTEM

- 01 - Frame
- 02 - Coupling shackle
- 03 - Lifting Support (Mechanical Jack)
- 04 - Lower Front Cover
- 05 - Upper Front Cover
- 06 - Tires
- 07 - Wheel Hub
- 08 - Lower Lateral Cover
- 09 - Upper Lateral Cover
- 10 - Chain
- 11 - Tailgate
- 12 - Hydraulic Cylinder
- 13 - Hydraulic Hoses

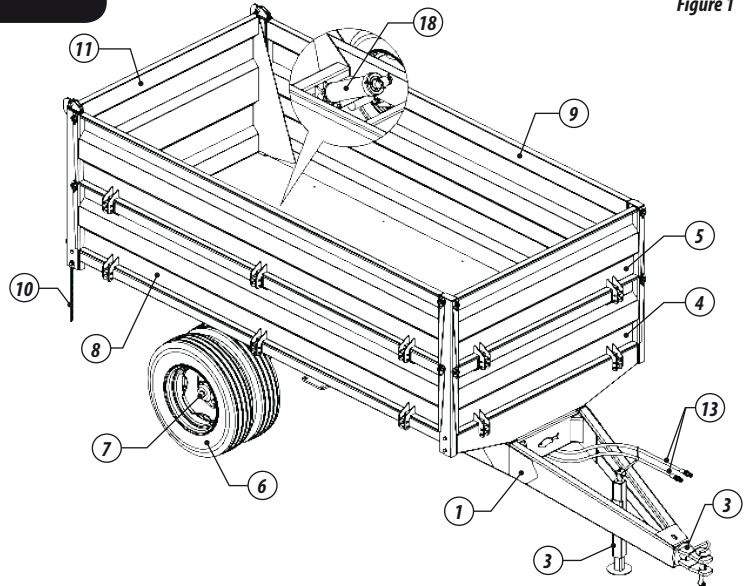
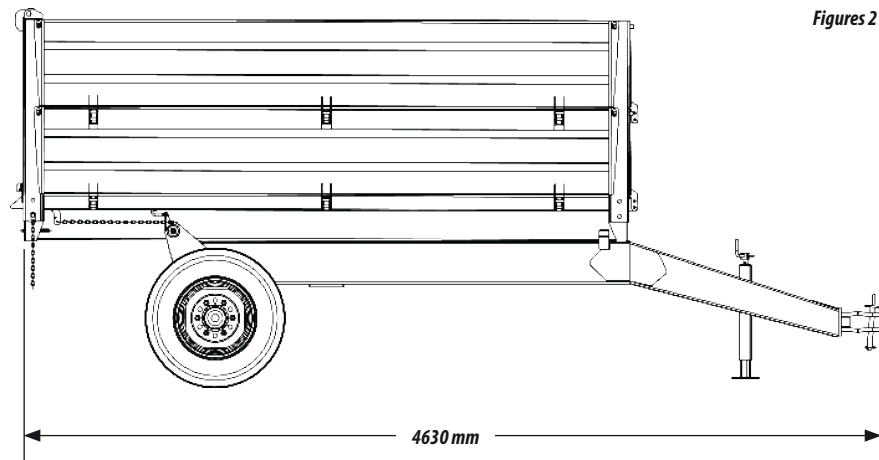
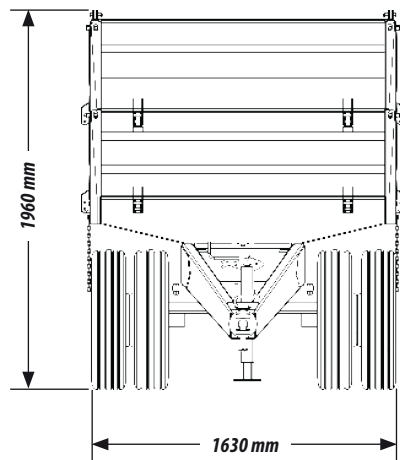

Figure 1



## DIMENSIONS

### CABC 4500



*Figures 2*



**CABC**

## DIMENSIONS

CABC 4500

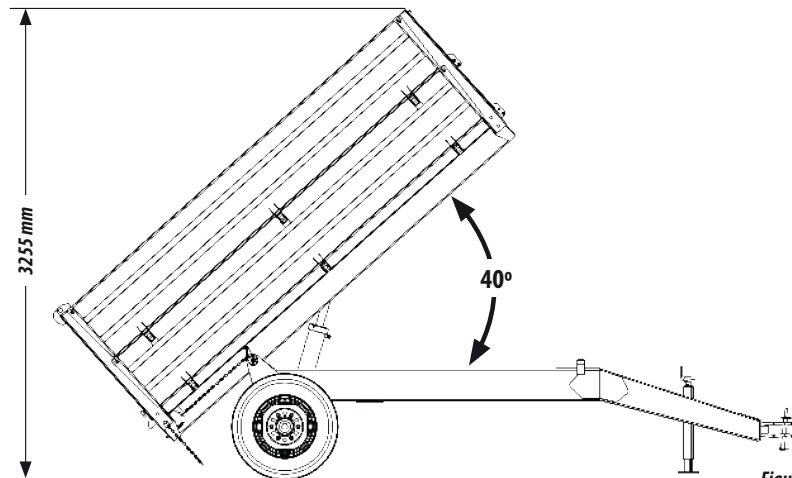

Figures 2



## TECHNICAL SPECIFICATIONS

<i>Model</i>	<i>Load Capacity (m<sup>3</sup>)</i>	<i>Total Length (mm)</i>	<i>Total Width (mm)</i>	<i>Total Height (mm)</i>	<i>Approximate weight (kg)</i>	<i>Tractor Power (HP)</i>
<b>CABC</b>	4,50	4630	1630	1960	970	70

*Table 01*

*BALDAN reserves the right to change and or improve the technical characteristics of its products without notice and without the obligation to do so with the products previously manufactured. The technical specications are approximate and informed in normal working conditions.*



**CABC**

## ASSEMBLY

- 01 - The CABC wagon when destined to the export market, is shipped disassembled to facilitate the boarding. To assemble it, follow the instructions below:
- 02 - Before starting the assembly of the CABC, look for an ideal place to make its assembly easier.
- 03 - To perform any assembling and disassembling service, use gloves on your hands.
- 04 - Do not use loose clothes as they can curl up on the equipment.

### FRAME ASSEMBLY

Figure 3

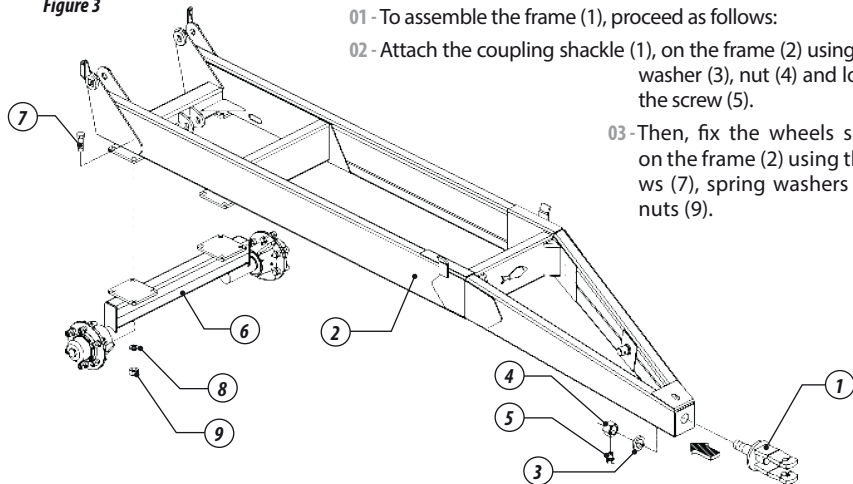

01 - To assemble the frame (1), proceed as follows:

02 - Attach the coupling shackle (1), on the frame (2) using the flat washer (3), nut (4) and lock with the screw (5).

03 - Then, fix the wheels shaft (6) on the frame (2) using the screws (7), spring washers (8) and nuts (9).

## ASSEMBLY

### DOUBLE WHEELS INSTALLATION

- To install the double wheels, proceed as follows:

- 01 - First, fix the wheel (1) on the shaft hub (2) in a reverse way, i.e., with the internal part of the wheel facing out, using the screws (3).
- 02 - Then, install the wheel (4), in the normal position, using the nuts and lock nuts (5).

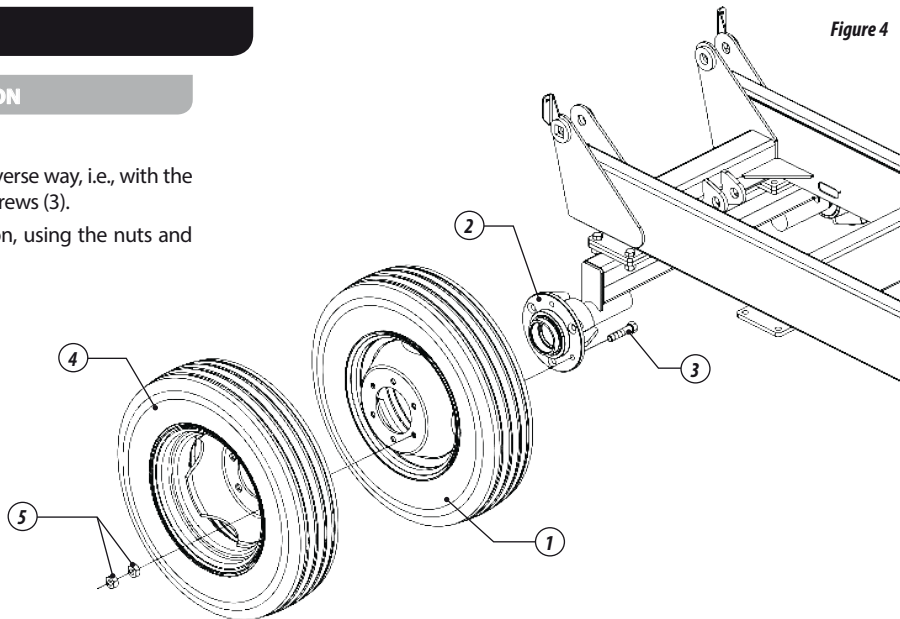

Figure 4



## ASSEMBLY

### MECHANICAL JACK ASSEMBLY

- To assemble the mechanical jack (1), proceed as follows:

- 01 - Engage the mechanical jack (1) in the frame (2) and lock with the pin (3) and the lock (4).
- 02 - At the end of the assembly, put the puller pin (5) in the coupling shackle (6) and lock with the pin with the ring (7).



### ATENCIÓN

*Before assembling the bucket base, next page, adjust the mechanical jack (1), to level the frame (2).*

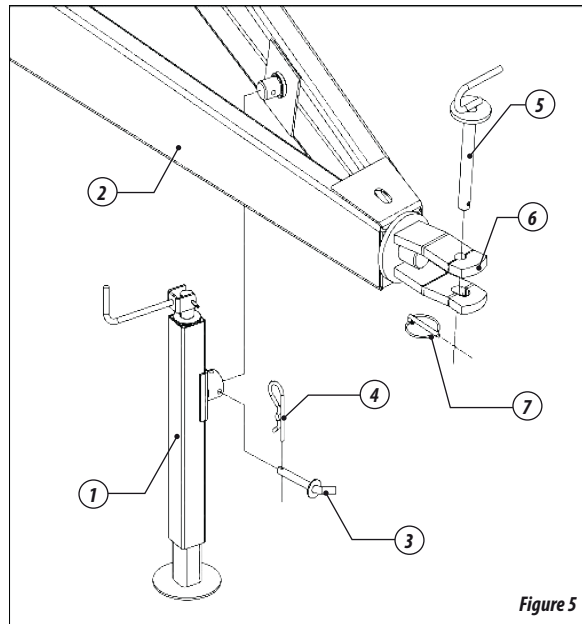

Figure 5



## ASSEMBLY

### BUCKET BASE ASSEMBLY

- To assemble the bucket base (1), proceed as follows:  
**01** - Couple the bucket base (1) to the frame (2) and lock with the pin (3) and cotter pin (4).  
**02** - Then, install the hook (5) and lock it with the spring washer (6) and nut (7).

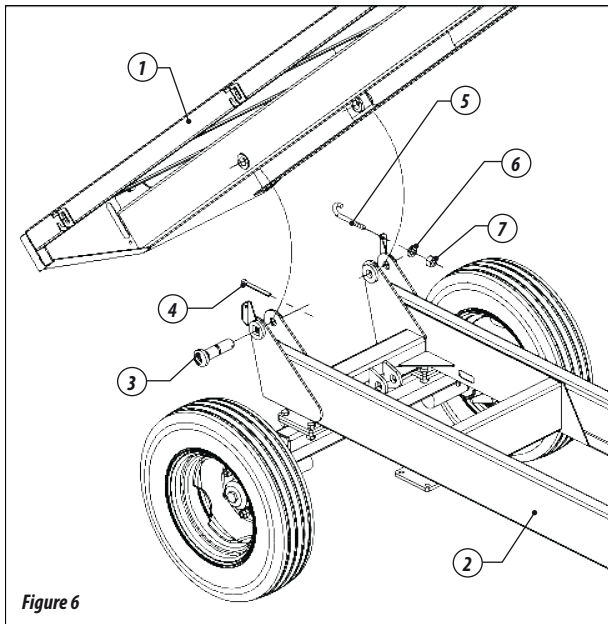

## ASSEMBLY

### HYDRAULIC CYLINDER INSTALLATION

- To install the hydraulic cylinder (1), proceed as follows:  
**01** - Engage the hydraulic cylinder (1) in the frame (2) using the pin (3), flat washer (4) and cotter pin (5).  
**02** - Then, fix the hydraulic cylinder rod (1) on the bucket (6) using the pin (7), flat washer (8) and cotter pin (9).

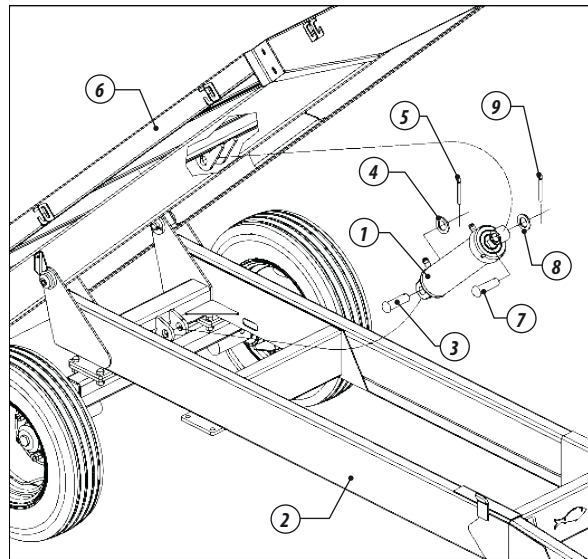

Figure 7



## ASSEMBLY

### HYDRAULIC HOSES ASSEMBLY

- To assemble the hydraulic hoses (1), proceed as follows:
  - 01 - Engage the hydraulic hoses (1) on the hydraulic cylinder (2), as shown on figure 08.
  - 02 - Then, stretch the hydraulic hoses (1) and connect them to the quick couplings (3), as shown on figure 09.

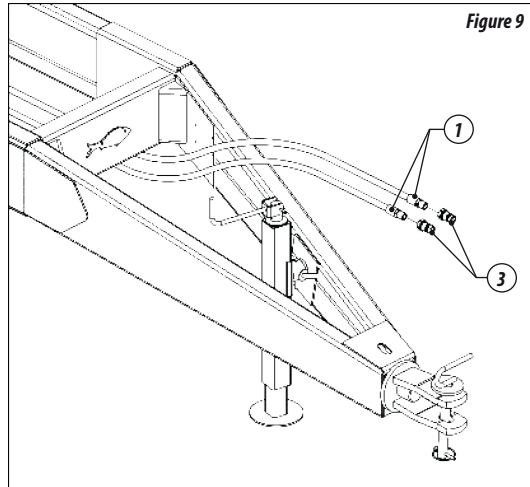
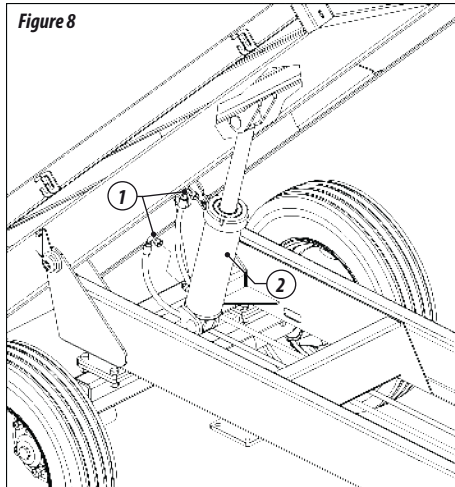

## ASSEMBLY

### LOCKING SYSTEM ASSEMBLY

- To assemble the locking system set (1), proceed as follows:  
**01** - Fix the lock (1) on the frame (2) using the pin (3) and cotter pin (4).  
**02** - Then, fix the pin (5) on the frame (2) using the spring washer (6) and nut (7).  
**03** - Finally, fix the spring (8) on the pin (5) and on the hook (9).

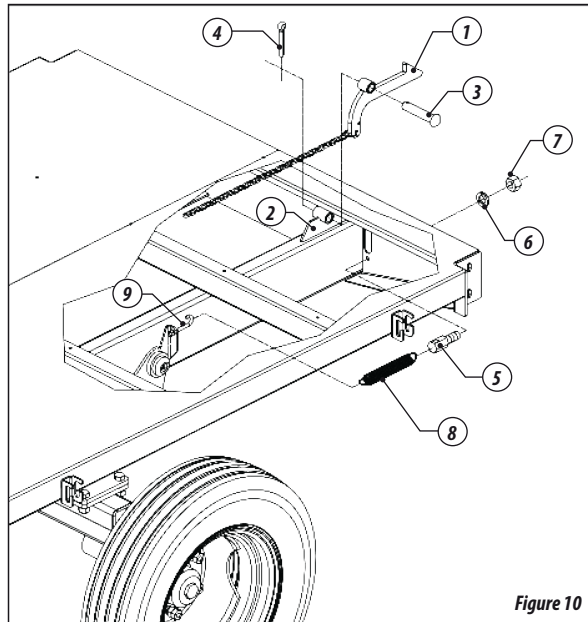

Figure 10

## ASSEMBLY

### BUCKET BASE ASSEMBLY

- To assemble the front and rear beams, proceed as follows:

#### REAR BEAMS

- 01 - Assemble the rear beams (1) and the chains (2) on the frame (3), fixing them using the screws (4), flat washers (5), spring washers (6) and nuts (7).

#### FRONT BEAMS

- 02 - Assemble the front beams (8) on the frame (3), fixing them using the screws (9), flat washers (10), spring washers (11) and nuts (12).

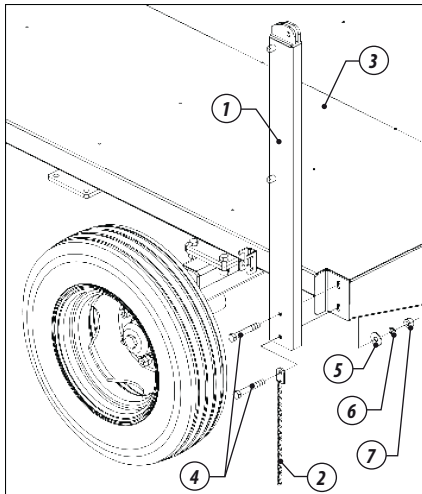

Figures 10

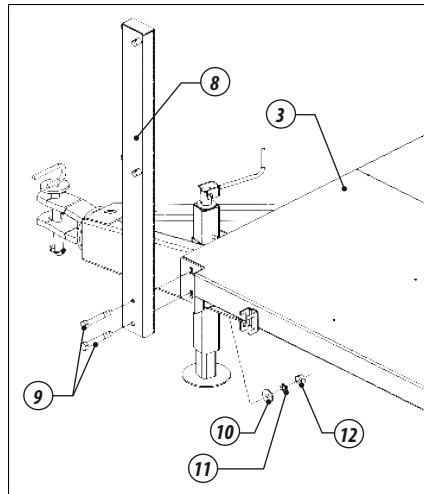

**CABC**

## ASSEMBLY

### LOWER PLATES ASSEMBLY

- The CABC plates are adjustable and easy to assemble and disassemble. To assemble the lower plates (1), we recommend to assemble them one by one, to do this proceed as follows:

- 01 - Fix the plate (1) on the couplings (2) on the frame lateral (3). Then, lock them on the beams (4) with the pins with ring (5).
- 02 - Then, repeat the procedure above for the plate assembly (6).
- 03 - Finally, fix the plate (7) on the couplings (8) of the frame front part (3). Then, lock them on the beams (4) with the pins with ring (5).

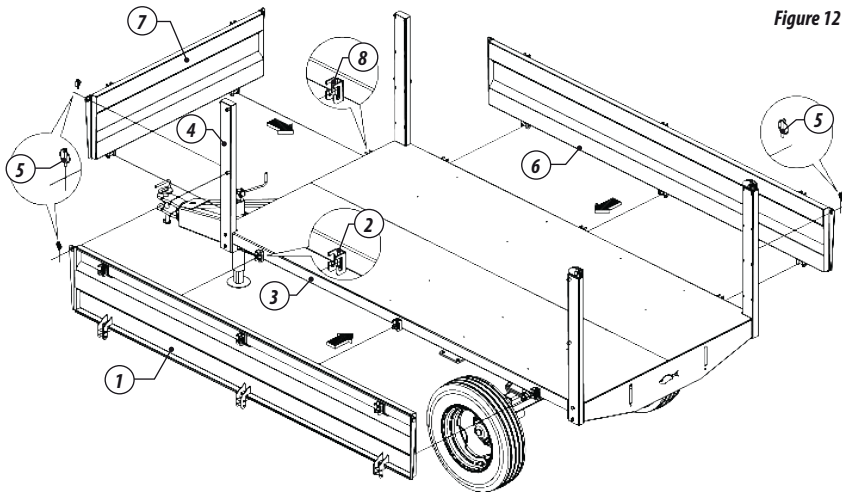

Figure 12

## ASSEMBLY

### UPPER PLATES ASSEMBLY

- 01 - After the lower plates assembly, assemble the upper plates, to do this proceed as follows:
- 02 - Fix the plate (1) on the couplings (2) on the lower frame lateral (3). Then, lock them on the beams (4) with the pins with ring (5).
- 03 - Then, repeat the procedure above for the plate assembly (6).
- 04 - Finally, fix the plate (7) on the couplings (8) of the lower frontal plate (9). Then, lock them on the beams (4) with the pins with ring (5).

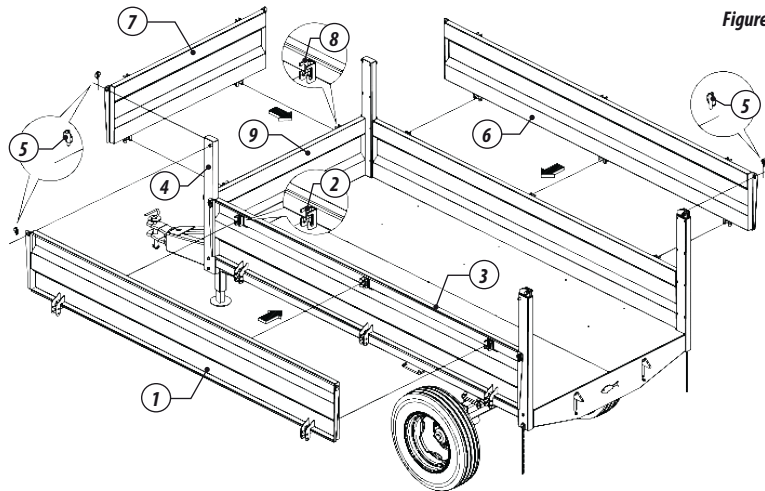

Figure 13



## ASSEMBLY

### TAILGATE ASSEMBLY

- 01 - Finally, complete the CAB assembly, fixing the tailgate (1), to do this, proceed as follows:
- 02 - Engage the tailgate (1) on the beams (2 and 3) fixing it with the screws (4) and nuts (5).

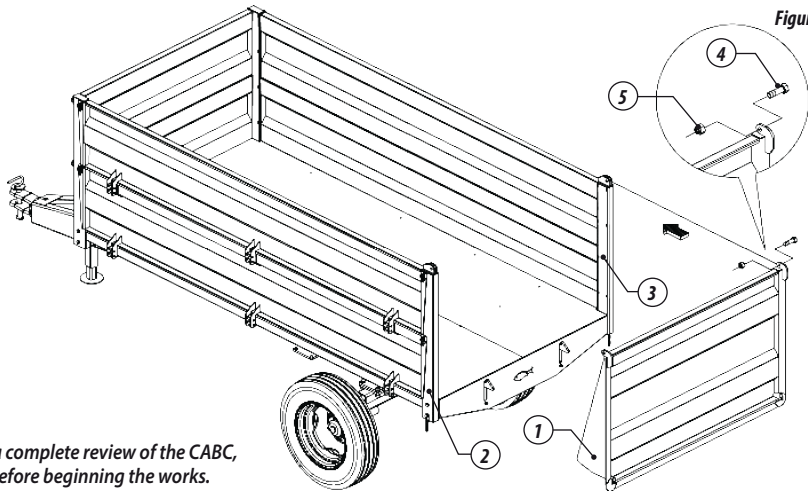

Figure 14



#### ATTENTION

After the tailgate assembly (1), make a complete review of the CAB, checking all assembled components before beginning the works.



## COUPLING

### COUPLING OF THE AGRICULTURAL WAGON TO THE TRACTOR TRACTION BAR

- To couple the CABC to the tractor traction bar, proceed as follows:
  - 01 - Before coupling the CABC, find a safe and easily accessible place.
  - 02 - Always use a reduced gear with low acceleration.
  - 03 - Before connecting or disconnecting the hydraulic hoses, stop the engine and relieve the circuit pressure, fully triggering the control levers.
  - 04 - Make sure that, when you relieve the system pressure, nobody can be harmed by the equipment motion.
- According to the following instructions, proceed as follows:
  - 05 - Level the CABC coupling header (1) in relation to the tractor coupler using the regulator (2). Then, slowly move in reverse the tractor to the CABC, paying attention to the brakes application.
  - 06 - Couple the CABC to the tractor fixing it with the coupling pin (3) and lock-ring (4).
  - 07 - Finally, couple the hoses (5) on the tractor quick coupling.

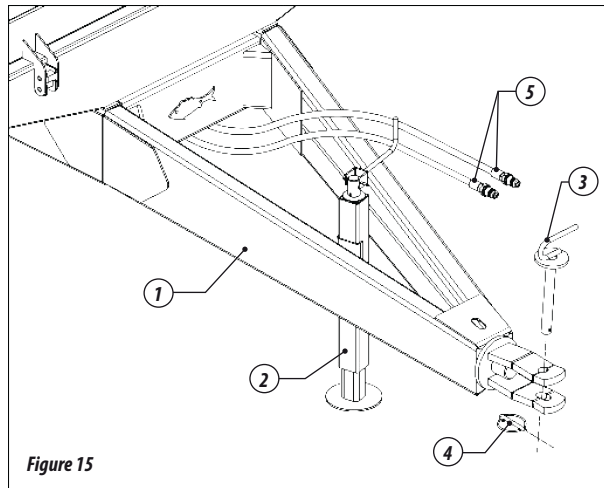

Figure 15



## COUPLING

### LEVELING OF THE AGRICULTURAL WAGON

- To level the CABC, proceed as follows:
  - 01 - The tractor must be on leveled ground; then, level the CABC checking the longitudinal leveling (length) on the side in relation to the ground.
  - 02 - Otherwise, it must be leveled using the tractor coupling bar, using the height which corresponds to the best CABC leveling.



#### ATTENTION

*Read the tractor instructions manual and verify in which positions the traction bar can work.*

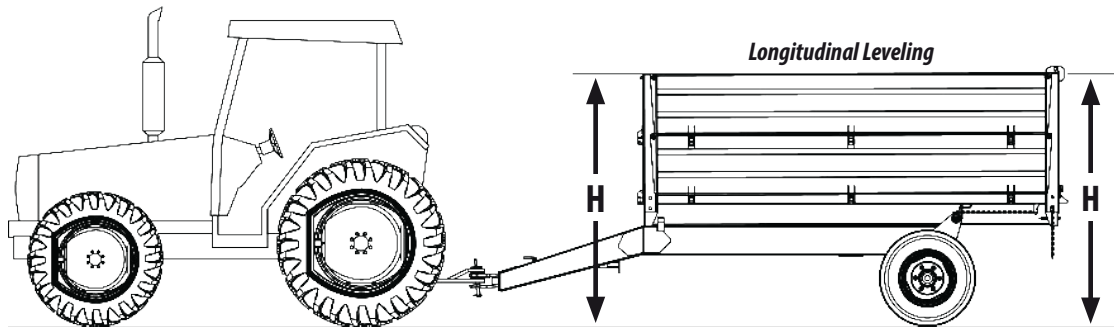

Figure 16





## ADJUSTMENTS

### WHEEL SHAFT GRAVITY ADJUSTMENT

- The CABC has a wheel shaft gravity system, which depending on the need and the kind of product to be transported or tilted, allows changing the wheel shaft fixation position, facilitating the work with the agricultural wagon. To adjust the wheel shaft (1), proceed as follows:
- 01 - Loosen the screws (2), spring washers (3) and nuts (4) releasing the wheel shaft (1) from the point "A" of the frame (5).
  - 02 - Then, assemble the wheel shaft (1) on the point "B" of the frame (5), fixing it with the same screws (7), spring washers (8) and nuts (9).

Figures 17



### ATTENTION

*This adjustment should be done in extreme cases when the product is very heavy and the agricultural wagon has difficulties of tilting and transporting.*

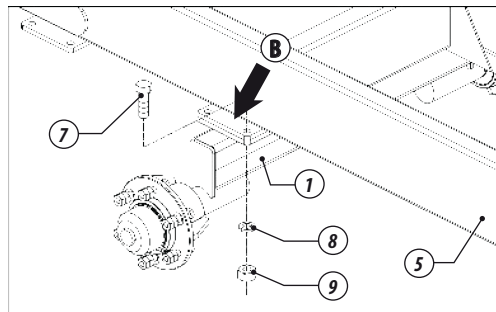
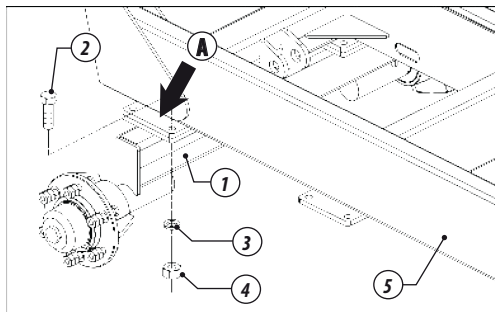

**CABC**

## ADJUSTMENTS

### TAILGATE DISARMING AND REARMING ADJUSTMENT

- The CABC has a tailgate disarming and rearming system (1) using the lock (2), allowing the operator to do the works without having to get out of the tractor. To adjust the tailgate disarming and rearming (1), proceed as follows:  
01 - Adjust the chain (3) using the threaded rod (4), adjusting so as to obtain a perfect disarming and rearming.

Figure 18



#### ATTENTION

To ensure the synchronism of the tailgate disarming and rearming (1), the adjustment must be identically done on both sides of the agricultural wagon.

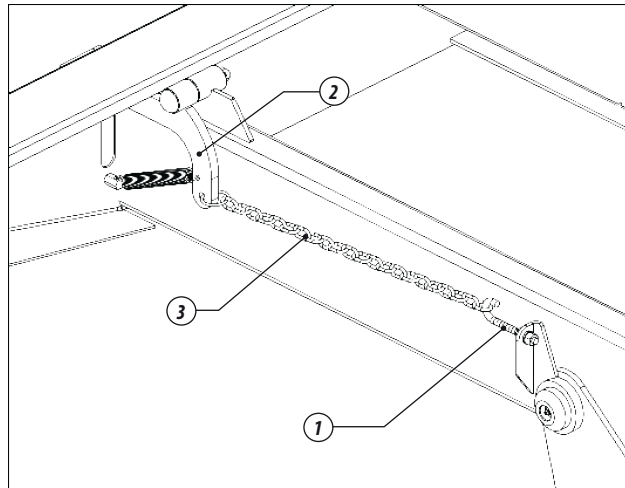
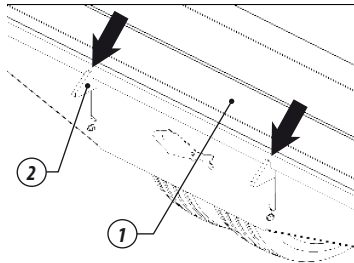

## ADJUSTMENTS

### TAILGATE OPENING ADJUSTMENT

- The CABC has a tailgate opening adjustment system (1), enabling the operator to limit the amount to be unloaded when tipping the agricultural wagon. To adjust the tailgate opening (1), proceed as follow:
- 01 - Engage the chain (2) on the tailgate (1) so that it is tighter or looser resulting in a greater or smaller tailgate opening (1).

#### **ATTENTION**

*To ensure the synchronism of the tailgate opening (1), the chains (2) must be identically adjusted; otherwise, the tailgate can be damaged (1) when tipping.*

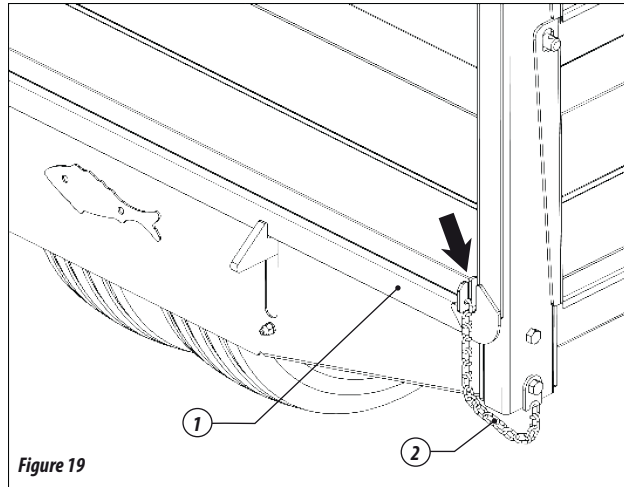

Figure 19



## OPERATIONS

- The tractor preparation will help you to save time in addition to a better result of the work on the field. The following suggestions may be helpful to you.

- 01- Before beginning to work, make a general review on the agricultural wagon.
- 02- Always keep the tires with the same calibration 54 lbs/pol<sup>2</sup>, to avoid early wears due to excess or lack of pressure.
- 03- Never transport the agricultural wagon with its bucket raised.
- 04- Respect the lubrication intervals.
- 05- Do not remove only by yourself the lateral parts of the agricultural wagon, there is a risk of serious accidents.
- 06- Do not perform maintenance services on the agricultural wagon with the bucket raised only by the hydraulic system, use wedges.
- 07- The agricultural wagon has several adjustments but only the local conditions will determine the best adjustment.
- 08- Make sure the agricultural wagon operator is trained and qualified to work.
- 09- In case of doubt, do not operate or handle the agricultural wagon, ask the After-Sales. Phone: 0800-152577 or e-mail: posvenda@baldan.com.br

## MAINTENANCE

- 01 - The CABC was developed to give you the maximum performance whatever are the soils conditions. The experience shows that the periodic maintenance of some parts of the winch is the best way to avoid problems, so we suggest checking.

### TIRES PRESSURE

- 01 - The tires must always be properly calibrated avoiding premature wear due to excess or lack of pressure.



#### ATTENTION

*The recommended calibration of 54 lb/pol<sup>2</sup> is for tires model 650 x 16 08 plies supplied with the CABC. When you calibrate the CABC tires do not exceed the recommended calibration. If you purchase an agricultural wagon with no tires, we recommend asking the tire manufacturer about the ideal calibration for the model used on the CABC.*



#### NOTE

*The tractor tire pressure calibration must be made according to the one recommended by the manufacturer.*

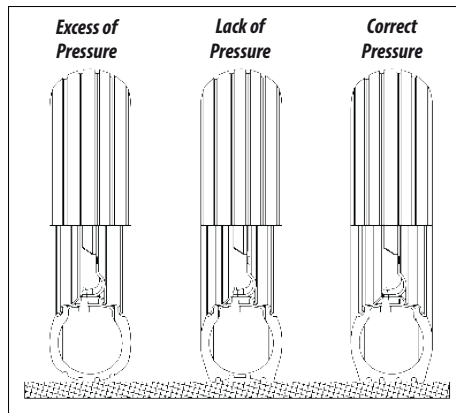

Figure 20



**CABC**

## MAINTENANCE

### LUBRICATION

Table 02

- 01 - Lubrication is essential for a good performance and a longer durability of the CABC moving parts, contributing to the maintenance costs reduction.
- 02 - Before starting the operation, carefully lubricate all the grease fittings always respecting the lubrication intervals of the following pages. Pay attention to the lubricant quality, relative to its efficiency and purity, avoiding using products contaminated by water, earth and other agents.

TABLE OF GREASES AND EQUIVALENTS

<i>Manufacturer</i>	<i>Types of recommended grease</i>
<i>Petrobrás</i>	<i>Lubrax GMA 2</i>
<i>Atlantic</i>	<i>Litholine MP 2</i>
<i>Ipiranga</i>	<i>Super Graxa Ipiranga Ipiranga Super Graxa 2 Ipiflex 2</i>
<i>Castrol</i>	<i>LM 2</i>
<i>Mobil</i>	<i>Mobilgrease MP 77</i>
<i>Texaco</i>	<i>Marfak 2 Agrotex 2</i>
<i>Shell</i>	<i>Retinax A Alvania EP 2</i>
<i>Esso</i>	<i>Multipurpose grease H</i>
<i>Bardahl</i>	<i>Maxlub APG 2 EP</i>



#### IMPORTANT

If there are equivalent manufacturers and brands which are not listed in the table, consult the manufacturer's technical manual.



## MAINTENANCE

LUBRICATE EVERY 10 WORKING HOURS

Figures 21

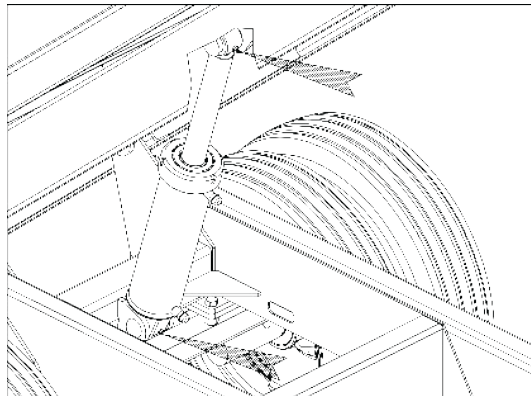
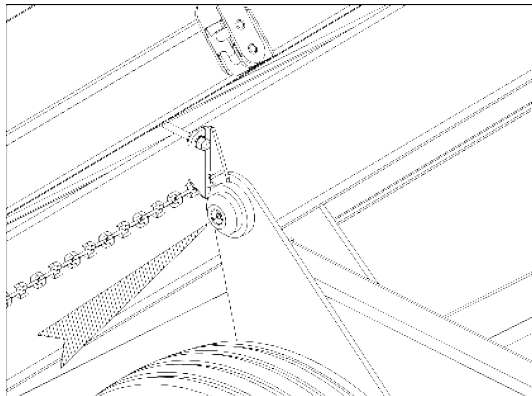

### ATTENTION

When lubricating the CABC, does not exceed the new grease quantity. Use the sucient quantity.



**CABC**

## MAINTENANCE

### LUBRICATE EVERY 30 WORKING HOURS

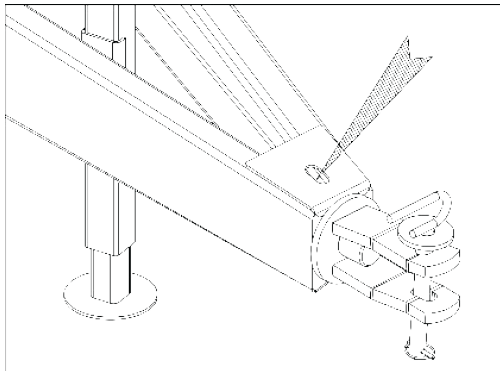

Figure 22

### LUBRICATE EVERY 60 WORKING HOURS

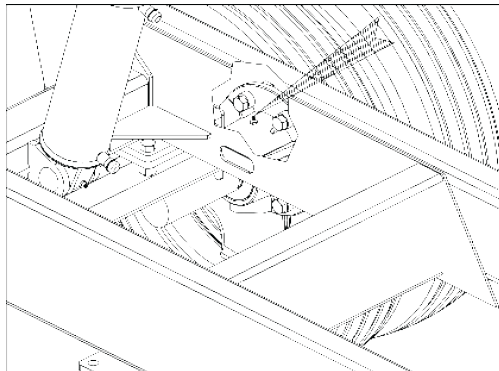

Figure 23



#### ATTENTION

When lubricating the CABC, does not exceed the new grease quantity. Use the sucient quantity.



## MAINTENANCE

### PRECAUTIONS

- 01- Before each work, check the condition of all pins, terminals, nipples and hydraulic hoses. When necessary, replace or retighten them.
- 02- The travel speed must be carefully controlled according to the soil conditions.
- 03- The CABC is used in various applications requiring knowledge and attention during its handling.
- 04- Only the local conditions will determine the best way to operate the CABC.
- 05- When assembling or disassembling any part of the CABC, use appropriate methods and tools.
- 06- Strictly respect the lubrication intervals on the various lubricating points of the agricultural wagon.
- 07- Always check any wear on the parts. If you need spare parts, require Baldan genuine parts.
- 08- Keep the CABC tires always calibrated.



#### IMPORTANT

*Proper and periodic maintenance is necessary to ensure the equipment long life.*



**CABC**

## MAINTENANCE

### GENERAL CLEANING

- Due to the corrosive action of the time, we recommend that you clean the agricultural wagon before storing it, to preserve and extend the life of your equipment. To do this, proceed as follows:
- 01 - First of all, perform a general cleaning of the CABC, removing all product residuals found inside and outside the agricultural wagon. Then, wash it only with water.
- 02 - Make sure the paint is not worn, if so, apply a general coat of paint on all points.
- 03 - Lubricate the whole agricultural wagon. Check all the CABC moving parts if wear or looseness appears, make the necessary adjustment or replace the parts, keeping the agricultural wagon ready for the next work.
- 04 - When connecting or disconnecting hydraulic hoses, do not let the ends touch the ground. Before connecting the hydraulic hoses, clean the connections with a clean and lint-free cloth (do not use burlap).
- 05 - Replace all stickers mainly those of warning that are damaged or missing. Make everyone aware about their importance and the dangers of accidents when the instructions are not followed.
- 06 - After all maintenance cares, store your CABC on a flat surface, covered and dry location, away from pets and children.
- 07 - We recommend washing the CABC only with water at the beginning of a new work.



#### ATTENTION

*Do not use chemicals to wash the agricultural wagon, this will damage the paint.*



## IDENTIFICATION

### PRODUCT IDENTIFICATION

01 - To consult the parts catalog or request technical assistance from Baldan, always indicate the model (1), serial number (2) and manufacturing date (3), found on the product identification plate.

		
<b>BALDAN IMPLEMENTOS AGRÍCOLAS S/A.</b>		
AV. BALDAN, 1500   CEP 15.993-000   MATÃO-SP   BRASIL		
FONE: (0xx16) 3221-6500   FAX: (0xx16) 3382-6500		
e-mail: sac@baldan.com.br   Home Page: www.baldan.com.br		
CNPJ: 52.311.347/0009-06   INSCR. EST.: 441.016.953.110		
Modelo		
Nº de Série	Data	

1

2

3



### ATTENTION

*The drawings in this instructions manual are for illustrative purposes only. To enable a better overview and detailed instructions, on some drawings in this manual, safety devices (covers, shields, etc..) were removed. Never operate the agricultural wagon without these devices.*



### MARKETING

Edition of Catalogs and Manuals

Code: 6055010225-3 | Revision: 00  
CPT: CAB00615



### CONTACT

*In case of doubt do not operate or handle the equipment, please contact our After-sales Service.*  
Phone: 0800-152577  
E-mail: posvenda@baldan.com.br



**CABC**

## IDENTIFICATION

### PRODUCT IDENTIFICATION

- Do the identification below to always have the properly informations about your equipment life time.

*Owner:* \_\_\_\_\_

*Dealer:* \_\_\_\_\_

*Farm:* \_\_\_\_\_ *City:* \_\_\_\_\_ *Country:* \_\_\_\_\_

*Model:* \_\_\_\_\_

*Warranty:* \_\_\_\_\_ *Serial Number:* \_\_\_\_\_

*Purchase Date:* \_\_\_\_\_ / \_\_\_\_\_ / \_\_\_\_\_ *Invoice Number:* \_\_\_\_\_

NOTES

This image shows a blank sheet of white paper with horizontal ruling lines. The lines are evenly spaced and extend across the width of the page. There are no margins, text, or other markings on the paper.

NOTES

This image shows a blank sheet of white paper with horizontal ruling lines. The lines are evenly spaced and extend across the width of the page. There are no margins, text, or other markings on the paper.





6 0 5 5 0 1 0 2 2 5 3



**Baldan**



## **BALDAN IMPLEMENTOS AGRÍCOLAS S/A.**

Av. Baldan, 1500 | Nova Matão | CEP: 15993-000 | Matão-SP | Brasil

Phone: (0\*\*16) 3221-6500 | Fax: (0\*\*16) 3382-6500

Home Page: [www.baldan.com.br](http://www.baldan.com.br) | e-mail: [sac@baldan.com.br](mailto:sac@baldan.com.br)

Export: Phone: 55 16 3221-6500 | Fax: 55 16 3382-4212 | 3382-2480

e-mail: [export@baldan.com.br](mailto:export@baldan.com.br)