

Instruction Manual



CABC

Coffee Wagon with Articulated Dumping System

 **BALDAN**

■ Presentation

We appreciate the preference and would like to congratulate you for excellent choice you just made, since you have acquired a product manufactured with **BALDAN**



IMPLEMENTOS AGRÍCOLAS S/A technology.

This manual will guide you through the procedures required since its acquisition until operational procedures of usage, safety and maintenance.

BALDAN assures that it has delivered this implement for resale in full and in perfect conditions.

Resale was responsible for the custody and maintenance during the period in its possession, and also for the assembly, retightening, lubrication and overhaul.

During the technical delivery, dealer should guide the user regarding maintenance, safety, their obligations in eventual technical assistance, strict compliance with the warranty term and reading the instructions manual.

Any technical assistance request while in warranty must be made to the dealer from whom you have purchased it.

We reiterate the need for a careful read of the warranty certificate and compliance of all items from this manual, because by doing so you will increase the life of your device.

Instruction Manual



CABC

Coffee Wagon with Articulated Dumping System

BALDAN IMPLEMENTOS AGRÍCOLAS S/A.
CNPJ: 52.311.347/0009-06
Insc. Est.: 441.016.953.110



Scan the QR Code on the identification plate of your device and access this Instruction Manual online.

 **BALDAN**

▪ Index

BALDAN WARRANTY	07
GENERAL INFORMATION	08
<i>To the owner</i>	<i>08</i>
SAFETY RULES.....	09
<i>To the operator.....</i>	<i>09 - 13</i>
WARNINGS	14 - 15
COMPONENTS.....	16
<i>CABC - Coffee Wagon with Articulated Dumping System.....</i>	<i>16</i>
DIMENSIONS	17
<i>CABC - Coffee Wagon with Articulated Dumping System</i>	<i>17 - 18</i>
SPECIFICATIONS	19
<i>CABC - Coffee Wagon with Articulated Dumping System</i>	<i>19</i>
ASSEMBLY	20
<i>Assembly shackle.....</i>	<i>20</i>
<i>Assembly wheel axle</i>	<i>21</i>
<i>Assembly the dual tires.....</i>	<i>22</i>
<i>Assembly lift bracket.....</i>	<i>23</i>
<i>Assembly bucket base</i>	<i>24</i>
<i>Assembly hydraulic cylinder and hydraulic hoses.....</i>	<i>25</i>
<i>Assembly the lock system.....</i>	<i>26</i>
<i>Assembly the rear and front support beams</i>	<i>27</i>
<i>Assembly of the lower plates</i>	<i>28</i>
<i>Assembly of the upper plates.....</i>	<i>29</i>
<i>Assembly rear cover.....</i>	<i>30</i>
HITCH.....	31
<i>Tractor hitch</i>	<i>31</i>
<i>Support bracket position</i>	<i>32</i>
LEVELING	33
<i>Agricultural wagon levelling</i>	<i>33</i>
ADJUSTMENTS	34
<i>Rear cover disarm and reset adjustment</i>	<i>34</i>
<i>Rear cover opening adjustment.....</i>	<i>35</i>
OPERATIONS.....	36
<i>Operating recommendations.....</i>	<i>36</i>
<i>General recommendation.....</i>	<i>36</i>
MAINTENANCE	37
<i>Tires pressure</i>	<i>37</i>
<i>Changing tires</i>	<i>38</i>
<i>Lubrification</i>	<i>39</i>
<i>Lubrification every 10 hours of work.....</i>	<i>40</i>
<i>Lubrification every 30 hours of work</i>	<i>41</i>
<i>Lubrification every 60 hours of work</i>	<i>41</i>
<i>Cares</i>	<i>42</i>

▪ Index

General cleaning 42 - 43

Conservation of the coffee wagon 43 - 44

OPTIONAL **45**

Optional accessories 45

IDENTIFICATION **46**

Identification plate 46

Product identification 47

NOTES **48 - 49**

CERTIFICATE **50**

Certificate of warranty 50 - 56

▪ **Baldan Warranty**

BALDAN IMPLEMENTOS AGRÍCOLAS S/A ensures the dealer normal performance of the implement for a period of six (6) months as of the delivery date on the retail invoice to the first final consumer.

During this period, **BALDAN** undertakes to repair defects in material and/or of manufacture of its liability, including labor, freight and other expenses of the dealer's liability.

In the warranty period, request and replacement of eventual defective parts shall be made to the dealer of the area, who will submit the faulty piece for **BALDAN** analysis.

When this procedure is not possible and the resolving capacity of the dealer is exhausted, the dealer will request the support of **BALDAN** Technical Assistance through a specific form distributed to dealers.

After analyzing the replaced items by **BALDAN** Technical Assistance, and concluding that it is not a warranty, then the dealer will be responsible for the costs related to the replacement; as well as material expenses, travel including accommodation and meals, accessories, lubricant used and other expenses arising from the call out to Technical Assistance, and **BALDAN** company is authorized to carry the respective invoice in the name of the resale.

Any repair carried out in the product within the dealer warranty deadline will only be authorized by **BALDAN** upon previous budget presentation describing parts and workforce to be executed.

The product is excluded from this term if it is repaired or modified by representatives not belonging to the **BALDAN** dealer network, as well as the application of non-genuine parts or components to the user's product.

This warranty is void where it is found that the defect or damage is caused by improper use of the product, failure to follow instructions or inexperience of the operator.

It is agreed that this warranty does not cover tires, polyethylene tanks, cardan shafts, hydraulic components, etc., which are equipment guaranteed by their manufacturers.

Manufacturing and/or material defects, object of this warranty term, will not constitute, under any circumstances, grounds for termination of a purchase agreement, or for indemnification of any nature.

BALDAN reserves the right to change and/or perfect the technical characteristics of its products, without previous notice, and without obligation to proceed in the same way with the products previously manufactured.

▪ General Information

• To the owner

BALDAN IMPLEMENTOS AGRÍCOLAS S/A is not responsible for any damaged caused by accident due to usage, transportation, or in the improper or incorrect transportation of its implement, whether by negligence and/or inexperience of any person.

Only people with complete knowledge of the tractor and the implement should carry their transportation and operation.

BALDAN is not responsible for any damaged caused in unpredictable or unrelated situations to the normal use of the implement.

The incorrect handling of this equipment may result in severe or fatal accidents. Before starting the equipment, carefully read the instructions contained in this manual. Make sure that the person responsible for the operation is instructed as the correct and safe handling. Also make sure that the operator has read and understood the instructions manual of the product.

ATTENTION

NR-31 - SAFETY AND HEALTH AT WORK IN AGRICULTURE, LIVESTOCK FORESTRY, FOREST EXPLORATION AND AQUACULTURE.

The purpose of this Regulatory Standard is to establish the precepts to be observed in the organization and in the work environment, in a manner compatible with the planning and development of agriculture, livestock, forestry and aquaculture activities with the safety and health and environment work environment.

MR. OWNER OR OPERATOR OF THE EQUIPMENT.
Read and carefully comply with provisions of NR-31.

For more information, refer to the site and read in full NR-31.
<http://portal.mte.gov.br/legislacao/normas-regulamentadoras-1.htm>

▪ Safety Rules

- To the operator



THIS SYMBOL INDICATES IMPORTANT SAFETY WARNING. IN THIS MANUAL, WHENEVER YOU FIND IT, READ THE FOLLOWING MESSAGE CAREFULLY AND PAY ATTENTION TO THE POSSIBILITY OF PERSONAL ACCIDENTS.



ATTENTION



Carefully read the instructions manual to learn about the recommended safety practices.



ATTENTION



Only start to operate the tractor when you are properly seated and with the seat belt locked.



ATTENTION



Do not transport people or equipment on the tractor.



ATTENTION

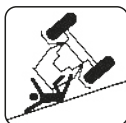

There are risks of severe injuries due to tipping when working in sloped terrains. Do not over speed.



ATTENTION



Do not work with the tractor if the front has insufficient ballast to the rear equipment. Should there be a trend to lift, add weights or ballasts to the front or the front wheels.



ATTENTION



Before performing any maintenance in your equipment, make sure it is properly stopped. Avoid being run over.



ATTENTION



Be careful when handling the CABC support leg, as there is a risk of accidents.

▪ Safety Rules

! ATTENTION FOLLOW ALL RECOMMENDATIONS, WARNINGS AND SAFE PRACTICES RECOMMENDED IN THIS MANUAL, UNDERSTAND THE IMPORTANCE OF YOUR SAFETY. ACCIDENTS MAY LEAD TO DISABILITY OR INCLUDING DEATH. REMEMBER, ACCIDENTS CAN BE AVOIDED!

! ATTENTION



Do not make adjustments with the CABC in operation.

When doing any service on the CABC, turn off the tractor first.

Use appropriate tools.

! ATTENTION



Avoid heating parts near the fluid lines.

Heating may generate fragility in the material, rupture and exit of the pressurized fluid, causing burns and injuries.

! ATTENTION

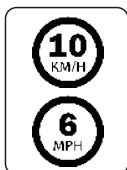

When working/transporting the CABC, do not exceed the speed of 10 Km/h or 6 MPH, avoiding risks of damages and accidents.

! ATTENTION



Before commencing work or transportation to CABC, check for any nearby persons or obstruction.

! ATTENTION

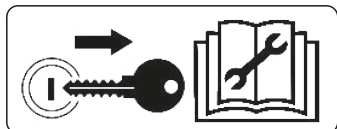

Remove the ignition key before performing any maintenance on the CABC. Protect yourself from possible injury or death caused by an unforeseen CABC start up.

If the CABC is not properly engaged, do not start the tractor.

! ATTENTION



Hydraulic oil works under pressure and may cause serious injuries if there are any leakages.

Periodically check hoses for conservation. If there are any sign of leakage, replace them immediately. Before connecting or disconnecting hydraulic hoses, relief system pressure by activating the command with the tractor power switched off.

▪ Safety Rules

ATTENTION



Always maintain places of access and work free of residues such as oil or grease to prevent accidents.

ATTENTION

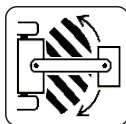

Keep the joint area free while the CABC is in operation.

In closed curves, prevent tractor wheels from touching the head.

ATTENTION



Disposing of waste improperly affects the environment and the environment, as it will pollute rivers, canals

or the soil.

Inform yourself about the proper way of recycling or disposing residues.

PROTECT THE ENVIRONMENT!

ATTENTION

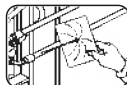

When looking for possible leaks in hoses, use a cardboard or wood, never use your hands. Avoid fluid incision into the skin.

ATTENTION



Never weld the tire-mounted wheel, the heat may cause increased air pressure and cause the tire to burst.

When filling the tire, position yourself besides the tire, never in front of it. To inflate a tire, always use a containment device (inflation cage).

▪ Safety Rules

ATTENTION

When operating or transporting the agricultural wagon, keep away from electric transmission lines, low branches of trees and other overhead obstructions, avoiding serious injury or even death.

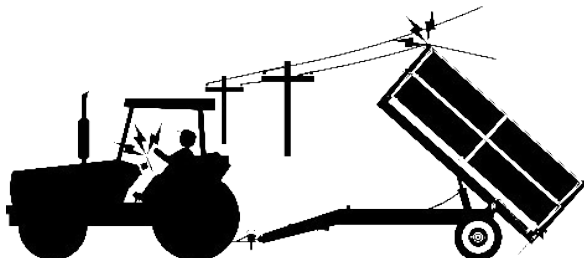

ATTENTION

To avoid serious injuries or death, keep a safe distance from the unloading and elevation area during the operation.

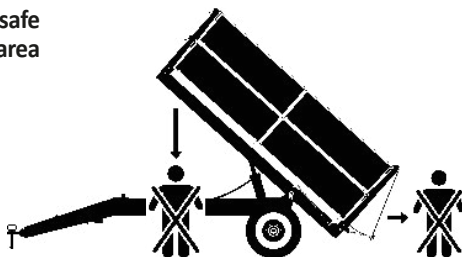

ATTENTION

Only stop CAB C in a flat location. Do not park CAB C uphill or downhill.

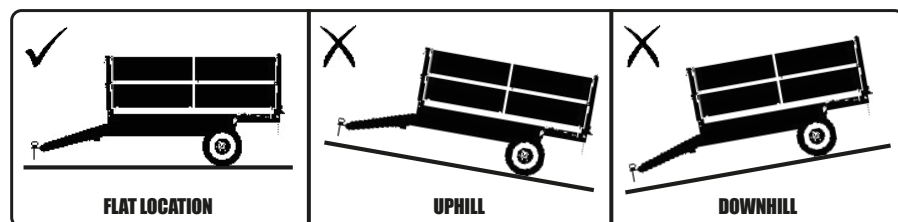

▪ Safety Rules

• PPE Equipment



ATTENTION

DO NOT WORK WITH THE CABC WITHOUT WEARING PPE (SAFETY EQUIPMENT). IGNORING THIS WARNING MAY CAUSE DAMAGES TO HEALTH, SEVERE ACCIDENTS OR DEATH.

When performing certain procedures with the **CABC**, wear the following Safety Equipment (PPE):



! IMPORTANT

Safety practice must be performed in all stages of working with the CABC, thus avoiding accidents such as impact of objects, fall, noise, cuts and ergonomics, in other words, the person responsible for operating the CABC is subject to internal and external bodily damage.



OBSERVATION

All PPEs (Safety Equipment) should have certificate of authenticity.



▪ Warnings

- ⚠ When operating with the CABC, do not let people stay close or on it.
- ⚠ When performing any maintenance service, use PPEs equipment.
- ⚠ Do not wear loose clothing, as they may get caught in the CABC.
- ⚠ When operating the tractor engine, be properly seated in the operator's seat and be aware of the full knowledge of the correct and safe handling of both the tractor and the CABC. Always put the gear shift in neutral position, unplug the power take-off gear switch and place the hydraulic controls in neutral position.
- ⚠ Do not start the motor in a closed environment or with no proper ventilation since the exhaust gases are harmful to health.
- ⚠ When maneuvering the tractor to the CABC hitch, make sure you have adequate clearance and that there are no people too close, always maneuver at idle and be prepared to brake in an emergency.
- ⚠ Do not make adjustments with the CABC in operation.
- ⚠ When working in sloped terrains, proceed with precautions, always trying to maintain the required stability. In case of imbalance, reduce acceleration, turn the wheels to the slope side of the terrain and never lift the CABC.
- ⚠ Always conduct the tractor in speeds compatible to the safety, especially during works in bumpy lands or slopes, keep the tractor always engaged.
- ⚠ When driving the tractor in highways, keep the brake pedals interconnected.
- ⚠ Do not work with the tractor with light rear. If the rear has a tendency to lift, add more weights on the rear wheels.
- ⚠ When leaving the tractor, put the gear lever in neutral position and apply the parking brake. Never leave the CABC on the tractor in the raised position of the hydraulic system.
- ⚠ Any and all maintenance on the CABC must be done with the same stop and with the tractor off.
- ⚠ Do not travel on highways mainly at night. Use warning signs throughout the route.
- ⚠ If there is a need to travel with the CABC on the highways, consult the traffic agencies.
- ⚠ Do not allow the use of CABC by people who have not been trained, that is, who do not know how to operate it correctly.
- ⚠ Do not transport or work with the CABC near obstacles, rivers or streams.
- ⚠ The transportation of people in self-propelled machines and implements is prohibited.
- ⚠ Changes to the original CABC characteristics are not allowed, as they may alter the safety, operation and life of the CABC.
- ⚠ Read or explain all the procedures of this manual to the operator who cannot read.

▪ Warnings

 Always check that the CABC is in perfect conditions of use. In the event of any irregularity that may interfere with the operation of the CABC, ensure proper maintenance before any work or transportation.

 Maintenance and especially inspection in CABC risk areas should be done only by a qualified or qualified worker, observing all safety guidelines. Before starting maintenance, disconnect all CABC drive systems.

 Periodically check all components of the CABC before using it.

 Due to the equipment used and work conditions on field or in maintenance areas, precautions are required. Baldan has no direct control over precautions, so it is the owner's responsibility to implement safety procedures while working with CABC.

 Check the recommended minimum tractor power for each CABC model. Only use tractor with power and ballast compatible with the load and topography of the terrain.

 When transporting the CABC, travel at speeds compatible with the terrain and never exceed 10 km/h, as this reduces maintenance and consequently increases the life of the CABC.

 Never disconnect the CABC with the product in the bucket. Ignoring this warning may cause a risk of tipping accident.

 Alcoholic beverage or some medications may cause loss of reflexes and change the operator's physical conditions. Therefore, never operate this CABC under the influence of these substances.

 Read or explain all the procedures of this manual to the operator who cannot read.

In case of doubts, refer to Post-Sales.

Telephone: 0800-152577 / E-mail: posvenda@baldan.com.br

▪ Components

• CABC - Coffee Wagon with Articulated Dumping System

1. Frame
2. Coupling shackle
3. Lifting support
4. Hydraulic hoses
5. Lower front cover
6. Upper front cover
7. Tailgate
8. Lower lateral cover
9. Upper lateral cover
10. Chain
11. Wheel hub
12. Tires
13. Hydraulic cylinder

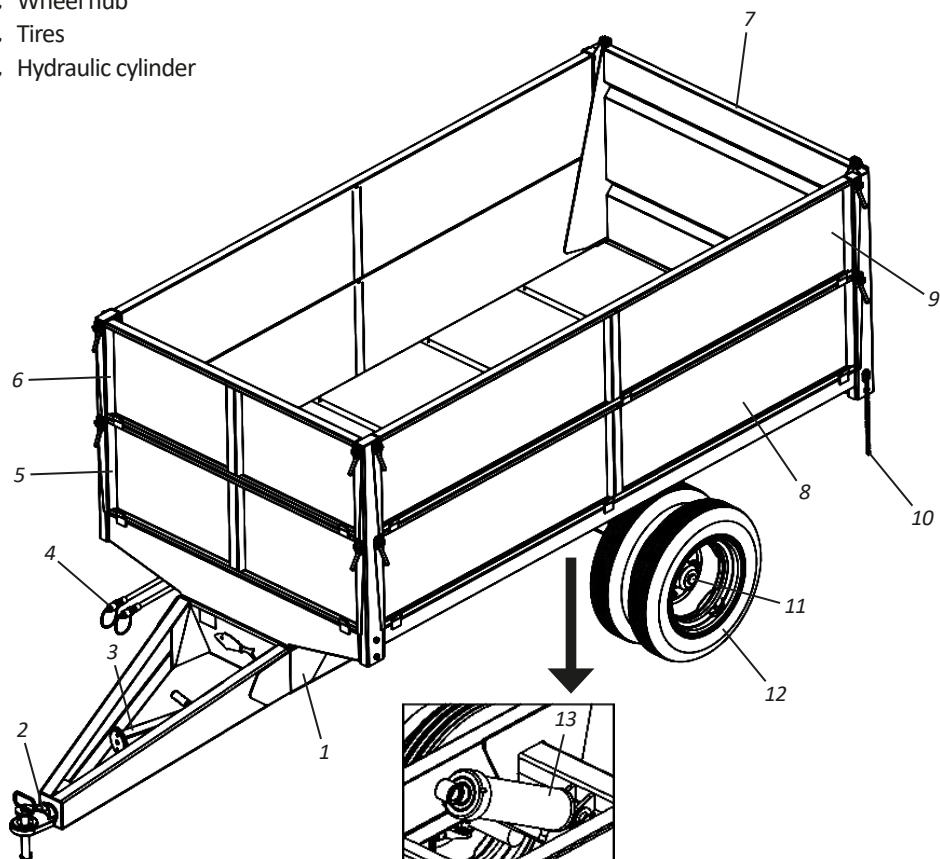

▪ Dimensions

• CABC - Coffee Wagon with Articulated Dumping System - Part I

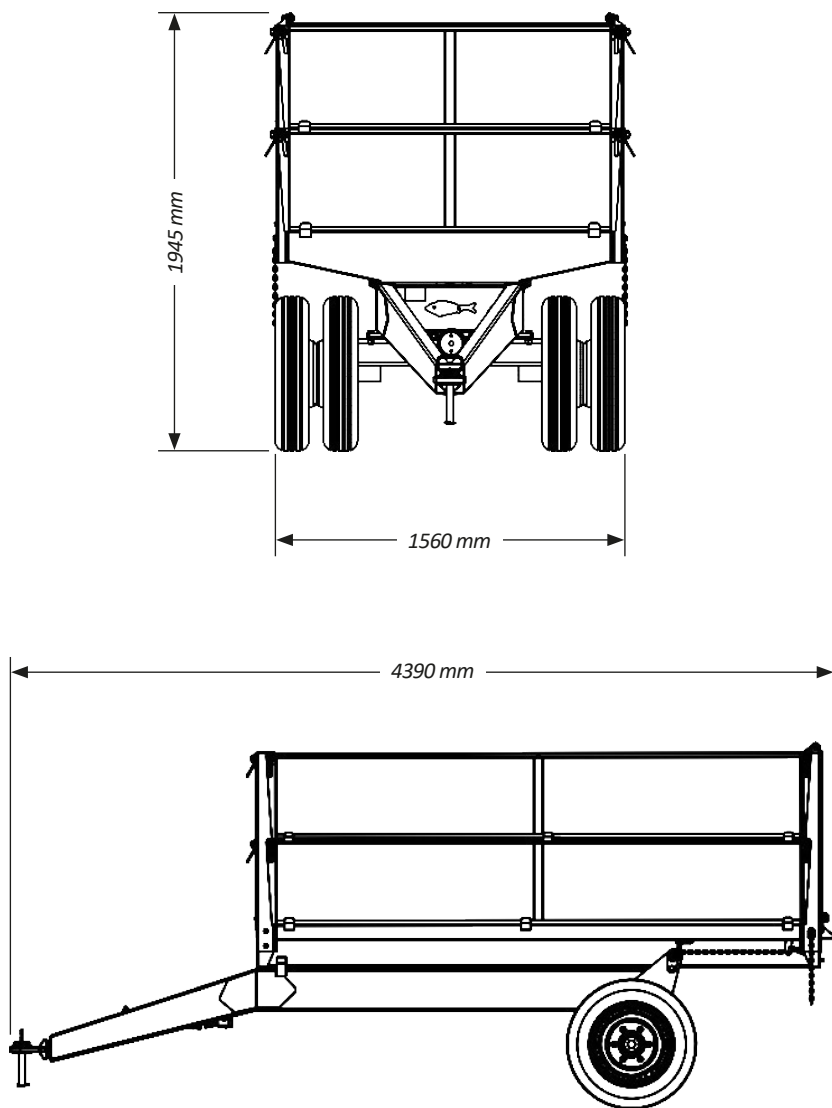

▪ Dimensions

• CABC - Coffee Wagon with Articulated Dumping System - Part II

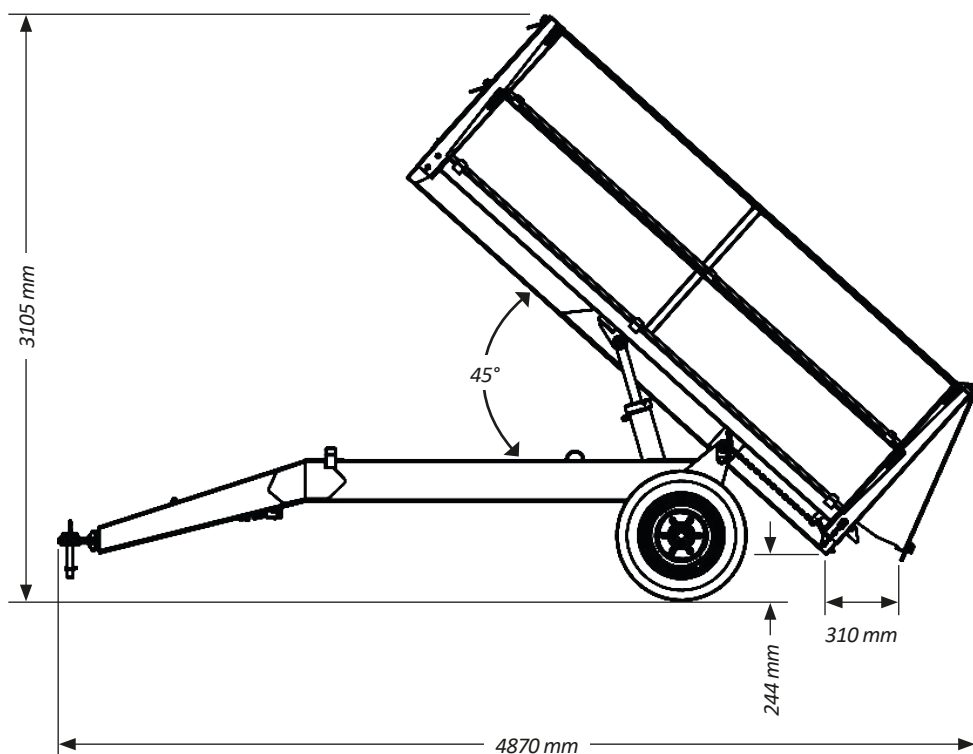

▪ Specifications

• CABC - Coffee Wagon with Articulated Dumping System

Model	Load Capacity (m³)	Bucket inner width (mm)	Bucket inner height (mm)	Bucket inner length (mm)	Approx. Weight (Kg)	Tractor Power (Hp)
CABC	3,80	1435	917	2915	796	70

Double wheel gauge - External measure (mm) 1560
 Rear opening automatic

*Baldan reserves the right to change and/or perfect the technical characteristics of its products, without previous notice, and without obligation to proceed in the same way with the products previously manufactured.
 Technical specifications are approximate and informed under normal work conditions.*

INTENDED USE OF THE CABC

- **CABC** is dedicated to collecting coffee from the fields.
- The **CABC** must be conducted and operated only by a properly instructed operator.

UNAUTHORIZED USE OF THE CABC

- To avoid damage, serious accident or death, do not transport people over any part of the **CABC**.
- Using the **CABC** to hitch, tow or push other implements or accessories is not allowed.
- The **CABC** must not be used by an inexperienced operator who is not familiar with all driving, command and operation techniques.

▪ Assembly

When **CABC** is sold to the domestic market, it leaves the factory semi-assembled and when sold to the foreign market, it leaves the factory disassembled both situations to facilitate loading and transportation. To set up the **CABC**, follow the instructions below and on the following pages:

- ⚠ The **CABC** must be assembled by the resale, through trained and qualified personnel for this work.
- ⚠ Before assembling the **CABC**, look for an ideal location where you can easily identify its parts and assembly.
- ⚠ Do not wear loose clothing, as they may get caught into the **CABC**.

▪ Assembly

• Assembly shackle

To mount the shackle on the frame, proceed as follows:

- 01** - Couple the shackle (1) on the flat washer (2) and on the frame (3), fixing through the flat washer (4), nut (5) and cotter pin (6).

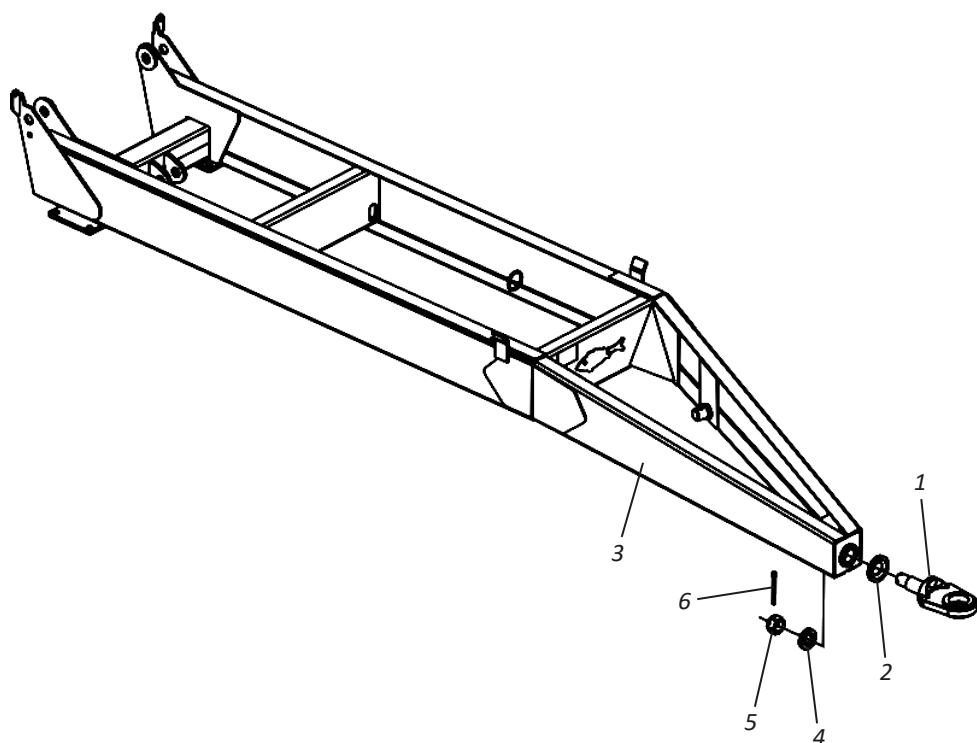

▪ Assembly

• Assembly wheel axle

To mount the wheel axle on the frame, proceed as follows:

- 01** - Couple the wheel axle (1) to the frame (2) fixing it through the screws (3), lock washers (4) and nuts (5).

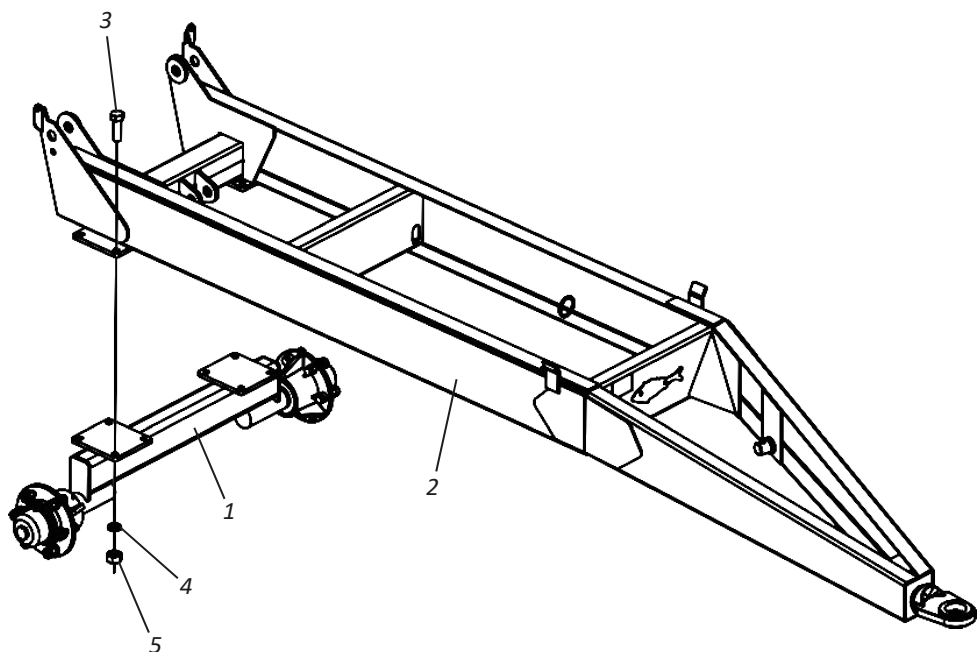

▪ Assembly

• Assembly the dual tires

To mount the dual tires on the wheel axle, proceed as follows:

- 01** - First, place the tire (1) on the axle hub (2) in reverse, that is, with the inner part of the rim facing outwards, through the screws (3).
- 02** - Then, attach the tire (4) in a normal way, fixing it through the nuts and counter nuts (5).

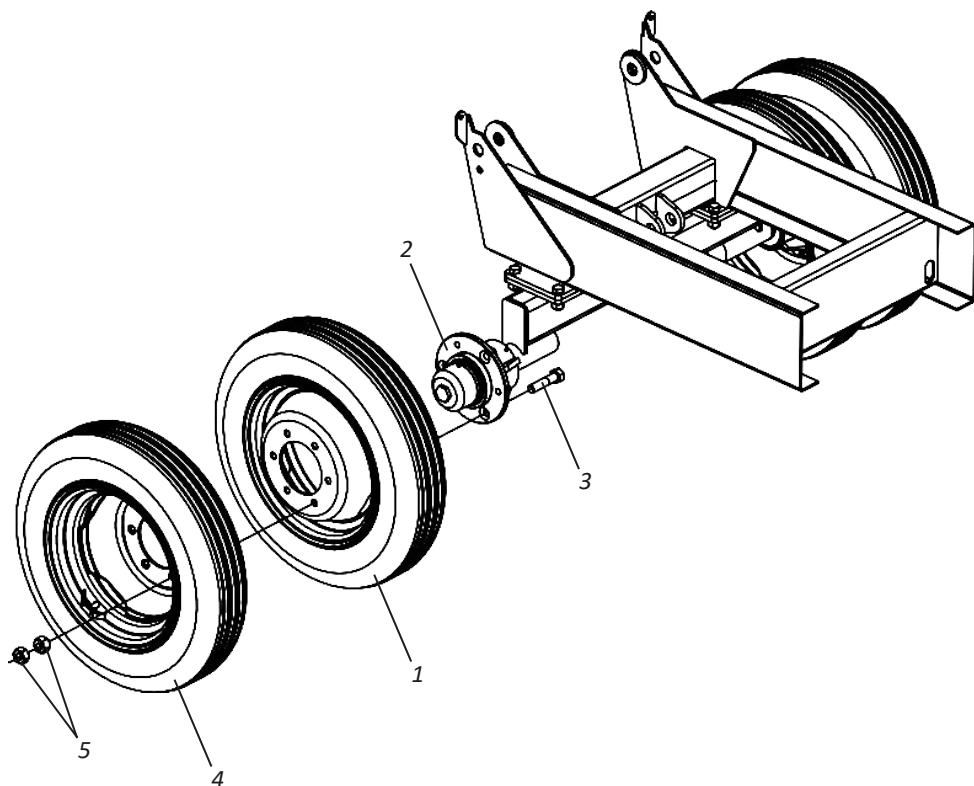

ATTENTION

Check for correct tire inflation
on page 37.

▪ **Assembly**

• **Assembly lift bracket**

To mount the lifting bracket, proceed as follows:

01 - Attach lift bracket (1) to hitch header (2) and lock with pin (3) and latch (4).

02 - Then, place the puller pin (5) on the yoke (6) and lock it with the ring pin (7).

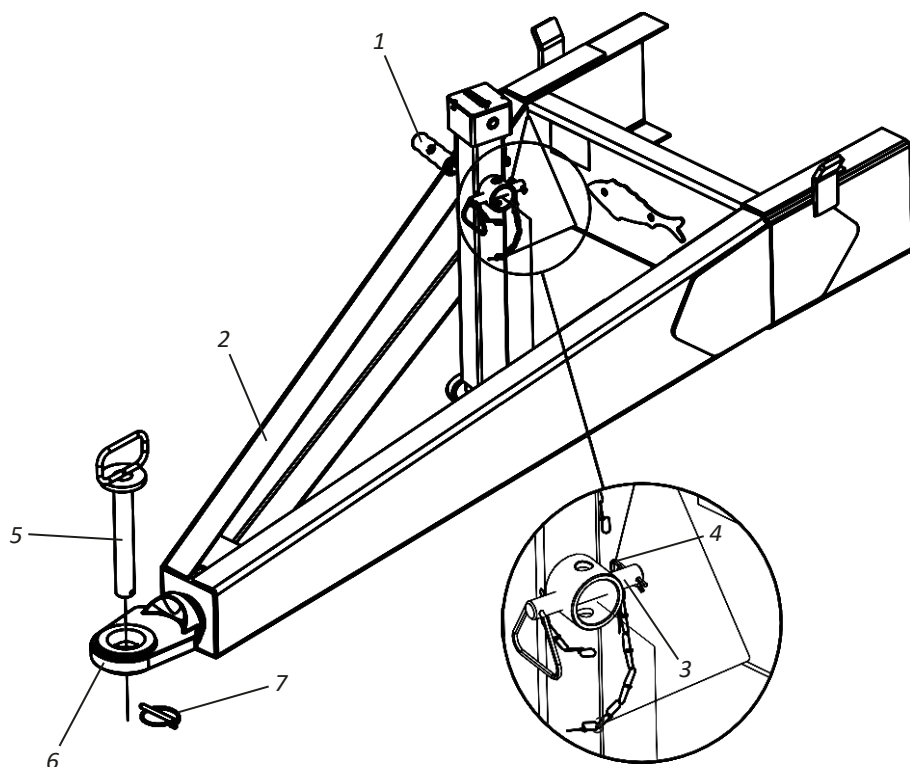

ATTENTION

Before starting the assembly of the bucket base according to the instructions on the following page, adjust the lifting bracket (1) leaving the upright level.

▪ Assembly

• Assembly bucket base

To assemble the bucket base, proceed as follows:

- 01** - Attach the bucket base (1) to the upright (2) and lock it with the pins (3), lock washers (4) and screws (5).
- 02** - Then place the hooks (6) on the upright (2) with the nuts (7), lock washers (8) and nuts (9).

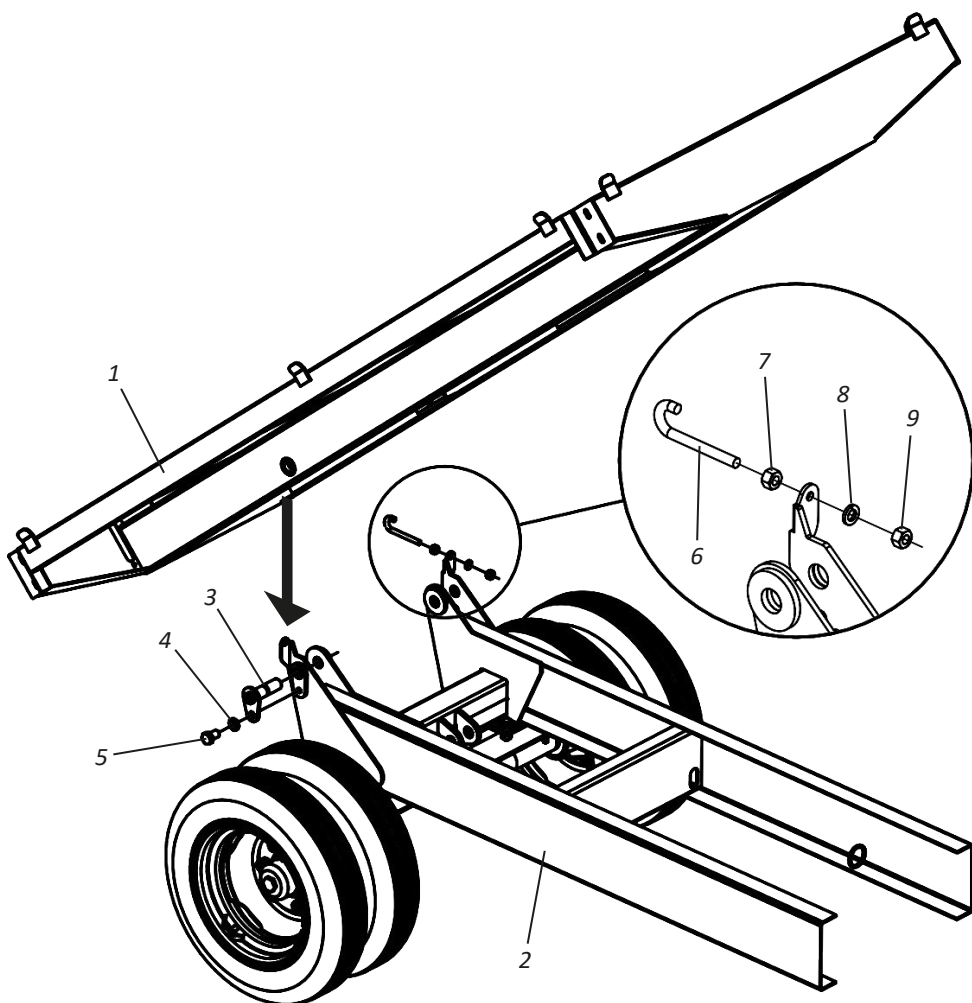

▪ Assembly

• Assembly hydraulic cylinder and hydraulic hoses

To assemble the hydraulic cylinder and hydraulic hoses, proceed as follows:

- 01** - Attach the hydraulic cylinder base (1) to the upright (2), fixing through the pin (3), flat washer (4) and cotter pin (5).
- 02** - Then, fix the hydraulic cylinder rod (1) to the bucket base (6) through the pin (7), flat washers (8) and cotter pin (9).
- 03** - Then attach the hydraulic hoses (10) to the hydraulic cylinder (1).

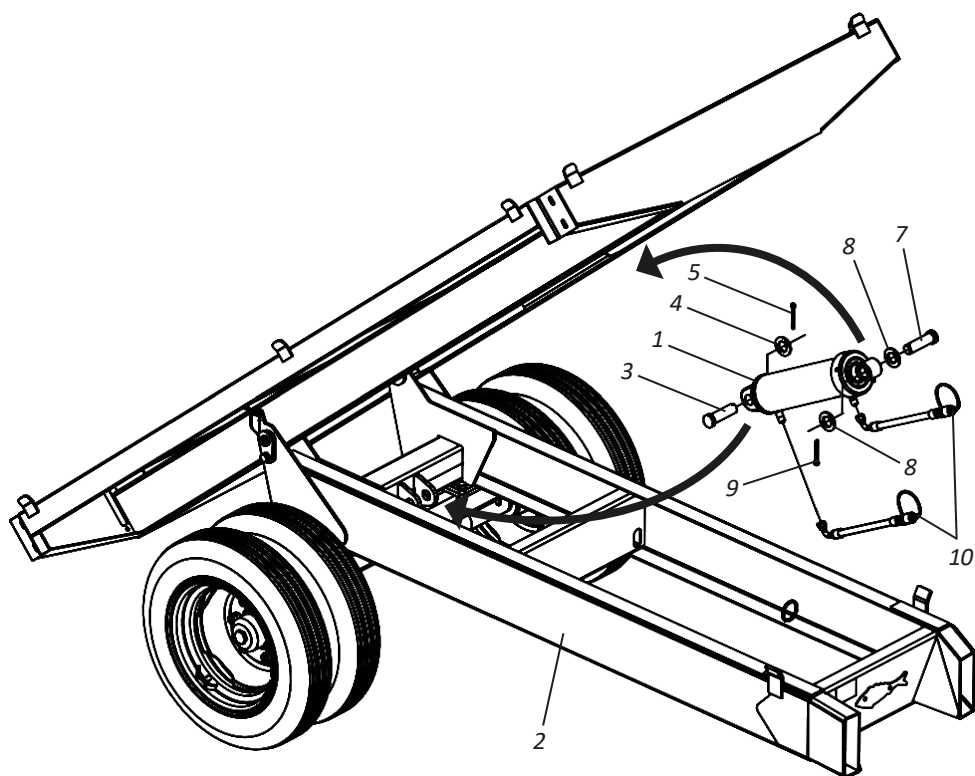

▪ Assembly

• Assembly the lock system

To assemble the locking system, proceed as follows:

- 01** - Fix the lock (1) on the chassis (2) through the pin (3) and cotter pin (4).
- 02** - Then fix the pin (5) on the chassis (2) through the lock washer (6) and nut (7).
- 03** - Then fix the spring (8) on the pin (5) and on the lock (1).
- 04** - Finish by attaching the chain (9) to the hook (10).

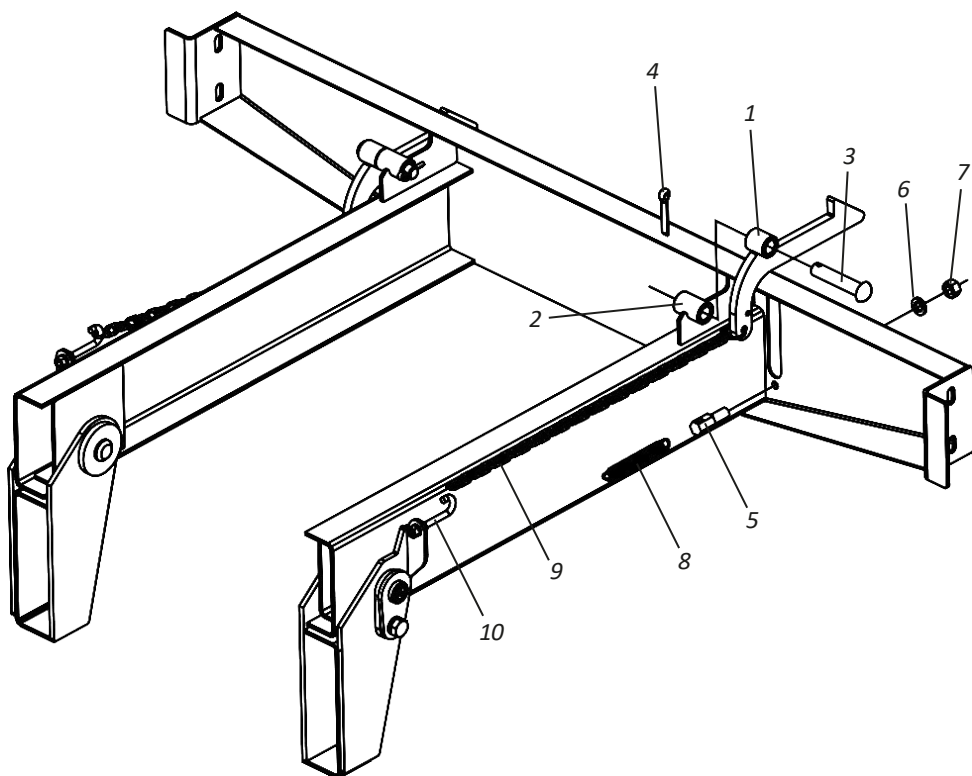

▪ Assembly

• Assembly the rear and front support beams

To assemble the rear and front support beams, proceed as follows:

REAR SUPPORT BEAMS

01 - Attach the rear support beams (1) and chains (2) to the upright (3), fixing through screws (4), flat washers (5), lock washers (6) and nuts (7).

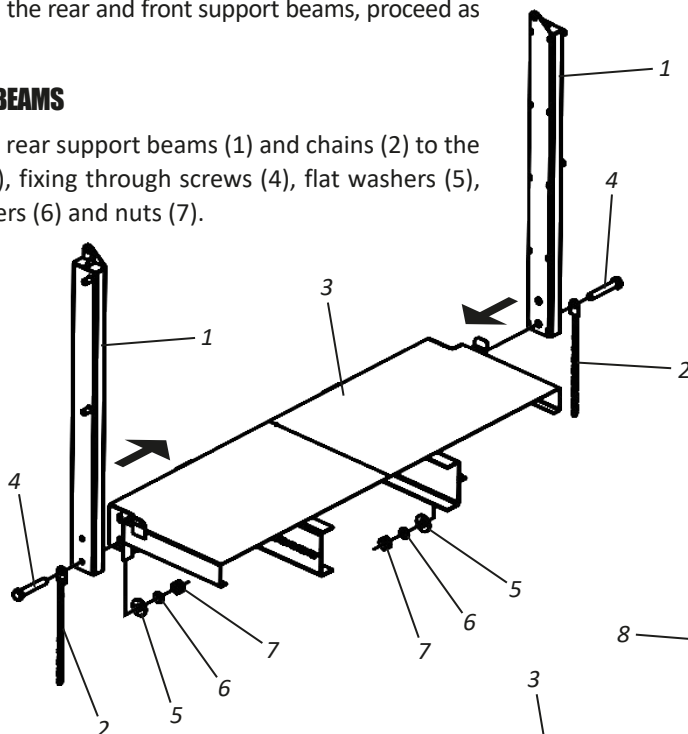

FRONT SUPPORT BEAMS

02 - Attach the front support beams (8) to the upright (3), fixing through the screws (9), flat washers (10), lock washers (11) and nuts (12).

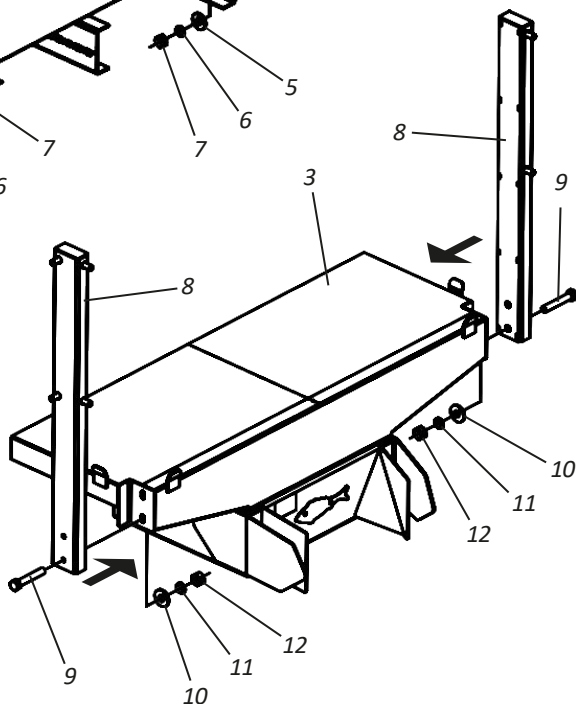

■ Assembly

• Assembly of the lower plates

The **CABC** plates are self-adjusting and easy to assemble and remove. To assemble the lower plates, we advise you to assemble them one at a time, proceed as follows:

01 - Fix the lower side plates (1) on the upright (2) through the lock nuts (3).

02 - Then, fix the lower front plate (4) to the upright (2) through the lock nuts (5).

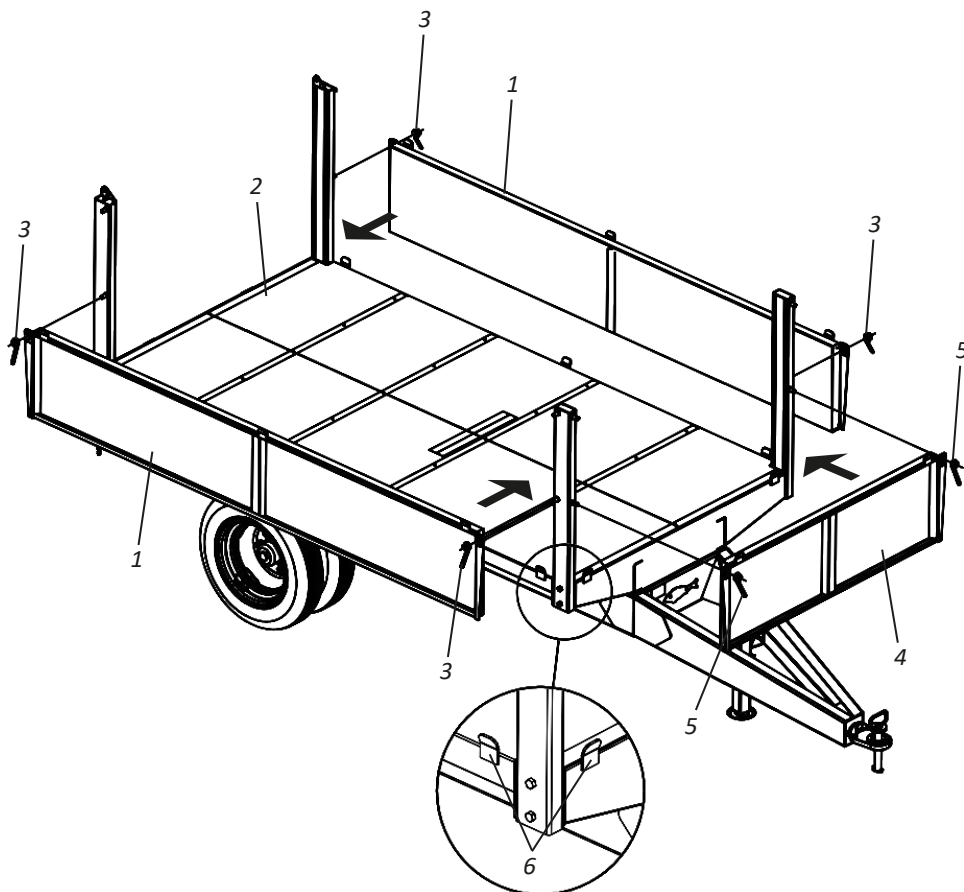

The lower side plates (1) and the lower front plate (4) must fit behind the latches (6).

▪ **Assembly**

• **Assembly of the upper plates**

After assembling the lower plates, assemble the upper plates, proceed as follows:

01 - Fix the lower side plates (1) on the upright (2) through the lock nuts (3).

02 - Then, fix the lower front plate (4) to the upright (2) using the lock nuts (5).

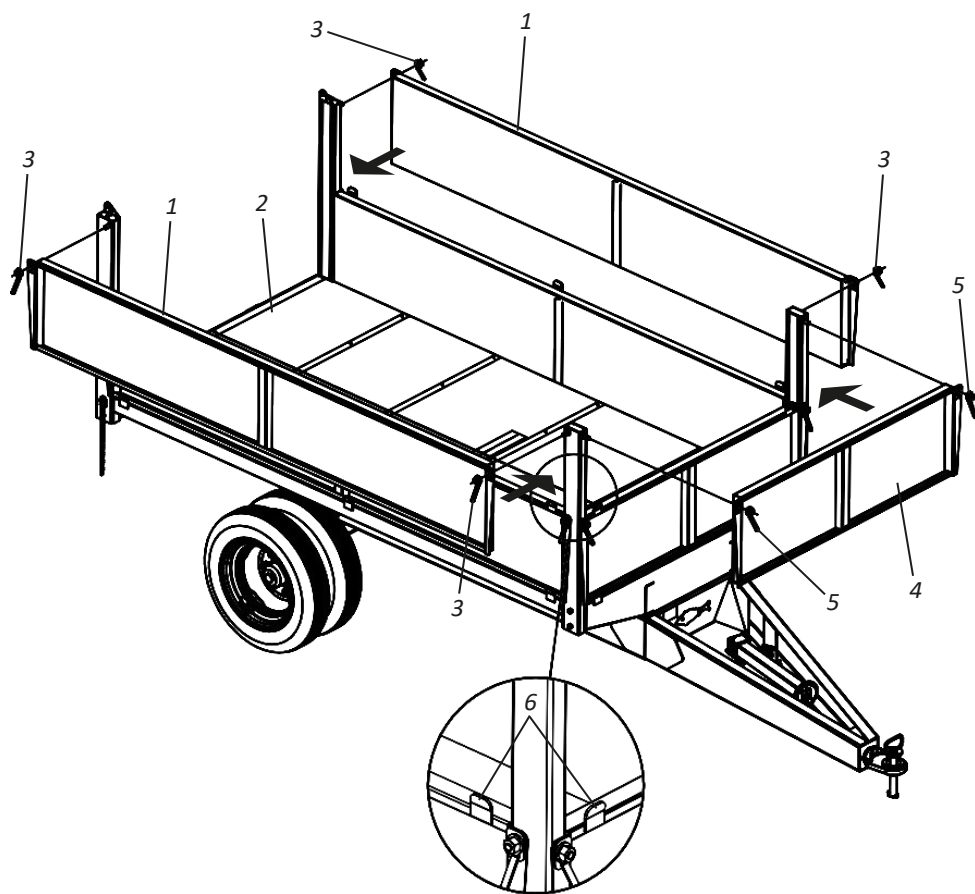
**NOTE**

The upper side plates (1) and the upper front plate (4) must fit behind the latches (6).

▪ Assembly

• Assembly rear cover

Finish assembling the **CABC** by fixing the rear cover, proceed as follows:

- 01** - Fix the rear cover (1) to the rear support beams (2 and 3) using screws (4), bushings (5), lock washers (6) and nuts (7).
- 02** - Then, fix the chains (8) in the hooks (9) of the rear cover (1).

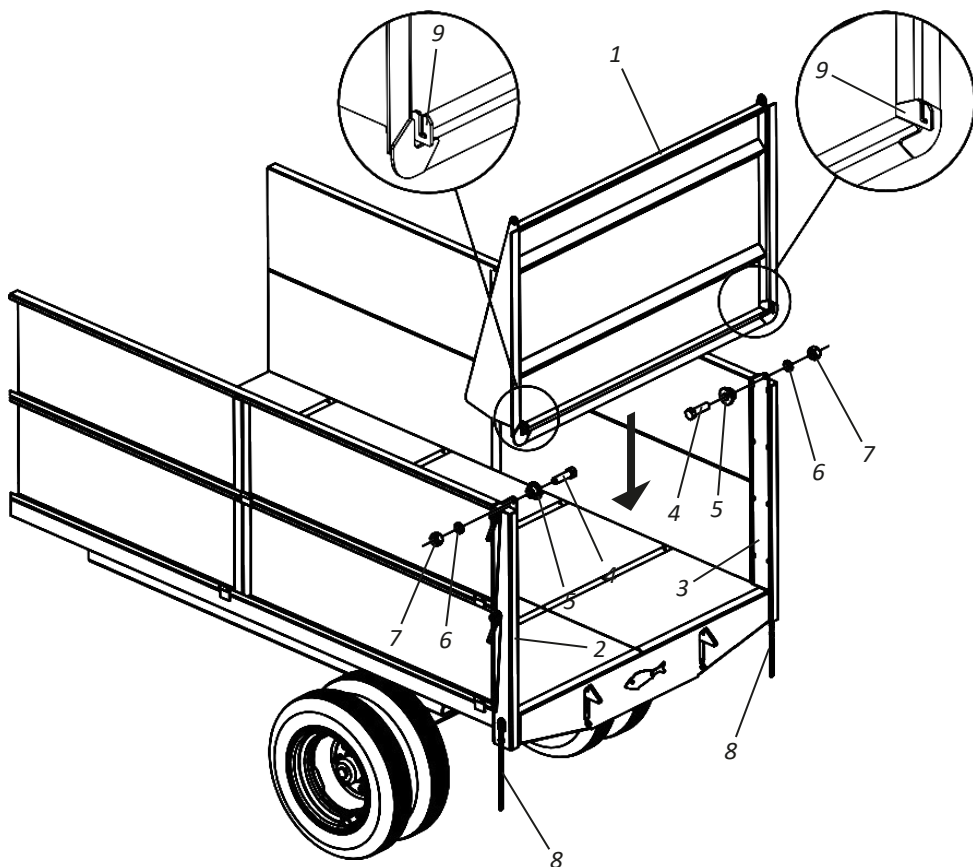

ATTENTION When completing the assembly of the rear cover (1), do a general overhaul of the CABC, checking all the assembled components before starting work.

▪ Hitch

• Tractor hitch

To attach the **CABC** to the tractor's drawbar, follow the instructions below:

Before attaching the **CABC**, look for a safe and easily accessible place.

- Always use low gear with low throttle.
- Before connecting or disconnecting the hydraulic hoses, stop the engine and relieve the pressure in the circuit, operating the control levers fully.
- Make sure that when relieving system pressure, no one is injured when moving the equipment.

Following the instructions above, proceed as follows:

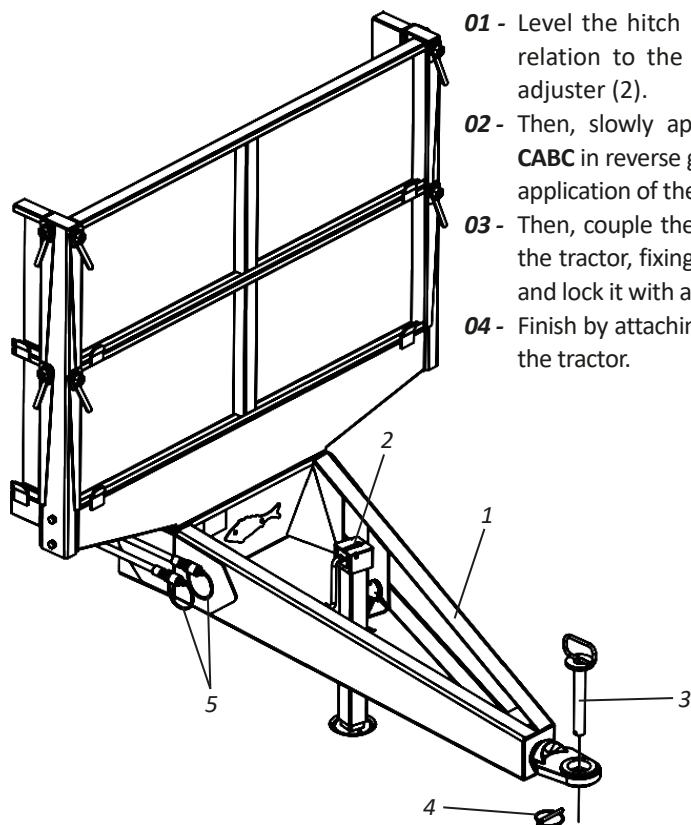

01 - Level the hitch header (1) of the **CABC** in relation to the tractor hitch through the adjuster (2).

02 - Then, slowly approach the tractor to the **CABC** in reverse gear, paying attention to the application of the brakes.

03 - Then, couple the header (1) of the **CABC** to the tractor, fixing it through the hitch pin (3) and lock it with a ring (4).

04 - Finish by attaching the hydraulic hoses (5) to the tractor.

▪ Hitch

• Support bracket position

The support bracket must be in a vertical or horizontal position according to the guidelines below. To position the support bracket, proceed as follows:

01 - Unlock the support bracket (1), rotate it vertically or horizontally and lock it.

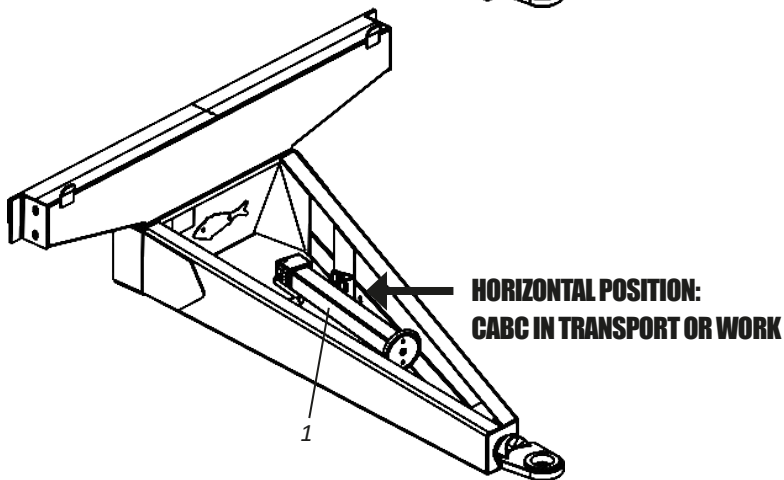
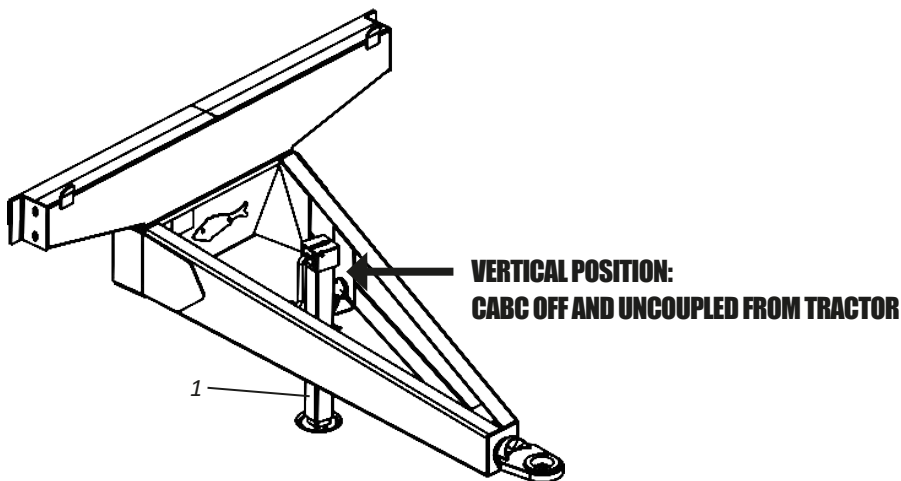

ATTENTION Do not work or transport the CABC with the support bracket (1) in an upright position. Ignoring this warning could cause damage or serious accidents.

▪ Leveling

• Agricultural wagon leveling

To level the **CABC**, proceed as follows:

- 01** - First, the tractor must be on level ground.
- 02** - Then, level the agricultural wagon, observing the longitudinal leveling (length) in relation to the ground from the side.
- 03** - Otherwise, it must be leveled through the tractor's drawbar, using the height that results in the best leveling of the **CABC**.

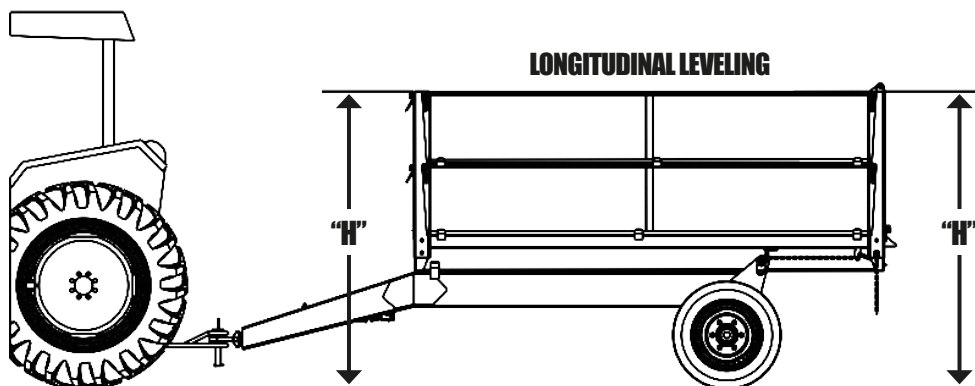

ATTENTION

Read the tractor's instruction manual and make sure the positions in which you can work with the traction.

▪ Adjustments

• Rear cover disarm and reset adjustment

The **CABC** has a rear cover disarm and reset system, allowing the operator to carry out the work without leaving the tractor. To adjust the disarming and resetting of the rear hatch, proceed as follows:

- 01** - Adjust the chain (1) through the hook (2) adjusting it in order to obtain a perfect disarming and resetting of the rear cover (3) through the locks (4).

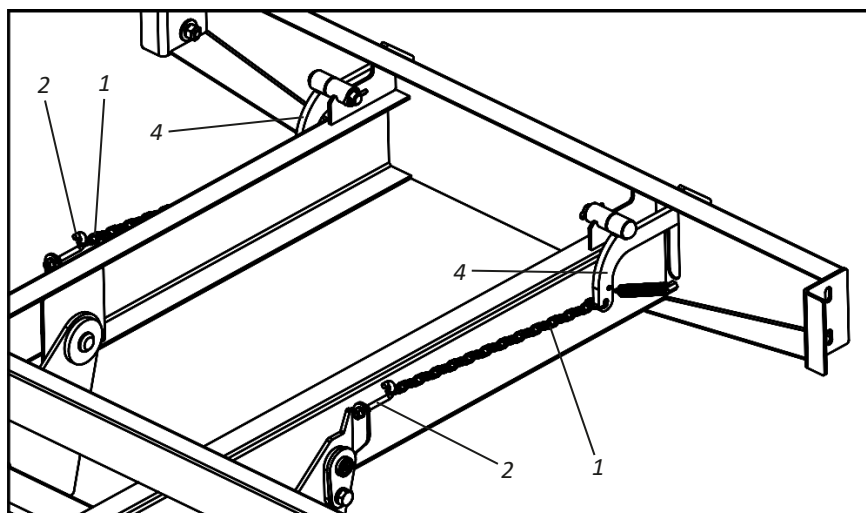

ATTENTION

In order for there to be synchronism in the disarming and resetting of the rear cover (3), the adjustment of the currents (1) must be the same on both sides.

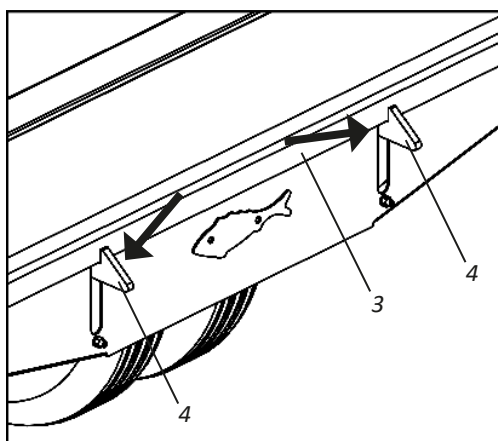

▪ Adjustments

• Rear cover opening adjustment

The **CABC** has a rear cover opening adjustment system allowing the operator to limit the amount to be dumped when tilting the bucket. To adjust the opening of the back cover, proceed as follows:

- 01** - Engage the chains (1) in the locks (2) of the back cover (3) so that they are tighter or looser, giving the back cover (3) greater or lesser opening.

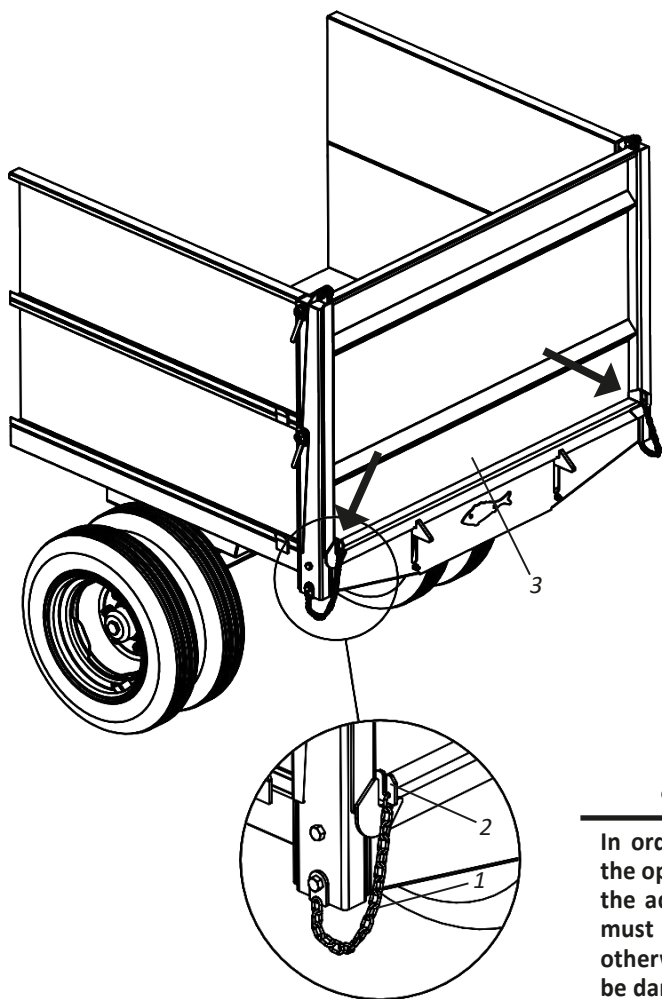

ATTENTION

In order to have synchronism in the opening of the back cover (3), the adjustment of the chains (1) must be the same on both sides, otherwise, the back cover (3) may be damaged when tilting.

▪ Operations

• Operating recommendations

The preparation of the **CABC** and the tractor will allow you to save time in addition to obtain better result in the field work. The following suggestions may be useful for you.

GENERAL RECOMMENDATION

- 01** - Before starting work/transport, make a general overhaul on the coffee wagon and check that the tires are properly calibrated and in good condition.
- 02** - Adjust the tractor according to the contents of the instruction manual, always using the front and rear weights to stabilize the equipment.
- 03** - Always do the coupling to the tractor at slow speed and with great care.
- 04** - Check that the **CABC** hitch is complete and level. Place the support bracket in the transport position and keep the tractor drawbar fixed.
- 05** - After the coupling is made, the next adjustments will be made directly in the field of work, analyzing the terrain in its texture, humidity and the types of operations to be done with the **CABC**.
- 06** - Observe the working / transport speeds specified on page 10, do not exceed them. The speed when excessive, causes high accelerations of the masses or loads that originate forces above the normal resistance of the components causing damage to the **CABC**.
- 07** - During work/transport, the tractor drawbar must remain fixed.
- 08** - Do not transport or work with excessive load on the **CABC**.
- 09** - When performing any maintenance on the **CABC**, the engine must be turned off.
- 10** - Do not make sharp turns with the **CABC** during work or transportation.
- 11** - The **CABC** has several settings, but only local conditions can determine the best setting.
- 12** - Do not keep the **CABC** charged overnight or for long periods.
- 13** - Observe the lubrication intervals.
- 14** - The weight of the product is related to its granulometry and density.

If in doubt, never operate or handle the CABC, see Post Sale.
Telephone: 0800-152577 / E-mail: posvenda@baldan.com.br

▪ Maintenance

The **CABC** has been developed to provide maximum performance over land conditions. Experience has shown that periodic maintenance of certain parts of the **CABC** is the best way to help you avoid problems, so we suggest checks.

• Tires pressure

The tires should always be properly calibrated avoiding early wear due to excess or lack of pressure.

STANDARD: TIRES 600 X 16 - 6 CANVAS
USE: 44 LBS/POL²

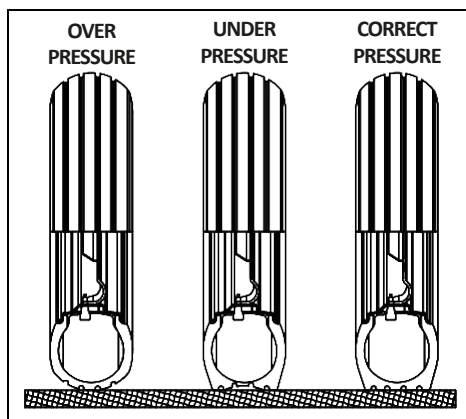

OPTIONAL: TIRES 650 X 16 - 8 CANVAS
USE: 54 LBS/POL²

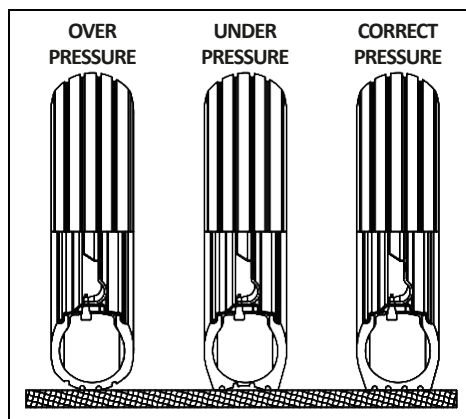

ATTENTION

Never weld the wheel mounted with tire, the heat may cause air pressure increase and provoke the explosion of the tire.

When filling the tire, position yourself besides the tire, never in front of it.

To fill the tire, always use containment device (armor cage).

Assemble the tires with proper equipment. The service should only be performed by people qualified for the work.

IMPORTANT

When calibrating tires, do not exceed the recommended calibration.

NOTE

The pressure of the tractor tires should be performed according to the manufacturer's recommendation.

■ Maintenance

• Changing tires

If necessary, change or repair the tires for this, proceed as follows:

- 01** - Loosen the nuts and locknuts (1).
- 02** - Then remove the tire (2 or 3) that needs to be replaced or repaired.
- 03** - Then, couple the tire again by securing it.

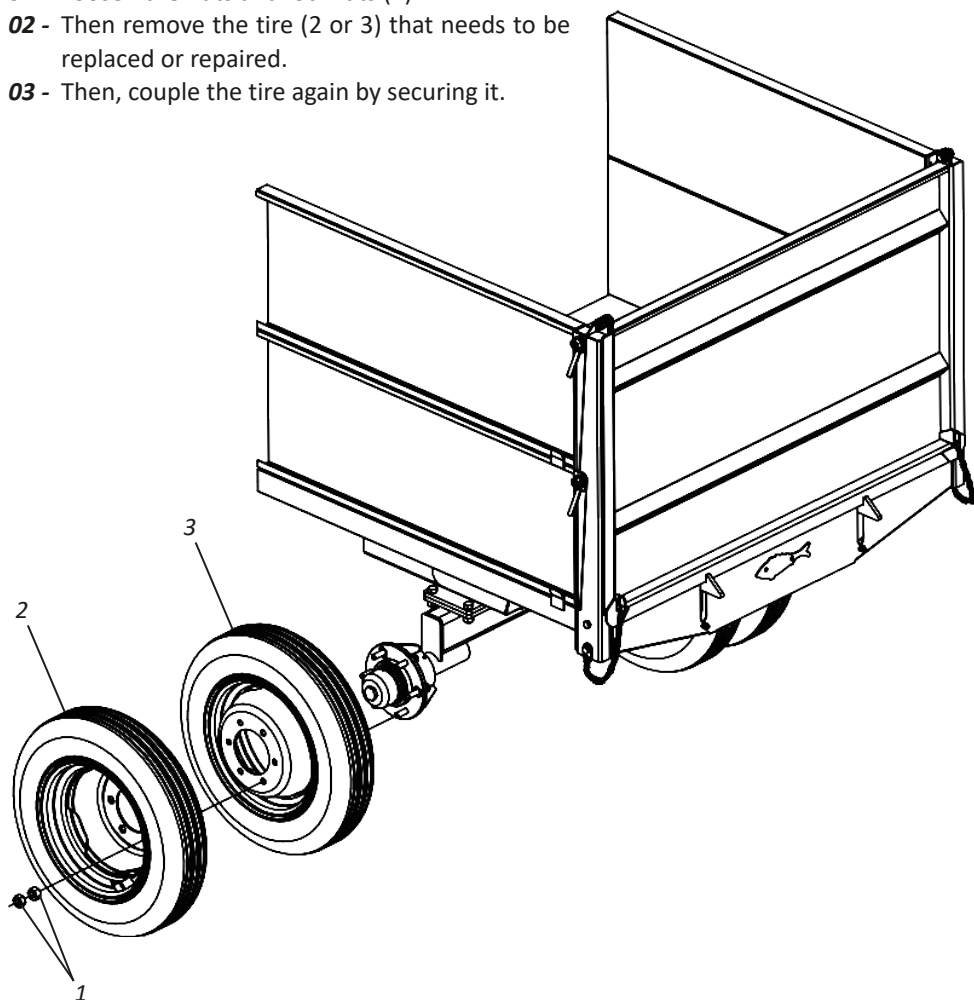

Before changing or repairing the tire, make sure that the CAB is properly supported. Failure to do so can cause damage, serious accidents or even death.

▪ Maintenance

The **CABC** has been developed to provide maximum performance over land conditions. Experience has shown that periodic maintenance of certain parts of the **CABC** is the best way to help you avoid problems, so we suggest verification.



ATTENTION

Check nuts and bolts constantly, if necessary, retighten them. General harrow retention maintenance should be done every 8 hours of work.

• Lubrification

Lubrication is indispensable for the good performance and durability of **CABC** moving parts, contributing to the maintenance cost savings.

Before starting the operation, carefully lubricate all grease cups, always observing the lubrication intervals in the following pages. Make sure of the lubricant quality regarding its efficiency and purity, avoiding products contaminated by water, dust and other agents.

• Table of greases and equivalents

Manufacturer	Types of grease recommended
Petrobrás	Lubrax GMA-2
Atlantic	Litholine MP 2
Ipiranga	Ipiflex 2
Castrol	LM 2
Mobil	Grease MP
Texaco	Marfak 2
Shell	Alvania EP 2
Esso	Multi H
Bardahl	Maxlub APG-2EP
Valvoline	Palladium MP-2
Petronas	Tutela Jota MP 2 EP
	Tutela Alfa 2K
	Tutela KP 2K



ATTENTION

If there are equivalent manufacturers and/or brands that are not listed in the table, consult the manufacturer's technical manual.

▪ Maintenance

- Lubrification every 10 hours of work

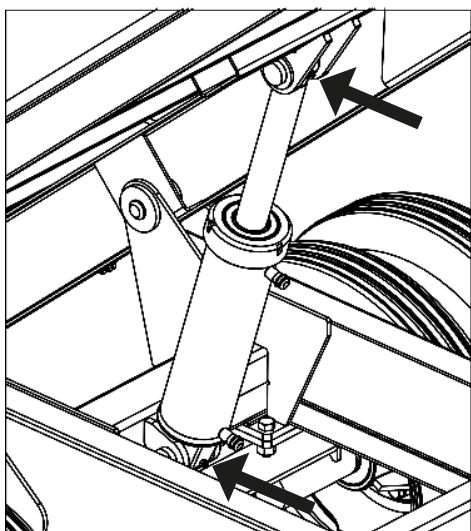
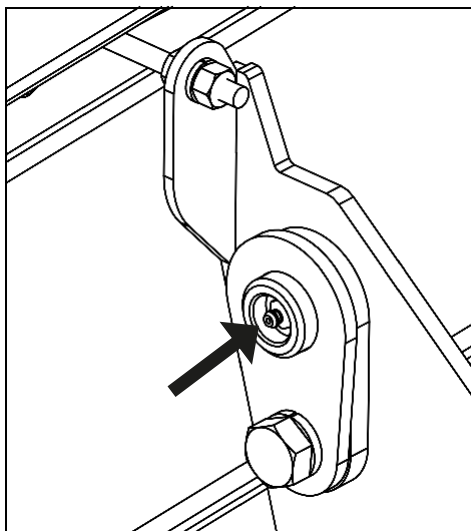

ATTENTION

When lubricating the CABC, do not exceed the amount of new grease. Introduce an adequate amount.

▪ Maintenance

- Lubrification every 30 hours of work

ATTENTION

When lubricating the CABC, do not exceed the amount of new grease. Introduce an adequate amount.

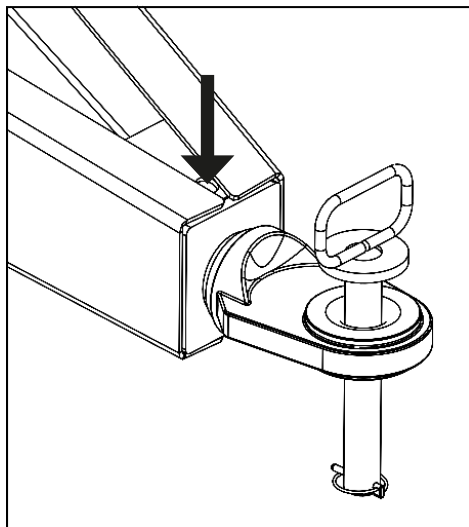

- Lubrification every 60 hours of work

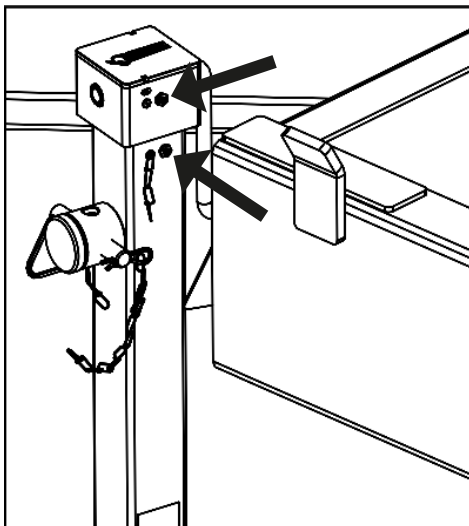
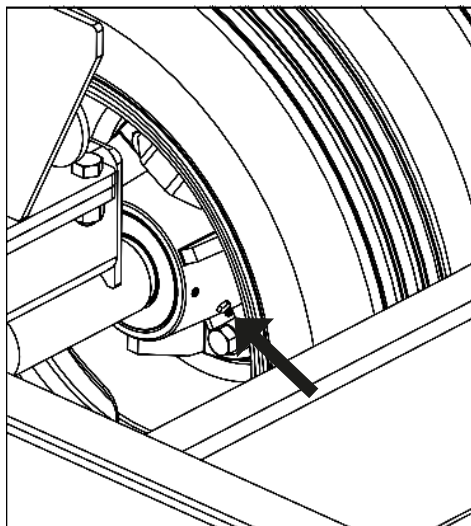

▪ Maintenance

• Cares

- 01** - Before each job, check the condition of all hoses, pins and bolts. Where necessary, retighten them.
- 02** - The displacement speed should be carefully controlled according to the land's conditions.
- 03** - The **CABC** is used in several applications, requiring knowledge and attention during handling.
- 04** - Only local conditions can determine the best method of operation of **CABC**.
- 05** - When assembling or dismantling any part of the **CABC**, employ appropriate methods and tools.
- 06** - Carefully observe the lubrication intervals in the various lubrication points of the **CABC**. Respect the lubrication intervals.
- 07** - Always check if the parts have wears. If there is a need for replacement, always demand Baldan original parts.
- 08** - Keep **CABC** tires always inflated.



IMPORTANT

Proper and periodic maintenance are necessary to ensure the long life of **CABC**.

• General cleaning - Part I

- 01** - When storing the **CABC**, make a general cleaning and wash it thoroughly with water only. Make sure the paint has not worn out, if it did, give a general coat, pass the protective oil and fully lubricate the **CABC**. Do not use burned oil or other abrasive.
- 02** - Lubricate the **CABC** fully. Check all moving parts of the **CABC**, if they show wear or looseness, make the necessary adjustment or replacement of the parts, leaving the agricultural trailer ready for the next job.
- 03** - In the period that you do not use the **CABC**, clean the residues of products that remain in it after use.
- 04** - Spray the entire **CABC** with castor oil or preservative oil, never use burnt oil.
- 05** - After all maintenance care, store the agricultural trailer in a covered and dry place, properly supported.

Avoid: - That the hydraulic hoses be properly capped.

▪ **Maintenance**

• **General cleaning - Part II**

- 06** - When connecting or disconnecting hydraulic hoses, do not let the terminals touch the ground. Before connecting the hydraulic hoses, wipe the connections with a clean, lint-free cloth. **Do not use tow!**
- 07** - Replace all adhesives, especially those about warnings, that are damaged or missing. Make everyone aware of the importance and risks of accidents when instructions are not followed.
- 08** - After all maintenance care, store your **CABC** on a flat, covered, dry surface, away from animals and children.
- 09** - We recommend washing the **CABC** with water only at the start of work.



ATTENTION

Do not use chemical or abrasive products to wash the CABC, this could damage the paint and the stickers on the CABC.

• **Conservation of the coffee wagon - Part I**

To prolong the life and appearance of the **CABC** for longer, follow the instructions below:

- 01** - Wash and clean all harrow components during and at the end of the work season.
- 02** - Use neutral products to clean the harrow, following the safety and maintenance instructions provided by the manufacturer.
- 03** - Always carry out maintenance during the periods indicated in this manual.

• **Conservation of the coffee wagon - Part II**

The practices and care below if adopted by the owner or operator make a difference to the conservation of the **CABC**.

- 01** - Be careful when performing high-pressure washing; do not direct the water jet directly into the connectors and electrical components. Isolate all electrical components;
- 02** - Use only NEUTRAL detergent and water (pH equal to 7);
- 03** - Apply the product, following the manufacturer's instructions strictly, on the wet surface and in the correct sequence, respecting the time of application and washing;

■ Maintenance

- 04** - Stains and dirt not removed with the products should be removed with the aid of a sponge.
- 05** - Rinse the machine with clean water to remove any chemical residues.
- 06** - Do not use: - Detergents with a basic active ingredient (pH greater than 7), can attack/stain the paint on the coffee wagon.
 - **Detergents with acid active ingredient (pH less than 7), act as stripper/remover of zinc coating (the protection of parts against oxidation).**

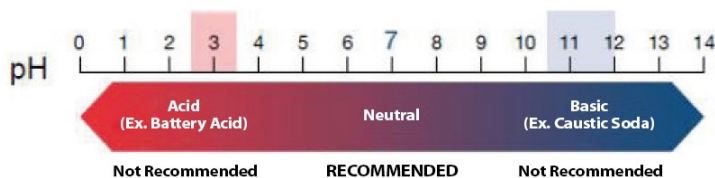

- 07** - Allow the machine to dry in the shade so that it does not accumulate water in its components. Very fast drying can cause stains on your paint.
- 08** - After drying, lubricate all chains and greases according to the recommendations in the operator's manual.
- 09** - Spray all the machine, especially the zinc parts, with protective oil, following the manufacturer's application guidelines. The protective also prevents dirt from adhering to the machine, facilitating subsequent washings.
- 10** - Observe curing (absorption) time and application intervals as recommended by the manufacturer.

⚠ ATTENTION | Do not use any other type of oil to protect the harrow (used hydraulic oil, "burnt" oil, diesel oil, castor oil, kerosene, etc.).

❗ IMPORTANT | We recommend the following protective oils:
 - Bardahl: Agro protective 200 or 300
 - ITWChemical: Zoxol DW - Series 4000

🔍 OBSERVATION | Ignoring the conservation measures mentioned above may result in the loss of warranty for painted or zinc-coated components which may exhibit oxidation (rust).

▪ Optional

• Optional accessories

The **CABC** has optional accessories that can be acquired according to the need of work.

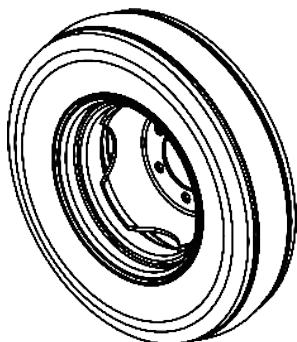

TIRE 650 X 16 - 8 CANVAS

■ Identification

• Identification plate

To see the parts catalog or to request technical assistance from Baldan, always inform model (01), serial number (02) and date of manufacture (03), which is on your **CABC** nameplate.



ATTENTION

The drawings herein are merely illustrative. To allow a better view and detailed instruction, the safety devices in some drawings of this manual were removed (covers, protections, etc.). Never operate CABC without these devices.

CONTACT

In case of doubts, never operate or handle your equipment without referring to Post-Sales.

Telephone: 0800-152577

e-mail: posvenda@baldan.com.br

PUBLICATIONS

Code: 60550108995 | CPT: CABC04220A



▪ Identification

• Product Identification

Please make the correct identification of the data below, to always have information about the service life of your equipment.

Owner: _____

Dealer: _____

Property: _____

City: _____

State: _____

Certificate of Warranty no.: _____

Implement: _____

Serial No: _____

Purchase Date: _____

Invoice: _____

This image shows a single sheet of white paper with horizontal ruling lines. The lines are evenly spaced and run across the width of the page. There are no margins, text, or other markings on the paper.

■ Notes

This image shows a single sheet of white paper with horizontal ruling lines. The lines are evenly spaced and run across the width of the page. There are no margins, text, or other markings on the paper.

BALDAN IMPLEMENTOS AGRÍCOLAS S/A ensures the dealer normal performance of the implement for a period of six (6) months as of the delivery date on the retail invoice to the first final consumer. During this period, **BALDAN** undertakes to repair defects in material and/or of manufacture of its liability, including labor, freight and other expenses of the dealer's liability.

In the warranty period, request and replacement of eventual defective parts shall be made to the dealer of the area, who will submit the faulty piece for **BALDAN** analysis. When this procedure is not possible and the resolving capacity of the dealer is exhausted, the dealer will request the support of **BALDAN Technical Assistance** through a specific form distributed to dealers. After analyzing the replaced items by Baldan Technical Assistance, and concluding that it is not a warranty, then the dealer will be responsible for the costs related to the replacement; as well as material expenses, travel including accommodation and meals, accessories, lubricant used and other expenses arising from the call out to Technical Assistance, and Baldan company is authorized to carry the respective invoice in the name of the resale. Any repair carried in the product within the dealer warranty deadline will only be authorized by **BALDAN** upon previous budget presentation describing parts and work to be performed.

The product is excluded from this term if it is repaired or modified by representatives not belonging to the **BALDAN** dealer network, as well as the application of non-genuine parts or components to the user's product. This warranty is void where it is found that the defect or damage is caused by improper use of the product, failure to follow instructions or inexperience of the operator.

It is agreed that this warranty does not cover tires, polyethylene tanks, cardan, hydraulic components, etc., which are equipment guaranteed by their manufacturers. Manufacturing and/or material defects, object of this warranty term, will not constitute, under any circumstances, grounds for termination of a purchase agreement, or for indemnification of any nature.

BALDAN reserves the right to change and/or perfect the technical characteristics of its products, without previous notice, and without obligation to proceed in the same way with the products previously manufactured.

▪ Inspection and Delivery Certificate

SERVICE BEFORE DELIVERY: This implement was carefully prepared by the sale organization, with all its parts inspected according to the manufacturing prescriptions.

DELIVERY SERVICE: The user was informed about the current warranty terms and instructed on the usage maintenance precautions.

I confirm that the user has been informed about the current warranty terms and instructed on the usage maintenance precautions.

Implement: _____ Serial Number: _____

Date: _____ Tax Number: _____

Dealer: _____

Telephone: _____ CEP: _____

City: _____ State: _____

Owner: _____

Telephone: _____

Address: _____ Number: _____

City: _____ State: _____

E-mail: _____

Sale date: _____

Signature / Dealer Stamp _____

1st copy - Owner

▪ Inspection and Delivery Certificate

SERVICE BEFORE DELIVERY: This implement was carefully prepared by the sale organization, with all its parts inspected according to the manufacturing prescriptions.

DELIVERY SERVICE: The user was informed about the current warranty terms and instructed on the usage maintenance precautions.

I confirm that the user has been informed about the current warranty terms and instructed on the usage maintenance precautions.

Implement: _____ Serial Number: _____

Date: _____ Tax Number: _____

Dealer: _____

Telephone: _____ CEP: _____

City: _____ State: _____

Owner: _____

Telephone: _____

Address: _____ Number: _____

City: _____ State: _____

E-mail: _____

Sale date: _____

Signature / Dealer Stamp _____

2nd copy - Dealer

▪ Inspection and Delivery Certificate

SERVICE BEFORE DELIVERY: This implement was carefully prepared by the sale organization, with all its parts inspected according to the manufacturing prescriptions.

DELIVERY SERVICE: The user was informed about the current warranty terms and instructed on the usage maintenance precautions.

I confirm that the user has been informed about the current warranty terms and instructed on the usage maintenance precautions.

Implement: _____ Serial Number: _____

Date: _____ Tax Number: _____

Dealer: _____

Telephone: _____ CEP: _____

City: _____ State: _____

Owner: _____

Telephone: _____

Address: _____ Number: _____

City: _____ State: _____

E-mail: _____

Sale date: _____

Signature / Dealer Stamp _____

3rd copy - Manufacturer (Please send completed within 15 days).

1.74.05.0059-5

AC MATÃO
ECT/DR/SP

RESPONSE CARD

NO STAMPING IS REQUIRED

THE STAMP WILL BE PAID BY:



BALDAN IMPLEMENTOS AGRÍCOLAS S/A.

Av. Baldan, 1500 | Nova Matão | CEP: 15993-900 | Matão-SP | Brasil

Phone: (16) 3221-6500 | Fax: (16) 3382-6500

www.baldan.com.br | email: sac@baldan.com.br

Export: Phone: +55 (16) 3221-6500 | Fax: +55 (16) 3382-4212 | 3382-2480

email: export@baldan.com.br



Avenida Baldan, 1500
Nova Matão
15.993-900
Matão/SP - Brasil
sac@baldan.com.br
export@baldan.com.br

+55 16 3221 6500
baldan.com.br