

Instruction Manual



CAMB NEW SERIES

Multiple Subsoiler, Fertilizer and Cultivator

 **BALDAN**

PRESENTATION

We appreciate your purchase and congratulate you for the excellent choice you just made because you have purchased a product manufactured with technology from **BALDAN IMPLEMENTOS AGRÍCOLAS S/A.**

This instruction manual will guide you through the procedures that are necessary since its acquisition up to the operating procedures of use, security and maintenance.

BALDAN ensures that has delivered this farming implement to the dealer in perfect conditions.

The dealer is responsible for the custody and maintenance of this farming implement and also for the assemblage, retightening, lubrication and overhaul.

In the technical delivery, the dealer must advise the user on its maintenance, security, its obligations under any technical assistance, the strict observance of the guarantee and reading of the instruction manual.

Any request for technical assistance under warranty should be made to the dealer where it was purchased.

We reiterate the need for careful reading of the **Warranty Certificate** and observance of all items in this instruction manual, as doing so, the useful life of your farming implement will increase.



Instruction Manual

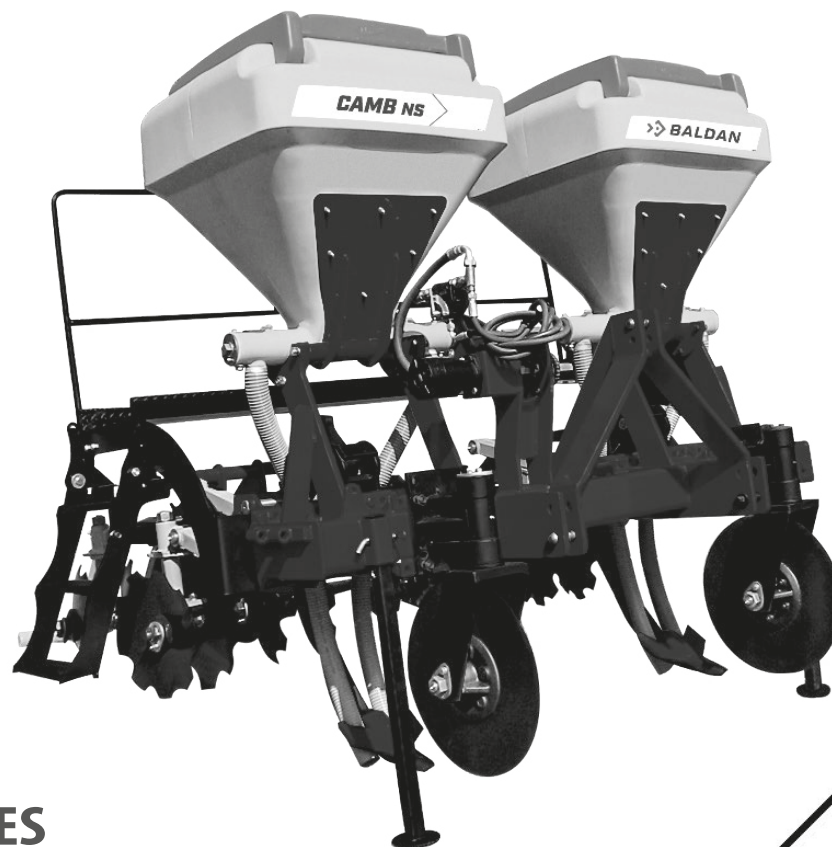

CAMB NEW SERIES

Multiple Subsoiler, Fertilizer and Cultivator

BALDAN IMPLEMENTOS AGRÍCOLAS S/A.
CNPJ: 52.311.347/0009-06
Insc. Est.: 441.016.953.110



Scan the QR Code on the
identification plate of your
device and access this
Instruction Manual online.

BALDAN

INDEX

01 - Safety standards	4 - 6
02 - Components	7
03 - Technical specifications	8
04 - Assembly	9
<i>Position of carts on the frame</i>	<i>10</i>
05 - Tractor coupling	
<i>Centering the grower</i>	<i>10 - 11</i>
<i>Work / Transportation</i>	<i>11</i>
06 - Adjustments	
<i>Cultivator leveling</i>	<i>12</i>
<i>Regulation of space between stems</i>	<i>12</i>
<i>Spring pressure instructions</i>	<i>13</i>
<i>Cutting disc depth adjustment</i>	<i>13</i>
<i>Pantographic kit adjustment</i>	<i>13 - 14</i>
<i>Rail cane version kit adjustment</i>	<i>14</i>
07 - Fertilizer distribution system	
<i>Fertilizer distribution system</i>	<i>15</i>
08 - Adjusting the fertilizer with hydraulic motor	15
<i>Fertilizer distribution tables hydraulic engine</i>	<i>16</i>
09 - Maintenance and operation	
<i>Lubrication</i>	<i>17</i>
<i>Grease table and equivalents</i>	<i>17</i>
<i>Oils table and equivalents</i>	<i>17</i>
<i>Fixed stretcher</i>	<i>17</i>
<i>Lubricación points</i>	<i>18</i>
10 - Operational maintenance	19
11 - Cleaning	20
<i>Fertilizer system</i>	<i>20</i>
12 - Optional	21
<i>Optional equipment</i>	<i>21</i>
13 - Identification	22
<i>Product identification</i>	<i>22</i>
<i>Anotaciones</i>	<i>23</i>
Certificate of warranty	24
<i>Inspection and delivery certificate</i>	<i>24 - 26</i>

01. SAFETY RULES

THIS SYMBOL INDICATES IMPORTANT SAFETY WARNING. WHENEVER YOU FIND IT IN THIS HANDBOOK, CAREFULLY READ THE MESSAGE THAT FOLLOWS AND BE AWARE AS FOR THE POSSIBILITY OF PERSONAL INJURY.

! ATTENTION

- *Read the instruction manual carefully, so you can learn the recommended safety practices.*

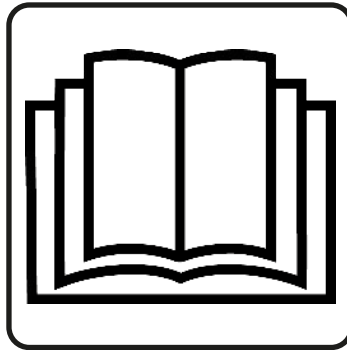
**! ATTENTION**

- *Do not operate the tractor if the front is light. With a tendency to rise, add weights on the front of the tractor or front wheels.*

**! ATTENTION**

- *Only begin operating the tractor when are properly accommodated and with the seat belt fastened.*

**! ATTENTION**

- *There are risks of serious injury by tumbling when working on slopes.*
- *Do not use excessive speed.*

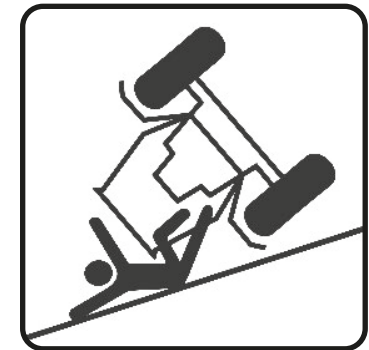

ATTENTION

- *Do not operate the seed drill if the transmission hoods are not properly fixed.*
- *Only remove the hoods to make the replacement of gears, put them back immediately.*
- *When doing any work in the machine transmission, turn the ratchets off.*
- *Do not make adjustments with the machine in motion.*

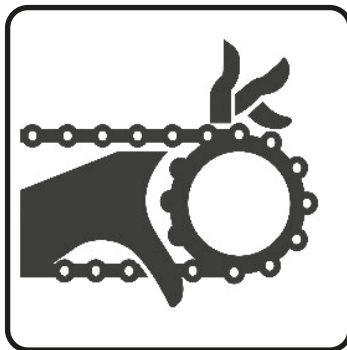

ATTENTION

- *The hydraulic oil works under pressure and can cause serious injury, if has any leak. always check the hoses condition. If has any leakage replace it.*
- *Before connect and disconnect the hydraulic hoses release the pressure.*



ATTENTION

- *Keep yourself away from the active elements of the machine (discs), they are sharp and can cause accidents.*
- *When carrying any service on discs, use safety gloves on hands.*



ATTENTION

- *When operating the seed drill, do not allow the permanence of people on the machine.*
- *Do not stay on the platforms with the machine in motion.*



ALCOHOL OR DRUGS CAN GENERATE SOME LOSS OF REFLEXES AND CHANGE THE OPERATOR'S PHYSICAL CONDITIONS. SO, NEVER OPERATE THIS EQUIPMENT UNDER USE OF THESE SUBSTANCES.

! ATTENTION

- Before performing any maintenance on your equipment, make sure it is turned off. Avoid getting hit.

**! ATTENTION**

- When looking for a possible leak in the hoses, use a piece of cardboard or wood, never use your hands.
- Avoid the incision of fluid in the skin.

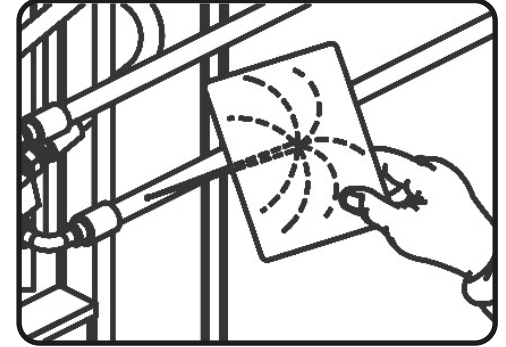
**! ATTENTION**

- Avoid accidents caused by intermittent action of rows mark
- Make sure if has anybody closer to the row mark.

**! ATTENTION**

- Whenever the seed machine is being operated, watch out for surrounding people.
- Do not transport people on the tractor nor in or on the equipment.



ALCOHOL OR DRUGS CAN GENERATE SOME LOSS OF REFLEXES AND CHANGE THE OPERATOR'S PHYSICAL CONDITIONS. SO, NEVER OPERATE THIS EQUIPMENT UNDER USE OF THESE SUBSTANCES.



WARNING

THE MISMANAGEMENT OF THIS EQUIPMENT CAN RESULT IN SERIOUS OR FATAL ACCIDENTS. BEFORE PLACING THE EQUIPMENT IN OPERATION, CAREFULLY READ THE INSTRUCTIONS IN THIS HANDBOOK. MAKE SURE THAT THE PERSON RESPONSIBLE FOR THE OPERATION IS INSTRUCTED ON THE PROPER AND SAFE HANDLING, IF HE HAS READ AND UNDERSTOOD THE HANDBOOK OF THIS PRODUCT.

- 01- ⚠** When operating the equipment, do not allow people to stay very close or on it.
- 02- ⚠** In making any assembling and disassembling service in the discs, always use safety gloves.
- 03- ⚠** Before connecting or disconnecting hydraulic hoses, relieve the system pressure by moving the command with the tractor off.
- 04- ⚠** Periodically check the conservation status of the hoses. If there is evidence of leaks, immediately replace them because the oil works under high pressure and can cause serious injury.
- 05- ⚠** Do not wear loose clothing as they can become entangled in moving parts.
- 06- ⚠** When turning the tractor engine on, be properly seated on the operator's seat and aware of the correct and safe management of both tractor and implement. Always put the selector lever in neutral, turn off the power take-off command and place the hydraulic commands in the neutral position.
- 07- ⚠** Do not run the engine in indoor environments without adequate ventilation, as the exhaust fumes are harmful to health.
- 08- ⚠** When maneuvering the tractor to the implement hitch, make sure that there is plenty of room and that there is nobody very close, always do the maneuvers in low gear and be prepared to brake in emergency situations.
- 09- ⚠** Do not make adjustments with the implement in operation.
- 10- ⚠** When working on slopes, proceed with caution when trying to maintain the necessary stability. In case of early imbalance, reduce the acceleration, turn the tractor wheels to the side of the terrain slope.
- 11- ⚠** Always drive the tractor at speeds compatible with safety, especially when working on uneven ground or slopes, always keep the tractor engaged.
- 12- ⚠** When driving the tractor on roads, keep the brake pedals connected and use of safety signs.
- 13- ⚠** Do not operate the tractor if its front is light. If there is a tendency to rise, add weights on the front or front wheels.
- 14- ⚠** Leaving the tractor, put the selector lever in neutral and pull the parking brake.
- 15- ⚠** Alcohol or drugs can generate some loss of reflexes and change the operator's physical conditions. So, never operate this equipment under use of these substances.
- 16- ⚠** Read or explain all the procedures above to the operator who cannot read.

BALDAN MULTIPLE GROWER FERTILIZER - CAMB New Series

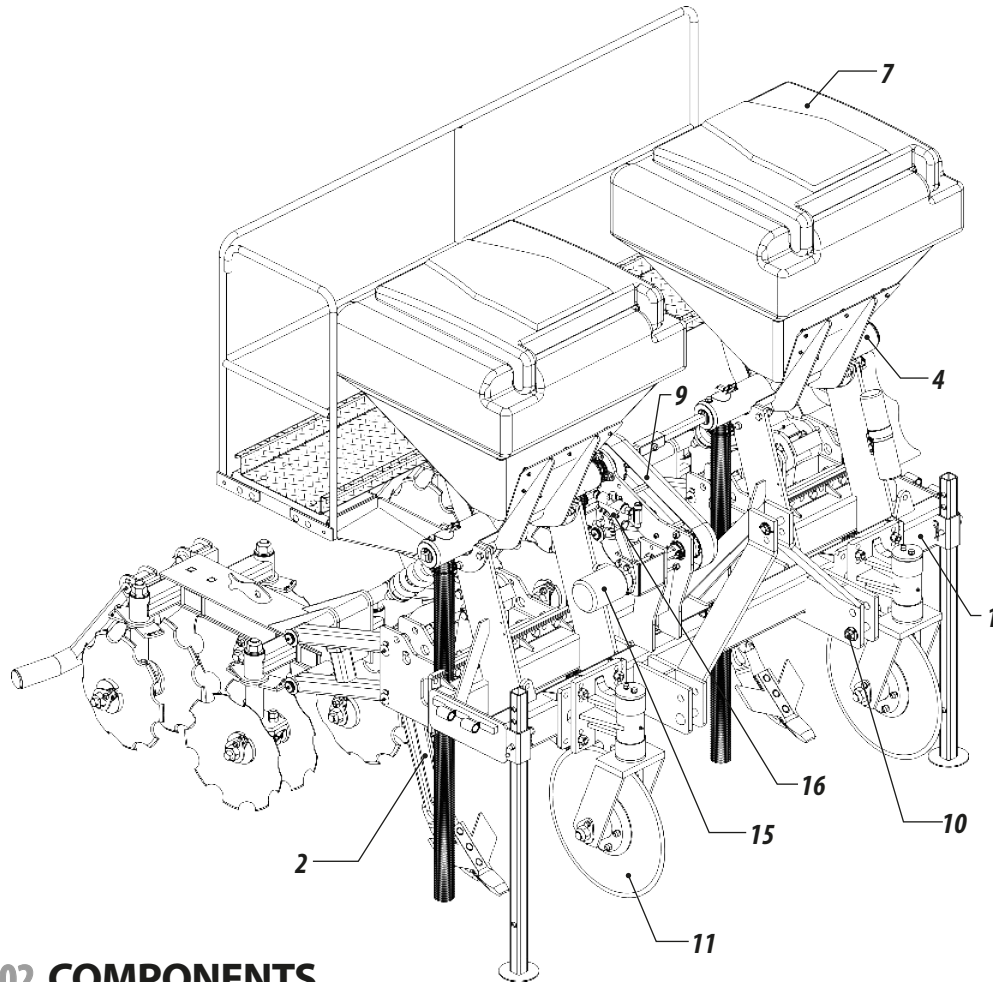

Figures 1

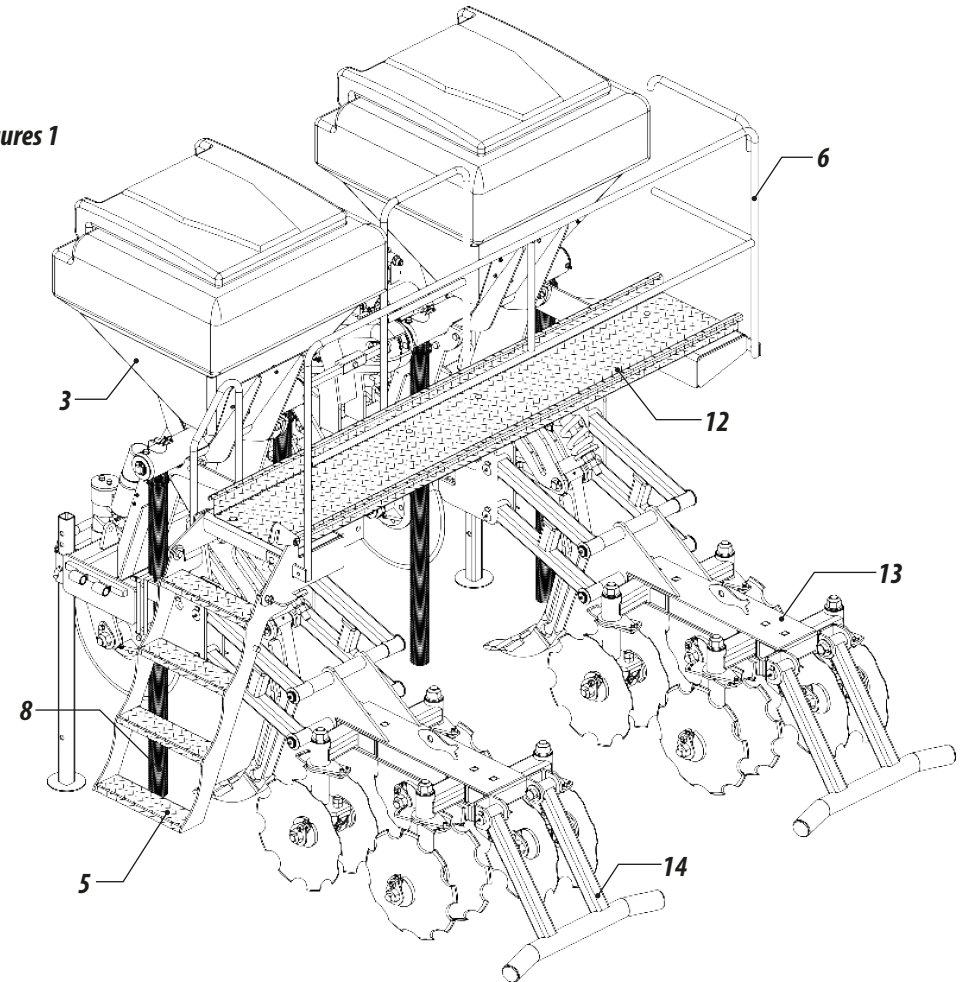

02. COMPONENTS

- 01 - Chassis
- 02 - Subsoiling rod
- 03 - Fertilizer tank
- 04 - Fertilizer spout

- 05 - Ladder
- 06 - Railing
- 07 - Fertilizer tank cap
- 08 - Fertilizer hose

- 09 - Chain cap
- 10 - Coupling pin cat. II
- 11 - Cutting disc
- 12 - Platform

- 13 - Disc harrow in pantograph system
- 14 - Leveler support
- 15 - Hydraulic motor
- 16 - Oil flow control valve

03. TECHNICAL SPECIFICATIONS

<i>Model</i>	<i>Nr. of lines</i>	<i>Spacing between lines (mm)</i>	<i>Average Yield (Ha / Day)</i>	<i>Total width (mm)</i>	<i>Total height (mm)</i>	<i>Fertilizer hopper (L)</i>	<i>Fertilizer flow (Kg / Ha)</i>	<i>Overall lenght (mm)</i>	<i>Approx. weight (Kg)</i>	<i>Required tractor power (Hp)</i>
CAMB <i>New Série</i>	2	1300 / 1400 / 1500	8,84 / 9,52 / 10,20	2750	2300	800	250 - 1200	2750	1700	118 - 160

Table 1

Equipment driven by hydraulic motor.

* Yield calculated considering working speed of 5 km / h, working day of 8 hours per day and equipment yield of 85%.

The BALDAN reserves the right to change the specifications of this product without prior notice.
The technical specifications are approximate and valid in normal working conditions.

04. ASSEMBLY

01 - The grower is factory assembled, but it is necessary to prepare it for use.

POSITION OF CARTS ON THE FRAME

02 - The grower is provided with two lines, and their spacing can be changed as required.

03 - Mark the position on the frame where the carts will be set, then loosen the screws (1), washers and nuts (2), move the cart (3) to the desired position, then, retighten the screws (1).

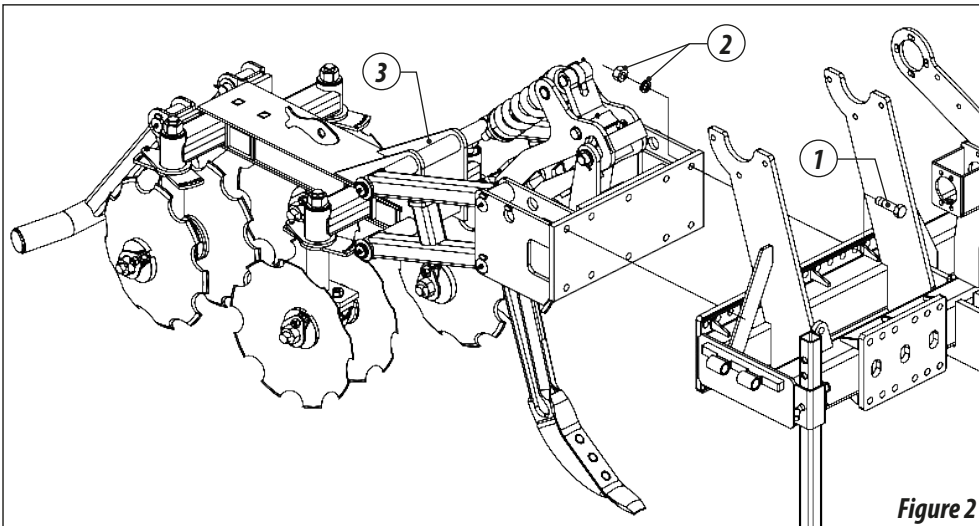

Figure 2

05. TRACTOR COUPLING

CENTERING THE GROWER

• To center the grower in relation to the longitudinal axis of the tractor, find a flat place and proceed as follows:

01 - Align the upper hitch of the furrow with the 3rd point of the tractor, checking if the distances "A" of the lower arms of the hydraulic are equal in relation to the tractor tires as detail "B". The lower arms must be leveled with each other.

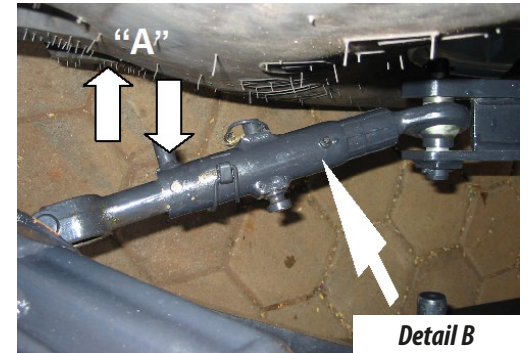

Detail B

02 - Align the tractor to the furrow in idling speed. Approach the tractor in reverse until the hydraulic arms (1) of the tractor in lowered position are as aligned as possible to the coupling pins (2). Fit the eye of the tractor arms to the hitch pins (2) and place the lock (3). Then, connect the arm of the third point of the tractor (4) to the coupling header (5) of the grower according to detail "C".

Detail C

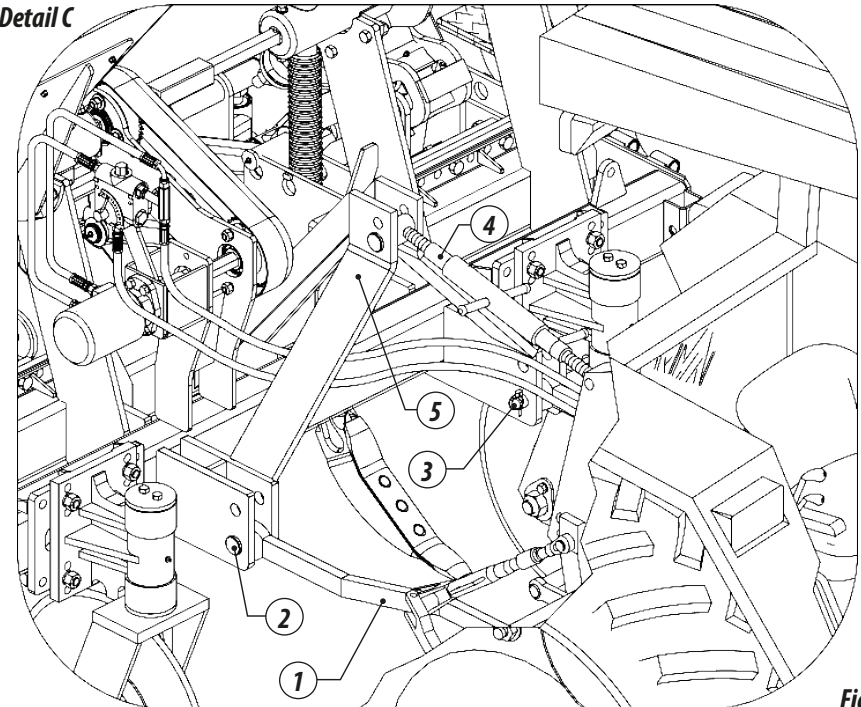

Figures 3

NOTE

If it is necessary to increase the arm length of the third point (4), you must do so by turning the body of the arm and not just the part of the eye. The arm of the third point (4) adjusts the attack angle of the rods to the ground, increasing or decreasing their depth.

- 03 - When coupling the equipment, find a safe place and easy to access, use always low gear and low throttle.
- 04 - the hoses (6) in quick hitch of the tractor. Detail "D".
- 05 - Before connecting or disconnecting the hydraulic hoses, stop the engine and relieve the pressure by triggering the control levers fully. Make sure that the by releasing the pressure of the hydraulic system, no one is near the area.

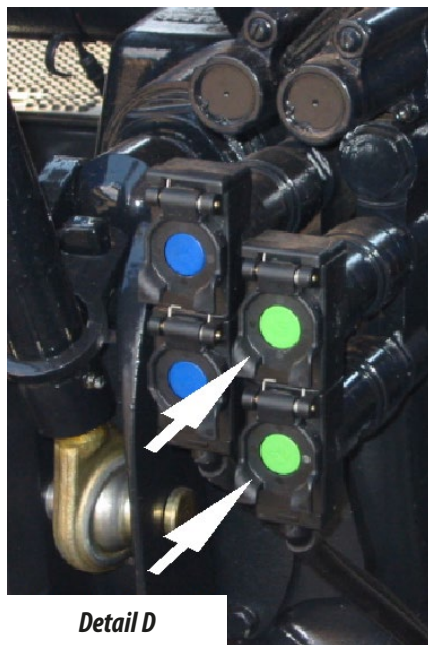

Figures 3

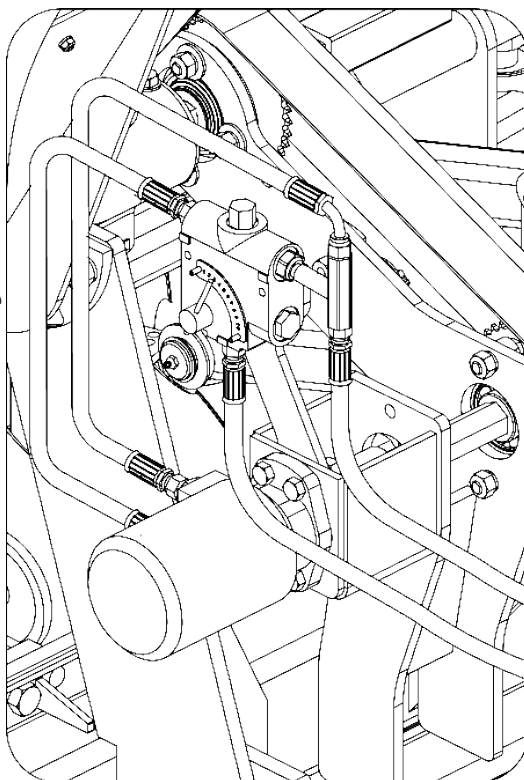

ATTENTION

More adjustments for coupling can be performed by the tractor's hydraulic winch, Detail "B", figure 03, previous page.

WORK / TRANSPORTATION

- Before working / transporting the grower, retract the side latter as follows:
- 01 - Articulate the ladder (1), locking it in the raised position by the latch (2), avoiding touching it to the ground.

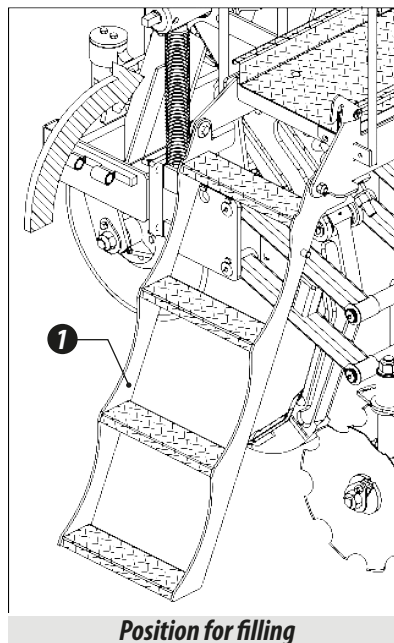

Figures 4

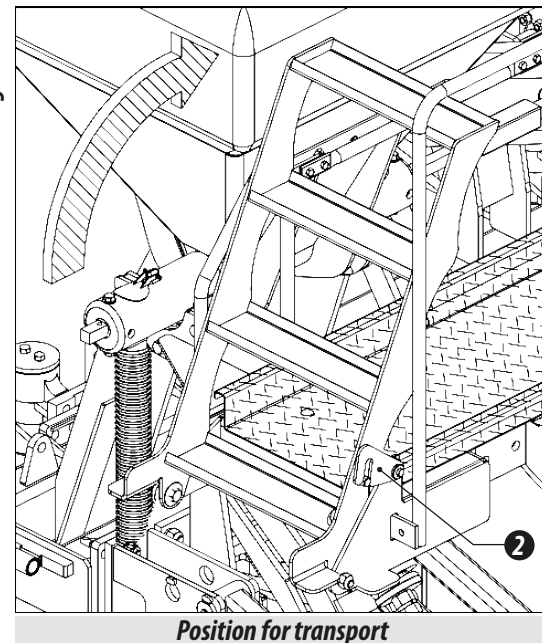

IMPORTANT

Do not carry the grower if it is loaded as it may damage the equipment. We recommend filling it only in the workplace.

06. ADJUSTMENTS

CULTIVATOR LEVELING

- For CAMB to work well, it must be level in both directions (transverse / longitudinal). Leveling in the transverse direction (width) is achieved by acting on the two hydraulic arms of the tractor (1), so that they are of the same length. Then proceed to its longitudinal leveling (length), acting on the connecting arm of the third point (2), decreasing or increasing its length. After performing the above operations, proceed as follows:

01 - Note that the stems should be parallel to the ground.

02 - The working speed varies according to the soil conditions. An average of 4 to 5 km / hour is recommended.

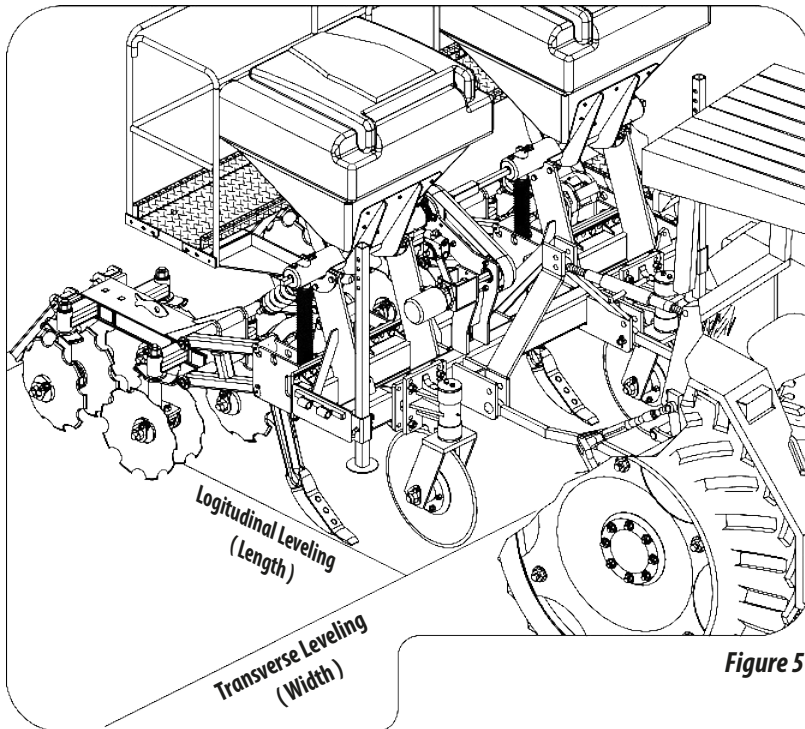

Figure 5

IMPORTANT

The implement's chassis must be well leveled in relation to the ground when working depth.

REGULATION OF SPACE BETWEEN STEMS

- 01** - To increase or decrease the spacing between the rods, loosen the screws (1), washers and nuts (2) and move the rod (3) to the ideal position. After retighten them.

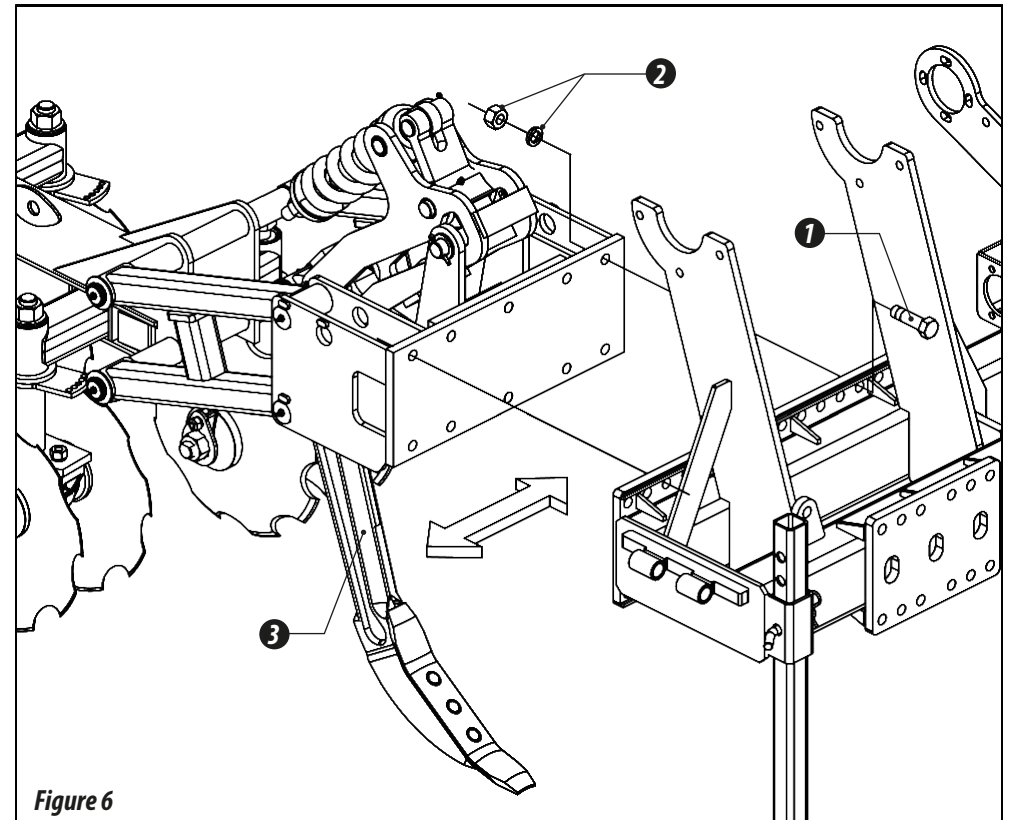

Figure 6

SPRING PRESSURE INSTRUCTIONS

Charge 320 mm	Land with greater compaction	Table 2
Charge 330 mm	Land with regular compaction	
Charge 340 mm	Land with medium compaction	

- 02** - To apply + pressure on the spring, using a suitable tool, loosen the nut (3) and turn the counter nut (4). Detail "A".
- 03** - The stems are equipped with an exclusive automatic disarm and reset system that, when encountering obstacles, disarm and return to the normal working position just by lifting the cultivator.
- 04** - When operating with the cultivator, choose a gear that allows maintain a certain reserve of power, ensuring against unforeseen efforts.

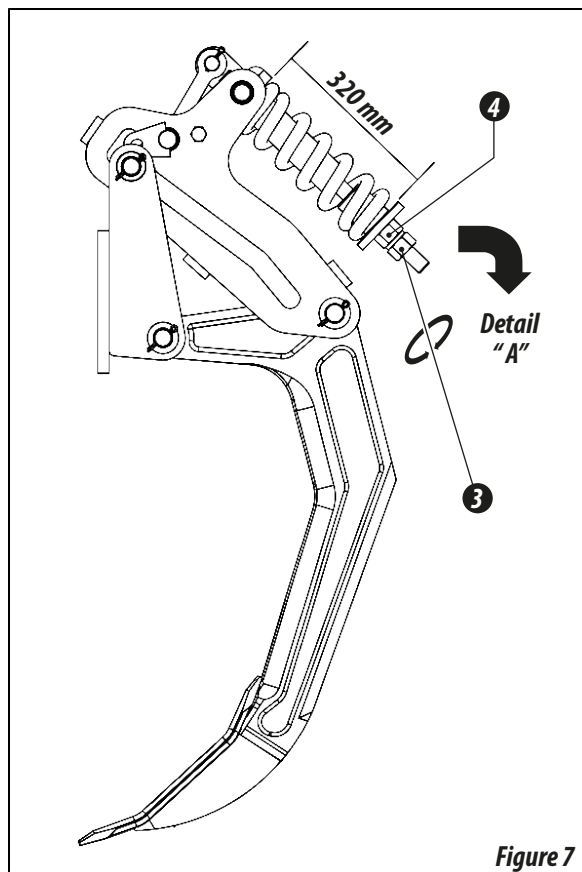

Figure 7

CUTTING DISH DEPTH ADJUSTMENT

- 05** - CAMB has 23 "cutting discs for work in areas of reduced preparation or straw of annual crops used in rotation in the reform areas, facilitating their cutting.
- 06** - To adjust the depth of the cutting disc (1), loosen the screws (2), washers and nuts (3) and move the assembly (4) to the desired setting. Then retighten them.

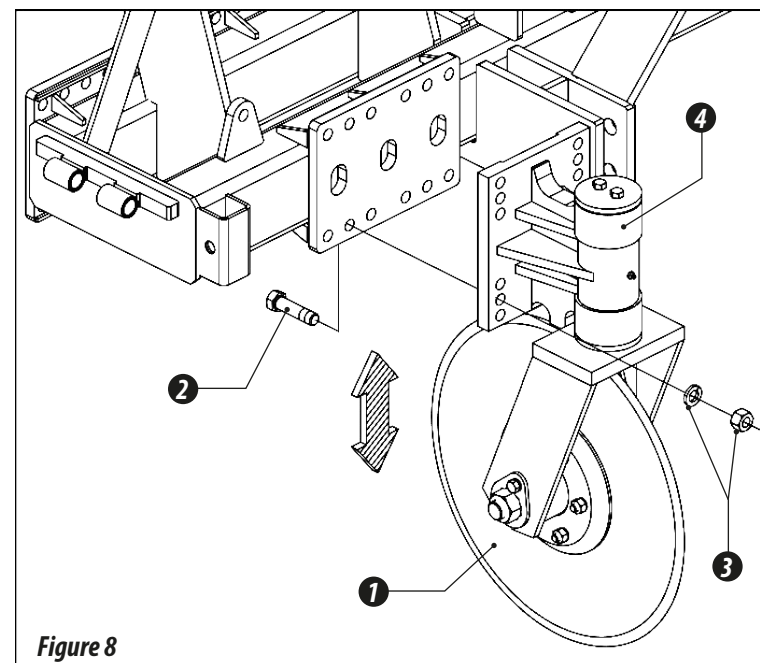
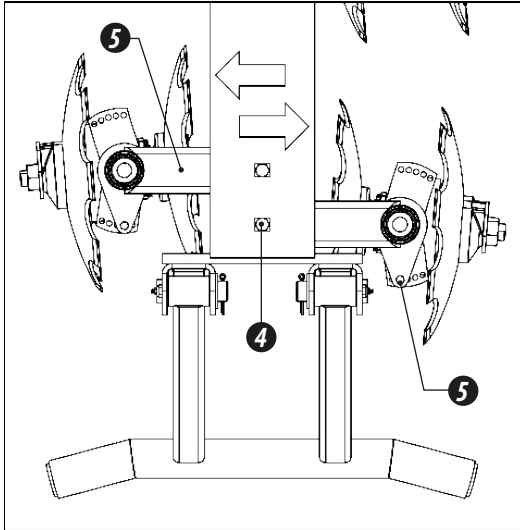

Figure 8

PANTOGRAPHIC KIT ADJUSTMENT

- 07** - Intended to cultivate the area after planting the cane, through the Kit composed of two pantographic sets of 18 "cut discs and leveler.
- 08** - To adjust the width of the grid, loosen the nuts and screws (4) that secure the tubes (5), moving them to the desired width. After retighten the nuts and bolts (4).

- 09 - Then adjust the cutting angle of the discs, loosen the screws and nuts (6) that secure the shoe (7) of the discs, loosen the nut (8), after turning the disc section to the desired position. After retighten the screws and nuts (6).



Figures 9

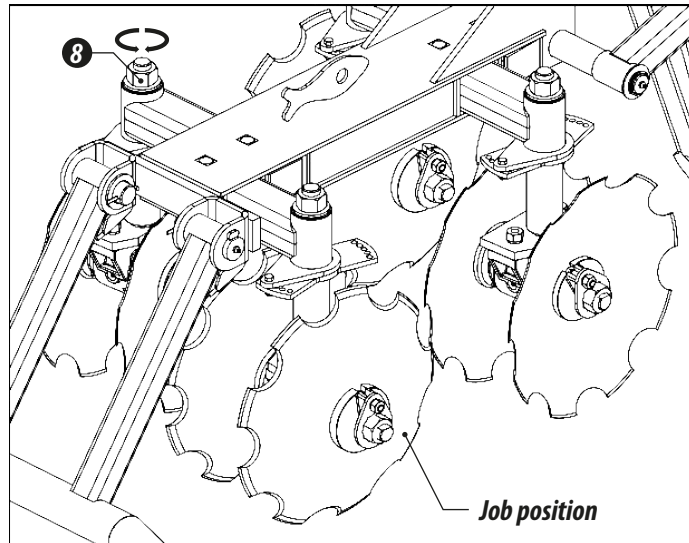

RAIL CANE VERSION KIT ADJUSTMENT

- 10 - Intended to cultivate and fertilize sugarcane areas harvested mechanically and without burning. The implement makes it possible to subsoil the lines between the crop and fertilize it without harming the straw mattress by mechanized harvesting. It consists of arms with cut-out discs with angular adjustment and two bed rollers with an appropriate weight to bed the straw between the rows of the crop.
- This set has simplified adjustments, to execute them proceed as follows:
- 11 - Loosen the nut (1), give the cutting angle by turning the cut disc (2), through the crank (3) to the desired position, after retightening the nut (1). This type of adjustment makes it possible to do an excellent job on raw cane, where cultivation can be carried out keeping the straw mattress intact, incorporating part of the straw, just regulating the working depth of the cut discs.

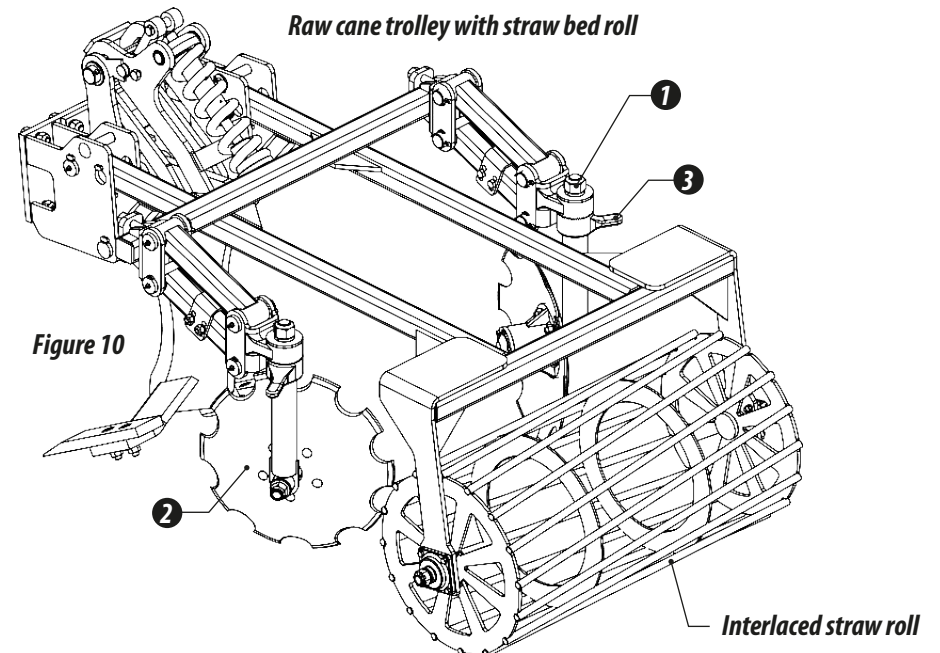

- 12 - Through the kit composed of scratching nozzle (loin break) (6), it is possible to break the groove media, leaving the area level, which will be very important to avoid losses in the harvest, especially when it is mechanized. It also allows to complement the planting fertilization.

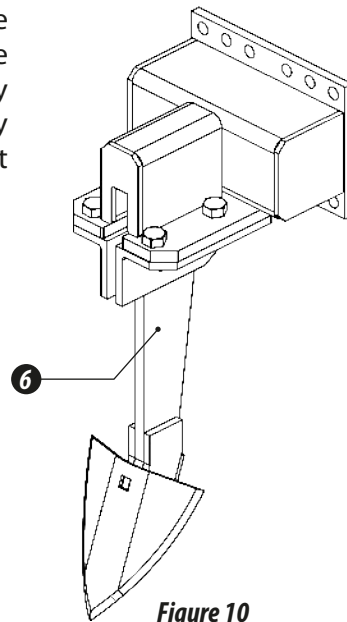
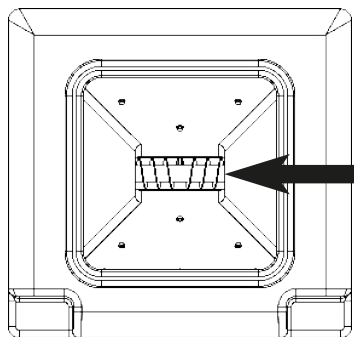

Figure 10

07. FERTILIZER DISTRIBUTION SYSTEM

FERTILIZER DISTRIBUTION SYSTEM

- 01 - To carry the fertilizer from the distributor to the soil, attach the hoses (1) to the high flow distributor spouts of the fertilizer (2), fixing them with the clips (3), preventing them from being crossed or bent.



Fertilizer
entrance

Figures 11

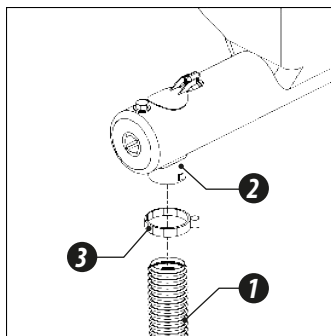

- 02 - The individual high flow distribution system has a safety outlet, because if the hose is clogged, when the fertilizer enters the doser, it will start to leak through this safety outlet, guaranteeing the functioning of the system without damaging it.
- 03 - If this occurs, proceed with the cleaning of the doser until the end of the hose near the furrow. Clogging can occur from roots, pieces of plastic and other objects. Figure 12.

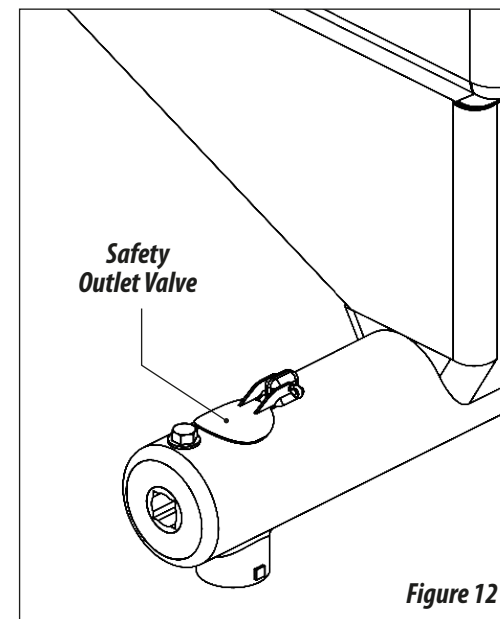

Figure 12



IMPORTANT

Check the dispensing spouts, hoses daily and clean the outlet if necessary.

08. ADJUSTING THE FERTILIZER WITH HYDRAULIC MOTOR

- 01 - The adjustment of the fertilizer must be done through the oil flow regulation valve (1), with the tractor stopped, but at the same working speed. Collect the fertilizer during the timed time to cover 50 or 100 meters.metros.



OBSERVACIÓN

Wait a few seconds before starting to collect the fertilizer so that it completely envelops the shaft.

Before starting the test, heat the tractor oil to normal working temperature.

- 02 - The variation in the amount of fertilizer is obtained by opening or closing the oil flow regulation valve (1).
- 03 - By opening the oil flow regulating valve, the hydraulic motor (2) rotates faster, increasing the amount of fertilizer.

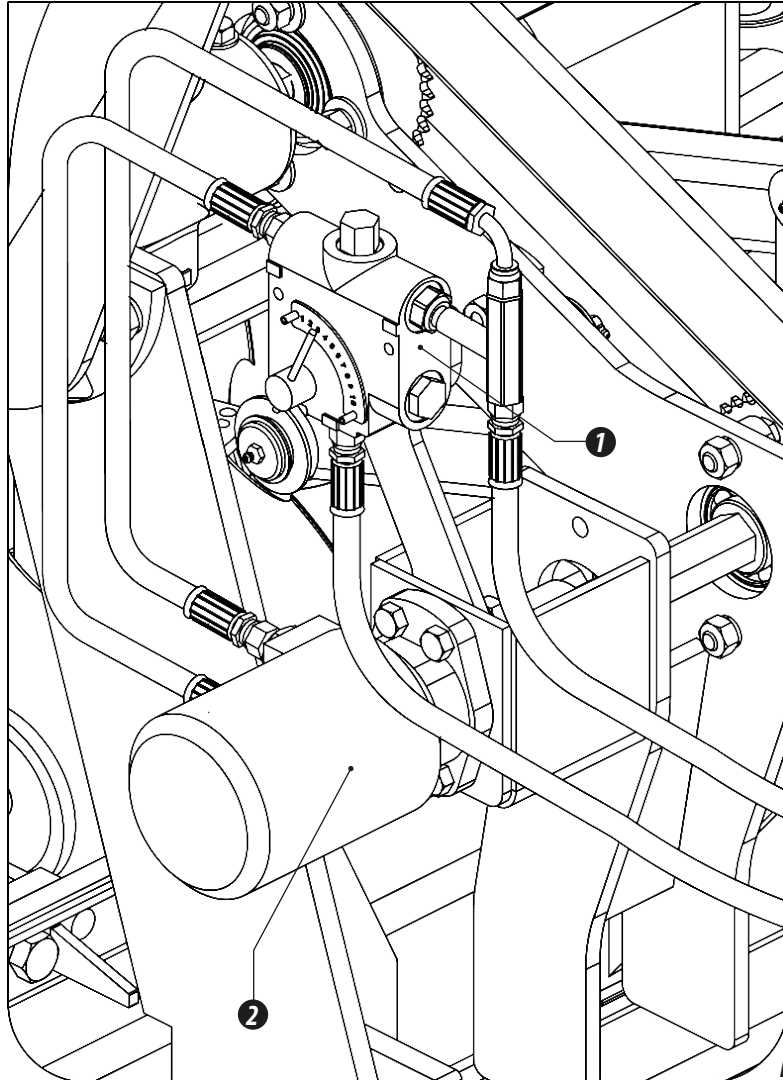

Figure 13

FERTILIZER DISTRIBUTION TABLES HYDRAULIC ENGINE

Remote Control Hydraulic Coupling - 1800 rpm

Table 3

Regulation	Spacing (mm)		(Kg / Ha)
	1300	1400	1500
2.3	263	244	227
2.4	388	360	335
2.5	513	477	443
3.0	535	497	462
3.5	555	515	479
4.0	574	534	496
4.5	750	697	648
5.0	927	862	801
5.5	1213	1128	1048
6.0	1500	1394	1296

Continuous Flow Hydraulic Coupling - 1800 rpm

Table 4

Regulation	Spacing (mm)		(Kg / Ha)
	1300	1400	1500
2.3	141	131	122
2.4	199	185	172
2.5	256	238	221
3.0	484	450	418
3.5	505	470	436
4.0	524	487	453
4.5	670	626	582
5.0	823	765	711
5.5	774	905	841
6.0	1124	1044	971

09. MAINTENANCE AND OPERATION

LUBRICATION

- 01 - Lubrication is indispensable for good performance and greater durability of the moving parts of the cultivator, helping to save maintenance costs.
- 02 - Before starting the operation, carefully lubricate all grease fittings, always observing the lubrication intervals on the following pages.



NOTE

Make sure the quality of the lubricant, as to its efficiency and purity, avoiding using products contaminated by water, earth and other agents.

GREASE TABLE AND EQUIVALENTS

MANUFACTURER	TYPE OF RECOMMENDED GREASE
Petrobrás	Lubrax GMA 2
Atlantic	Litholine MP 2
Ipiranga	Super Graxa Ipiranga Ipiranga Super Graxa 2 Ipiflex 2
Castrol	LM 2
Mobil	Mobilgrease MP 77
Texaco	Marfak 2 Agrotex 2
Shell	Retinax A Alvania EP 2
Esso	Multipurpose grease H Litholine MP 2
Bardahl	Maxlub APG 2 EP

Table 5



If there are other lubricants and/or equivalent brands of grease as listed on the table, consult the technical manual of the respective lubricant manufacturer.

OILS TABLE AND EQUIVALENTES

MANUFACTURER	TYPE OF RECOMMENDED OILS
Petrobrás	INDL. EGF 150 PS
Atlantic	PENNAT EP 150
Ipiranga	IPIRANGA SP 150
Esso	SPARTAN EP 150

Table 6



If there are other lubricants and/or equivalent brands of oils as listed on the table, consult the technical manual of the respective lubricant manufacturer.

FIXED STRETCHER

- 03 - Check the chain tension daily, the normal clearance should be of + 1 cm in the center of them.
- 04 - To tension the chain, loosen the screw (1), slide the tensioner (2) to the required tension, then retighten the screw (1).

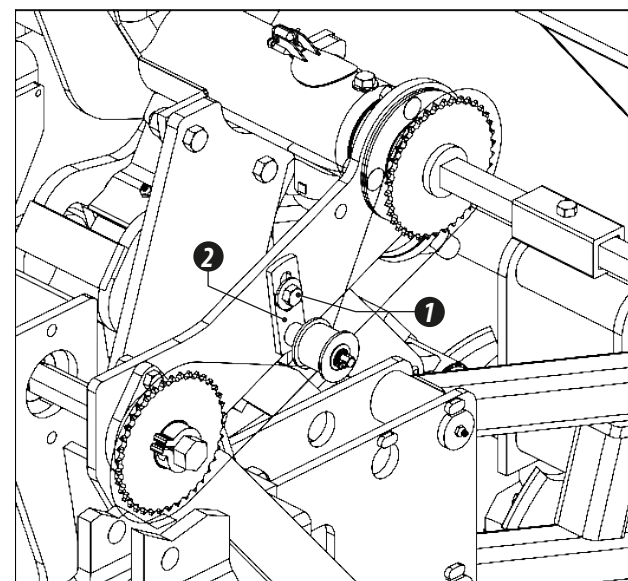
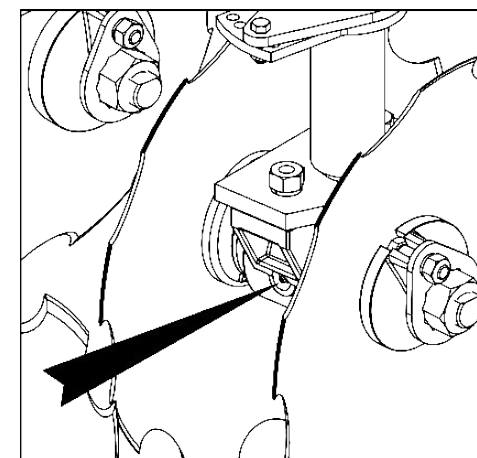
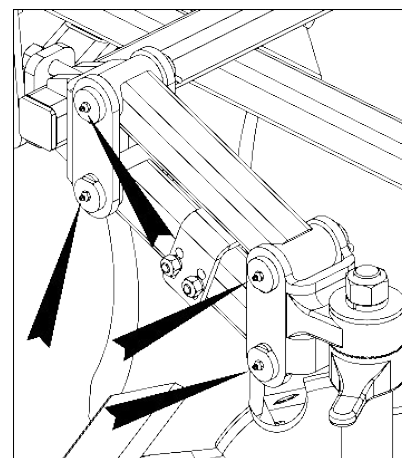
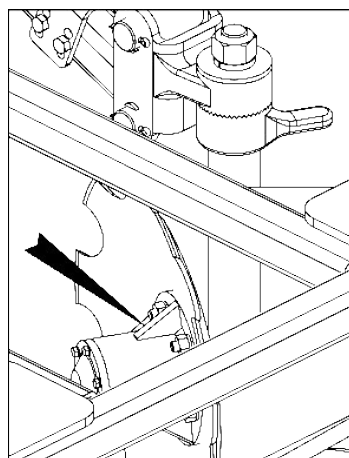
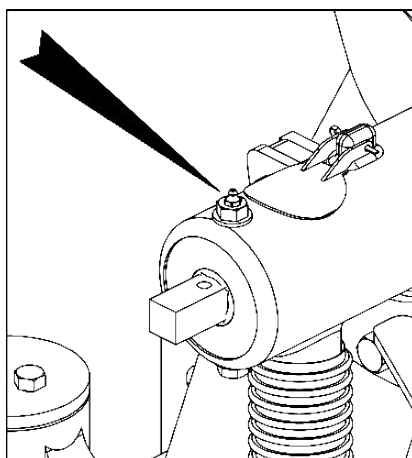
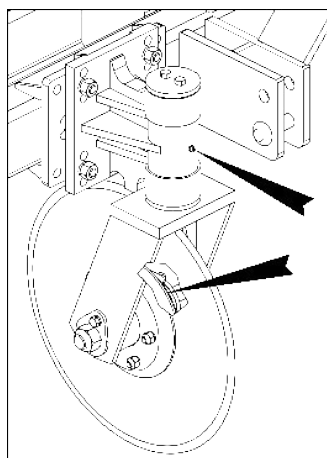
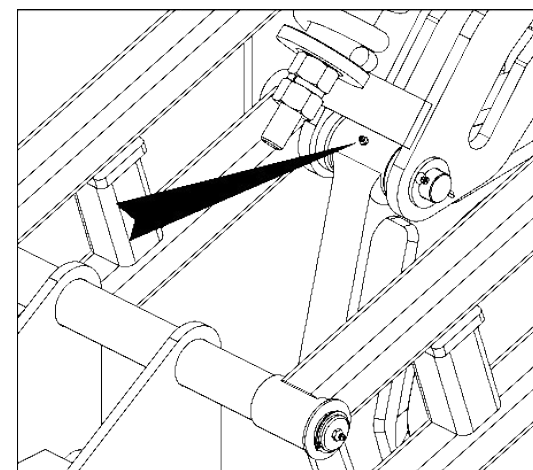
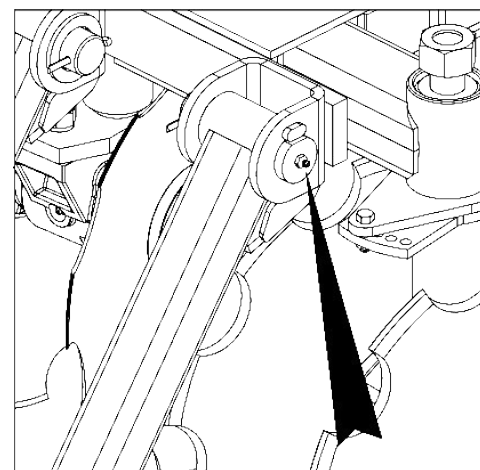
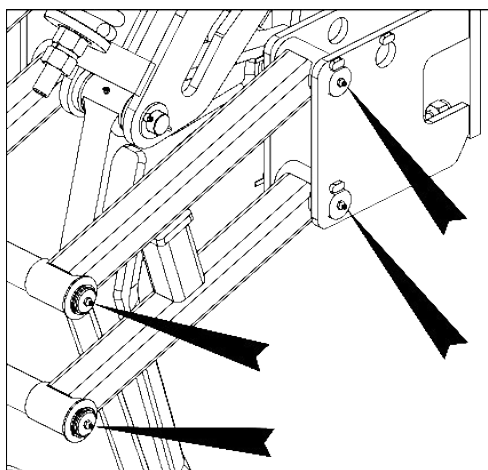
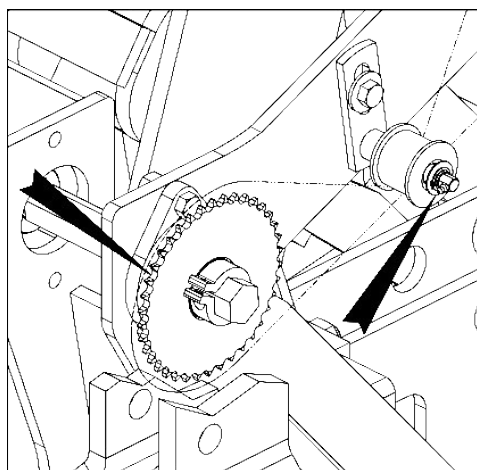

Figure 14

LUBRICATION POINTS**WARNING**

When lubricating the cultivator, do not exceed the amount of new grease. Enter a sufficient amount.

LUBRICATE EVERY 10 HOURS OF OPERATION*Figures 15*

10. OPERATIONAL MAINTENANCE

PROBLEMS	PROBABLE CAUSES	SOLUTIONS
Fertilizer leaks from the safety outlet valve while cultivating.	The hoses are stopped up or pieces of plastic block the fertilizer spiral conductor.	Unblock the hoses or remove the upper conduit going to the spiral, turn the axle the opposite direction until the foreign body is loosened.
The fertilizer hub axle does not turn.	The spiral conductor is block with wet fertilizer or excessive fertilizer in the closed line.	Unblock the spiral tubing, check if the spout is loose and the fertilizer is entering by its sides.
The tractor lifts when lifting the cultivator.	There is not enough ballast in the front part of the tractor.	Add ballast to the front of the tractor.
The cultivator moves out of place while cultivating on very sloped terrains.	The lower arms of the tractor linkage are loose and move sideways.	Fasten the lower arms of the tractor linkage, as to eliminate the sideways movement.
The shanks become disabled frequently.	Improper adjustment of the screws.	Apply the correct torque to the screws.
	There are obstacles in the area (logs, rocks). The terrain is too compacted.	Reduce the operating speed or avoid hitting the obstacles.

Table 7

11. CLEANING

FERTILIZER SYSTEM

- After cultivation, do not leave fertilizer in the tank, clean it in the following way:
- 01** - Remove the elastic pin (1) and washer (2), then loosen the screws (3), washers (4), remove the conductor bushing (5), bronze bushing (6) and shaft (7).
- 02** - Clean the tank, the shafts and also the dispensing spouts and then wash them with running water. Reassemble the axles, observing the correct assembly of the fertilizer distribution system.
- 03** - Always fill the fertilizer tank at the workplace.
- 04** - Avoid any type of impurity inside the fertilizer tank.
- 05** - Check dosage daily.
- 06** - Do not insert your fingers or objects into holes or the inside of the deposit in motion because the helical conductor of the fertilizer can cause serious injuries.

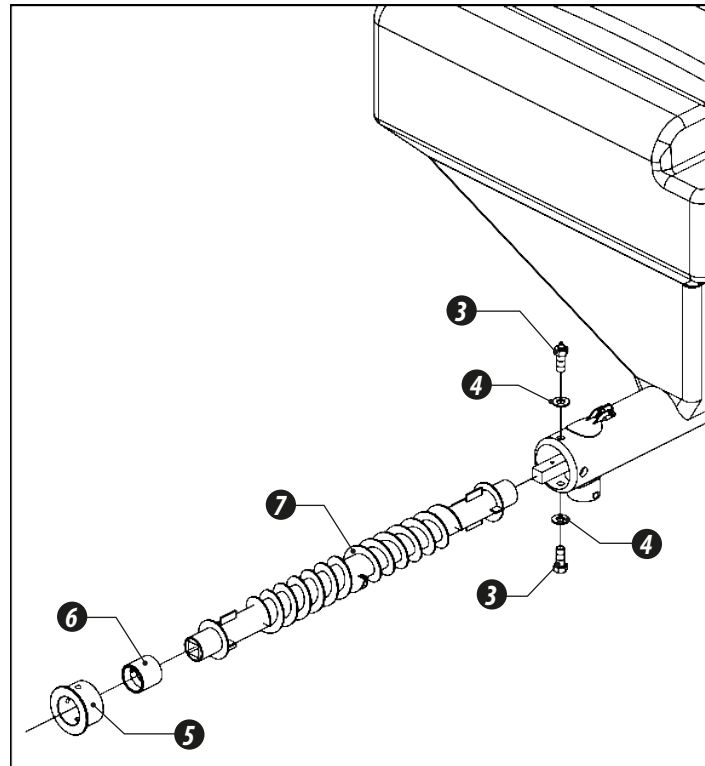
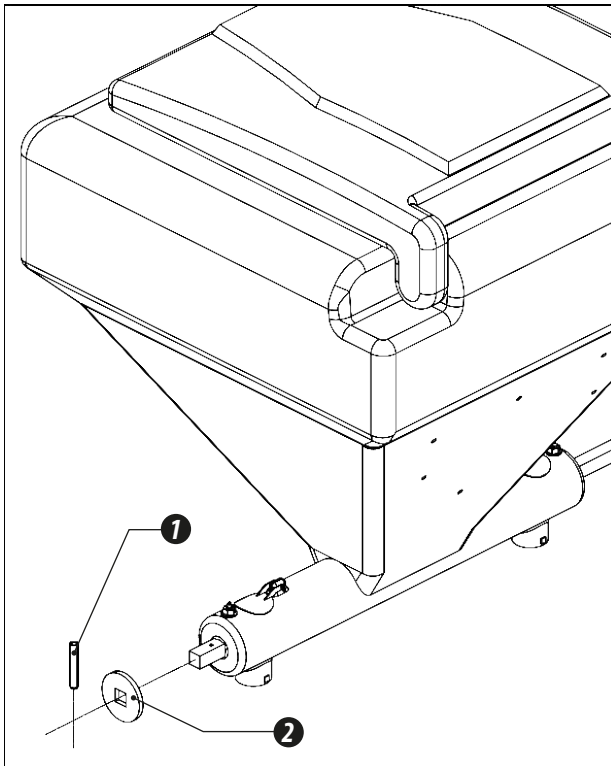

Figures 16

IMPORTANT

- 01** - Wash the CAMB. Do not use chemical detergents, as this may damage the paintwork.
- 02** - Replace the paint where necessary.
- 03** - Spray it with oil or any other type of anticorrosive.
- 04** - Check all the moving parts of the CAMB, if they show wear or looseness, make the necessary adjustment or replacement of the parts, leaving it ready for use. Use original Baldan parts.
- 05** - Store the CAMB in a dry place, protected from the sun and rain.

12.OPTIONAL

OPTIONAL EQUIPMENT

Figures 17

REAR TROLLEY CPL - BURNED CANE VERSION

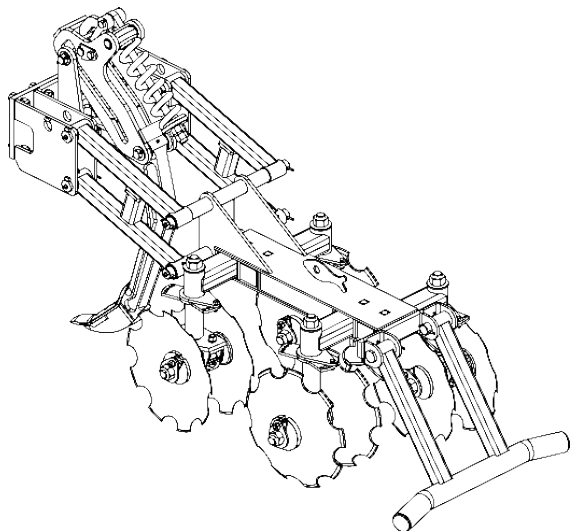

REAR TROLLEY CPL - RAW CANE VERSION

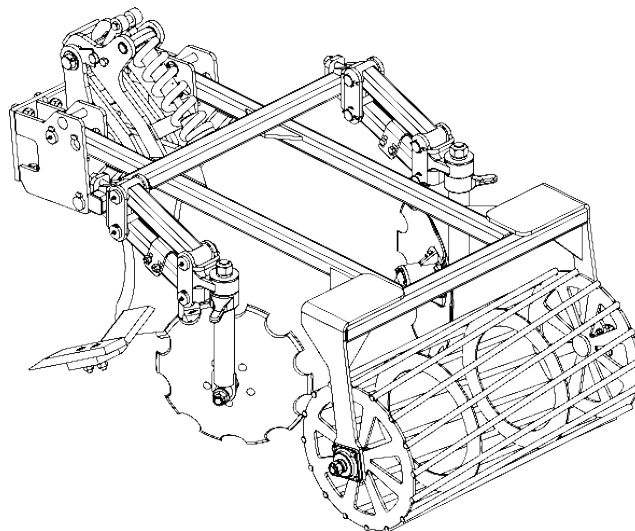

STEM (WING TYPE POINT)

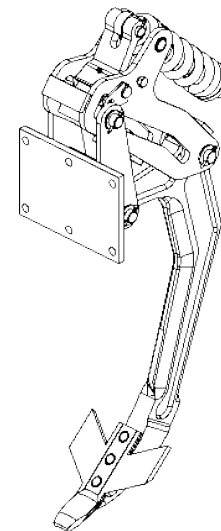

23" CUTTING COULTER

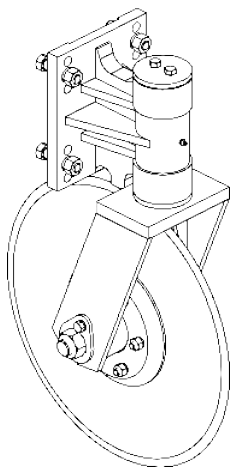

MIDDLE SPACE BREAKER

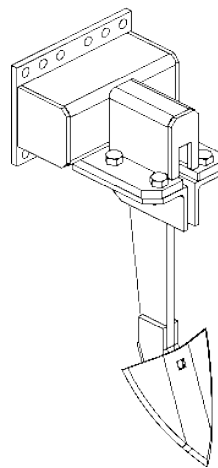

COMPLETE PLATAFORM

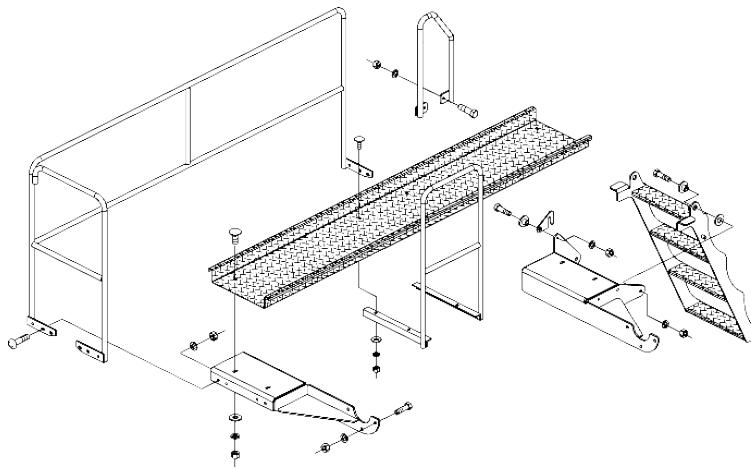

GRADER

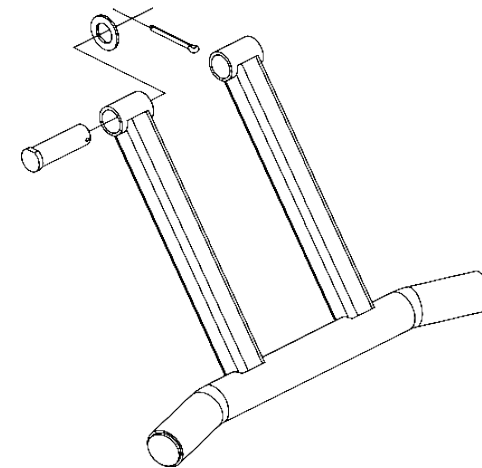

13. IDENTIFICATION

- To view the parts catalog or request technical assistance from Baldan, always indicate the model (1), serial number (2) and date of manufacture (3), which are on the identification label of your equipment.

ALWAYS REQUIRE BALDAN ORIGINAL PARTS

 BALDAN IMPLEMENTOS AGRÍCOLAS S/A. AV. BALDAN, 1500 NOVA MATÃO CEP 15.993-900 MATÃO-SP BRASIL FONE: (16) 3221-6500 CNPJ: 52.311.347/0009-06 CREA/SP 0170977		
01 — Modelo / Model	03 — Data / Date	
02 — Nº de Série / Serial Number	Tipo / Type	
Capacidade / Load Capacity	Peso / Weight	



PUBLICATIONS

Code: 60550102644
CPT: CAMBNS11617

! ATTENTION

The drawings in this instruction manual are of illustrative purposes only.

CONTACT

In case of doubt do not operate the equipment, please contact our after-sales service.
Telephone: 0800-152577
e-mail: posvenda@baldan.com.br

PRODUCT IDENTIFICATION

- Make the identification of the data below to always have correct information about the life time of your equipment.

Owner's name: _____

Dealer: _____

Farm: _____

City: _____ State: _____

Model: _____

Invoice number: _____ Warranty: _____

Date of purchase: ____ / ____ / ____ Serial number: _____



This image shows a full page of blank, lined paper. It features approximately 20 evenly spaced horizontal grey lines across its entire width, providing a guide for handwriting or typing. The paper itself is a clean, off-white color.

CERTIFICATE OF WARRANTY

BALDAN IMPLEMENTOS AGRÍCOLAS S/A, guarantee the normal operation of the product for a 6 (six) months period dated from the dealer's bill of sale to the first final customer.

During this period, **BALDAN** compromise itself to repair the material or manufacturing defects, but the labour, the freight and other expenses are the dealer's responsibility.

At the guarantee period, all the request and replacement of any defective part must be made to the dealer of the region, which will send the defective part for analysis at **BALDAN**.

When this procedure won't be possible and the dealer couldn't have the ability to solve the problem, the dealer can ask for **Baldan's Technical Assistance** using the specific form delivered to them.

After the analysis of the items replaced by Baldan Technical Assistance and if we conclude that it wasn't a guarantee problem, then the dealer will be the responsible for all costs related to the replacement; as well as material expenses, travel including accommodation and meals, also the accessories, lubricant used or any other expenses after having called the Technical Assistance. And, withal, the company **BALDAN** is authorized to issue the billing in name of the respective reseller.

Any repair made to the product which is in warranty period by the dealer, will only be authorized by **BALDAN** after budget previous presentation describing pieces and labour to be accomplished.

It is out of this term the product which has repairs or modifications not made by dealers from **BALDAN'S** network, as well as pieces applications or not authentic components to the product by the user.

This certificate of guarantee will become invalid when notice that the damage or defect is the result of incorrect use of the product, of instructions non-observance or operator's inexperience.

It's stipulated that this guarantee don't cover tires, polyethylene deposits, universal joints, hydraulic components, etc, which equipments are guarantee by their manufacturers.

The material or manufacture defects, object of this certificate of guarantee, will not be, by any hypothesis, reason for cancellation of the contract of sale, or indemnity of any kind.

For a warranty solicitation to the distributor, you have to proceed in the following manner:

Send the technical informe detailed telling the problem (technical assistance request form to the client), you can find it send us an email to aftersales@baldan.com.br or accessing our website.

If it's possible send films and photos from the requested spare parts.

To point at the form: serial number, manufacture year, etc, that is, all information asked at the form. The damage spare parts should be available for analysis of the the after sales department in a future visit (in case of requested).

BALDAN keeps the right of changing and or improve the technical characteristics of its products, without notice and without the obligation of act like this way with its previously manufactured products.

INSPECTION AND DELIVERY CERTIFICATE

- **SERVICE BEFORE THE DELIVERY:** This equipment was very carefully prepared by the dealer's organization, inspected in all its parts in agreement with the manufacture's prescription.
- **DELIVERY SERVICE:** The user was informed about the current guarantee terms and instructed about maintenance care and utilization.
- I confirm that I was informed about the current guarantee terms and instructed about the correct utilization and maintenance of this product.

Product: _____

Serial Number: _____

Date: _____ Bill of sale: _____

Store: _____ City: _____

State: _____ Zip Code: _____

Owner: _____ Phone: _____

Address: _____ Number: _____

City: _____ State: _____

E-mail: _____

Date of sale: _____

Signature / Store's stamp _____

1ª Page - Owner

INSPECTION AND DELIVERY CERTIFICATE

- **SERVICE BEFORE THE DELIVERY:** This equipment was very carefully prepared by the dealer's organization, inspected in all its parts in agreement with the manufacture's prescription.
- **DELIVERY SERVICE:** The user was informed about the current guarantee terms and instructed about maintenance care and utilization.
- I confirm that I was informed about the current guarantee terms and instructed about the correct utilization and maintenance of this product.

Product: _____

Serial Number: _____

Date: _____ Bill of sale: _____

Store: _____ City: _____

State: _____ Zip Code: _____

Owner: _____ Phone: _____

Adress: _____ Number: _____

City: _____ State: _____

E-mail: _____

Date of sale: _____

Signature / Store's stamp _____

2ª Page - Store

INSPECTION AND DELIVERY CERTIFICATE

- **SERVICE BEFORE THE DELIVERY:** This equipment was very carefully prepared by the dealer's organization, inspected in all its parts in agreement with the manufacture's prescription.
- **DELIVERY SERVICE:** The user was informed about the current guarantee terms and instructed about maintenance care and utilization.
- I confirm that I was informed about the current guarantee terms and instructed about the correct utilization and maintenance of this product.

Product: _____

Serial Number: _____

Date: _____ Bill of sale: _____

Store: _____ City: _____

State: _____ Zip Code: _____

Owner: _____ Phone: _____

Adress: _____ Number: _____

City: _____ State: _____

E-mail: _____

Date of sale: _____

Signature / Store's stamp _____

3ª Page - Manufacturer

Please send this filled copy to Baldan, until 15 days after the purchase.

1.74.05.0059-5
AC MATÃO
ECT/DR/SP

RESPONSE CARD

NO STAMPING IS REQUIRED

THE STAMP WILL BE PAID BY:



BALDAN IMPLEMENTOS AGRÍCOLAS S/A.

Av. Baldan, 1500 | Nova Matão | CEP: 15993-900 | Matão-SP | Brasil
Phone: (0**16) 3221-6500 | Fax: (0**16) 3382-6500
Home Page: www.baldan.com.br | e-mail: sac@baldan.com.br
Export: Phone: 55 16 3321-6500 | Fax: 55 16 3382-4212 | 3382-2480
e-mail: export@baldan.com.br



Avenida Baldan, 1500
Nova Matão
15.993-900
Matão/SP - Brasil
sac@baldan.com.br
export@baldan.com.br

+55 16 3221 6500
baldan.com.br