

GAB 600

• **Mounted Hoist**

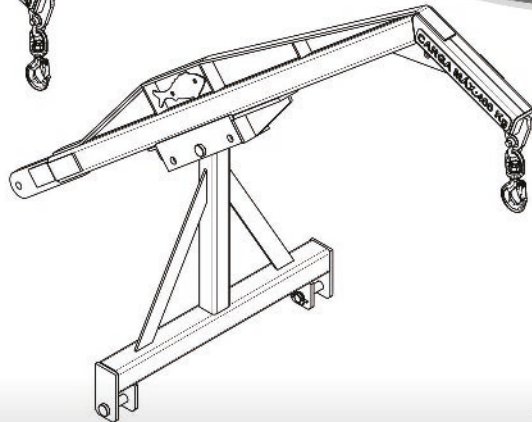
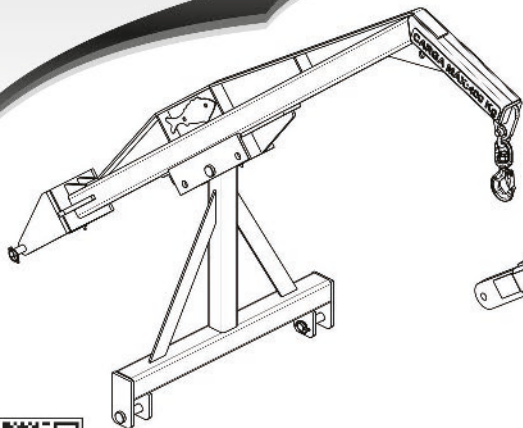

www.baldan.com.br

Instruction Manual

INTRODUCTION

Thank you for the preference and we want to congratulate you for the excellent choice you have just made, because you purchased a product manufactured with *BALDAN IMPLEMENTOS AGRÍCOLAS S/A's* technology.

This manual will guide you through the procedures that are necessary since its acquisition until the operating procedures of use, safety and maintenance.

BALDAN ensures that delivered this implement to resale complete and in perfect condition.

The resale is accountable for the custody and maintenance during the period it was in its power, and also for assembly, retightening, lubrication and overhaul.

In technical delivery, the dealer should guide the user customer regarding maintenance, security, their obligation to possible technical assistance, the strict observance of the warranty and reading the instructions manual. Any request for technical assistance under warranty, shall be made to reseller in which was acquired.

We reiterate the need for careful reading of the warranty certificate and the observance of all items in this manual, because doing so will increase the life of your implement.



Instruction Manual



CONTENTS

WARRANTY	5
<i>Product Warranty.....</i>	<i>5 - 6</i>
GENERAL INFORMATION.....	7
<i>Owner</i>	<i>7</i>
SAFETY STANDARDS	8 - 9
WARNINGS	10 - 11
COMPONENTS	12
TECHNICAL SPECIFICATIONS.....	13
ASSEMBLY	13
<i>Winch assembly (Figure 02).....</i>	<i>14</i>
HITCHES.....	15
<i>"Male" and "Female" Hitches (Figure 03)</i>	<i>15</i>
<i>Hitch to Tractor (Figures 04).....</i>	<i>16</i>
REGULATIONS	17
<i>Regulation of elevation (Figure 05).....</i>	<i>17</i>
OPERATIONS.....	18
<i>Winch work (Figure 06)</i>	<i>18</i>
<i>Recommendations For Operation.....</i>	<i>19</i>



MANTENIMIENTO	20
Care.....	20
General Cleaning	20
IDENTIFICATION.....	21
Product Identification (Figures 07).....	21 - 22
NOTES	23
CERTIFICATE.....	24
Warranty Certificate	24 - 30



WARRANTY

PRODUCT WARRANTY

BALDAN IMPLEMENTOS AGRÍCOLAS S/A, ensures normal operation of the implement to the dealer for a period of six (6) months from the delivery date of the resale invoice to the first end consumer.

During this period, **BALDAN** undertakes to remedy defects in materials and/or workmanship of its responsibility, being labor, freight and other expenses the dealer's responsibilities.

In the warranty period, the request and replacement of any defective parts should be made to the dealer in the region, which will send to **BALDAN** the defective part for analysis.

When it's not possible such a procedure and exhausted the solving capacity of the dealer, it shall request support from **BALDAN's** Technical Assistance through specific form distributed to dealers.

After analyzing the items replaced by **BALDAN's** Technical Assistance, and concluded that, it is not about warranty, then it will be the responsibility of the dealer the replacement-related costs; as well as costs of materials, travel including accommodation and meals, accessories, lubricant and other expenses resulting from the service call, being **BALDAN** authorized to make the billing on behalf of resale.

Any repairs made in the product that are within the warranty period by dealer, it will only be authorized by **BALDAN** through prior budget presentation describing the work of parts and labor to be performed.



It is excluded from this term the product that is repaired and official modifications that do not belong to **BALDAN's** dealer network, as well as the application of parts or non-genuine components to the user product.

This guarantee will become null when it is determined that the defect or damage is resulting from improper product use, failure to follow instructions or the inexperience of the operator.

It is agreed that this warranty does not cover tires, deposits of polyethylene, cardans, hydraulic components, etc., which are equipment guaranteed by their manufacturers.

Manufacturing and or material defects, object of this warranty term, will not constitute, under any circumstances, reason for purchase and sale contract termination, or compensation of any nature.

BALDAN reserves the right to alter and or enhance the technical characteristics of its products, without notice and without obligation to proceed with products previously manufactured.



GENERAL INFORMATION

OWNER

BALDAN IMPLEMENTOS AGRÍCOLAS S/A, is not responsible for any damage caused by accident from use, transport or in improper or incorrect storage of your implement, whether by negligence and / or inexperience of anyone.

Only people who have full knowledge of the tractor and the implement must make the transport and the operation thereof.

BALDAN is not responsible for any damage caused in unpredictable situations or others to implement's normal use.

Improper handling of this equipment can result in serious or fatal accidents. Before putting the equipment into operation, carefully read the instructions in this manual. Make sure that the person responsible for the operation is instructed about the correct and safe handling. Also be sure that the operator has read and understood the product's instruction manual.



NR-31 - SAFETY AND HEALTH AT WORK IN AGRICULTURE, LIVESTOCK FORESTRY, LOGGING AND AQUACULTURE.

This Regulatory Standard is to establish the principles to be observed in the organization and work environment, in a mode compatible with planning and development of agricultural, livestock, forestry and aquaculture activities with safety, health and environment of work.

MR. OWNER OR EQUIPMENT OPERATOR.

Read and follow carefully the provisions of NR-31.

More information, visit the website and read in full the NR-31.

<http://portal.mte.gov.br/legislacao/normas-regulamentadoras-1.htm>



SAFETY STANDARDS



THIS SYMBOL INDICATES IMPORTANT SAFETY WARNING. IN THIS MANUAL, WHENEVER YOU FIND IT, READ ATTENTIVELY THE MESSAGE THAT FOLLOWS AND BE ALERT TO THE POSSIBILITY OF INJURY.



ATTENTION

- *Read the instruction manual carefully to know the recommended safety practices.*



ATTENTION

- *Only start operating the tractor, when you are properly accommodated and the seat belt is locked.*



ATTENTION

- *Do not carry people within or on the equipment.*



ATTENTION

- *There are risks of serious injury by tipping when working on slopes.*
- *Do not use excessive speed.*

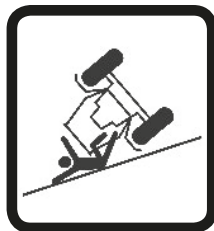

SAFETY STANDARDS



THIS SYMBOL INDICATES IMPORTANT SAFETY WARNING. IN THIS MANUAL, WHENEVER YOU FIND IT, READ ATTENTIVELY THE MESSAGE THAT FOLLOWS AND BE ALERT TO THE POSSIBILITY OF INJURY.



ATTENTION

- Before performing any maintenance on your equipment, make sure it is properly stopped.
- Avoid getting hit.



ATTENTION

- Do not exceed the maximum load capacity of 400 kg.



ATTENTION

- When transporting the winch, do not exceed the speed of 16 km/h or 10 MPH, avoiding risk of accidents.







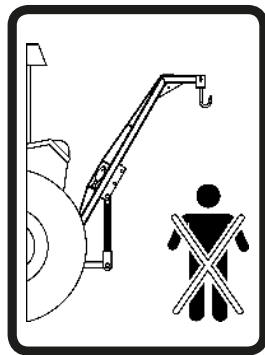



ATTENTION

- To the winch operator, do not allow people to stay very close to or below the lifting point.







WARNINGS

- 01-  When operating the winch, do not allow people to stay very close, inside or on it.
- 02-  Do not use loose clothing as they could curl up on the winch.
- 03-  Do not transit through roads, especially at night. Use warning signs all the way.
- 04-  Do not use loose clothing as they could curl up on the winch.
- 05-  Do not run the tractor engine indoors, without adequate ventilation, as the exhaust gases are harmful to health.
- 06-  By placing the tractor engine in running status, be properly seated in the operator's seat and aware of the complete knowledge for proper and secure handling, for both the tractor and the implement. Always place the gearshift lever in neutral, turn off the outlet power command and place the hydraulic commands in neutral.
- 07-  Do not make adjustments with winch running.
- 08-  When working on slopes proceed with caution whenever trying to maintain the necessary stability. In case of imbalance, reduce throttle and turn the wheels on the slope side of the terrain, and never raise the implement.
- 09-  Always drive the tractor at speeds compatible with safety, especially when working in rough terrain or slopes, keep the tractor always engaged.



WARNINGS

- 10-  When driving the tractor on roads, keep the brake pedals interconnected..
- 11-  Do not operate the tractor with the front being light. If there is a tendency to rise, add weights at the front or the front wheels.
- 12-  When leaving the tractor put the gear lever in neutral and set the parking brake. Never leave the tractor hitched to implements in the raised position of the hydraulic system.
- 13-  Alcohol or some drugs can cause a loss of reflexes and alter the physical conditions of the operator. Therefore, never operate this equipment under the influence of these substances.
- 14-  Read and explain all of the above procedures, to the user that cannot read it.

*In case of questions, contact the Aftersales department.
Phone: 08000-152577 / E-mail: posvenda@baldan.com.br*



COMPONENTS

GAB 600 BALDAN AGRICULTURAL WINCH

01- Hitch head

02- Raise arm w/ 3rd point male hitch

03- Raise arm w/ 3rd point female hitch

04- Winch

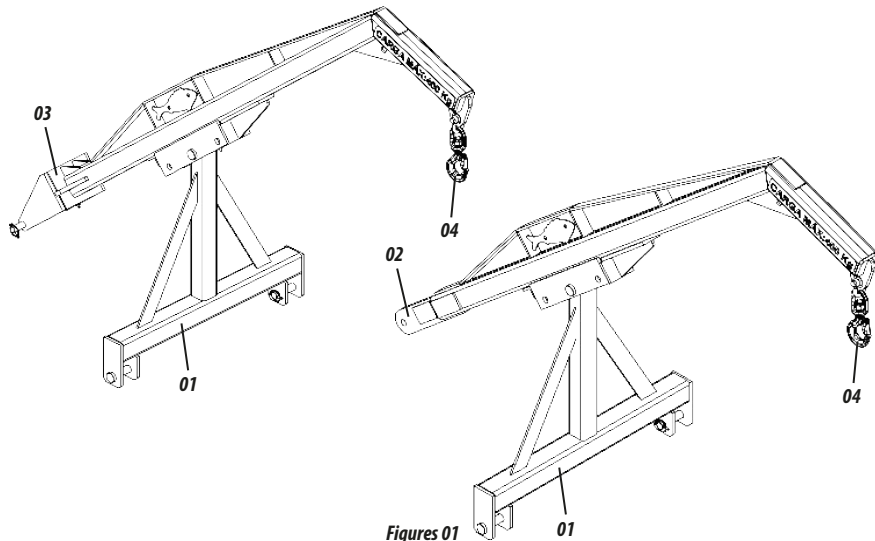

Figures 01



TECHNICAL SPECIFICATIONS

Cuadro 01

<i>Model</i>	<i>Load capacity(Kg)</i>	<i>Total Length(mm)</i>	<i>Raise Height (mm)</i>	<i>Approximate weight (kg)</i>
GAB 600	400	2200	2000	55

BALDAN reserves the right to alter and or enhance the technical characteristics of its products, without notice and without obligation to proceed with products previously manufactured. The technical specifications are approximate and reported in normal working conditions.

ASSEMBLY

GAB 600 is delivered disassembled for ease of loading and transport.

- 1 - ⚠ *Before starting the assembly of **GAB 600**, look for an ideal place, which facilitates the assembly of it.*
- 2 - ⚠ *When making any mounting and dismantling service to winch, use protective equipment.*
- 3 - ⚠ *Do not use loose clothing as they could curl up on the winch.*



ASSEMBLY

WINCH ASSEMBLY (FIGURE 02)

To assemble winch, proceed as follows:

- 01- Couple the raise arm (1) on the hitch head (2) locking it with the pin (3) and lock with ring (4).
- 02- Then pass the shackle (5) inside the hook (6), fixing the raise arm (1) using the screw (7), nut (8) and lock (9).
- 03- Finish placing the pins (10), fixing the locks with rings (11).



ATTENTION

When finished mounting the winch, make an overhaul, check all the pins, locks to make sure that the winch is properly mounted.

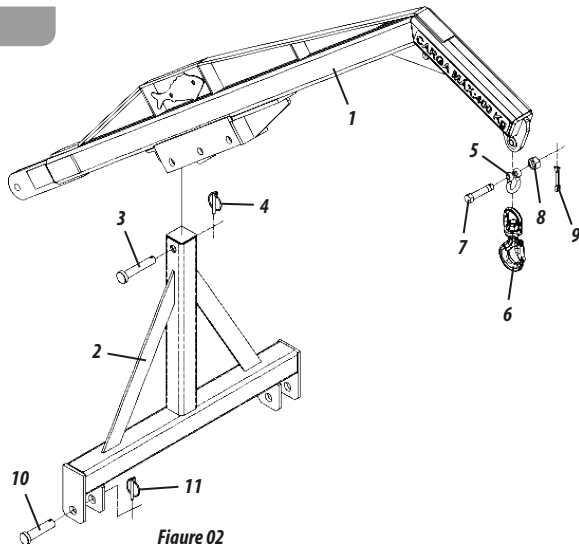

Figure 02



HITCH

"MALE" AND "FEMALE" HITCHES (FIGURE 03)

GAB 600 can be purchased in two different models, "male" and "female" hitches.

Before purchasing the **GAB 600**, check on your tractor what is the type of third point hitch it has, to be sure what winch model must be purchased.



ATTENTION

Failure to comply with the third hitch type on your tractor before purchasing GAB 600 may result in the acquisition of the wrong winch i.e., with hitch model equal to the tractor, resulting in disorders and especially no coupling of winch to the tractor.

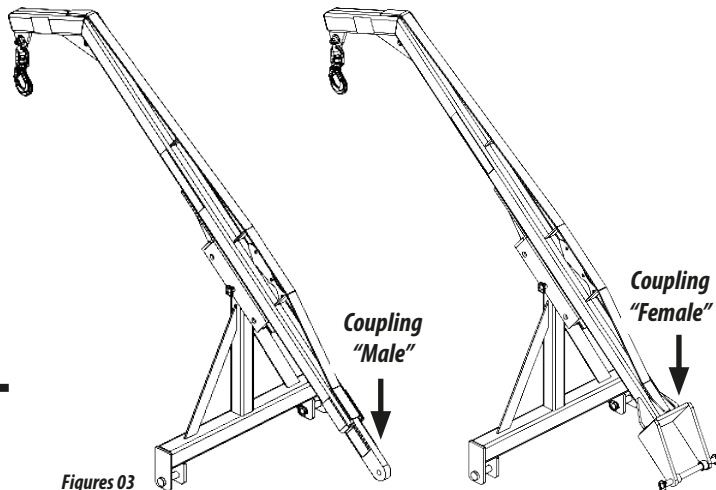

Figures 03

HITCH

HITCH TO TRACTOR (FIGURE 04)

Before engaging **GAB 600** to tractor, make sure the tractor is equipped with weights at the front or the front wheels to not lift the tractor. The rear wheels will give the tractor greater stability and traction to the ground:

To engage **GAB 600**, proceed as follows:

- 01 - Approach slowly the tractor to winch in reverse gear, watching for application of the brakes. Use the hydraulic position control lever, leaving the lower arms of the tractor (1) on the hitch head level (2) of the winch.
- 02 - Then adjust the eyelet of the lower arms (1) and engage the winch through the pins (3), locking them with the lock with ring (4).
- 03 - Then finalize engaging the raise arm (5) of the winch on the third point hitch of the tractor through the pin (6) **and lock with ring (7) as shown in detail "A"**.



REMARK

*When hitching **GAB 600**, find a safe and easily accessible place, always use low gear with low acceleration.*

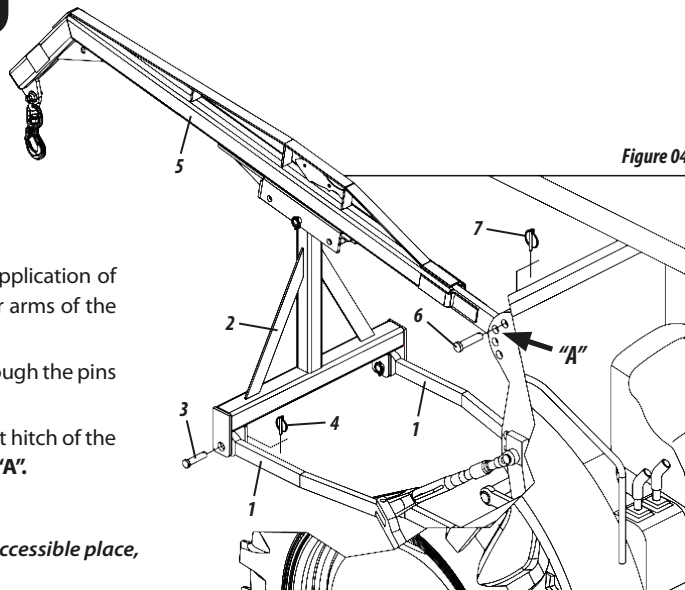

Figure 04

REGULATIONS

REGULATION OF ELEVATION (FIGURE 05)

GAB 600 has regulation system that allows you to increase or decrease its elevation. To adjust the elevation, proceed as follows:

- 01 - First release the lock with ring (1) and remove the pin (2).
- 02 - Then choose the hole that serves the regulation of desired height.
- 03 - Finish placing the pin (2), and lock with ring (1).

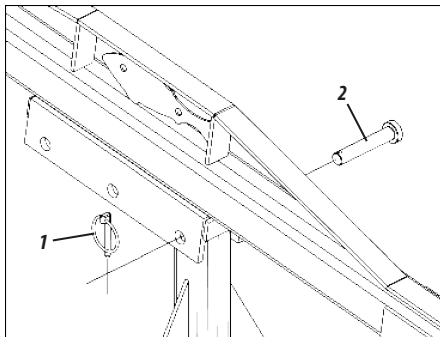

Figures 05

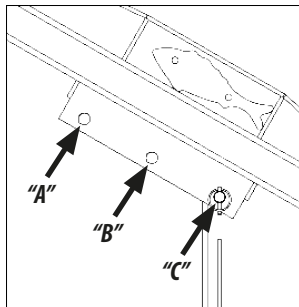

LIFTING SYSTEM:

- "A" - Minor elevation
- "B" - Medium elevation.
- "C" - Major elevation.



OPERATIONS

WINCH WORK (FIGURE 06)

At the end of the elevation adjustment as instructed on the previous page, start works with **GAB 600**, for this proceed as follows:

When engaging the load on **GAB 600**, operate the hydraulic tractor to lift it as shown in the **Detail "D"**.



IMPORTANT

Before starting work with GAB 600, make sure that it is fully assembled and fastened properly to the tractor, thus avoiding accidents and damage to equipment.



ATTENTION

Do not exceed the 400kg load capacity of GAB 600. Ignoring this warning may result in serious accidents and damage to the winch.

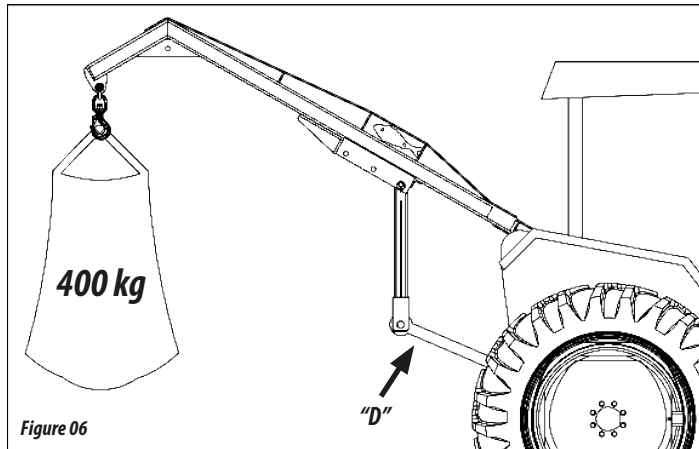

Figure 06



OPERATIONS

RECOMMENDATIONS FOR OPERATION

- 01 - After the first day of work with **GAB 600**, check the condition of pins and locks.
- 02 - Do not carry or work with overloaded. Maximum load capacity of **400 kg**.
- 03 - When operating the **GAB 600**, do not allow people to stay very close to or below the lifting point.
- 04 - If you have questions, do not operate or handle **GAB 600**, check with After Sales.
- 05 - Phone: 0800-152577 or e-mail: posvenda@baldan.com.br



MAINTENANCE

CARE

- 01 - Check the condition of all pins and locks before starting the use of **GAB 600**.
- 02 - The travel speed should be carefully controlled depending on the ground conditions.
- 03 - **GAB 600** is used in various applications, requiring knowledge and ATTENTION during handling.
- 04 - When assembling or disassembling any portion of **GAB 600**, use methods and tools.
- 05 - Check always the parts for wear. If you need replacement, **always insist on original Baldan parts**.

GENERAL CLEANING

- 01 - When storing the **GAB 600**, make a clean sweep and wash it completely with water only. Make sure that the ink does not worn, if it happened, give a full coat and pass the protective oil.
- 02 - Replace all main warning stickers that are damaged or missing. Aware of the importance to all of them and of the dangers of accidents when instructions are not followed.
- 03 - After all cares for maintenance, store your **GAB 600** in a covered, dry place, properly supported.



ATTENTION

Do not use chemicals to wash GAB 600, it can damage the paint on it.



IDENTIFICATION

PRODUCT IDENTIFICATION (FIGURES 07)

To check the parts catalog or request technical assistance in Baldan, always identify the model **(1)**, serial number **(2)** and manufacturing date **(3)**, which is found on the identification label (4) of **GAB 600**.

ALWAYS DEMAND ORIGINAL BALDAN PARTS.



Figure 07



ATTENTION

The drawings in this manual are merely illustrative.



MARKETING

Manual and Catalog Editing

Code: 60550101036

CPT: GAB09915



CONTACT

If you have questions, do not operate or handle GAB 600, check with After Sales.

Phone: 0800-152577

E-mail: posvenda@baldan.com.br



IDENTIFICATION

PRODUCT IDENTIFICATION

Make identification of the data below to always have correct information about the life of your **GAB 600**.

Owner: _____

Resale: _____

Farm: _____

City: _____ State: _____

Warranty certificate number: _____

Model: _____

Serial number: _____

Purchase Date: ____/____/____

Invoice No.: _____



ANNOTATIONS

[illegible]

WARRANTY CERTIFICATE

BALDAN IMPLEMENTOS AGRÍCOLAS S/A, ensures normal operation of the implement to the dealer for a period of six (6) months from the delivery date of the resale invoice to the first end consumer.

During this period, **BALDAN** undertakes to remedy defects in materials and/or workmanship of its responsibility, being labor, freight and other expenses the dealer's responsibilities.

In the warranty period, the request and replacement of any defective parts should be made to the dealer in the region, which will send to **BALDAN** the defective part for analysis.

When it's not possible such a procedure and exhausted the solving capacity of the dealer, it shall request support from **BALDAN's** Technical Assistance through specific form distributed to dealers.

After analyzing the items replaced by **BALDAN's** Technical Assistance, and concluded that, it is not about warranty, then it will be the responsibility of the dealer the replacement-related costs; as well as costs of materials, travel including accommodation and meals, accessories, lubricant and other expenses resulting from the service call, being **BALDAN** authorized to make the billing on behalf of resale. Any repairs made in the product within the warranty period by the dealer will only be authorized by **BALDAN** by prior budget presentation describing the work of parts and labor to be performed.

It is excluded from this term the product that is repaired and official modifications that do not belong to **BALDAN's** dealer network, as well as the application of parts or non-genuine components to the user product.

This guarantee will become null when it is determined that the defect or damage is resulting from improper product use, failure to follow instructions or the inexperience of the operator.

It is agreed that this warranty does not cover tires, deposits of polyethylene, cardans, hydraulic components, etc., which are equipment guaranteed by their manufacturers.

Manufacturing and or material defects, object of this warranty term, will not constitute, under any circumstances, reason for purchase and sale contract termination, or compensation of any nature.

BALDAN reserves the right to alter and or enhance the technical characteristics of its products, without notice and without obligation to proceed with products previously manufactured.



INSPECTION AND DELIVERY CERTIFICATE

- **SERVICE PRIOR TO DELIVERY:** This accessory has been carefully prepared by the selling organization, surveyed in all its parts according to the manufacturer's instructions.
- **DELIVERY SERVICE:** The user is informed about the terms of existing warranty and instructed on the use and maintenance care.
- I confirm that I was informed about the terms of existing warranty and instructed on the use and proper maintenance of the implement.

Implement: _____ Serial number: _____

Date: _____ Invoice: _____ Resale: _____

City: _____ State: _____ Zip Code: _____

Owner: _____ Phone: _____

Address: _____ Number: _____

City: _____ State: _____

E-mail: _____ Date of Sale: _____

1st – Owner

Signature / Stamp of Resale _____



INSPECTION AND DELIVERY CERTIFICATE

- **SERVICE PRIOR TO DELIVERY:** This accessory has been carefully prepared by the selling organization, surveyed in all its parts according to the manufacturer's instructions.
- **DELIVERY SERVICE:** The user is informed about the terms of existing warranty and instructed on the use and maintenance care.
- I confirm that I was informed about the terms of existing warranty and instructed on the use and proper maintenance of the implement.

Implement: _____ Serial number: _____

Date: _____ Invoice: _____ Resale: _____

City: _____ State: _____ Zip Code: _____

Owner: _____ Phone: _____

Address: _____ Number: _____

City: _____ State: _____

E-mail: _____ Date of Sale: _____

2st – Owner

Signature / Stamp of Resale _____



INSPECTION AND DELIVERY CERTIFICATE

- **SERVICE PRIOR TO DELIVERY:** This accessory has been carefully prepared by the selling organization, surveyed in all its parts according to the manufacturer's instructions.
- **DELIVERY SERVICE:** The user is informed about the terms of existing warranty and instructed on the use and maintenance care.
- I confirm that I was informed about the terms of existing warranty and instructed on the use and proper maintenance of the implement.

Implement: _____ Serial number: _____

Date: _____ Invoice: _____ Resale: _____

City: _____ State: _____ Zip Code: _____

Owner: _____ Phone: _____

Address: _____ Number: _____

City: _____ State: _____

E-mail: _____ Date of Sale: _____

3st – Manufacturer

Please send this document filled within 15 days to BALDAN.

Signature / Stamp of Resale _____



1.74.05.0059-5

AC MATÃO
ECT/DR/SP

RESPONSE CARD

NOT REQUIRED SEAL

SEAL WILL BE PAID BY:



Baldan



BALDAN IMPLEMENTOS AGRÍCOLAS S/A.

Av. Baldan, 1500 | Nova Matão | CEP: 15993-000 Matão-SP | Brasil

Phone: (16) 3221-6500 | Fax: (16) 3382-6500

Home Page: www.baldan.com.br | e-mail: sac@baldan.com.br

Export: Phone: 55 (16) 3221-6500 Fax: 55 (16) 3382-4212 | 3382-2480

e-mail: export@baldan.com.br



6 0 5 5 0 1 0 3 7 0 5



Baldan



BALDAN IMPLEMENTOS AGRÍCOLAS S/A.

Av. Baldan, 1500 | Nova Matão | CEP: 15993-000 | Matão-SP | Brasil

Phone / Teléfono: (0**16) 3221-6500 | Fax: (0**16) 3382-6500

Home Page: www.baldan.com.br | e-mail: sac@baldan.com.br

Export - Phone / Teléfono: 55 16 3221-6500 | Fax: 55 16 3382-4212 | 3382-2480

e-mail: export@baldan.com.br