

GTA

• **Drag Type Offset Disc
Harrow - Heavy Duty**

Instruction Manual

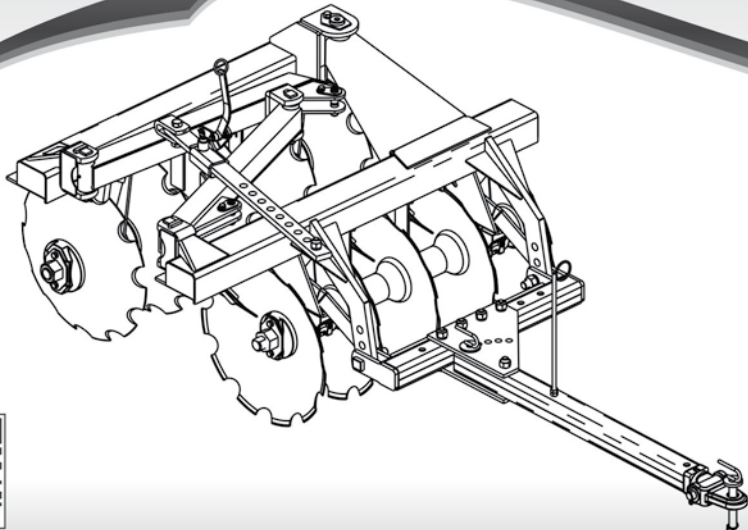

www.baldan.com.br

INTRODUCTION

We thank you for the preference and congratulate your excellent choice in acquiring an implement of outstanding quality, manufactured in accordance with the advanced technology of **BALDAN IMPLEMENTOS AGRÍCOLAS S/A.**

This manual will assist you, in proceeds necessities, since when you bought until the operational proceeds application, security and maintenance.

The **BALDAN** guarantees that deliver this implement to the dealer, working properly, and in perfect conditions.

The dealers it's under the responsibility to keep the protection and conservation while keep the implement in your stock, and than, to assembly, tighten, lubrication and overhaul.

On time of the technical deliver, the dealer must to have conducted the user customer about the manutentation, safety, and your obligations in a possible technical assistance, the obligation to see the warranty terms and read the instruction manual. Any solicitation of warranty, please contact our Baldan technical service, by your Baldan dealer that you bought our implement.

Reaffirm the necessity to read carefully of warranty certificate and note all of items from this manual, therefore you will increase the working life of your equipment.



Instruction Manual



INDEX

01. Safety standards	4
02. Components	9
03. Technical specifications	10
04. Assembly	11
<i>Union of rear and front frames</i>	13
<i>Assembling the hydraulic piston (optional)</i>	14
<i>Assembling the coupling header</i>	15
05. Coupling the disc harrow to the tractor drawbar	16
06. Adjustments and operations.....	17
<i>Adjusting the disc harrow opening</i>	17
<i>Side displacement of the disc harrow</i>	17
<i>Adjusting the cross bar on the front frame</i>	18
07. Operations	19
08. Lubrication	20
<i>Table greases and equivalents</i>	20
09. Lubrication points	21
<i>Adjustment of bearings</i>	23
10. Cleaning.....	23
11. Approximate produccion	24
12. Table of approximate production	25
13. Identification	26
14. Notes.....	28

01. SAFETY STANDARDS



THIS SYMBOL INDICATES IMPORTANT SAFETY WARNING. WHENEVER YOU FIND IT IN THIS HANDBOOK, CAREFULLY READ THE MESSAGE THAT FOLLOWS AND BE AWARE OF THE POSSIBILITY OF PERSONAL INJURY.

ATTENTION

- *Read the instruction manual carefully, so you can learn the recommended safety practices.*

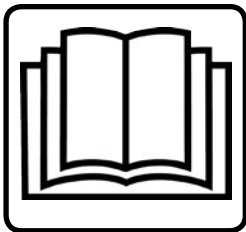

ATTENTION

- *Only start operating the tractor when properly seated and with the safety belt fastened.*



ATTENTION

- *Do not transport people on the tractor and not in or on the equipment.*



ATTENTION

- *Do not operate the tractor if the front is light. With a tendency to rise, add weights on the front of the tractor or front wheels.*



ATTENTION

- *There are risks of serious injury by tumbling when working on slopes.*
- *Do not use excessive speed.*



ATTENTION

- *Before performing any maintenance on your equipment, make sure it is turned off. Avoid getting hit.*



ALCOHOL OR DRUGS CAN GENERATE SOME LOSS OF REFLEXES AND CHANGE THE PHYSICAL CONDITIONS OF THE OPERATOR, SO, NEVER OPERATE THIS EQUIPMENT UNDER USE OF THESE SUBSTANCES.

ATTENTION

- *Keep yourself away from the active elements of the machine (discs), they are sharp and can cause accidents.*
- *When carrying any service on discs, use safety gloves on hands.*



ATTENTION

- *The hydraulic system operate with a high pressure fluid, existing risk of serious injuries or death, search for damaged hose every day and replace it.*
- *Before coupling or uncouple the hoses relief the pressure, using the tractor's control when it is turned off.*







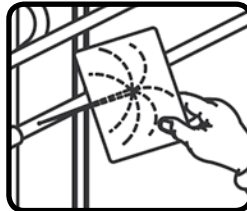



ATTENTION

- *When searching for a possible leak on the hoses, use a piece of cardboard or wood and never use your hands.*
- *Avoid the incision of fluid on the skin.*





THE MISMANAGEMENT OF THIS EQUIPMENT CAN RESULT IN SERIOUS OR FATAL ACCIDENTS. BEFORE PLACING THE EQUIPMENT IN OPERATION, CAREFULLY READ THE INSTRUCTIONS IN THIS HANDBOOK. MAKE SURE THAT THE PERSON RESPONSIBLE FOR THE OPERATION IS INSTRUCTED ON THE PROPER AND SAFE HANDLING, IF HE HAS READ AND UNDERSTOOD THE HANDBOOK OF THIS PRODUCT.

- 01-  When operating the equipment, do not allow people to stay very close or on it.
- 02-  In making any assembling and disassembling service in the discs, always use safety gloves.
- 03-  Before connecting or Disconnecting hydraulic hoses, relieve the system pressure by moving the command with the tractor off.
- 04-  Periodically check the conservation status of the hoses. If there is evidence of leaks, immediately replace them because the oil works under high pressure and can cause serious injury.
- 05-  Do not wear loose clothing as they can become entangled in moving parts.
- 06-  When turning the tractor engine on, be properly seated on the operator's seat and aware of the correct and safe management of both tractor and implement. Always put the selector lever in neutral, turn off the power take-off command and place the hydraulic commands in the neutral position.
- 07-  Do not run the engine in indoor environments without adequate ventilation, as the exhaust fumes are harmful to health.
- 08-  When maneuvering the tractor to the implement hitch, make sure that there is plenty of room and that there is nobody very close, always do the maneuvers in low gear and be prepared to brake in emergency situations.

- 09- **⚠ Do not make adjustments with the implement in operation.**
- 10- **⚠ When working on slopes, proceed with caution when trying to maintain the necessary stability. In case of unbalance, reduce the throttle and turn the wheels of the tractor to the side of the slope.**
- 11- **⚠ Always drive the tractor at speeds compatible with safety, especially when working on uneven ground or slopes. Keep the tractor always engaged.**
- 12- **⚠ When driving on roads, keep the tractor brake pedals interconnected and use safety signs.**
- 13- **⚠ Do not operate the tractor if the front is light. If there is a tendency to rise, add weights on the front or front wheels.**
- 14- **⚠ Leaving the tractor, put the shifter in neutral and apply the parking brake.**
- 15- **⚠ Alcoholic beverages and some medications can cause loss of reflexes and change the physical conditions of the operator. Therefore, never operate this equipment, under the influence of these substances.**
- 16- **⚠ Read or explain all the procedures above to the operator who cannot read.**



GTA - DRAG TYPE OFFSET DISC HARROW - HEAVY DUTY

Figure 1

02. COMPONENTS

- 01 - Front Frame
- 02 - Rear Frame
- 03 - Front stabilizer bar
- 04 - Rear stabilizer bar
- 05 - Lock handle
- 06 - Lock ruler
- 07 - Coupling header
- 08 - Discs
- 09 - Disc wiper
- 10 - Hose support

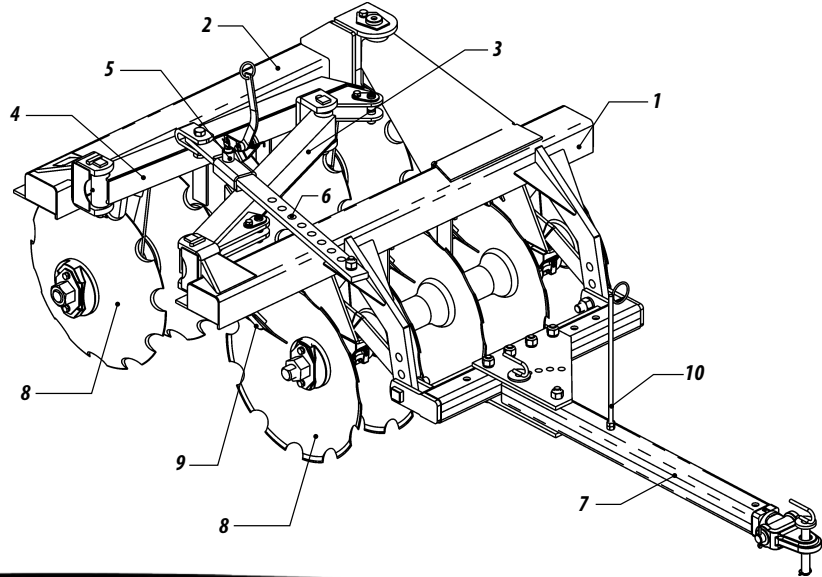

03. TECHNICAL SPECIFICATIONS

Table 1

Model	No. of Discs	Disc spacing (mm)	Disc diameter (ø)	Spherical Discs (mm)	Axle diameter (ø)	Working width (mm)	Working depth (mm)	Approx. weight (Kg)			Required tractor power (HP)
								30"	32"	34"	
GTA	10	340	30" - 32" - 34"	7,5 - 9,0 - 12,0	2.1/4"	1530	200 - 300	1655	1705	1770	90 - 100
GTA	12	340	30" - 32" - 34"	7,5 - 9,0 - 12,0	2.1/4"	1870	200 - 300	1835	1895	1966	108 - 120
GTA	14	340	30" - 32" - 34"	7,5 - 9,0 - 12,0	2.1/4"	2390	200 - 300	2007	2076	2157	126 - 140
GTA	16	340	30" - 32" - 34"	7,5 - 9,0 - 12,0	2.1/4"	2550	200 - 300	2253	2332	2431	144 - 160
GTA	18	340	30" - 32" - 34"	7,5 - 9,0 - 12,0	2.1/4"	2890	200 - 300	2547	2635	2754	162 - 180
GTA	20	340	30" - 32" - 34"	7,5 - 9,0 - 12,0	2.1/4"	3230	200 - 300	2753	2851	2978	180 - 200

BALDAN reservase el derecho de cambiar las características técnicas de este producto sin previo aviso.

Las especificaciones técnicas són aproximadas y informadas en condiciones normales de trabajo.



04. ASSEMBLY

- 01 - Check the parts with the parts list that is inside the packing box.
- 02 - The assembly must always begin with the set of discs.
- 03 - Place the shaft Item 1, Figure 2, the concave thrust washer Item 2, one washer Item 3, a nut item 4, the latch item 5 and fix with the screw Item 6 as shown in figure 2. Note that the nut is facing with the tip of the shaft.
- 04 - Place the shaft item 1, the first disc item 7, one bearing * Item 8, another disc Item 7, the separator reel item 9 and so on, as figure 2.
- 05 - When the set is complete with all discs, bearings and separator reels, place the convex thrust washer item 10, the washer Item 3, another nut Item 4, giving a prior tightening to firm the set. Check if the washers and discs did not come out of the socket.
- 06 - Then, wedge the set of discs and tighten the nut Item 4 through impacts. When it is about achieving maximum grip, adjust the lock Item 5 with the convex washer, always tighten the nut to match the drilling, fasten them through the screw Item 6.
- 07 - View of the front and rear item assembled with the lubrication system to the rear part of the implement to provide greater protection.
- 08 - When in oil bath, roller bearings should be assembled with the lubrication system (plug) facing the back of the implement according to figure 3.

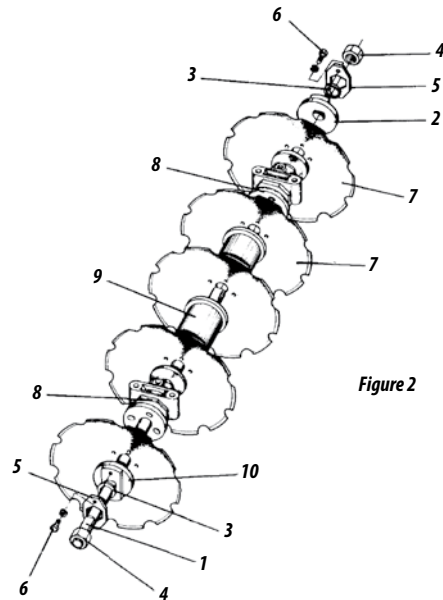

Figure 2



ATTENTION

Before beginning assembly, place PROTECTIVE GLOVES on hands.

01 - Figure 3 shows the assembly of the disc items for each disc harrow model and its respective frames.

Figures 3

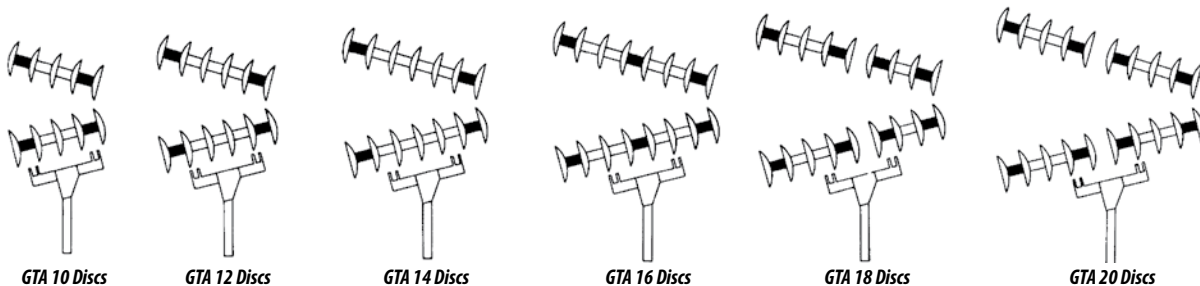

02 - When assembling the frame on the disc item, note that the bracket to fix the bearings (Shoe) should face the concavity of discs, as shown in figure 4.

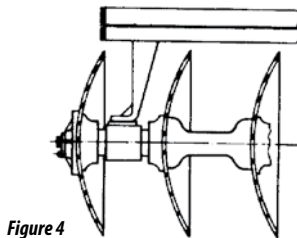

Figure 4

LEGEND

- = BEARING
- = SEPARATOR REEL
- ⌒ = DISC

UNION OF REAR AND FRONT FRAMES

- 01 - Couple the front frame Item 1, Figure 6, to the rear frame item 2 through the coupling shaft item 3 with flat washer, nut and lock screw. Couple the rear stabilizer bar item 4 on the rear frame item 2, with the coupling shaft Item 5 and washer, nut and lock pin item 7.
- 02 - Attach the rear stabilizer bar item 5 with front stabilizer bar item 7 through the coupling shaft item 8, coupling it to the front frame item 1, with the pin Item 10.
- 03 - Place the lock handle item 11 on the front stabilizer bar, passing the adjustment latch item 12 through inside the lock handle, coupling the rear stabilizer bar through screw item 13.

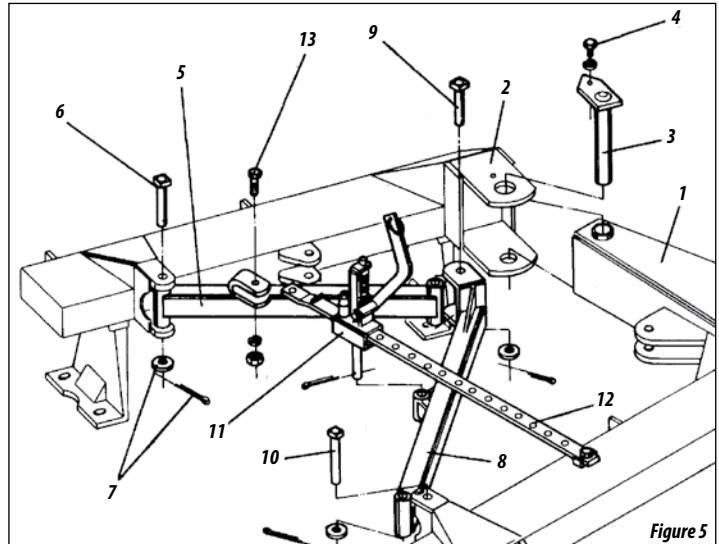

Figure 5

ASSEMBLING THE HYDRAULIC PISTON (OPTIONAL)

- 01 - Set the piston Item 1 Figure 6, so that the base of the cylinder is placed on the front frame item 2, through the pin item 3, locking it with the screw and the piston rod attached to the rear frame item 4, through pin item 5 locking with screw Item 6.
- 02 - Connect the hoses Item 7 in the hydraulic piston.
- 03 - Place the front and rear frames on flat and clean place.
- 04 - Lift a frame (front or rear), assemble the disc set online, observe the their arrangement in Figure 3. Make it coincide with the drilling of shoes with those of bearing, and make the assembly through screws Item 1 Figure 7, noting that the bracket support (shoe) should be facing the concavity of the disc as shown in Figure 3.
- 05 - Lift the other part of the disc harrow and repeat the above operation, verifying that the concavity of the discs of one section should be unlike another.
- 06 - Fix the wipers item 1, figure 8, on supports.
- 07 - Place the central wipers item 2 figure 8 in the front and rear frames.

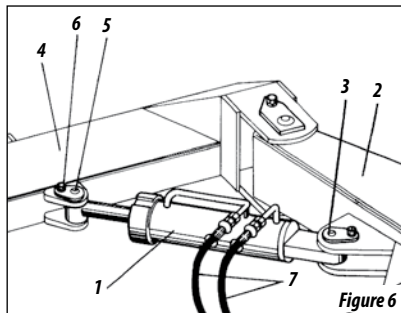

Figure 6

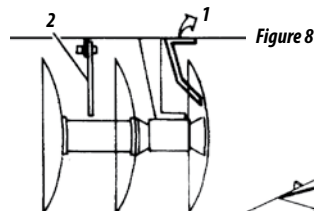

Figure 8

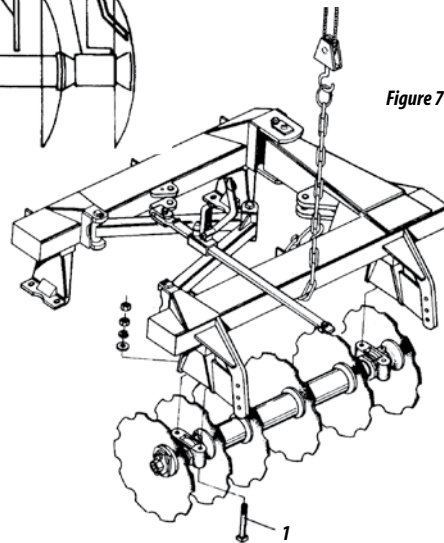

Figure 7

ASSEMBLING THE COUPLING HEADER

- 01 - Place the complete crossbar item 1 Figure 9, in the front frame item 2 using the screws Item 3.
- 02 - Place the coupling header item 4, between the upper and lower plates of the cross bar, fixing it with the screw item 5, washer and nut item 6. Place the adjustment pin item 6.
- 03 - Fix the hose support Item 8 in the header, passing the hoses through it.

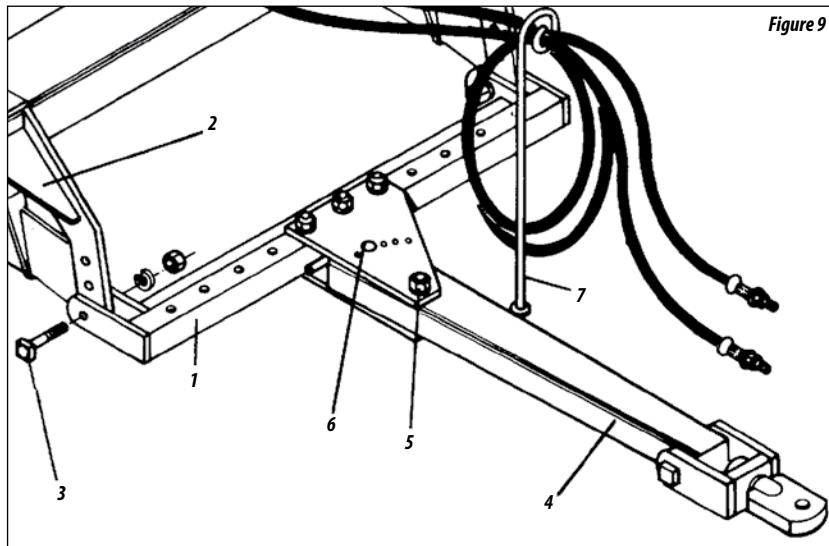

Figure 9

05. COUPLING THE DISC HARROW TO THE TRACTOR DRAWBAR

- 01 - To couple the disc harrow to the tractor drawbar, their alignment should be observed, adjust the exact height of the disc harrow and use the coupling pin "L" item 1 Figure 10.
- 02 - Before connecting or disconnecting hydraulic hoses, stop the engine and relieve the system pressure, activating the command levers completely. Make sure that, by relieving the system pressure, no one gets hurt with the movement of the equipment.



ATTENTION

When coupling the implement, find a safe and easily accessible place, always use low gear with low throttle.



ATTENTION

Connect the hoses item 2 on the quick hitch of the tractor.



NOTE

If the tractor is not equipped with hydraulic control and output for remote control, Baldan will optionally provide remote control kit appropriate for each tractor model.

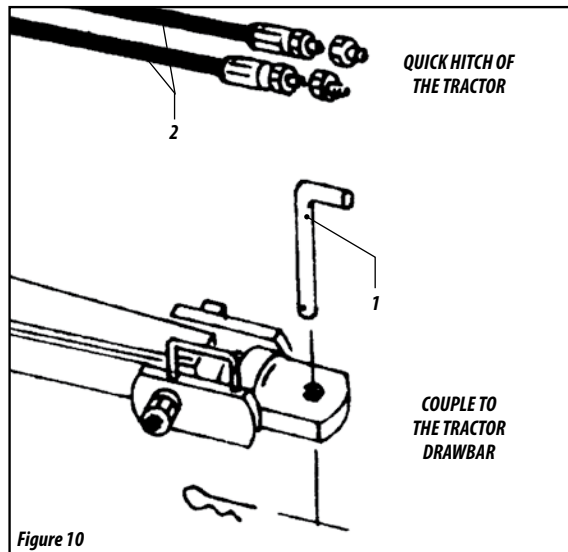

Figure 10

06. ADJUSTMENTS AND OPERATIONS

ADJUSTING THE DISC HARROW OPENING

- 01 - To obtain optimum penetration of discs, the disc harrow opening varies according to the type of soil.
- 02 - In soils more difficult to penetrate, increase the opening "A" of the disc harrow, according to figure 12.
- 03 - In loose and lighter soils, you should reduce the disc harrow opening
- 04 - To open or close, pull the rope that goes up the tractor driver, releasing the opening adjustment set. If you want to open the disc harrow, move the tractor forward, if you want to close the disc harrow, move the tractor backward.
- 05 - For transportation, completely close the disc harrow.

SIDE DISPLACEMENT OF THE DISC HARROW

- 01 - This side displacement should be done when the disc harrow is not giving a perfect finishing, that is, leaving tractor trail. The disc harrow should work centralized with the tractor traction line. To do this, move the upper and lower header plates to the right or to the left, as shown in figure 12.
- 02 - The coupling header operates in the center hole of the top and bottom plates for intermediate soils; displacing the other holes, changes the angle of the front section, as in Figure 12

- 1 *Increases penetration*
- 2 *Levels the coupling header*
- 3 *Decreases penetration*

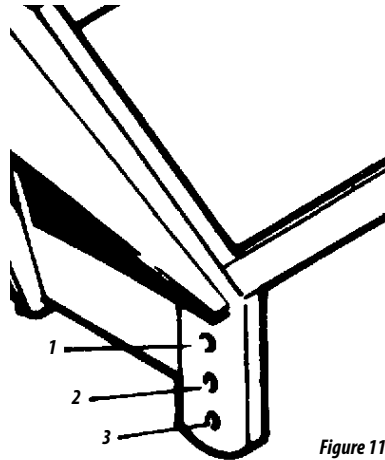
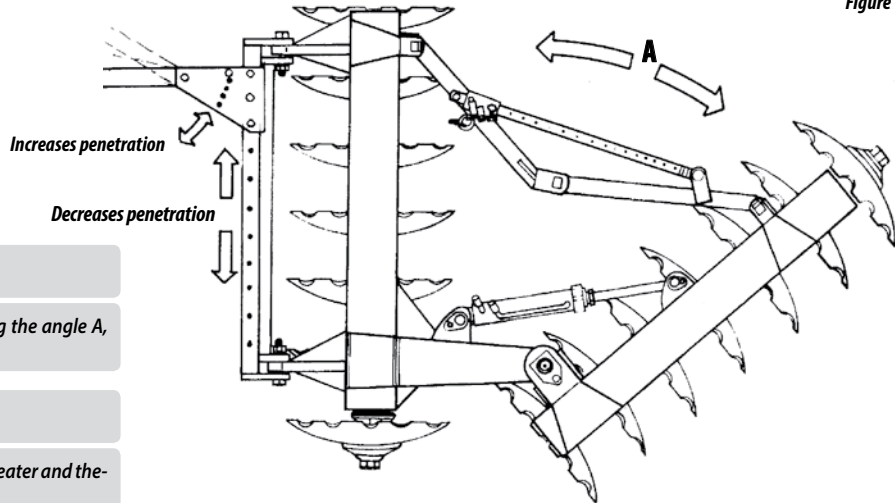

Figure 11

ADJUSTING THE CROSS BAR ON THE FRONT FRAME

01 - The coupling arms are welded in the front frame, which has three holes as in Figure 11, whose main purpose is to level the header of the disc harrow in relation to the tractor drawbar.

Figure 12



NOTE

Increasing the angle A greater penetration. Decreasing the angle A, lower penetration.



NOTE

When engaged in the upper hole, penetration will be greater and therefore in the lower hole, penetration will be lower.

07. OPERATIONS

- 01 - Before starting operations with the disc harrow, revise it completely, retighten all bolts, nuts, hose terminals, axes and especially disc sections.

HOW TO START HARROWING

- 01 - To start harrowing, you should follow the terraces or contour lines, starting operation so that the terrace is on the left side of the tractor driver.
- 02 - Do not turn it to the right, see figure 18. The harrowed soil must always be at the left side of the tractor driver.
- 03 - The figure below shows some operation systems.

TO HARROW TOWARDS THE OUTSIDE

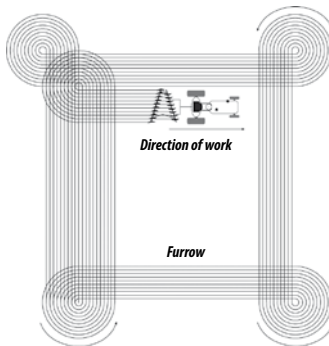
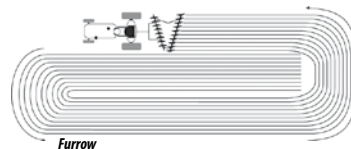

Figure 11

TO HARROW TOWARDS THE INSIDE

- 01 - In this way, we obtain greater perfection. When you start working in the headboards, you should start another plot.



PLOTS WITH CONTOUR LINES

- 01 - In soils with contour lines, it is usual to start two plots at a time, having the care to start working with the contour line of the left side of the tractor driver. When you reach the middle of the contour line, you should start another plot to save fuel.

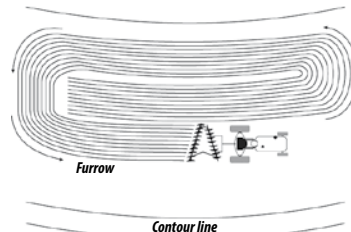

08. LUBRICATION

- 01 - Lubrication is essential for optimal performance and durability of moving parts of your disc harrow.
- 02 - Before start working, carefully lubricate all grease fittings, always observing re-lubrication intervals, making sure about the quality of the lubricant, as its efficiency and purity, avoiding the use products contaminated by water, dirt, etc.

LUBRICATION OF ROLLER BEARINGS IN GREASE

- 01 - Clean the grease fitting with a clean and lint-free cloth and replace damaged ones.
- 02 - The amount of grease in each bearing is 500 grams.
- 03 - The roller bearings should be re-lubricated every 12 hours, using the grease specified in the table below.
- 04 - The oil change should be done every 1200 working hours. Use SAE 90.mineral oil

LUBRICATION OF ROLLER BEARINGS IN OIL BATH

- 01 - In the first days of working with the disc harrow, check the oil level of bearing daily and the seals.
- 02 - Check the oil level every 120 hours.
- 03 - The oil change should be done every 1200 working hours. Use SAE 90 mineral oil.

TABLE GREASES AND EQUIVALENTS

Manufacturer	Type of grease recommended
Petrobrás	Lubrax GMA 2
Atlantic	Litholine MP 2
Ipiranga	Super Grasa Ipiranga Ipiranga Super Grasa 2 Ipiflex 2
Castrol	LM 2
Mobil	Mobilgrease MP 77
Texaco	Marfak 2 Agrotex 2
Shell	Retinax A Alvania EP 2
Esso	Multipurpose grease H
Bardahl	Maxlub APG 2 EP

Table 2



If there are manufacturers and /or equivalent brands which are not listed in the table, refer to the manufacturer's technical manual.

09. LUBRICATION POINTS

Table 3

Item	Part Description	Number of nipples						Oil replacement	Lubricate with grease	Retighten	Replace	Check	Maintenance intervals
		GTA 10 Discs	GTA 12 Discs	GTA 14 Discs	GTA 16 Discs	GTA 18 Discs	GTA 20 Discs						
1	Bearings	4	4	6	6	8	8		X				12 hours
2	Union of frames	1	1	1	1	1	1		X				
3	Piston rod	1	1	1	1	1	1		X				
4	Union of stabilizer bars	1	1	1	1	1	1		X				60 hours
5	Rear stabilizing bar	1	1	1	1	1	1		X				
6	Piston coupling	1	1	1	1	1	1		X				
7	Front stabilizing bar	1	1	1	1	1	1		X				
8	Coupling shackle	1	1	1	1	1	1		X				
9	Hydraulic system											X	
10	Bearing oil											X	120 hours
11	Nuts, screws and shafts									X			
12	Bearings							X					1200 hours
13	Seals										X		1500 hours
14	Bearings										X		
15	Discs										X		Whenever required

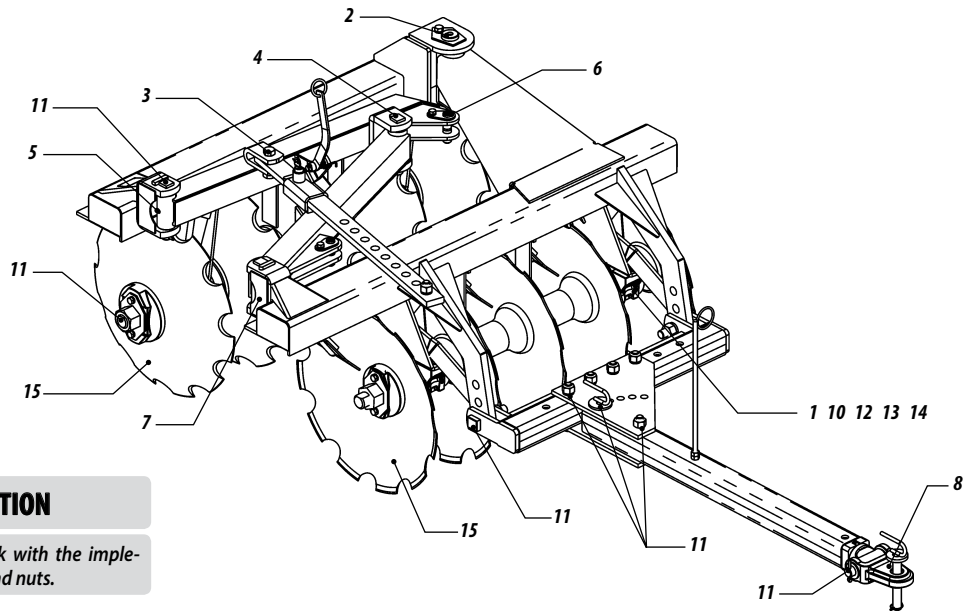

ATTENTION

After the first day of work with the implement, tighten all screws and nuts.

Figure 14

ADJUSTMENT OF BEARINGS

- 01 - When bearings show clearances, adjust them as follows:
- 02 - Loosen the nut Item 1 Figure 15, remove the lock item 2, and adjust the bearings by tightening the cover item 3, taking into account that the bearing should not work too tight not to wear excessively the bearings.
- 03 - Replace the lock item 2, the nut item 1 and retighten it.

Figure 15

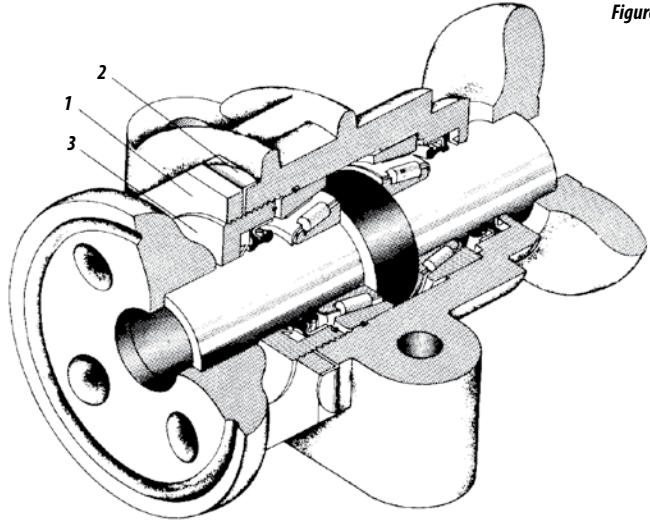

10. CLEANING

- 01 - When the disc harrow remains inactive for an extended period, make a general cleaning, make sure the cover is not worn out. If so, apply a general coat, protective oil and lubricate the disc harrow completely. Check the discs, apply a coat of paint on them and protective oil

11. APPROXIMATE PRODUCCION

01 - To calculate the approximate hourly production of the disc harrow, use the following formula:

$$A = \frac{L \times V \times F}{X}$$

WHERE

- A = Area to be worked
- L = Working width of the disc harrow (in meters)
- V = Average tractor speed (meters / hour)
- F = Production factor - 0.90
- X = Hectare value - 10,000 m²

• **Example:** Using a 14-disc disc harrow, how many Hectare it will produce in an hour of work at an average speed of 7km / h?

- A = ?
- L = 2.39m
- V = 7.000m/h
- F = 0.90
- X = 10.000 m²

$$\frac{A = 2,39 \times 7.000 \times 0,90}{10.000} = 1,50 \text{ Ha/h}$$



12. TABLE OF APPROXIMATE PRODUCTION

Table 4

Model	Spacing (m)	Working length (m/h)	Average speed	Production factor
				Hectares
GTA 10	1,53	7.000	0,90	0,96
GTA 12	1,87	7.000	0,90	1,17
GTA 14	2,39	7.000	0,90	1,50
GTA 16	2,55	7.000	0,90	1,60
GTA 18	2,89	7.000	0,90	1,82
GTA 20	3,23	7.000	0,90	2,03

01 - The formula to calculate the appropriate production refers to the calculation of the area to be worked by the disc harrow. If you want to know how long it will take to work an area of known value, simply divide the value of this area by the hourly production of the disc harrow.

- **Example:** How long (x) it will take for a 14-disc disc harrow to produce 35 hectares at an average speed of 7km / h?

$$X = \frac{35 \text{ Ha}}{1.70 \text{ Ha / h}} = 20,5 \text{ hours approx.}$$

02 - The hourly production can vary by factors that alter the pace of work, for example: humidity and soil hardness, land slope and inadequate adjustments. These factors are different from those in the Table above, which shows field work in soils under normal conditions.

13. IDENTIFICATION

- In order to refer parts catalogues or apply technical support from Baldan, always indicate model (1), serial number (2), manufacture date (3) located on the identification tag.

ALWAYS REQUIRE BALDAN ORIGINAL PARTS



BIA Baldan
BALDAN IMPLEMENTOS AGRÍCOLAS S/A.
AV. BALDAN, 1500 | CEP 15.993-000 | MATÃO-SP | BRASIL
FONE: (0xx16) 3221-6500 | FAX: (0xx16) 3382-6500
e-mail: sac@baldan.com.br | Home Page: www.baldan.com.br
CNPJ: 52.311.347/0009-06 | INSCR. EST.: 441.016.953.110

Modelo	
Nº de Série	Data

1 points to the 'Modelo' field.
2 points to the 'Nº de Série' field.
3 points to the 'Data' field.



MARKETING EDITING CATALOGS AND MANUALS

Code: 6055010029-3
Revision: 01
CPT: GTA08914



ATTENTION

The drawings in these instructions are merely illustrative.



CONTACT

*In case of doubt do not operate the equipment, please contact our After-sales Service.
Phone: 0800-152577
e-mail: export@baldan.com.br*



PRODUCT IDENTIFICATION

- Do the identification below to always have the properly informations about your equipment life time.

Owner: _____

Dealer: _____

Farm: _____ *City:* _____ *Country:* _____

Model: _____

Warranty Number: _____ *Serial Number:* _____

Purchase Date: _____ / _____ / _____ *Invoice Number:* _____

14. NOTES

This image shows a blank sheet of white paper with horizontal ruling lines. The lines are evenly spaced and run across the width of the page. There are no margins, text, or other markings on the paper.

WARRANTY CERTIFICATE

BALDAN IMPLEMENTOS AGRÍCOLAS S/A guarantees to dealer the normal functioning of the implement for a period of six (6) months as from the date of delivery on the sales invoice to the first consumer.

During this period **BALDAN** is committed to repairing material and/or manufacturing defects under its responsibility, which means that manpower, freights and other expenses are under dealer responsibility.

During the warranty period, the request and replacement of eventual defective parts should be executed by the regional dealer, who will send the defective part to **BALDAN** for analysis.

When this procedure is not possible and the problem solving capacity of the dealer is exhausted, the dealer must request the support from **BALDAN** Technical Assistance through the specific form distributed to dealers.

After Baldan Technical Assistance analyzes the replaced items and concludes that it is not a warranty issue, the dealer becomes responsible for the costs related to the replacement as well as the expenses with material, trip including accommodation and meals, accessories, lubrication used and other expenses resulting from calling Technical Assistance, and Baldan is authorized to make the respective billing in the name of the dealer.

Any repair made by the dealer on the product during the warranty period will only be authorized by **BALDAN** through prior presentation of the budget describing the parts and manpower to be executed.

The product subjected to repairs or modifications at official dealers not belonging to the network of **BALDAN** dealers as well as the application of non-genuine parts or components to the user product are not included in this deed.

The present warranty becomes void when it is confirmed that the defect or damage is the result of undue use of the product, non-observation of the instructions or the inexperience of the operator.

It is agreed that the present warranty does not cover tires, polyethylene hoppers, cardans, hydraulic components, etc, which are equipment under warranty by their manufacturers.

The manufacturing and/or material defects subject to this warranty deed will not include, under any circumstance, reason for termination of purchase and sales contract or for indemnification of any kind.

BALDAN reserves the right to change and/or improve the technical characteristics of its products without prior warning and without obligation of doing so with the previously manufactured products.



CERTIFICATE OF INSPECTION AND DELIVERY

- **SERVICE BEFORE DELIVERY:** This implement was carefully prepared by the sales organization, inspected in all its parts according to the prescriptions of the manufacturer.
- **DELIVERY SERVICE:** The user was informed on the effective warranty deeds and instructed on the use and maintenance precautions.
- I confirm that I was informed on the effective warranty terms and instructed on the correct use and maintenance of the implement.

Implement: _____ Serial Number: _____

Date: _____ Invoice Number: _____ Dealer: _____

City: _____ State: _____ Zip Code: _____

Owner: _____ Phone: _____

Address: _____ Number: _____

City: _____ State: _____

E-mail: _____ Date of sale: _____

1st Owner

Dealer Signature / Stamp _____



CERTIFICATE OF INSPECTION AND DELIVERY

- **SERVICE BEFORE DELIVERY:** This implement was carefully prepared by the sales organization, inspected in all its parts according to the prescriptions of the manufacturer.
- **DELIVERY SERVICE:** The user was informed on the effective warranty deeds and instructed on the use and maintenance precautions.
- I confirm that I was informed on the effective warranty terms and instructed on the correct use and maintenance of the implement.

Implement: _____ Serial Number: _____

Date: _____ Invoice Number: _____ Dealer: _____

City: _____ State: _____ Zip Code: _____

Owner: _____ Phone: _____

Address: _____ Number: _____

City: _____ State: _____

E-mail: _____ Date of sale: _____

2nd Dealer

Dealer Signature / Stamp _____



CERTIFICATE OF INSPECTION AND DELIVERY

- **SERVICE BEFORE DELIVERY:** This implement was carefully prepared by the sales organization, inspected in all its parts according to the prescriptions of the manufacturer.
- **DELIVERY SERVICE:** The user was informed on the effective warranty deeds and instructed on the use and maintenance precautions.
- I confirm that I was informed on the effective warranty terms and instructed on the correct use and maintenance of the implement.

Implement: _____ Serial Number: _____

Date: _____ Invoice Number: _____ Dealer: _____

City: _____ State: _____ Zip Code: _____

Owner: _____ Phone: _____

Address: _____ Number: _____

City: _____ State: _____

E-mail: _____ Date of sale: _____

3rd - Manufacturer

Please send this filled out copy to BALDAN within a maximum of 15 days.

Dealer Signature / Stamp _____



1.74.05.0059-5

AC MATÃO
ECT/DR/SP

REPLY CARD

NO NEED TO SEAL

THE STAMP WILL BE PAID BY:



BALDAN IMPLEMENTOS AGRÍCOLAS S/A

Av. Baldan, 1500 | Nova Matão | CEP [Zip Code]: 15993-000 | Matão-SP | Brazil

Phone number: (0**16) 3221-6500 | Fax: (0**16) 3382-6500

Home Page: www.baldan.com.br | e-mail: sac@baldan.com.br

Export: Phone number: 55 16 3221-6500 | Fax: 55 16 3382-4212 | 3382-2480

E-mail: export@baldan.com.br



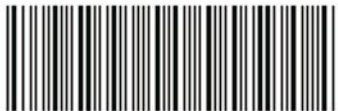

60550100293



Baldan



BALDAN IMPLEMENTOS AGRÍCOLAS S/A.

Av. Baldan, 1500 | Nova Matão | CEP: 15993-000 | Matão-SP | Brasil

Phone: (0**16) 3221-6500 | Fax: (0**16) 3382-6500

Home Page: www.baldan.com.br | e-mail: sac@baldan.com.br

Export: Phone: 55 16 3221-6500 | Fax: 55 16 3382-4212 | 3382-2480

e-mail: export@baldan.com.br