

# ***Instruction Manual***

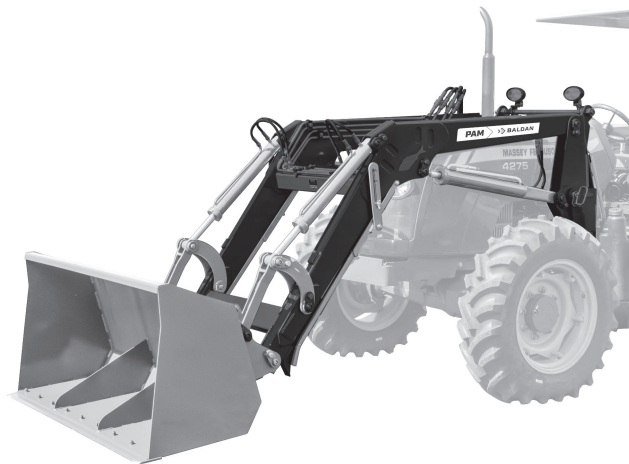

**PAM 600/1100**

Agricultural Front Attachments for Tractors

**> > BALDAN**



## INTRODUCTION

We appreciate the preference and would like to congratulate you for the excellent choice you just made, since you just made, since you have acquired a product manufactured with **BALDAN IMPLEMENTOS AGRICOLAS S/A** technology.

This manual will guide you through the procedures required since its acquisition until operational procedures of usage, safety and maintenance.

**BALDAN** assures that it has delivered this implement for resale in full and in perfect conditions. Resale was responsible for the custody and maintenance during the period in its possession, and also for the assembly, retightening, lubrication and overhaul.

During the technical delivery, dealer should guide the user regarding maintenance, safety, their obligations in eventual technical assistance, strict compliance with the warranty term and reading the instructions manual. Any technical assistance request while in warranty must be made to the dealer from whom you have purchased it. We reiterate the need for a careful read of the warranty certificate and compliance of all items from this manual, because by doing so you will increase the life of your device.



# ***Instruction Manual***

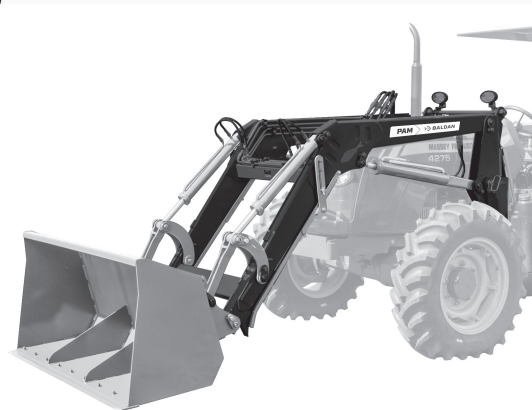

## **PAM 600/1100**

Agricultural Front Attachments for Tractors

BALDAN IMPLEMENTOS AGRÍCOLAS S/A.  
CNPJ: 52.311.347/0009-06  
Insc. Est.: 441.016.953.110



Scan the QR Code on the  
identification plate of your  
device and access this  
Instruction Manual online.

**BALDAN**

## ÍNDEX

<b>01 - Safety Rules .....</b>	<b>07 - 11</b>
<b>02 - Components:</b>	
- Agricultural Front Attachments for Tractors .....	12
<b>03 - Technical Specifications .....</b>	<b>13</b>
- Loading and Unloading Angles .....	14
- Optionals Equipments .....	15
<b>04 - Assembly:</b>	
- Assembly of Frames .....	16
- Assembly of the Tractor Shovel .....	17
- SHB Hydraulic System Assembly - Pump Assembly .....	18
- Hydraulic Circuit Assembly With Dual Control .....	19
- Hydraulic Circuit Assembly for Options Using Triple Control .....	20
<b>05 - Adjustments:</b>	
- Adjustment of Blade Cutting Depth .....	21
<b>06 - Operations:</b>	
- Options Exchange System .....	22
<b>07 - Recommendations for Use .....</b>	<b>23</b>

## ÍNDEX

<b>08 - Uncoupling and connecting to the tractor .....</b>	<b>24</b>
<b>09 - Maintenance and Lubrification:</b>	
- Maintenance .....	25
- Lubrification .....	25 - 26
- Tractor Oil Level (BT System) .....	27
- Oil Chance (SHB System) .....	27
- Operational Maintenance .....	28 - 29
<b>10 - Care .....</b>	<b>30</b>
- General Cleaning .....	30
<b>11 - Version .....</b>	<b>31</b>
- PAM-C - Agricultural Front Attachments Cylinder for Tractors .....	31
<b>12 - Identification .....</b>	<b>32</b>
- Production Identification .....	33
<b>Notes .....</b>	<b>33 - 34</b>
<b>Guarantee Certificate .....</b>	<b>35 - 41</b>



## 01 - SAFETY RULES



THE SYMBOL INDICATES IMPORTANT SAFETY WARNING. WHERE TO FIND IT IN MANUAL CAREFULLY READ THE FOLLOWING MESSAGE AND BE AWARE OF PERSONAL INJURIES.



### WARNING

- Carefully read the instructions manual to know the recommended safety practices.



### WARNING

- Only start operating the tractor when properly accommodated and with the sit belt locked.



### WARNING

- Do not transport people or equipment on the tractor.



### WARNING

- There are risks of severe injuries due to tipping when working in sloped terrains.
- Do not over speed.



## 01 - SAFETY RULES



### WARNING

- Before performing any maintenance in your equipment, make sure it is properly stopped.
- Avoid being run over.



### WARNING

- When looking for possible leaks in hoses, use a cardboard or wood, never use your hands.
- Avoid fluid incision into the skin.

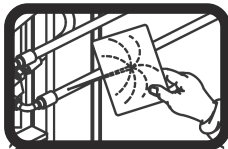

### WARNING

- Do not work with the tractor if the front has insufficient ballast to the rear equipment.
- Should there be a trend to lift, add weights or ballats to the front or the front wheels.



### WARNING

- Always maintain places of access and work free of residues such as oil or grease to prevent accidents.



ALCOHOLIC DRINKS OR OTHER DRUGS CAN CAUSE LOSS OF REFLEXES AND ALTER THE PHYSICAL CONDITIONS OF THE OPERATOR. THEREFORE, NEVER OPERATE THIS EQUIPMENT WHEN UNDER THE INFLUENCE OF THESE SUBSTANCES.



**BALDAN**

*Instruction Manual*

**PAM 600/1100 - 8**



### WARNING

- When operating the PAM, do not allow people to stay very close to or below the same.
- Avoid accidents caused by action up and down the support Mobile.



### WARNING

- The hydraulic oil operates pressurized and can cause serious injuries, in case of leakage. Periodically verify the condition of the hoses. If there are any signs of leakage, replace them immediately.
- Before connecting or disconnecting the hoses, relieve hydraulic system pressure, triggering the triggering the command with the tractor off.









FOLLOW ALL RECOMMENDATIONS, WARNINGS AND SAFE PRACTICES RECOMMENDED IN THIS MANUAL, UNDERSTAND THE IMPORTANCE OF YOUR SAFETY. ACCIDENTS MAY LEAD TO INVALIDITY OR INCLUDE DEATH.







**WARNING:**



The mishandling of this equipment can result in serious or fatal accidents. Before placing the implement in operation, carefully read the instructions in this manual. Make sure that the person responsible for the operation is instructed regarding the correct and safe handling, and have read and understand the operating instructions for this machine.

- 1 -  When operating the modulated agricultural shovel, do not allow people to stay very close to or on the implement.
- 2 -  Do not use loose clothes as they can curl up on the equipment.
- 3 -  When putting the tractor engine running, you should be properly seated in the operator's seat and aware of the complete, proper and safe handling for both the tractor and the equipment. Always place the gearshift lever in neutral position, take the command off the PTO.
- 4 -  Do not run the engine indoors or without adequate ventilation, because the exhaust fumes are harmful to health.
- 5 -  When driving the tractor on roads keep the brake pedals interconnected and use safety signs.
- 6 -  When leaving the tractor, place the gearshift lever in neutral and apply the parking brake.
- 7 -  When working on slopes proceed with caution always looking to maintain the necessary stability. In case of early imbalance, reduce the throttle; turn the wheels to the side of the land declivity.



- 8 -  Always drive the tractor at speeds compatible with safety, especially when working in rough terrain or slopes, always keep the tractor hitched, always keep the tractor hitched. Always keep the tractor hitched.
- 9 -  Do not traverse the roads, especially at night. Use warning signs all the way.
- 10 -  Do not work with the tractor if the rear is light. If there is a tendency to lift, add weights at the rear or rear wheels. Remove front weights from the tractor.
- 11 -  Do not use the PAM 600/1100 with the tractor's front drive system engaged. Ignoring this warning may cause damage the PAM 600/1100 or tractor.
- 12 -  When there is an exhaust adapter in the equipment, keep distance according to the instructions on the sticker.
- 13 -  Alcohol or drugs can generate some loss of reflections and change the physical conditions of the operator. Therefore, do not operate this equipment under the use of these substances.
- 14 -  Read or explain all the above procedures to the user that cannot read.

*If in doubt, do not operate or handle the PAM, consult Pos-Sales.  
Telephone: 0800-152577 or e-mail: posvenda@baldan.com.br*

## 02 - COMPONENTS

- 1 - Mobile Holder
- 2 - Rod
- 3 - Tower
- 4 - Hydraulic Piston or Mobile Holder
- 5 - Support Foot
- 6 - Pivot Support (Boomerang)
- 7 - Shovel
- 8 - Shovel Blade
- 9 - Hydraulic Piston and Pivot Support
- 10 - Oil Lead Pipes
- 11 - Hidraulics Hose
- 12 - Keys

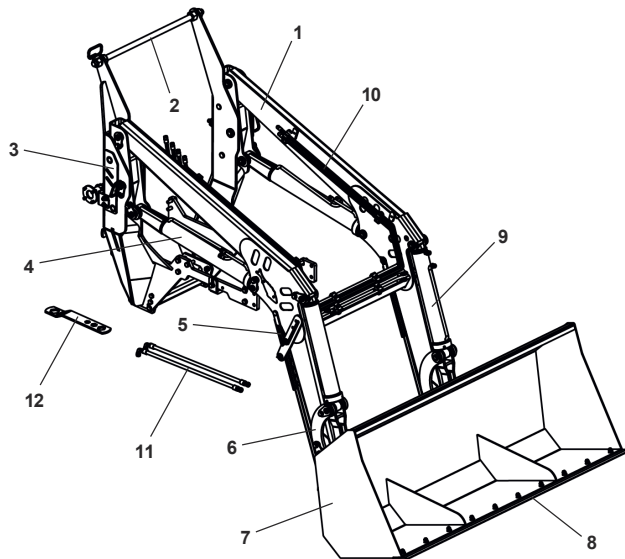

FIGURE01

### 03 - TECHNICAL SPECIFICATIONS

TABLE 01

MODEL	TRACTORS	SHOVEL			BLADE (BLA)			SWATHER (EEM)			SILAGE FORK (GAS)			BIG BAG (BBA)		
		Width (mm)	Capacity (m³)	Height lift (mm)	Width (mm)	Height (m³)	Weight (Kg)	Width (mm)	No. of teeth	Weight (Kg)	Width (mm)	Volume (mm)	Weight (Kg)	Width (mm)	Capacity of load (Kg)	Weight (Kg)
PAM 600	<b>Valtra</b> 88-4 / 785-4 / 800-4 / 885-4s 900-4 / <b>BM</b> 85-4 / 100-4 / A650.4 / A750.4 / A850.4 / A950.4 <b>Massey Ferguson</b> 265 / 265-4 / 275 / 275-4 / 283 / 283-4 / 290 / 290-4 (Advanced) 292-4 / 291.4 / 4275.4 / 4283.4 / 4290.4 / 4291.4 <b>New Holland</b> TL 55 à 100 / TL 55.4 à 100.4 / TT 4030-4 <b>John Deere</b> 5603-4 / 5403-4 / 5600-4 / 5605-4 / 5700-4 / 5705-4 / 5055-4 / 5065-4 / 5075-4 E / 5078-4 E <b>LS Tractor Plus</b> 80.4 / 90.4 <b>Case Farmall</b> 80.4 / 95.4 BT e SHB	1700	0,600	2900*	2150	430	190	2300 2625 2625	8 9 11	270 302 332	1600	0,75	310	1100	1000	177
PAM 1100	<b>Ford N. H.</b> TS 6020.4 / 7630.4 série 2007 GII BT / SHB (Motor NH / NIF) <b>John Deere</b> 6415.4 / 6415.4 Classic / 6615.4 / 7515.4	1700 1900	0,600 0,700	3900*	2600	510	305	3175	13	492	1600	0,75	310	1100	1000	177

\*The technical specifications are approximate and reported in normal working conditions.

Baldan reserves the right to change the technical specifications of this product without prior notice.

(\*) The height varies depending on the tractor model and the tire used.  
 • Optional: Blade. / Swather. / Silage Fork. / Winch.

## LOADING AND UNLOADING ANGLES

Cylinder with thinner  $\varnothing$  for a higher working speed.

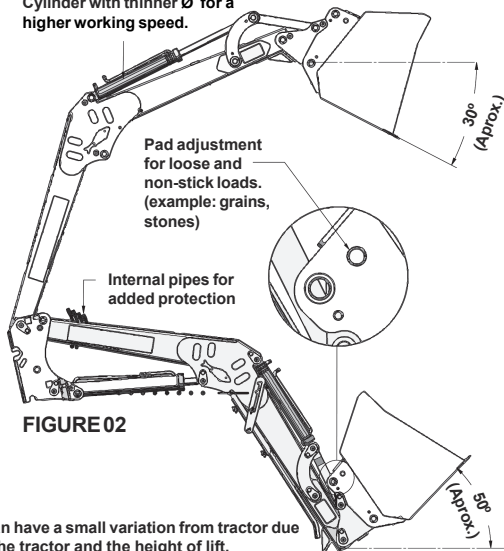

The inclination angle of the brucket can have a small variation from tractor due to positioning of the equipament on the tractor and the height of lift.

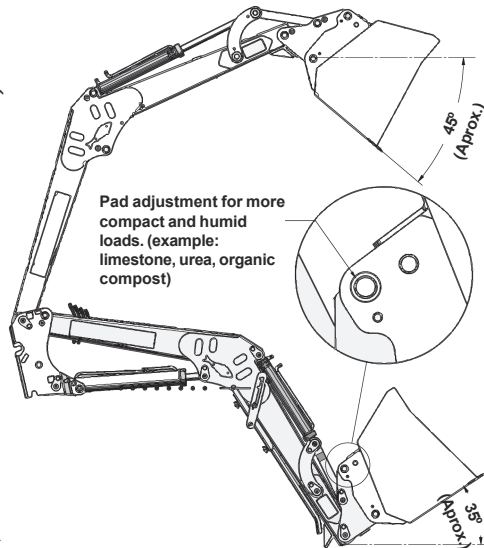

## OPTIONAL EQUIPMENTS

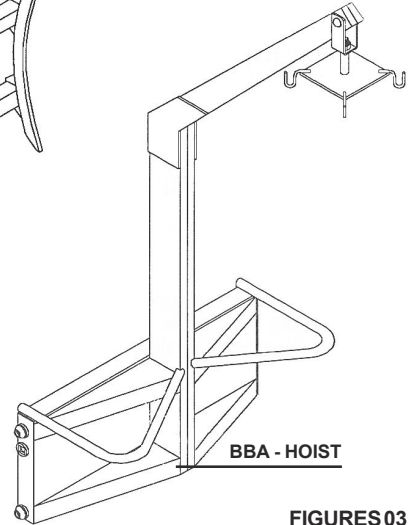
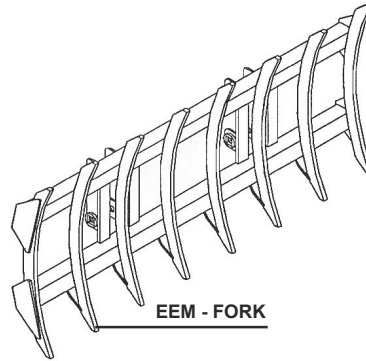
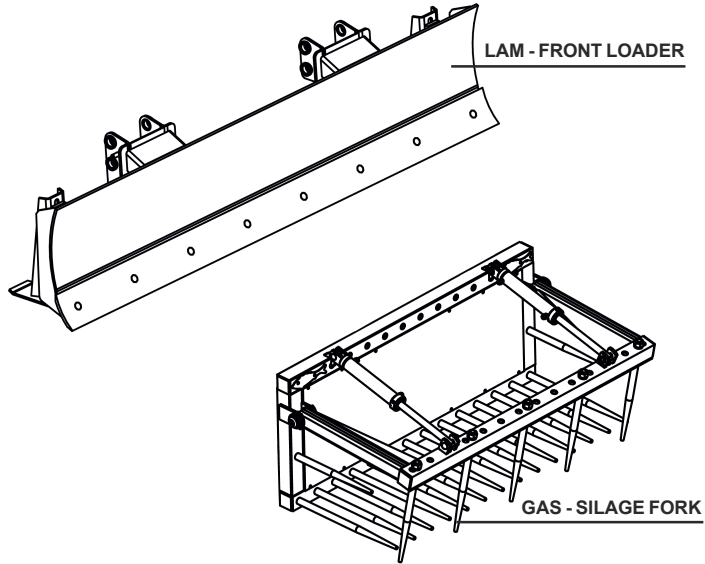

FIGURES03

## 04 - ASSEMBLY

- 1 - Check parts against the list that is inside the packing box.
- 2 - Place the tractor on a flat and clean place.
- 3 - Remove the front counterweights from the tractor and other components if necessary (headlights, radiator protection grille, etc.).

### ASSEMBLY OF FRAMES

- 1 - Secure the side supports (1) on the rear axle of the tractor with the fasteners (2).
- 2 - Place the right and left side (3) on the rear bracket (1), securing with screws (4) and the front of the housing of the tractor, securing with screws (5).



### IMPORTANT

*The assembly basically follows as described, due to the great diversity of models of tractors on the market, following an arrangement attached to each model.*

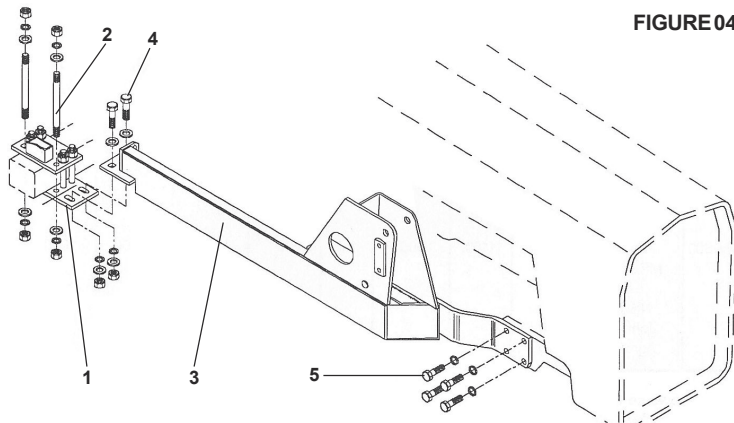

FIGURE 04



**BALDAN**

**Instruction Manual**

**PAM 600/1100 - 16**

## ASSEMBLY OF THE TRACTOR SHOVEL

1 - Position the complete shovel and tractor, bring the same structure and attach the bracket (1) to the frame (2) via pin (3).

2 - Loosen the wing nut (4), articulate the support bracket (5), and retighten the wing nut.

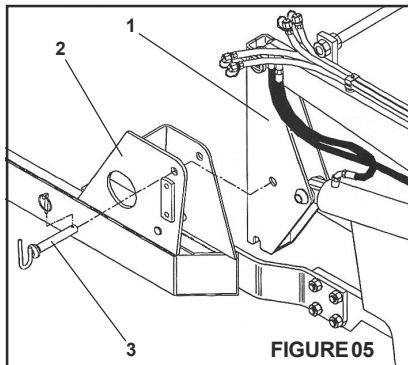

FIGURE 05



### NOTE

*Couple or uncouple always idling.*

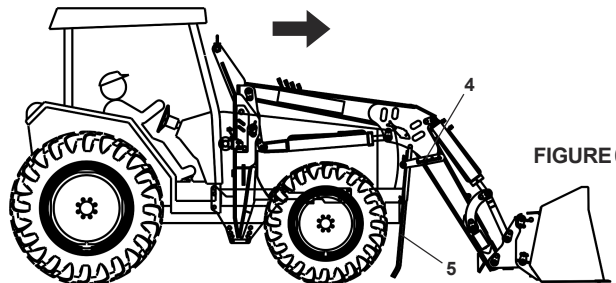

FIGURE 06

3 - For BT hydraulic system (tractor pump), connect the hydraulic hoses to the tractor rear outlets. For SHB system (Baldan Hydraulic System) proceed as in the following figures.



### IMPORTANT

*The BT system (pump tractor) is recommended for tractors with hydraulic oil flow above 51l/min at 200 rpm.*

*For tractors with hydraulic oil flow less than 51 l/min, we recommend using the SHB system (Baldan Hydraulic System), to give a faster movement of the shovel.*

## SHB HYDRAULIC SYSTEM ASSEMBLY - PUMP ASSEMBLY

- 1 - Connect the flange (1) on the crankshaft pulley of the tractor, using the screws (2).
- 2 - Insert the splined shaft (3) with bushing (4) on the flange (1).
- 3 - Attach the complete hydraulic pump (5) on the front support of the tractor.

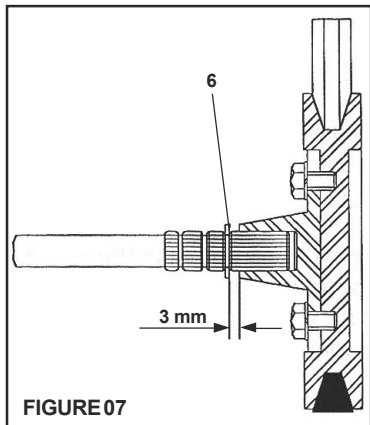

### IMPORTANT

*When mounting the hydraulic pump, observe a gap of 3mm between the shaft and the flange, as detail of figure 07. For this clearance, place the ring (6) in one of the existing grooves of the splined shaft.*

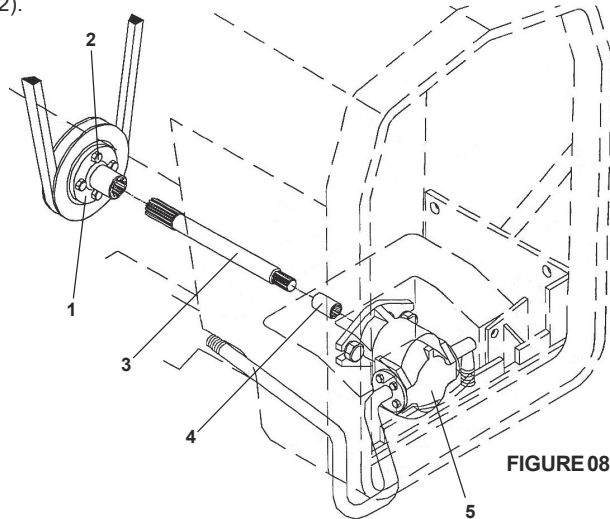

## HYDRAULIC CIRCUIT ASSEMBLY WITH DUAL CONTROL

1 - Attach the complete oil tank (1) to the side frame (2) through bolts with washers (3).

2 - Proceed to connect the hydraulic hoses as follows:

- Connect the return hose (4) of the filter head to the hydraulic control;

- Connect the pressure hose (5) to the pump (6) to the hydraulic control and suction hose (7) between the pump pipe and the bottom outlet of the oil tank (1);

- Proceed to connect the hoses (8) of the piston drive between the hydraulic control and the pipes (9).

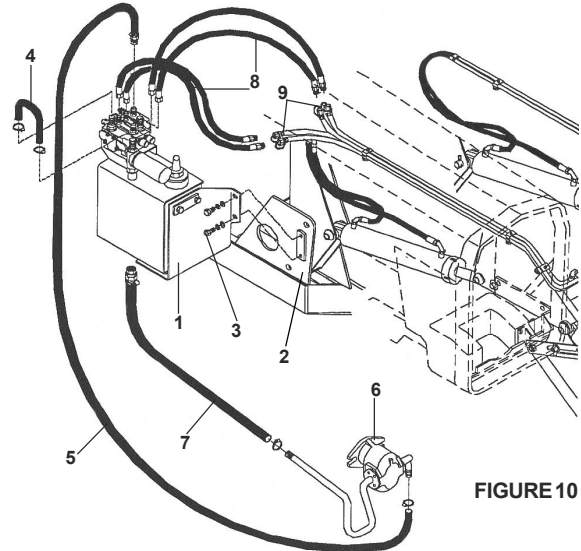
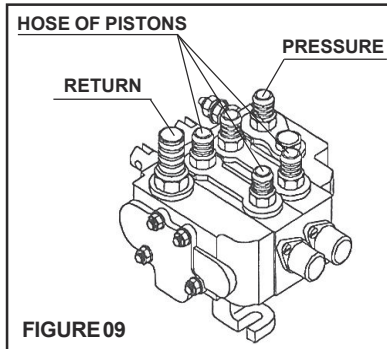

## HYDRAULIC CIRCUIT ASSEMBLY FOR OPTIONS USING TRIPLE CONTROL

- 1 - Connect the hoses between the hydraulic control and the pipes for optional (1).
- 2 - Connect the hoses (2) between the pipes (1) to outputs of the pipes (3) of optional element.

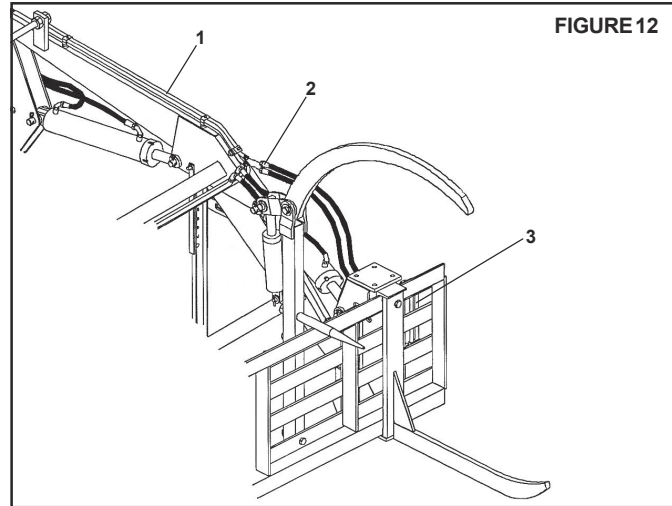
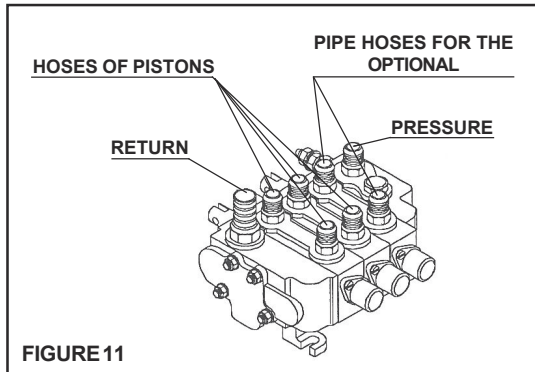

## 05-ADJUSTMENTS

### ADJUSTMENT OF BLADE CUTTING DEPTH

1 - To regulate the blade cutting depth, loosen the screw (1) and move the stand (2) to the desired position.

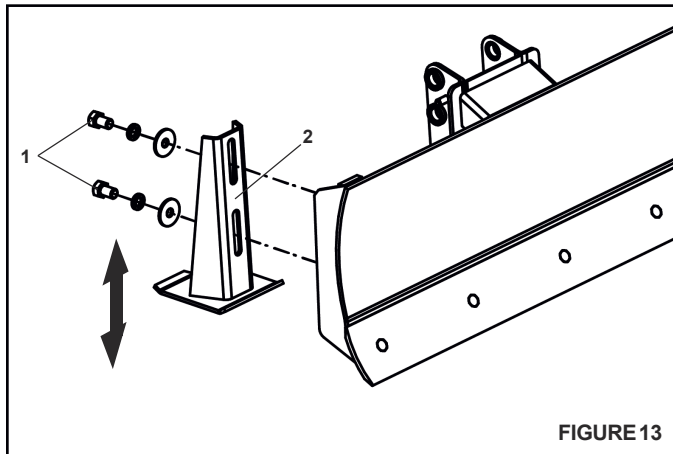

### OPTION EXCHANGE SYSTEM

1 - The PAM is a device modulated with optional equipment, all with the same structure coupling system.  
2 - To exchange a product for another, proceed as follows:

- Support the set tha will be taken at a local level;
- Remove the locking pin (1) on both sides;
- Gently depress the lever of the hydraulic command to the undocking of the support (2) of pins (3);
- In equipment with piston to drive the top (silage fork or log), uncouple hydraulic hoses;
- Drive the tractor to other equipment that will be attached and proceed in a manner contrary to decoupling.

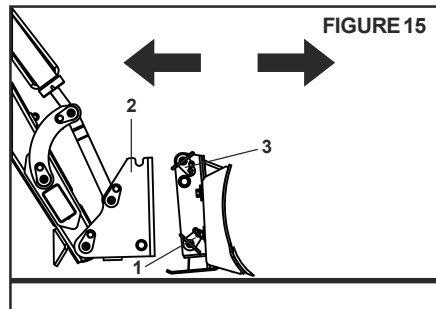
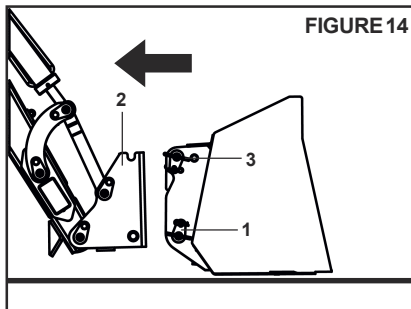

**WARNING**

*In making the exchange of equipment do not allow people to stay close to service areas.*



## 07 - RECOMMENDATIONS FOR USE

1 - PAM (Agricultural Front Attachments for Tractors) is an implement of lightweight, so it is not recommended for services that require large efforts.

2 - LAM (Front Loader) is recommended to carry out various tasks on the farm within the load limits for which it was scaled.



### WARNING

*Is not appropriate for services of deforestation or land stump*

3 - PAM (Agricultural Front Attachments for Tractors), recommended for loading loose products, such as: grain, fertilizers, gravel, sand and according to the load capacity set to 0,600 m<sup>3</sup> e 0,700 m<sup>3</sup> to PAM 600 and PAM 1100 respectively.

4 - GAS (Silage Fork), the product inside the silo is packaged, so in order to remove it you should proceed as shown in Figure 16, i.e., from top to bottom, so that it becomes detached more easily.



### WARNING

*Do not attempt to detach the product by engaging reserve gear on the tractor, it must be done through the drive of the hydraulic piston, moving the fork up and down to loosen the portion to be removed, thus preventing damage to the equipment.*

FIGURE 16

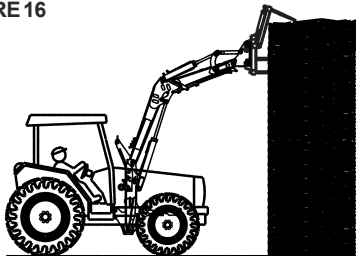
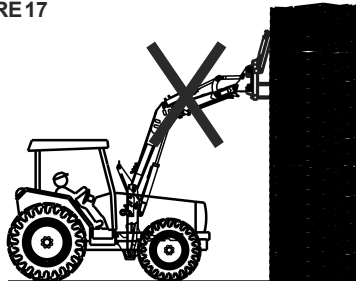

FIGURE 17



## 08 - UNCOUPLING AND CONNECTING TO THE TRACTOR

- 1 - To decouple the tractor, choose a plan location, properly support the implement on the ground, remove the pin (1) loosen the wing nut of the support bracket (2), articulate the same to the vertical position and in a firm location and retighten wing nuts.
- 2 - Detach the hydraulic hoses from quick couplers of the pipes (3).
- 3 - Take reserve gear slowly until releasing the joint.
- 4 - Do not move the set while it is not attached to not harm this operation later.
- 5 - To reattach the implement to the tractor, proceed the decoupling operation in reverse.

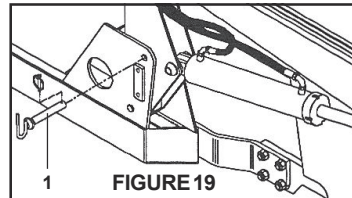
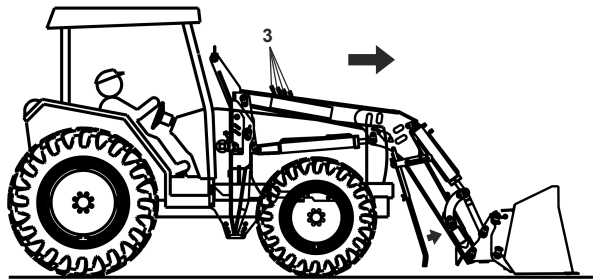
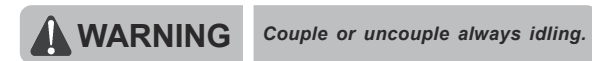
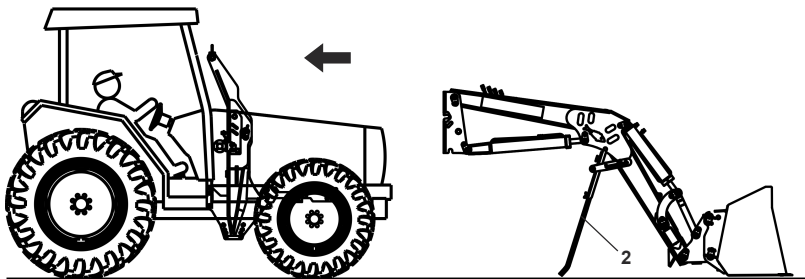

FIGURE 18



09 - MAINTENANCE AND LUBRIFICATION

MAINTENANCE

- 1 - Check conditions and tightening of screws, nuts and bolts of the blade every day.
- 2 - Check wear and sharpening of the cutting blade periodically, if necessary replace it.

LUBRIFICATION

- 1 - Lubrification is essential for a good performance and great durability of moving parts of the shovel, helping the maintenance costs saving.
- 2 - Before starting operation, carefully lubricate all grease fittings, always observing relubrication intervals, making sure the quality of the lubricant, as its efficiency and purity, avoiding using products contaminated by water, land or other agents.
- 3 - Before starting lubrication, clean all grease fittings with a lint-free cloth and replace them if damaged.

TABLE 02

MANUFACTURER	RECOMMENDED GREASE TYPE	
PETROBRÁS ATLANTIC IPIRANGA CASTROL TEXACO SHELL ESSO	LUBRAX GMA2 ALUBRIFICANT 54 SUPER GRAXA IPIRANGA MOBIL GREASE MP MARFAK 2 RETINAX A MULTIPURPOSE GREASE H	<p>NOTE</p> <p>If there are manufacturers and equivalent brands not included in table, consult the technical manual of the manufacturer.</p>

4 - Lubrification points.

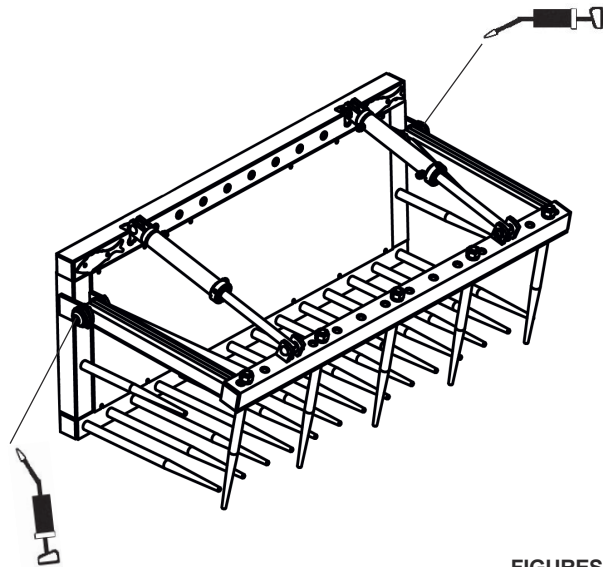
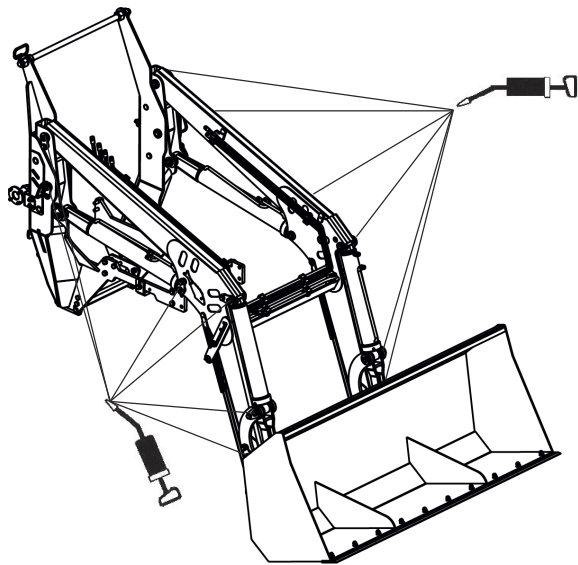

FIGURES 20

### TRACTOR OIL LEVEL (BT SYSTEM)

- 1 - Before starting operations with the blade, check the hydraulic oil level, this is because the hydraulic shovel will be stocked, for this proceed as follows:
- Start the engine of the tractor for a few minutes to warm the oil.
- Operate lever in both directions several times so that the oil fills the entire circuit.
- After, check the oil level and refill to level.
- Use only oil recommended by the tractor manufacturer.

### OIL CHANGE (SHB SYSTEM)

- 1 - Periodically check the oil level in the tank. Refill as necessary.
  - 2 - When using a particular brand of oil, do not fill the tank with oil from another brand and other specification.
  - 3 - Change the oil every 1.200 working hours.
  - 4 - To change the oil, proceed as follows:
- Place the tractor on a flat and clean place;
  - Heat oil, or make the exchange after a day of work;
  - Raise the blade to maximum height;
  - Turn off the tractor engine, chock the wheels and apply the brakes;
  - Remove the tank lid and the oil drain bottom plug;
  - With the engine off, drive the command switch to lower the shovel;

- Remove the oil filter;
- Thoroughly clean the hydraulic system, using clean, lint-free cloths. Do not use burlap because it is the greatest enemy of the hydraulic system;
- Replace the plug below the oil tank;
- Refill the tank;
- Replace the filter cap and run the blade for a few minutes, then check the oil level.

TABLE03

MANUFACTURER	RECOMMENDED OIL TYPE
PETROBRÁS	LUBRAX IND HR 32EP LUBRAX IND HR 68EP
ESSO	NU TO H 32 NU TO H 68
YPIRANGA	IPITUR AW 32 IPITUR AW 68
MOBIL	HYDRAULIC AW 68
SHELL	TELLUS 32 TELLUS 68
TEXACO	RANDO HD 32 RANDO HD 68



### IMPORTANT

*If there are other brands of equivalent oils not listed in this table, consult the oil manufacturer's own technical manual.*

*Always use Tellus 68 or 32 hydraulic oil.*

## OPERATIONAL MAINTENANCE

PROBLEMS	PROBABLE CAUSES	SOLUTIONS
The structure descends without triggering the command. (does not stay in the desired position).	<ul style="list-style-type: none"> <li>- Cylinder internal leak.</li> <li>- Control valve internal leak.</li> </ul>	<ul style="list-style-type: none"> <li>- Raise the blade to the maximum, remove the upper hose from the cylinder, the operate the control lever in the direction (up) and therefore not drain the oil. If there is a leak, check the piston repair and connection set.</li> </ul>
Leakage at both ends of the spool.	<ul style="list-style-type: none"> <li>- Sealing rings in the valve body.</li> </ul>	<ul style="list-style-type: none"> <li>- Replace the sealing rings.</li> </ul>
Arrested reels.	<ul style="list-style-type: none"> <li>- Application of oil on the reel seal, on the lid.</li> </ul>	<ul style="list-style-type: none"> <li>- Remove the cover, if there is oil, replace the reel sealing rings. Check if the retainer it is not deformed and the discharge orifice of the valve to the tank, which may be causing excessive backpressure.</li> </ul>
Quick couplings do not fit or leak.	<ul style="list-style-type: none"> <li>- Different quick couplings, one is needle coupling, another is sphere coupling.</li> <li>- Repairs damaged.</li> </ul>	<ul style="list-style-type: none"> <li>- Change the quick couplings for male and female of the same type.</li> <li>- Replace the repairs.</li> </ul>

## OPERATIONAL MAINTENANCE

PROBLEMS	PROBABLE CAUSES	SOLUTIONS
Hydraulic system does not run actuating the valve.	Defective pump (A). Defective cylinder (B). Load greater than the capacity of the system (C). Relief valve does not operate correctly (D). Dirt between relief valve piston and valve seat (E). Valve body is clenching (F).	A - Check the hydraulic pressure in the pump discharge. B - Replacing the cylinder. C - Check the tractor manual. D - Adjust the valve. E - Disassemble, clean and reassemble. F - Replace the valve.
Does not move the shovel to any direction or moves with difficulty.	Unequal plug pressure (A). Dent pipes (B). Reversed hoses (C).  Command insufficient pressure (D).	A - Adjust or replace if necessary. B - Unloack or touch the pipe. C - Check the entire system and mount the hoses correctly. D - Set the command through the relief valve with the help of a manometer. (normal pressure 180 Kg/cm <sup>2</sup> ).
Hydraulic piston leaking.	Repairs damaged (A). Damaged stem (B). Oil with impurities (C). Working pressure exceeding the recommended (D).	A - Replace the repairs. B - Replace the stem. C - Change oil and filter elements. D - Set the command through the relief valve with the help of a manometer.

## 10 - CARE

- 1 - Check the condition of all pins and bolts before starting the use of PAM.
- 2 - Every 8 hours, retighten the bolts and nuts.
- 3 - The travel speed must be carefully controlled as the terrain conditions.
- 4 - PAM are used in various applications requiring knowledge and attention during handling.
- 5 - Only local conditions may determine the best mode of operation of planers.
- 6 - When assembling or disassembling any portion of PAM, employ appropriate methods and tools.
- 7 - Always check if the parts do not show wear. If you need replacement, **always require Baldan original parts.**
- 8 - When PAM is to remain inactive for a long period, maintain it and clean it.

## GENERAL CLEANING

- Due to the corrosive action of the soil, we recommend that you clean PAM before storing it, to preserve and extend the life of your equipment. To do this, proceed as follows:

- 1 - First take a general cleaning, removing all residues that are in the PAM. Then wash it off completely.
- 2 - Then, check if the ink did not wear, if that happened, take a full coat on all these points.
- 3 - Lubricate totally PAM and check the moving parts for wear or looseness make the necessary adjustment or replacement of parts, leaving the machine ready for the next work.
- 4 - After all the care and maintenance, store your PAM in a safe place away from pets and children.
- 5 - If it is necessary, replace the damaged stickers with new and original ones.



### WARNING

*Do not use chemical cleaners to wash the PAM, this may damage the paintings on it.*



## 11 - VERSION

### PAM-C - AGRICULTURAL FRONT ATTACHMENTS CYLINDER FOR TRACTORS

1 - PAM can be purchased in the **PAM-C** version (with 1 cylinder).

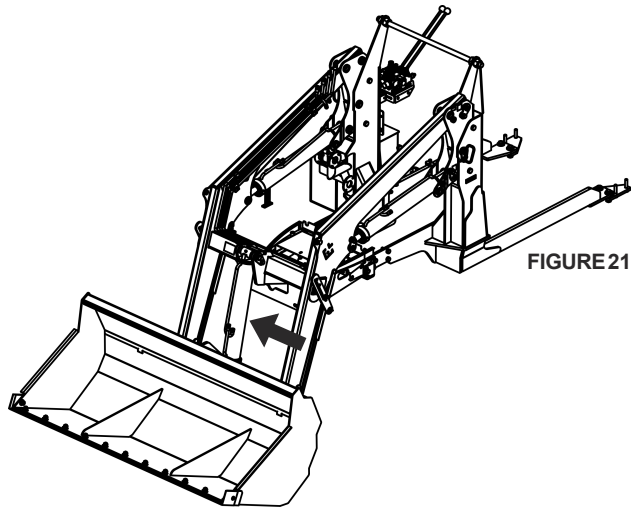

FIGURE 21

## 11 - IDENTIFICATION

1 - To view the part catalog or request technical assistance in Baldan, always indicate the model (1), serial number (2) and date of manufacturing (3), which is on the identification label (4) of PAM.

2 - ALWAYS REQUIRE BALDAN ORIGINAL PARTS.

 <b>BALDAN</b> BALDAN IMPLEMENTOS AGRÍCOLAS S/A. AV. BALDAN, 1500   NOVA MATÃO CEP 15.993-900   MATÃO-SP   BRASIL FONE: (16) 3221-6500 CNPJ: 52.311.347/0009-06   CREA/SP 0170977		
Modelo / Model	Data / Date	
Nº de Série / Serial Number	Tipo / Type	
Capacidade / Load Capacity	Peso / Weight	

### PUBLICATIONS

Code: 60550107832

CPT: PAMB09018

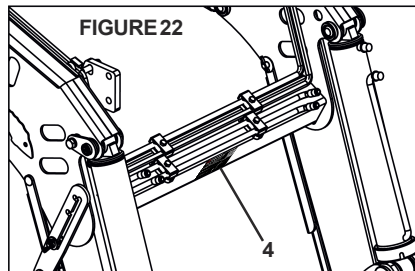

**WARNING**

*The drawings in this manual are merely illustrative.*



**CONTACT**

*If in doubt, do not operate or handle the PAM, consult Post-Sales.*

*Telephone: 0800-152577*

*E-mail: posvenda@baldan.com.br*



**BALDAN**

**Instruction Manual**

**PAM 600/1100 - 32**

## IDENTIFICATION OF PRODUCT

Make the correct identification of the data below, to always have information about the life of your equipment.

Ower: \_\_\_\_\_

Reseller: \_\_\_\_\_

Farm: \_\_\_\_\_

City: \_\_\_\_\_ State: \_\_\_\_\_

Warranty Certificate No:

Model: \_\_\_\_\_

Serial No.: \_\_\_\_\_

Date of Purchase: \_\_\_\_/\_\_\_\_/\_\_\_\_ NF. N°: \_\_\_\_\_

**Notes:**

This image shows a full page of blank handwriting practice paper. It features approximately 20 evenly spaced, horizontal blue lines across the entire width of the page. The lines are thin and consistent in color and thickness, providing a guide for letter height and placement. There are no margins, text, or other markings on the paper.

This image shows a single sheet of white paper with horizontal ruling lines. The lines are evenly spaced and run across the width of the page. There are no margins, text, or other markings on the paper.

## CERTIFICATE OF WARRANTY

**BALDAN IMPLEMENTOS AGRÍCOLAS S/A**, guarantee the normal operation of the product for a 6 (six) months period dated from the dealers's bill of sale to the first final customer.

During this period **BALDAN** compromise it self to repair the material or manufaturing defects, but the labour, the freight and other expenses are the dealer's responsibility.

At the garantee period, all the request and replacement of any defective part must be made to the dealer of the region, which will send the defective part for analysis at **BALDAN**.

When this procedure won't be possible and the dealer couldn't have the ability to solve the problem, the dealer can ask for **BALDAN'S TECHNICAL ASSISTANCE** using the specific form delivered to them.

After the analysis of the items replaced by **BALDAN TECHNICAL ASSISTANCE** and if we conclude that it wasn't a guarantee problem, then the dealer will be the responsible for all costs related to the replacement; as well as material expenses, travel including accommodation and meals, also the accessories, lubricant used or any other expenses after having called the Technical Assistance. And, withal, the company Baldan is authorized to issue the billing is name of the respective reseller.

Any repair made to the product wich is in warranty period by the dealer, will only be authorized by **BALDAN** after budget previous presentation describing pieces and labour to be a accomplished.

It is out of this term the product wich has repairs or modifications not made by dealers from **BALDAN'S** network, as well as pieces applications or not authentic components to the product by the user.

This certificate of guarantee will became invalid when notice that the damage or defect is the result of incorrect use of the product, of instructions non-observance or operator's inexperiences.

It's stipulated that this guarantee don't cover tires, polyethylene deposits, universal joints, hydraulic components, etc, wich equipments are guarantee by their manufacturers.

The material or manufacturer defects, object of this certificate of guarantee, will not be, by any hypotesis, reason for cancelattion of the contract of sale, or indemnity of any kind.

For a warranty solicitation to the distributor, you have to proceed in the following manner:

Send the technical informe detailed telling the problem (technical assistance request form to the client), you cand find it send us an email to [aftersales@baldan.com.br](mailto:aftersales@baldan.com.br) or acessing our website.

If it's possible send films and photos from the requested spare parts.

## CERTIFICATE OF WARRANTY

To poin at the form: serial number, manufacturer year, etc, that is, all information asked at the form. The damage spare parts should be available for analysis of the sales department in a future visit (in case of requested).

**BALDAN** keeps the right of chaging and or improve the technical characteristic of its products, without notice and without the obligation of act like this way with its previously manufactured products.

## INSPECTION AND DELIVERY CERTIFICATE

**SERVICE BEFORE THE DELIVERY:** This equipment was very carefully prepared by the dealer's organization, inspected in all its parts in agreement with the manufacture's prescription.

**DELIVERY SERVICE:** The user was informed about the current guarantee terms and instructed about maintenance care and utilization.

I confirm that i was informed about the current guarantee terms and instructed about the correct utilization and maintenance of this product.

PRODUCT \_\_\_\_\_ SERIAL NUMBER \_\_\_\_\_

DATE \_\_\_\_\_ BILL OF SALE \_\_\_\_\_ STORE \_\_\_\_\_

CITY \_\_\_\_\_ STATE \_\_\_\_\_ ZIP CODE \_\_\_\_\_ PHONE \_\_\_\_\_

OWER \_\_\_\_\_

ADRESS \_\_\_\_\_ N° \_\_\_\_\_

CITY \_\_\_\_\_ STATE \_\_\_\_\_

E-MAIL \_\_\_\_\_

\_\_\_\_\_  
DATE OF SALE

\_\_\_\_\_  
SIGNATURE / STORE'S STAMP



## INSPECTION AND DELIVERY CERTIFICATE

**SERVICE BEFORE THE DELIVERY:** This equipment was very carefully prepared by the dealer's organization, inspected in all its parts in agreement with the manufacture's prescription.

**DELIVERY SERVICE:** The user was informed about the current guarantee terms and instructed about maintenance care and utilization.

I confirm that i was informed about the current guarantee terms and instructed about the correct utilization and maintenance of this product.

PRODUCT \_\_\_\_\_ SERIAL NUMBER \_\_\_\_\_

DATE \_\_\_\_\_ BILL OF SALE \_\_\_\_\_ STORE \_\_\_\_\_

CITY \_\_\_\_\_ STATE \_\_\_\_\_ ZIP CODE \_\_\_\_\_ PHONE \_\_\_\_\_

OWER \_\_\_\_\_

ADRESS \_\_\_\_\_ N° \_\_\_\_\_

CITY \_\_\_\_\_ STATE \_\_\_\_\_

E-MAIL \_\_\_\_\_

\_\_\_\_\_  
DATE OF SALE

\_\_\_\_\_  
SIGNATURE / STORE'S STAMP



## INSPECTION AND DELIVERY CERTIFICATE

**SERVICE BEFORE THE DELIVERY:** This equipment was very carefully prepared by the dealer's organization, inspected in all its parts in agreement with the manufacture's prescription.

**DELIVERY SERVICE:** The user was informed about the current guarantee terms and instructed about maintenance care and utilization.

I confirm that i was informed about the current guarantee terms and instructed about the correct utilization and maintenance of this product.

PRODUCT \_\_\_\_\_ SERIAL NUMBER \_\_\_\_\_

DATE \_\_\_\_\_ BILL OF SALE \_\_\_\_\_ STORE \_\_\_\_\_

CITY \_\_\_\_\_ STATE \_\_\_\_\_ ZIP CODE \_\_\_\_\_ PHONE \_\_\_\_\_

OWER \_\_\_\_\_

ADRESS \_\_\_\_\_ N° \_\_\_\_\_

CITY \_\_\_\_\_ STATE \_\_\_\_\_

E-MAIL \_\_\_\_\_

\_\_\_\_\_  
DATE OF SALE

\_\_\_\_\_  
SIGNATURE / STORE'S STAMP

3ª PAGE - MANUFACTURER

Please send this filled copy to Baldan, until 15 days after the purchase.





Avenida Baldan, 1500  
Nova Matão  
15.993-900  
Matão/SP - Brasil  
[sac@baldan.com.br](mailto:sac@baldan.com.br)  
[export@baldan.com.br](mailto:export@baldan.com.br)

+55 16 3221 6500  
[baldan.com.br](http://baldan.com.br)