

# PSH

• **Post hole digger**

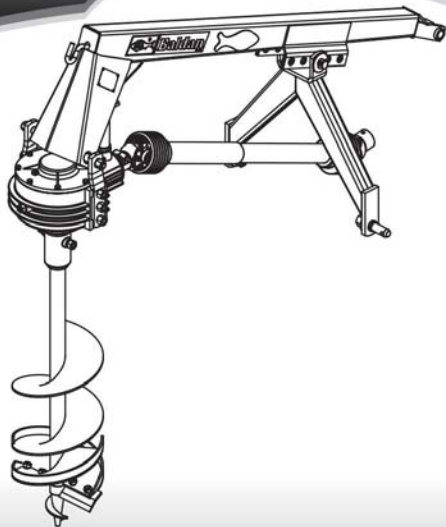

[www.baldan.com.br](http://www.baldan.com.br)

***Instruction Manual***



## INTRODUCTION

We thank you for the preference and congratulate your excellent choice in acquiring an implement of outstanding quality, manufactured in accordance with the advanced technology of BALDAN IMPLEMENTOS AGRÍCOLAS S/A.

This manual will assist you, in proceeds necessities, since when you bought until the operational proceeds application, security and maintenance.

The BALDAN guarantees that deliver this implement to the dealer, working properly, and in perfect conditions.

The dealers it's under the responsibility to keep the protection and conservation while keep the implement in your stock, and than, to assembly, tighten, lubrication and overhaul.

On time of the technical deliver, the dealer must to have conducted the user customer about the manutentation, safety, and your obligations in a possible technical assistance, the obligation to see the warranty terms and read the instruction manual. Any solicitation of warranty, please contact our Baldan technical service, by your Baldan dealer that you bought our implement.

Reaffirm the necessity to read carefully of warranty certificate and note all of items from this manual, therefore you will increase the working life of your equipment.



# ***Instruction Manual***



## ÍNDEX

01 - Safety Rules .....	4 - 7
02 - Components .....	8
03 - Technical Specifications .....	9
04 - Assembling .....	10
05 - Clamp .....	11 - 12
06 - Regulations and Operations .....	13
07 - Operations .....	13
08 - Maintenance .....	14
09 - Storage .....	15
10 - Identification .....	15

## 01 - SAFETY RULES



THIS ALERT SYMBOL INDICATES IMPORTANT SAFETY NOTES. WHENEVER YOU FIND IT IN THIS MANUAL, READ THE MESSAGE WITH ATTENTION TO AVOID ANY ACCIDENT.



### ATTENTION

- Read this instruction manual carefully to know the recommended safety rules.



### ATTENTION

- Only start the tractor operations, when are you properly accommodated and with the seat belt fasted.



### ATTENTION

- Never carry people over the tractor or equipment.





## ATTENTION

- There are risks of serious injury by tipping when working on slopes.
- Never use excessive speed.



## ATTENTION

- Before any equipment maintenance, make sure that is properly stopped.
- Avoid getting hit



















ALCOHOL AND DRUGS MAY GENERATE LOSS OF REFLEX AND CHANGING OF OPERATOR FISICAL CONDITIONS. SO DO NOT WORK WITH THIS EQUIPMENT, IN USE OF THIS SUBSTANCE.

#### **WARNINGS:**



The incorrect handling of this equipment can result in serious or fatal accidents. Before using the implement, read carefully the instructions of this manual. Be sure that the person responsible for the operation is instructed about the correct handling, safety and if read and understood the instructions manual concerning this machine.

- 1 -  When operating the equipment make sure that nobody remains closer or on the same.
- 2 -  Do not transport the Post hole digger hitched to the PTO switched on.
- 3 -  If during the perforation you fill excess resistance, don't go on with the work before to release the drill or eliminate any other possible think.
- 4 -  Do not make holes deeper as recommended.
- 5 -  Do not use baggy clothes that can twist to the machine.
- 6 -  Before you start the tractor engine, be firmly seated and sure you know thr operation of both, tractor and implement. Make sure the gear lever is in the neutral position, the P.T.O. drive is disengaged, and that the hydraulic lever command is also in the neutral position..
- 7 -  Do not start the tractor engine indoors without adequate ventilation, the exhaust gases are harmful to health.

- 8 -  When hitching the implement onto the tractor obliges you to manœuvre the tractor, make sure that there is enough room and that nobody close around can be caught. Always manœuvre with the engine in indle speed and be prepared immediatly the break when necessary.
- 9 -  Do not make adjustments with the equipment working.
- 10 -  When operating on sloping land in contours, procced carfully always keep the machine stability. In case of instability initiation, reduce speed turn the tractor hill downwards and lever lift the implement.
- 11 -  Always drive the tractor at a safety complatible speed, especially in the work in rough terrain or inclines. Always keep the tractor hooked up.
- 12 -  Driving the tractor on roads keep the break pedals connected and make use of safety light.
- 13 -  Do not work with the tractor front light. With a tendency to rise, add weights on the front or on wheels.
- 14 -  When you leave the tractor, make sure that the gear is in the neutral position, and the parking breaks applied.
- 15 -  Alcohol and drus may generate loss of reflex and changing of operator fisical conditions. So do not work with this equipment in use of this substance.
- 16 -  Read and explain all the proceeds above to the user that can not read.

## 02 - COMPONENTS

- 1 - Frame
- 2 - Hitch Arm
- 3 - Reduction Box
- 4 - Automatic Leveling Regulator of Drill
- 5 - Helicoidal Spring
- 6 - Drill (9" - 12" - 18")
- 7 - Drill Knife
- 8 - Drill Pointer
- 9 - PTO
- 10 - Hitch Pin

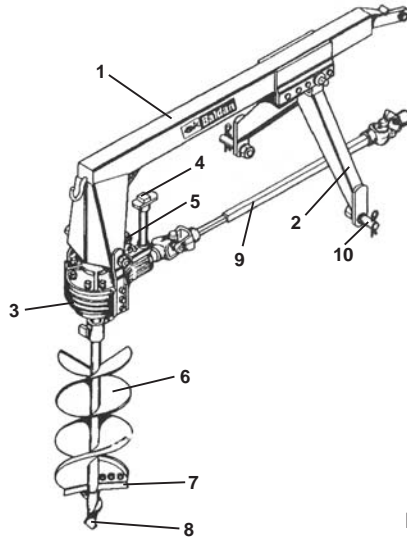

FIGURE 01

03 - TECHNICAL ESPECIFICATIONS

<i>Model</i>	<i>Drill diameter (ø)</i>	<i>Hole Depth (mm)</i>	<i>Hole Diameter (mm)</i>	<i>Approx. Weight (Kg)</i>	<i>Approx. RPM Drill</i>	<i>Required tractor power (Hp)</i>
PSH	-	-	-	144	128	40 (PTO 540 RPM)
PSH	9"	1000	230	164	128	40 (PTO 540 RPM)
PSH	12"	1000	310	172	128	40 (PTO 540 RPM)
PSH	18"	1000	460	187	128	40 (PTO 540 RPM)

TABEL 01

\*Baldan reserves the right to modify any technical specifications without prior notice.

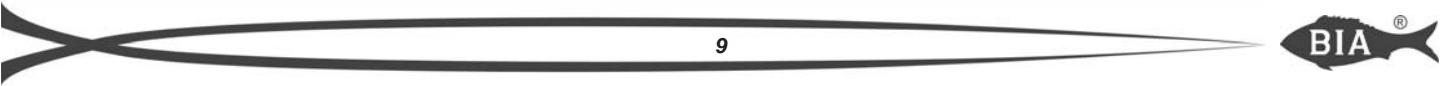

## 04 - ASSEMBLING

- 1 - Check the parts with the list that you will find into the package box.
- 2 - Assembly in the frame item 1 figure 2, the reduction box item 2, using the bolts item 3 and lock with nut item 4.
- 3 - Fix the spring item 5 on frame and reduction box.
- 4 - Fix on frame item 1 with head coupling item 6, by the pin item 7, locking it with cotter pin item 8.

**NOTE:** The drill should be placed after.

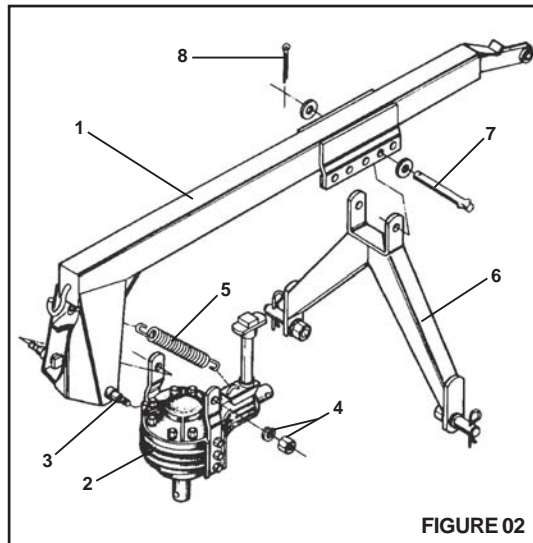

## 05 - CLAMP

### POST HOLE DIGGER CLAMP

1 - Before to clamp the post hole digger to the tractor, make sure that the equipment it's able to work as follow:

- Take off the arm from 3° point of tractor.
- Take off the traction bar from the tractor.

2 - Hitch the arm item 1 figure 3, on lower arm "A" of tractor with hitch pin item 2.

3 - Hitch the main frame item 3 on support "B", from where arm of 3° point tractor was took off.

4 - After to clamp the hole digger on 3° point of tractor, centralize and level related to the tractor, through the regulation handle "C" of right lower arm of tractor.

5 - The PTO item 7 should be fixed at the reduction box of post hole digger, plain side and use the slot key and the cotter pin.

6 - Check the loose "F" on telescopic axle as shown on figure 4, this should be the minimum of 20mm. If has no loose, adjust the PTO length.

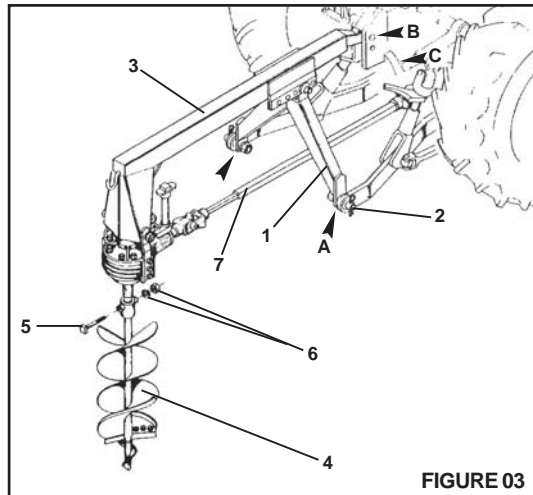
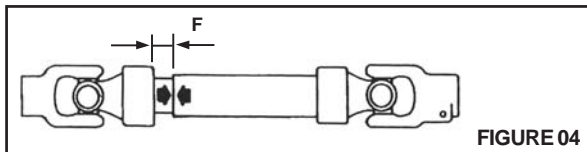

## PTO LENGTH ADJUSTMENT

- 7 - To adjust the length cut off on either sides of PTO proportionally.
- 8 - Clean the points.
- 9 - To assembly the PTO, make sure the alingment of salience of intern forks, to avoid vibration and to prolong the PTO life, as shown on figure 4.
- 10 - Connect the drill item 4, figure 3 on reduction gear axle, and fix with bolt item 5, washer and nut item 6.
- 11 - Connecting the PTO on (TDF), the tractor should be with engine running with and the parking break applied.
- 12 - Connect the flange (striated side) on outlet axle of (TDF) tractor, as shown on figure 5. Notice that the clamp will be complete when the key bolt pull out.
- 13 - Before to start the digger, make sure if the PTO it's free and cutter pin.
- 14 - When the PTO has protection, lock with the self chain, on implement and the tractor.

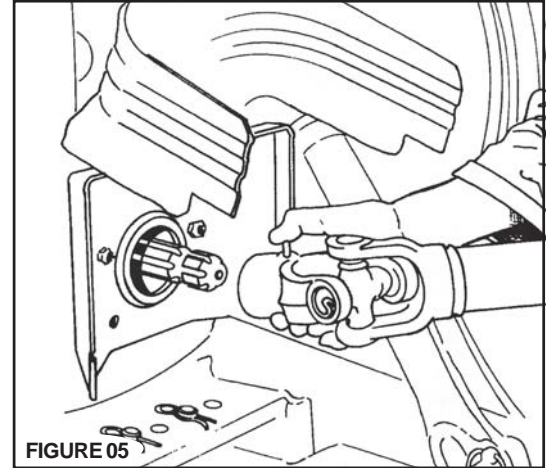

## 06 - REGULATIONS AND OPERATIONS

1 - According to tractor model, regulate the height of digger on clamp arm, according letters "A to B", figure 6.

A - To taller tractors.

B - To lower tractors.

### VERTICAL REGULATION OF DRILL

2 - Drop the digger until the drill point touch the soil, move the tractor to front or to back, until the drill stay 90° as shown on figure 6, after that release the stopper item 1, regulate the bolt item 2 until to touch at the upper metal sheet of frame. Tight again the stopper item 1.

## 07 - OPERATIONS

1 - The hole perforation, should be done in 2 or 3 steps, and never once, to avoid overweighth on digger and on tractor and have better efficiency.

2 - The drill has a doble spiral, that is able to have a perforation for about 60 to 100 holes by hour and a maximun deep of 1000mm.

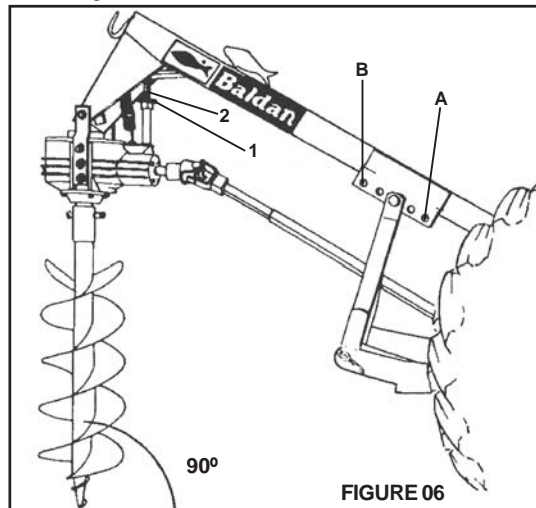

## 08 - MAINTENANCE

- 1 - Check daily the conditions and tight, of bolts, nuts and pins of digger.
- 2 - Check periodic the conservation of knives and points of drill and replace it as show any excess wastage.

### LUBRIFICATION

- 3 - The lubrication it's essential for a good work and better durability of digger.
- 4 - Before to start the work, lubricate carefully all the grease points, notice the relubrication interval, make sure about the oil quantity, about your efficiency and purity, avoiding to use contaminated products by water, dust and etc.
- 5 - Before the lubrication clean the grease points with a clean cloth, without of fine thread and replace the damages, if has.
- 6 - Lubricate all the grease points each 8 hours of work.

### OIL CHANGE

- 7 - Check the oil level do reductor daily, and fill when necessary.
- 8 - Change the oil each 1500 hours of work, using 3.300 liters of mineral oil SAE 90.
- 9 - When are you using a particular oil brand, avoid to complete the level with another one specification.

### LUBRICATION POINTS

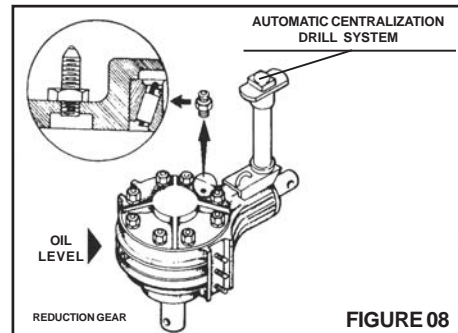
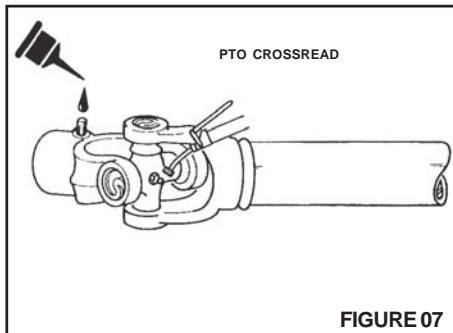

## 09 - STORAGE

- In the end of work, the equipment must to be cleaned and checked, make sure if has no broked and wear parts. Applies a layer of oil on all suface that may have dryness or corrosion and paint that when necessary. Store the equipment on a flat surface in a protected place away from pets and children.

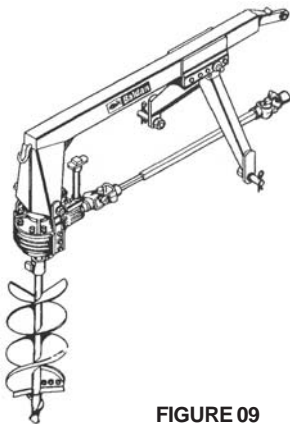

FIGURE 09

## 10 - IDENTIFICATION

1 - To view the parts catalog or request BALDAN technique assistance, always indicate the model (1), serial number (2) and date of manufacture (3), that is on the identification tag.

2 - ALWAYS REQUEST ORIGINAL BALDAN SPARE PARTS



**BIA Baldan**  
BALDAN IMPLEMENTOS AGRÍCOLAS S/A.  
AV. BALDAN, 1500 | CEP 15.993-000 | MATÃO-SP | BRASIL  
FONE: (0xx16) 3221-6500 | FAX: (0xx16) 3382-6500  
e-mail: sac@baldan.com.br | Home Page: www.baldan.com.br  
CNPJ: 52.311.347/0009-06 | INSCR. EST.: 441.016.953.110

1 Modelo	
2 Nº de Série	3 Data



### ATTENTION

The draws in this instruction manual are only to illustrate.



### Marketing

Catalogues and  
Manuals Edition

**Illustrations and Diagram:** Fabrício  
**Code:** 6055020140-5 **Revision:** 01  
**Publication:** Setembro/2009  
**CPT:**PSH16712

This image shows a single sheet of white paper with horizontal ruling lines. The lines are evenly spaced and run across the width of the page. There are no margins, text, or other markings on the paper.





## WARRANTY CERTIFICATE

**BALDAN IMPLEMENTOS AGRÍCOLAS S/A** guarantees to dealer the normal functioning of the implement for a period of six (6) months as from the date of delivery on the sales invoice to the first consumer.

During this period **BALDAN** is committed to repairing material and/or manufacturing defects under its responsibility, which means that manpower, freights and other expenses are under dealer responsibility.

During the warranty period, the request and replacement of eventual defective parts should be executed by the regional dealer, who will send the defective part to **BALDAN** for analysis.

When this procedure is not possible and the problem solving capacity of the dealer is exhausted, the dealer must request the support from **BALDAN** Technical Assistance through the specific form distributed to dealers.

After Baldan Technical Assistance analyzes the replaced items and concludes that it is not a warranty issue, the dealer becomes responsible for the costs related to the replacement as well as the expenses with material, trip including accommodation and meals, accessories, lubrication used and other expenses resulting from calling Technical Assistance, and Baldan is authorized to make the respective billing in the name of the dealer.

Any repair made by the dealer on the product during the warranty period will only be authorized by **BALDAN** through prior presentation of the budget describing the parts and manpower to be executed.

The product subjected to repairs or modifications at official dealers not belonging to the network of **BALDAN** dealers as well as the application of non-genuine parts or components to the user product are not included in this deed.

The present warranty becomes void when it is confirmed that the defect or damage is the result of undue use of the product, non-observation of the instructions or the inexperience of the operator.

It is agreed that the present warranty does not cover tires, polyethylene hoppers, cardans, hydraulic components, etc, which are equipment under warranty by their manufacturers.

The manufacturing and/or material defects subject to this warranty deed will not include, under any circumstance, reason for termination of purchase and sales contract or for indemnification of any kind.

**BALDAN** reserves the right to change and/or improve the technical characteristics of its products without prior warning and without obligation of doing so with the previously manufactured products.



---

## *Instructions Manual*

## CERTIFICATE OF INSPECTION AND DELIVERY

- **SERVICE BEFORE DELIVERY:** This implement was carefully prepared by the sales organization, inspected in all its parts according to the prescriptions of the manufacturer.
- **DELIVERY SERVICE:** The user was informed on the effective warranty deeds and instructed on the use and maintenance precautions.
- I confirm that I was informed on the effective warranty terms and instructed on the correct use and maintenance of the implement.

Implement: \_\_\_\_\_ Serial Number: \_\_\_\_\_

Date: \_\_\_\_\_ Invoice Number: \_\_\_\_\_ Dealer: \_\_\_\_\_

City: \_\_\_\_\_ State: \_\_\_\_\_ Zip Code: \_\_\_\_\_

Owner: \_\_\_\_\_ Phone: \_\_\_\_\_

Address: \_\_\_\_\_ Number: \_\_\_\_\_

City: \_\_\_\_\_ State: \_\_\_\_\_

E-mail: \_\_\_\_\_ Date of sale: \_\_\_\_\_

1<sup>st</sup> Owner

Dealer Signature / Stamp \_\_\_\_\_

---

# Instructions Manual



## CERTIFICATE OF INSPECTION AND DELIVERY

- **SERVICE BEFORE DELIVERY:** This implement was carefully prepared by the sales organization, inspected in all its parts according to the prescriptions of the manufacturer.
- **DELIVERY SERVICE:** The user was informed on the effective warranty deeds and instructed on the use and maintenance precautions.
- I confirm that I was informed on the effective warranty terms and instructed on the correct use and maintenance of the implement.

Implement: \_\_\_\_\_ Serial Number: \_\_\_\_\_

Date: \_\_\_\_\_ Invoice Number: \_\_\_\_\_ Dealer: \_\_\_\_\_

City: \_\_\_\_\_ State: \_\_\_\_\_ Zip Code: \_\_\_\_\_

Owner: \_\_\_\_\_ Phone: \_\_\_\_\_

Address: \_\_\_\_\_ Number: \_\_\_\_\_

City: \_\_\_\_\_ State: \_\_\_\_\_

E-mail: \_\_\_\_\_ Date of sale: \_\_\_\_\_

2<sup>nd</sup> Dealer

Dealer Signature / Stamp \_\_\_\_\_

---

**Instructions Manual**



## CERTIFICATE OF INSPECTION AND DELIVERY

- **SERVICE BEFORE DELIVERY:** This implement was carefully prepared by the sales organization, inspected in all its parts according to the prescriptions of the manufacturer.
- **DELIVERY SERVICE:** The user was informed on the effective warranty deeds and instructed on the use and maintenance precautions.
- I confirm that I was informed on the effective warranty terms and instructed on the correct use and maintenance of the implement.

Implement: \_\_\_\_\_ Serial Number: \_\_\_\_\_

Date: \_\_\_\_\_ Invoice Number: \_\_\_\_\_ Dealer: \_\_\_\_\_

City: \_\_\_\_\_ State: \_\_\_\_\_ Zip Code: \_\_\_\_\_

Owner: \_\_\_\_\_ Phone: \_\_\_\_\_

Address: \_\_\_\_\_ Number: \_\_\_\_\_

City: \_\_\_\_\_ State: \_\_\_\_\_

E-mail: \_\_\_\_\_ Date of sale: \_\_\_\_\_

3<sup>rd</sup> - Manufacturer

Dealer Signature / Stamp \_\_\_\_\_

Please send this filled out copy to BALDAN within a maximum of 15 days.

---

# Instructions Manual



1.74.05.0059-5

AC MATÃO  
ECT/DR/SP

## REPLY CARD

NO NEED TO SEAL

THE STAMP WILL BE PAID BY:



**BALDAN IMPLEMENTOS AGRÍCOLAS S/A**

Av. Baldan, 1500 | Nova Matão | CEP [Zip Code]: 15993-000 | Matão-SP | Brazil

Phone number: (0\*\*16) 3221-6500 | Fax: (0\*\*16) 3382-6500

Home Page: [www.baldan.com.br](http://www.baldan.com.br) | e-mail: [sac@baldan.com.br](mailto:sac@baldan.com.br)

Export: Phone number: 55 16 3221-6500 | Fax: 55 16 3382-4212 | 3382-2480

E-mail: [export@baldan.com.br](mailto:export@baldan.com.br)







## **BALDAN IMPLEMENTOS AGRÍCOLAS S/A.**

Av. Baldan, 1500 | Nova Matão | CEP: 15993-000 | Matão-SP | Brasil

Phone: (0\*\*16) 3221-6500 | Fax: (0\*\*16) 3382-6500

Home Page: [www.baldan.com.br](http://www.baldan.com.br) | e-mail: [sac@baldan.com.br](mailto:sac@baldan.com.br)

Export: Phone: 55 16 3221-6500 | Fax: 55 16 3382-4212 | 3382-2480

e-mail: [export@baldan.com.br](mailto:export@baldan.com.br)